

- ### GENERAL UTILITY CONSTRUCTION NOTES
1. WATER LINES TO HAVE THRUST BLOCKS CONSTRUCTED PER UDACS PLATE NO. 5
 2. WET TAPS TO BE CONSTRUCTED IN CONFORMANCE WITH UDACS PLATE NO. 22
 3. TRENCH BACKFILL FOR WATER LINES TO BE CONSTRUCTED PER UDACS PLATE NO. 6A, 6B & 6C WHERE APPLICABLE
 4. TRENCH BACKFILL FOR SEWER LINES TO BE CONSTRUCTED PER D.C.S.W.C.S. SD-16, SD-16A & SD-16B WHERE APPLICABLE
 5. CONTRACTOR TO LOCATE AND VERIFY SIZE, LINE TYPE, CONDITION, DEPTH, PRESSURE, AND LOCATION OF ALL EXISTING UTILITY LINES WITHIN THE CONSTRUCTION AREA PRIOR TO CONSTRUCTION. THE CIVIL ENGINEER SHALL BE CONTACTED ONCE THE UTILITY LINE IS LOCATED.
 6. THESE DRAWINGS MAY NOT INDICATE ALL EXISTING BURIED UTILITY LINES. CONTRACTOR IS TO EXERCISE GREAT CARE DURING EXCAVATION IN ORDER TO AVOID MAKING CONTACT WITH ANY EXISTING UTILITY LINES. IF UTILITY LINES ARE DAMAGED BY THE CONTRACTOR, SUCH DAMAGE SHALL BE REPLACED TO THE SATISFACTION OF THE OWNER AT THE CONTRACTOR'S EXPENSE.
 7. CONTRACTOR TO SAWCUT AND REMOVE EXISTING ASPHALT AND CONCRETE AS NECESSARY FOR UTILITY TRENCHES. BACKFILL AND PATCH ALL TRENCHES AS INDICATED IN DETAILS AND/OR ACCORDING TO THE GOVERNING ENTITY. (CITY OF LAS VEGAS)
 8. INSTALLATION OF ALL UTILITY LINES SHALL BE COORDINATED WITH THE CLARK COUNTY SCHOOL DISTRICT.
 9. CONTRACTOR/ OWNER TO OBTAIN A C.L.V. OFF-SITE IMPROVEMENT PERMIT FOR ALL WORK WITHIN PUBLIC RIGHT-OF-WAY.
 10. ALL DIMENSIONS TO UTILITIES ARE TO CENTERLINE OF PIPE UNLESS INDICATED OTHERWISE
 11. ONLY SEWER LINES AND LATERALS MAY BE INSTALLED IN TRENCHES EXCAVATED FOR SEWER LINES, SEE DCSWCS 2.2.15 (TYP.)
 12. WATER AND SEWER SEPARATION OF TRENCHES MUST BE AT LEAST 10' MIN. (TYP.). SEE DCSWCS 2.2.21 "A1", DDOACS 2.19.01 "A"
 13. ALL WATER FACILITIES CONSTRUCTION SHALL BE IN ACCORDANCE WITH THE "UNIFORM CONSTRUCTION STANDARDS FOR WATER DISTRIBUTION SYSTEMS" (UDACS), LATEST EDITION.
 14. WATER AND SEWER SERVICE LATERALS SHALL BE INSTALL A MINIMUM OF FORTY-EIGHT (48) INCHES APART IN SEPARATE TRENCHES. WATER LATERALS SHALL BE A MINIMUM OF TWELVE (12) INCHES ABOVE THE SEWER LATERAL (REF. UNIFORM PLUMBING CODE).

NOTE:
CONTRACTOR TO VERIFY UTILITY STUB LOCATIONS AND SIZE WITH PLUMBING PLANS PRIOR TO INSTALLATION OF NEW UTILITIES.

NOTE:
THE FIRE SAFETY CONTRACTOR IS RESPONSIBLE FOR ESTABLISHING THE SIZE OF PIPING THAT IS REQUIRED TO CONNECT TO THE FIRE SPRINKLER RISER. LINE SIZE SHOWN FOR INFORMATION PURPOSES ONLY.

NOTE: EXISTING UTILITY LINES ARE SHOWN IN APPROXIMATE LOCATIONS BASED ON INFORMATION AVAILABLE AT THE TIME OF DESIGN. THESE DRAWINGS MAY NOT INDICATE ALL EXISTING UNDERGROUND UTILITY LINES. THE CONTRACTOR SHALL EXERCISE GREAT CARE DURING EXCAVATION IN ORDER TO AVOID MAKING CONTACT WITH ANY EXISTING UTILITY LINES. CONTRACTOR SHALL VERIFY EXISTING UTILITY INFORMATION PRIOR TO CONSTRUCTION PER "THE CITY OF LAS VEGAS GENERAL NOTES" ON SHEET C1.01.

BASIS OF BEARINGS:
NORTH 02°20'31" WEST, BEING THE WEST LINE OF THE SOUTHWEST QUARTER (SW 1/4) OF SECTION 12, TOWNSHIP 19 SOUTH, RANGE 80 EAST, M.D.M., CLARK COUNTY, NEVADA, AS SHOWN ON THE MAP IN FILE 73 OF SURVEY, PAGE 14 OFFICIAL RECORDS, CLARK COUNTY.

BENCHMARK:
CITY OF LAS VEGAS BENCHMARK No. 1LV90 11E4
5/8" BRASS CAP, 2" ABOVE GROUND, JONES BOULEVARD AND HORSE DRIVE, REVISION DATE: 5/7/93
ELEV = 722.9994 m / 2372.04 FEET (NAVD88)

APPROVALS
[Signature] 8/20/12
DATE

LAS VEGAS FIRE DEPARTMENT
FIRE FLOW IS: 3000 GPM AT 20 PSI RESIDUAL PRESSURE
BASED ON: TYPE II - 1 HR. BLDG. CONSTRUCTION
SQUARE FOOTAGE: SEE SHEET C5.07
AREA BETWEEN 4-HR SEPARATION WALLS: NONE
BUILDING HEIGHT: 48'-6" TO PARAPET
NUMBER OF STORES: SEE SHEET C5.07
OCCUPANCY: E-1 UNLESS SPECIFIED DIFFERENTLY ON THIS SHEET.
FULL AUTOMATIC FIRE SYSTEM: YES
CITY OF LAS VEGAS FIRE DEPARTMENT
DATE: 8/19/12

- ### WATER NOTES
1. INSTALL 6" FIRE HYDRANT ASSEMBLY (INCLUDES 6"x6" TEE AND 6" GATE VALVE) PER U.D.A.C.S. PLATE NO. 7 & 8. PROVIDE A MINIMUM OF 3' CLEARANCE AROUND HYDRANT. INSTALL OFF-SITE HYDRANTS WITHIN SIDEWALK PER UDACS PLATE NO.7 CONDITION A.
 2. SEE FIRE SAFETY CONTRACTOR NOTE ON THIS SHEET
 3. PROVIDE A MINIMUM OF 18" CLEARANCE BETWEEN WATER AND SEWER OR STORM DRAIN LINES WITH SEWER OR STORM DRAIN LINES BEING BELOW WATER LINES.
 4. 4" TURBO METER AND VAULT. PER U.D.A.C.S. PLATE 18A AND C-475.
 5. DIP WATERLINE BELOW SEWER/STORM DRAIN PER DETAIL "D" ON SHEET C6.01
 6. INSTALL 8" DOUBLE CHECK DETECTOR ASSEMBLY ABOVE FG. PER U.D.A.C.S. PLATE NO. 20B. VALVES TO BE OS&Y TYPE.
 7. REFER TO MECHANICAL/ PLUMBING PLANS FOR LOCATION AND ADDITIONAL INFORMATION.
 8. INSTALL GATE VALVE PER UDACS PLATE NO. 8
 9. REFER TO LANDSCAPE PLANS FOR CONTINUATION.
 10. INSTALL A 4" RPPA PER U.D.A.C.S. PLATE NO. 11B.
 11. CONTRACTOR TO PROVIDE A MINIMUM OF 3.5' OF COVER ABOVE TOP OF PIPE, BASED ON FINISH GRADE.
 12. INSTALL 1-1/4" SERVICE SADDLE W/ CORP. STOP.
 13. INSTALL BOLLARDS (4 TOTAL) PER DETAIL "S" ON SHEET C6.02

- ### STORM DRAIN NOTES
1. CONSTRUCT 48" TYPE 1 MANHOLE PER CCAUSD No. 403. ALL ON-SITE MANHOLE COVERS TO BE PAINTED GRAY.
 2. INSTALL JENSEN PRECAST 2424 HDI DROP INLET W/ PEDESTRIAN GRATE PER DETAIL "P" ON SHEET C6.02 OR EQUIVALENT.
 3. CONSTRUCT 60" TYPE 1 MANHOLE PER CCAUSD No. 403. ALL ON-SITE MANHOLE COVERS TO BE PAINTED GRAY.
 4. INSTALL WATER QUALITY PIPE (C900) MEETING OR EXCEEDING ASTM STANDARD D2685-94
 5. INSTALL JENSEN PRECAST 4848 HDI DROP INLET W/ PEDESTRIAN GRATE PER DETAIL "Q" ON SHEET C6.02 OR EQUIVALENT.
 6. CONSTRUCT STORM DRAIN OUTLET AT WALL PER DETAIL "L" ON SHEET C6.02.
 7. CONSTRUCT STORM DRAIN OUTLET AT WALL PER DETAIL "V" ON SHEET C6.03.
 8. CONSTRUCT 3" CONCRETE VALLEY GUTTER W/ DRAIN PER DETAIL "E" ON SHEET C6.01
 9. INSTALL FLOOR DRAIN PER DETAIL "F" ON SHEET C6.02
 10. CONSTRUCT DEEP LATERAL CONNECTION PER DCSWCS DWG. No. SD-18
 11. REFER TO MECHANICAL/PLUMBING PLANS FOR LOCATION AND ADDITIONAL INFO.

- ### SANITARY SEWER NOTES
1. CONSTRUCT STANDARD ECCENTRIC MANHOLE (48") PER D.C.S.W.C.S. DRAWING NO. SD-1. ALL ON-SITE MANHOLE COVERS TO BE PAINTED GRAY.
 2. INSTALL WATER QUALITY PIPE (C900)
 3. REFER TO MECHANICAL/ PLUMBING PLANS FOR LOCATION AND ADDITIONAL INFORMATION.
 4. CONSTRUCT DEEP LATERAL CONNECTION PER DCSWCS DWG No. SD-18
- SANITARY SEWER N/E LOCATION**
- | SSMH# | NORTH (Y) | EAST (X) |
|-------|-------------|-------------|
| # 16 | 105880.5598 | 104969.8382 |
| # 17 | 106322.5634 | 104969.7569 |
- NOTE:**
A LIMITED FIRE FLOW OF 2000 GPM WILL BE AVAILABLE TO THIS SITE WHEN THE FOLLOWING PROJECTS ARE WITHIN 30 DAYS OF BEING OPERATIONAL:
1. CONT. 1060 (JONES 2539 ZONE PIPELINE PHASE 2.)
2. PROJECT #25879 (IRON MOUNTAIN RANCH HORSE/THOM/DECATUR INFRASTRUCTURE.)
3. PROJECT #25879 (IRON MOUNTAIN RANCH HORSE/THOM/DECATUR INFRASTRUCTURE.)
THE REQUIRED 3000 GPM FIRE FLOW WILL BE AVAILABLE WHEN CONTRACT 1028 (JONES 2538 ZONE PIPELINE PHASE 1) IS OPERATIONAL.
- NOTE:**
ALL ROP STORM DRAIN TO BE CLASS III UNLESS OTHERWISE NOTED
- NOTE:**
TOD'S SHALL BE INTERCONNECTED TO ALL BUILDING SPRINKLER SYSTEMS. CONTRACTOR TO COORDINATE INTERCONNECTION WITH THE CLV FIRE DEPARTMENT.

MATCHLINE - SEE SHEET C5.02 FOR CONTINUATION

MATCHLINE - SEE SHEET C5.03 FOR CONTINUATION

REVISIONS			
REV	DESCRIPTION	DATE	BY

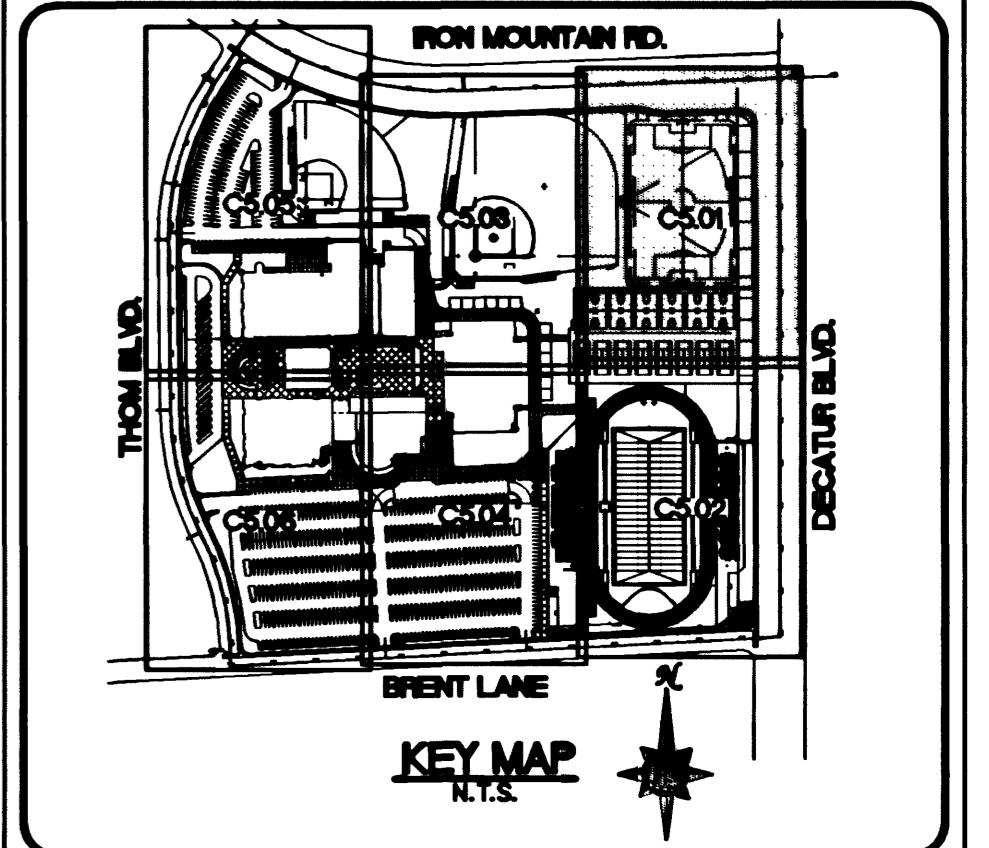

Call before you DIG
1-800-277-2900

Call before you OVERHEAD
1-702-983-6111

VERNON R. HUGHES
PROFESSIONAL ENGINEER - STATE OF NEVADA
No. 10088
Exp. 8/31/13

PROJECT NO. 1531
JOB NUMBER
APPROVED BY
DATE
DRAWN BY
CHECKED BY
SCALE
DATE
BY PROJECT NO.

PBSJ
PROFESSIONAL ENGINEER - STATE OF NEVADA
No. 10088
Exp. 8/31/13

ARCHITECTS
700 Vaila Verde Court, Henderson, Nevada 89014 ph: 702-458-3000 fax: 702-868-6208
www.tate-snyderkimsey.com

CLARK COUNTY SCHOOL DISTRICT
CONSTRUCTION MANAGEMENT DEPARTMENT 4828 S. PEARL STREET 796-7000 LAS VEGAS, NEVADA 89121

DECATUR / IRON MOUNTAIN HIGH SCHOOL
NEVADA
CITY OF LAS VEGAS

ON-SITE UTILITY PLAN

SHEET NO. **C5.01**
715-144
SHEET 34 OF 45