

IRON MOUNTAIN RD. (PUBLIC) - PLAN VIEW
HORIZONTAL SCALE: 1" = 30'

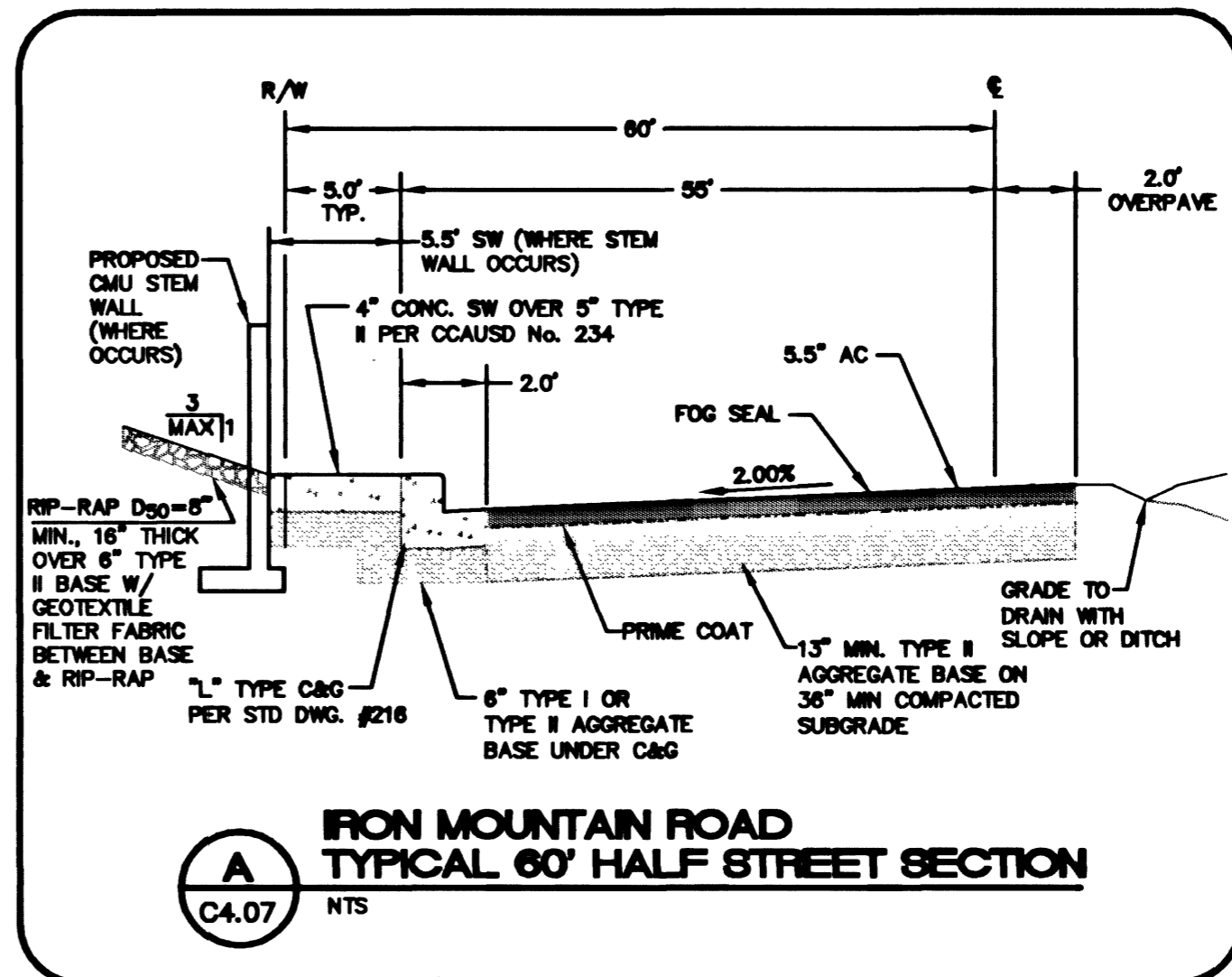
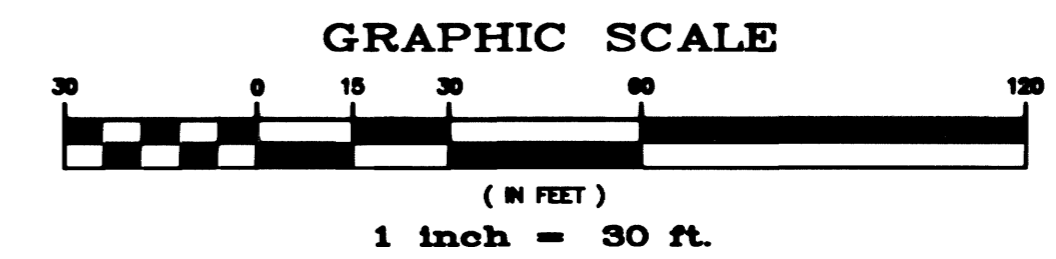
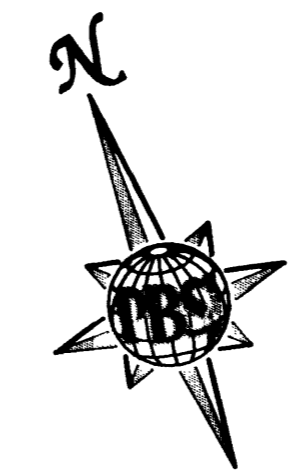

IRON MOUNTAIN ROAD TYPICAL 60' HALF STREET SECTION
C4.07 NTS

SIDEWALK RAMP PER C.C.A.U.S.D. NO. 235 CASE I

NO.	'A'	'B'
16	5'	5'
17	5'	5'
18	5'	5'

LEGEND

- PROPOSED OFF-SITE AC PAVEMENT
- PROPOSED RIP-RAP D₉₀=5" MIN., 16" THICK OVER 6" TYPE II BASE W/ GEOTEXTILE FILTER FABRIC BETWEEN BASE & RIP-RAP
- FUTURE GRADE BY OTHERS
- EXISTING GRADE
- PROPOSED GRADE

CONSTRUCTION KEY NOTES

- 1 CONSTRUCT TYPICAL SECTION PER CCAUSD NO. 202 AND 208.1 (100' R.O.W.), ALSO REFER TO DETAIL "A" ON THIS SHEET
- 2 CONSTRUCT 5' SIDEWALK PER CCAUSD NO. 234
- 3 CONSTRUCT "L" CURB AND GUTTER PER CCAUSD NO. 216
- 4 CONSTRUCT 6" CROSS GUTTER PER CCAUSD NO. 228
- 5 CONSTRUCT 2' SIDEWALK DRAIN PER CCAUSD NO. 236
- 6 CONSTRUCT DRIVEWAY PER CCAUSD NO. 224
- 7 CONSTRUCT HALF STREET CROSS GUTTER PER CCAUSD NO. 229
- 8 CONSTRUCT SIDEWALK RAMP PER CCAUSD NO. 235 CASE I REFER TO TABLE ON THIS SHEET FOR RAMP LENGTHS
- 9 CONSTRUCT COMMERCIAL DRIVEWAY PER CCAUSD NO. 222A
- 10 CONSTRUCT PAVED ACCESS ROAD PER DETAIL "A" ON SHEET C4.13 AND CCAUSD NO. 209
- 11 CONSTRUCT SIDEWALK RAMP PER CCAUSD NO. 235 CASE II REFER TO TABLE ON THIS SHEET FOR RAMP LENGTHS
- 12 CONSTRUCT TYPICAL BUS TURN-OUT WITH LOADING PAD PER C.C.A.U.S.D. NO 234.1 AND 234.2
- 13 SIGHT VISIBILITY RESTRICTION ZONE, REFER TO TRAFFIC SHEETS FOR ADDITIONAL INFORMATION

BASIS OF BEARINGS:

NORTH 02°20'31" WEST, BEING THE WEST LINE OF THE SOUTHWEST QUARTER (SW 1/4) OF SECTION 12, TOWNSHIP 19 SOUTH, RANGE 60 EAST, M.D.M., CLARK COUNTY, NEVADA AS SHOWN ON THE MAP IN FILE 73 OF SURVEY, PAGE 14 OFFICIAL RECORDS, CLARK COUNTY.

BENCHMARK:

CITY OF LAS VEGAS BENCHMARK No. 1LV90 11E4
BLM BRASS CAP, 2" ABOVE GROUND, JONES BOULEVARD AND HORSE DRIVE. REVISION DATE: 5/7/93
ELEV = 722.9994 m/2372.04 FEET (NAVD88)

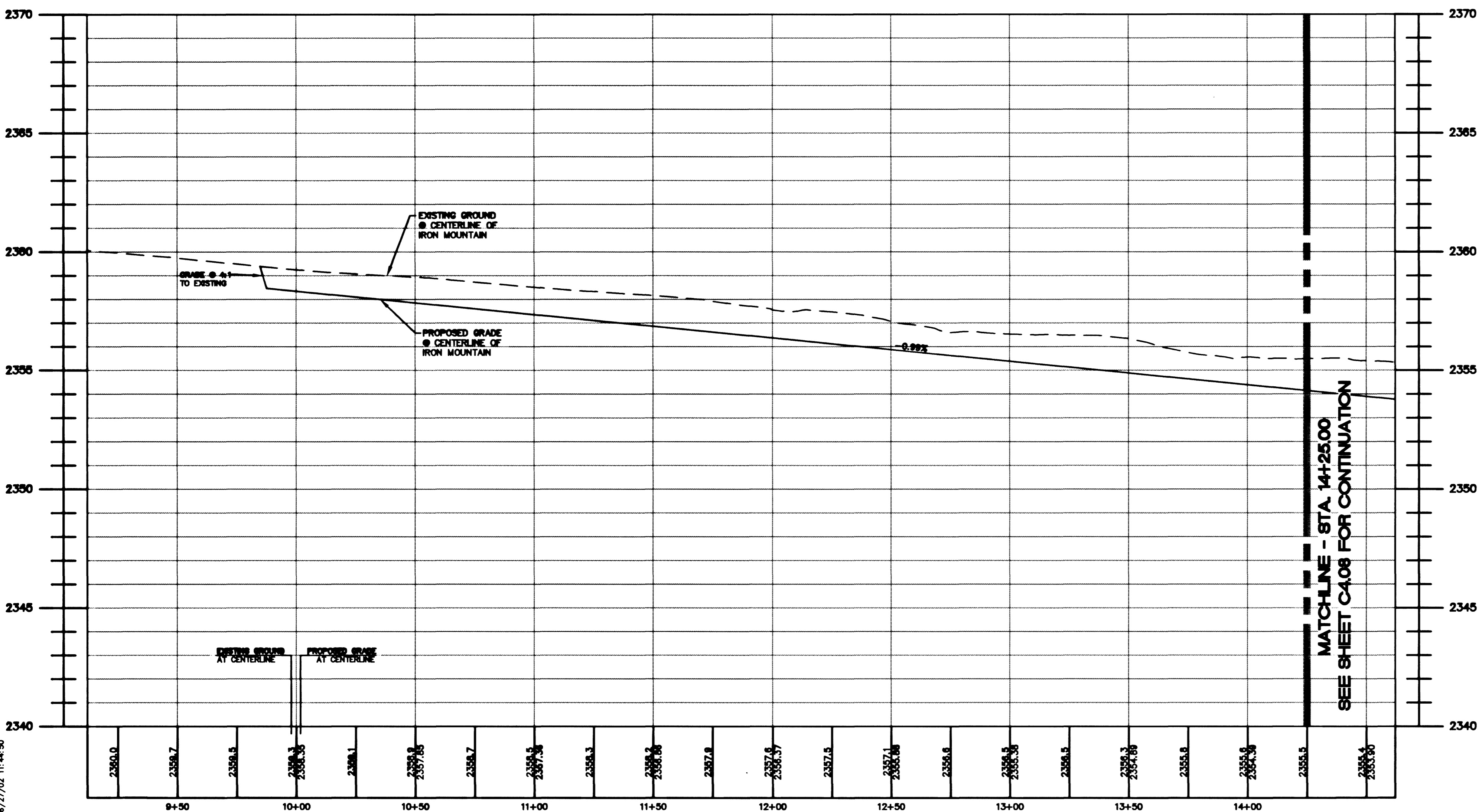

IRON MOUNTAIN RD. (PUBLIC) - PROFILE
HORIZONTAL SCALE: 1" = 30'
VERTICAL SCALE: 1" = 3'

REVISIONS

REV	DESCRIPTION	DATE	BY

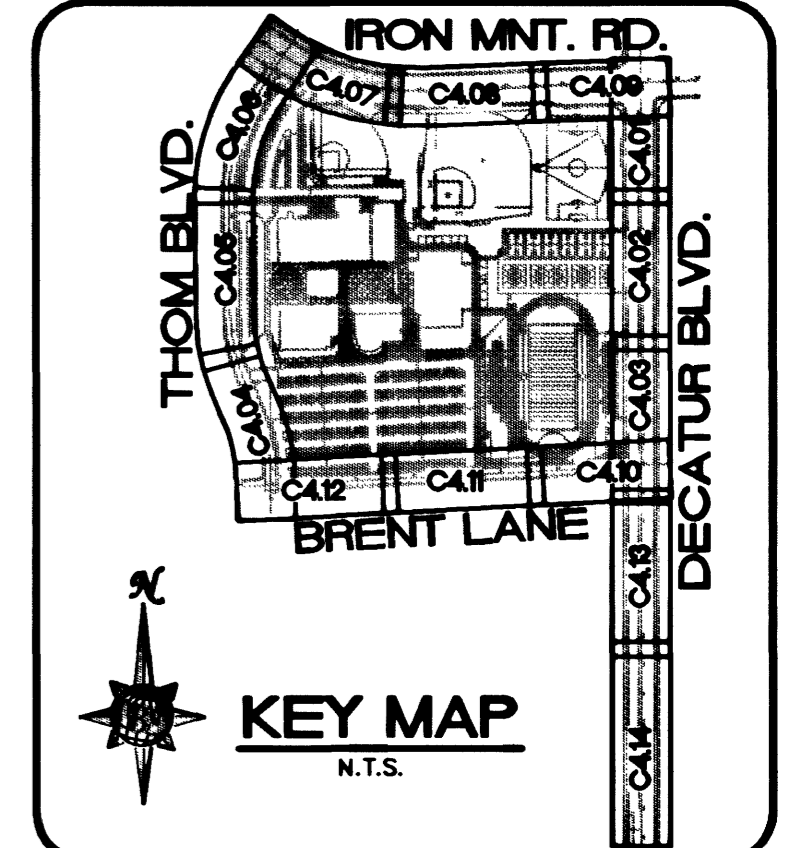

KEY MAP
N.T.S.

Call before you DIG
1-800-277-2800

Call before you OVERHEAD
1-702-983-6111

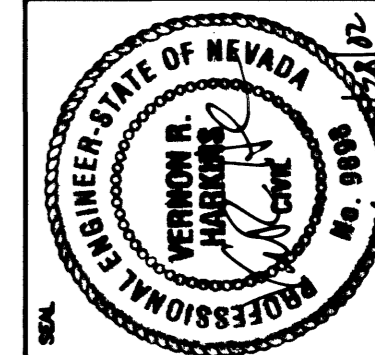

PROJECT NO. 125-01-801-001
DATE 05/27/02
CHECKED BY JTA
DATE 05-29-02
APPROVED BY
DATE 05-29-02
V.P.E. PROJECT NO. 98018



TATE SNYDER KIMSEY ARCHITECTS
708 Valle Verde Court Henderson, Nevada 89014 ph. 702.456.3000 fax 702.696.6209
www.tatesnyderkimsey.com

CLARK COUNTY SCHOOL DISTRICT
CONSTRUCTION MANAGEMENT DEPARTMENT 4828 S. PEARL STREET 798-7600 LAS VEGAS, NEVADA 89121

DECATUR / IRON MOUNTAIN HIGH SCHOOL
CITY OF LAS VEGAS

OFF-SITE, IRON MOUNTAIN RD.

SHEET NO. **C4.07**
715-144
SHEET 21 OF 25

1251-07.dwg RBB 05/27/02 11:44:50

44243