

BASIS OF BEARING
 NORTH 00°00'59" EAST BEING THE EAST LINE OF THE NORTHEAST QUARTER (NE 1/4), OF THE SOUTHWEST QUARTER (SW 1/4) OF SECTION 25, TOWNSHIP 19 SOUTH, RANGE 60 EAST, M.D.M. AS SHOWN ON PARCEL MAP, FILE 66, PAGE 7, OFFICIAL RECORDS, CLARK COUNTY, NEVADA.

BENCHMARK
CITY OF LAS VEGAS BENCHMARK #1LY90-36N4
 ELEVATION = 696.2262 METERS 2284.20 FEET (NAVD 88).
 RIVET AND PLATE IN SOUTH TOP OF CURB, ANN ROAD AT CURB ANGLE POINT, 1530.00 FEET EAST OF CALVERTS STREET AT BRADLEY ROAD.

CONSTRUCTION KEY NOTES

- 1 INSTALL 1-1/4" STREETLIGHT CONDUIT W/2-#4 1-#8 THW (TYP.) (BENEATH SIDEWALK, C.C. STDS.)
- 2 INSTALL 150 WATT HIGH PRESSURE SODIUM LIGHT PER C.C. STDS.
- 3 INSTALL 2" CONDUIT (FOR FUTURE FLASHING BEACON)
- 4 INSTALL NO. 3'-1/2" PULL BOX PER C.C.A.U.S.D. DWG. NO. 404.110. INTERCEPT EXISTING STREET LIGHT CIRCUIT INSTALL #3 PULLBOX. PULL CONDUCTORS.
- 5 NOT USED.
- 6 STREETLIGHTS TO BE INSTALLED IN BACK PORTION OF SIDEWALK PER CCAUSD NO. 320
- 7 NOT USED.
- 8 NOT USED.
- 9 NOT USED.
- 10 SIGHT VISIBILITY ZONE - NO WALLS, FENCES, TREES, SCHRUBS, UTILITY APPURTENANCES OR ANY OTHER OBJECT, OTHER THAN TRAFFIC CONTROL DEVICES AND STREET LIGHT POLES, MAY BE CONSTRUCTED OR INSTALLED WITHIN THE SIGHT VISIBILITY ZONE UNLESS SAID OBJECT IS MAINTAINED AT LESS THAN 24 INCHES IN HEIGHT, MEASURED FROM TOP OF CURB, OR WHERE NO CURB EXISTS. A HEIGHT OF 27 INCHES MEASURED FROM THE TOP OF ADJACENT ASPHALT, GRAVEL OR PAVEMENT STREET SURFACE.

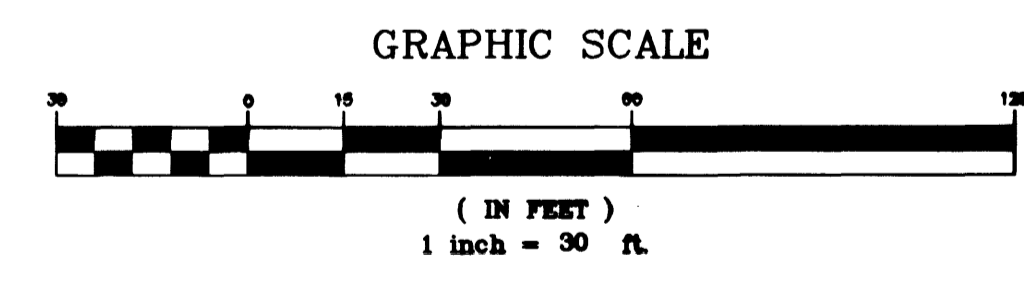
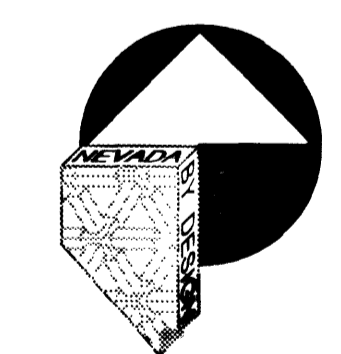

LEGAL DESCRIPTION

A PORTION OF THE NORTHEAST QUARTER (NE 1/4) OF SECTION 25, TOWNSHIP 19 SOUTH, RANGE 60 EAST, M.D.M. BEING MORE PARTICULARLY DESCRIBED AS FOLLOWS:
 LOT 2 OF A PARCEL MAP RECORDED IN FILE 66, PAGE 7 OF PARCEL MAPS IN CLARK COUNTY RECORDERS OFFICE, CLARK COUNTY, NEVADA.
 CONTAINS 17.13 ACRES MORE OR LESS.

LEGEND

- EXISTING AC
- PROPOSED AC

Call before you Dig
 1-800-227-2600
 NEVADA POWER ENFORCEMENT & SAFETY SERVICE (N.E.S.S.)

Call before you OVERHEAD
 1-702-593-6111
 NEVADA POWER ENFORCEMENT & SAFETY SERVICE (N.E.S.S.)

REVISIONS			
REV	DESCRIPTION	DATE	BY

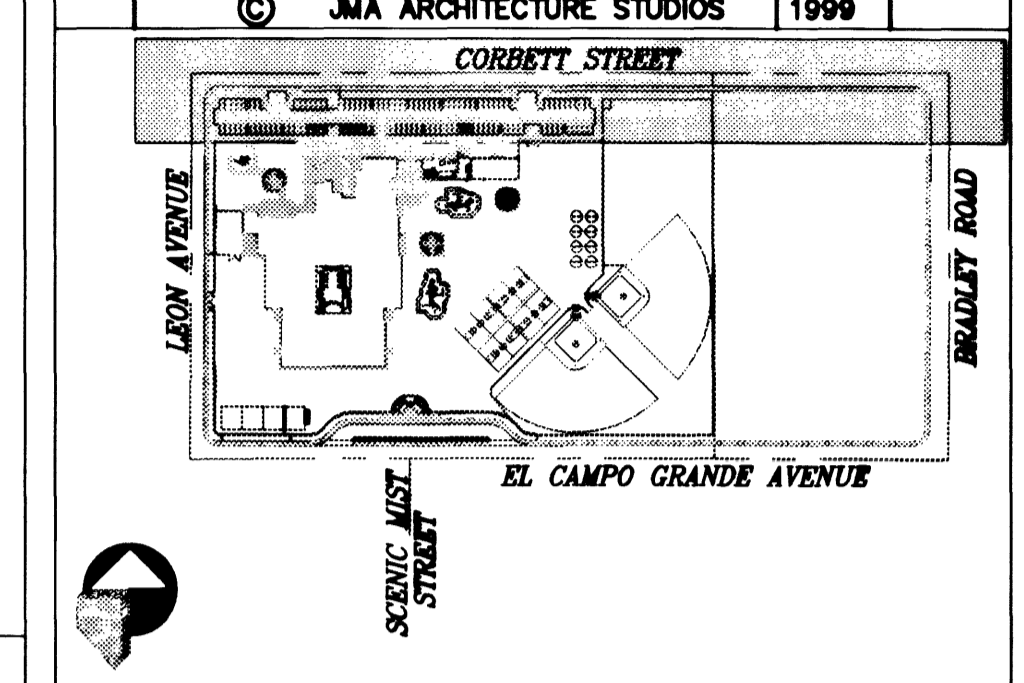

DO NOT SCALE DRAWINGS

SEAL
 STATE OF NEVADA
 PROFESSIONAL ENGINEER
 KENT B. ANDERSON
 CIVIL
 No. 6951
 2/17/02

DATE: 07/17/2000
 DRAWN BY: M.W.
 CHECKED BY: M.W.
 SUBMITTAL ELEMENT: STREET LIGHTING PLAN
 APPROVAL NO.: 0004

NEVADA BY DESIGN
 PROVIDING TOPOGRAPHIC SURVEYING SERVICES
 4021 S. Maryland Parkway
 Las Vegas, Nevada 89119
 702/731-2134 - Fax
 702/731-3888 - Tel

JMA ARCHITECTURE STUDIOS
 10118 CONVENTOR CESSA DRIVE LAS VEGAS, NEVADA 89123 8000

CLARK COUNTY SCHOOL DISTRICT
 CONSTRUCTION MANAGEMENT
 4828 PEARL ST.
 LAS VEGAS, NEVADA 89121

EL CAMPO GRANDE / BRADLEY ELEMENTARY SCHOOL
CORBETT STREET - STREET LIGHTING PLAN

SHEET NO.
C6.05
 SHEET 28 of 34
 DRAWING NUMBER
 715-132

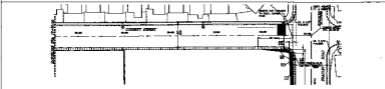
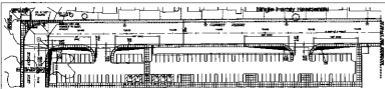

DATE OF DESIGN
 THIS PLAN IS THE PROPERTY OF THE ARCHITECT AND IS NOT TO BE REPRODUCED OR COPIED IN ANY MANNER WITHOUT HIS WRITTEN PERMISSION.

APPROVED BY
 CITY OF EL PASO, TEXAS, PLANNING AND ZONING DEPARTMENT
 ON _____ AT _____

CONSTRUCTION KEY POINT

- 1. ALL CONSTRUCTION SHALL BE IN ACCORDANCE WITH THE LATEST EDITIONS OF THE INTERNATIONAL BUILDING CODES AND THE TEXAS BUILDING CODE.
- 2. ALL MATERIALS SHALL BE OF THE BEST QUALITY AVAILABLE.
- 3. ALL WORK SHALL BE DONE IN ACCORDANCE WITH THE LATEST EDITIONS OF THE STANDARD SPECIFICATIONS FOR CONSTRUCTION OF PUBLIC WORKS.
- 4. ALL UTILITIES SHALL BE PROTECTED AND DEEPLY REVEALED PRIOR TO CONSTRUCTION.
- 5. ALL FOUNDATIONS SHALL BE CONSTRUCTED ON UNDISTURBED SOIL OR ON PILES DRIVEN TO UNDISTURBED SOIL.
- 6. ALL ROOFS SHALL BE CONSTRUCTED IN ACCORDANCE WITH THE LATEST EDITIONS OF THE ROOFING MANUFACTURER'S INSTRUCTIONS.
- 7. ALL EXTERIOR FINISHES SHALL BE IN ACCORDANCE WITH THE LATEST EDITIONS OF THE MANUFACTURER'S INSTRUCTIONS.
- 8. ALL INTERIORS SHALL BE FINISHED IN ACCORDANCE WITH THE LATEST EDITIONS OF THE MANUFACTURER'S INSTRUCTIONS.
- 9. ALL MECHANICAL, ELECTRICAL AND PLUMBING WORK SHALL BE INSTALLED IN ACCORDANCE WITH THE LATEST EDITIONS OF THE NATIONAL ELECTRICAL CODE, THE NATIONAL PLUMBING CODE AND THE NATIONAL MECHANICAL CODE.
- 10. ALL WORK SHALL BE COMPLETED WITHIN THE SPECIFIED TIME FRAME.



LEGAL DESCRIPTION
 LOT 1, BLOCK 1, EL CAMPO GRANDE SUBDIVISION, EL PASO COUNTY, TEXAS
 AS SHOWN ON PLAT NO. 123456, EL PASO COUNTY, TEXAS



NO. 1000 1000
 1000 1000
 1000 1000



REVISIONS BY
 DATE
 DESCRIPTION

CLARK COUNTY SCHOOL DISTRICT
 EL CAMPO GRANDE / BRADLEY
 ELEMENTARY SCHOOL
 CORNETT STREET - STREET LIGHTING PLAN

DATE: 10/15/2024
 PROJECT NO: C605