

APPROXIMATE QUANT.

ITEM	DESCRIPTION	UNIT	QUANTITY
123.206	6" VITRIFIED CLAY PIPE	LF	400
123.208	8" VITRIFIED CLAY PIPE	LF	1600
512.104	SANITARY SEWER MANHOLES	EA	5

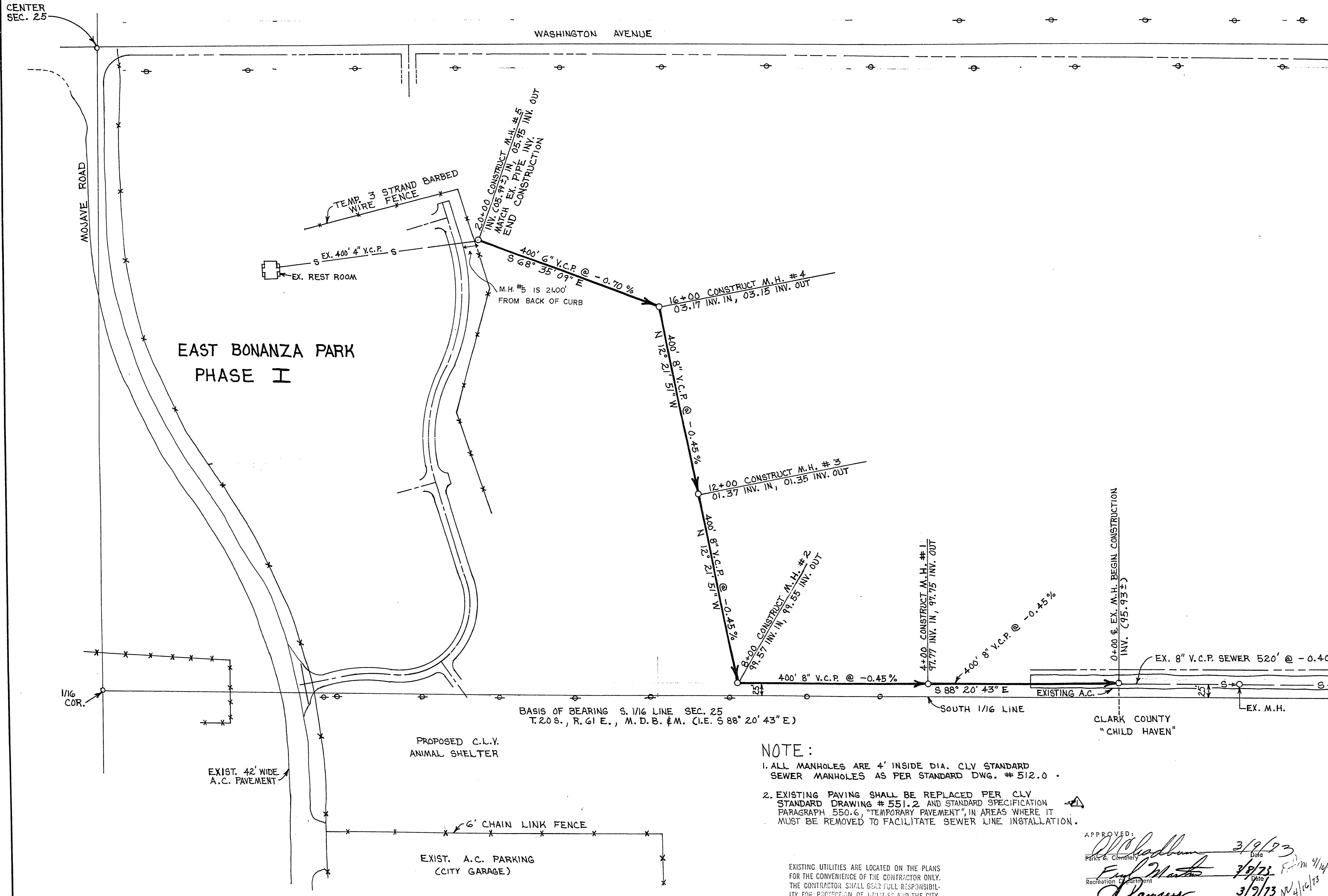

APPROVED:

Not Applicable	Date
N/A	Date
J. D. Decker	3-8-73
N/A	Date
N/A	Date
N/A	Date
William Adams	3/1/73
N/A	Date
N/A	Date
N/A	Date
N/A	Date
N/A	Date

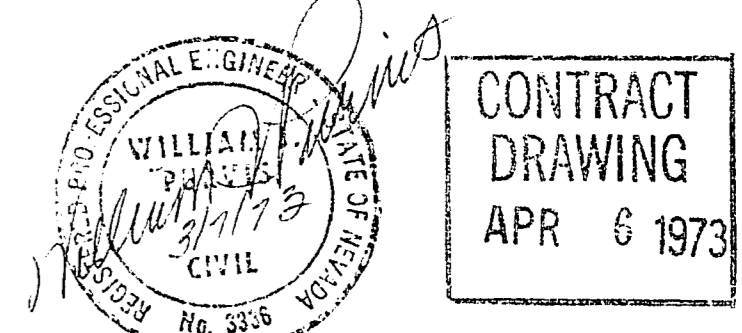

CONTRACT DRAWING
APR 6 1973

BENCH MARK
B.M. 06125 C1
C.I.V. BRASS CAP
SW COR. 30th & WASHINGTON
ELEV. 1817.16

REFERENCE
F.B. 66-6X, PP 70-71
F.B. 68-4X, PP 53-61
F.B. 70-7X, PP 21-24
F.B. 62-1X, PP 30
F.B. 72-7X, PP 38-42

- NOTE:
- ALL MANHOLES ARE 4' INSIDE DIA. CLY STANDARD SEWER MANHOLES AS PER STANDARD DWG. # 512.0 .
 - EXISTING PAVING SHALL BE REPLACED PER CLY STANDARD DRAWING # 551.2 AND STANDARD SPECIFICATION PARAGRAPH 550.6, "TEMPORARY PAVEMENT", IN AREAS WHERE IT MUST BE REMOVED TO FACILITATE SEWER LINE INSTALLATION.

EXISTING UTILITIES ARE LOCATED ON THE PLANS FOR THE CONVENIENCE OF THE CONTRACTOR ONLY. THE CONTRACTOR SHALL BEAR FULL RESPONSIBILITY FOR PROTECTION OF UTILITIES AND THE CITY BEARS NO RESPONSIBILITY FOR UTILITIES NOT SHOWN ON THE PLANS OR NOT IN THE LOCATION SHOWN ON THE PLANS.

APPROVED:

Chadburn 3/9/73
Fleming 3/8/73
Adams 3/9/73
Taylor 3/8/73

REVISION NO.	DESCRIPTION	BY	DATE	APPROVAL
AS BUILT				
	SPECIFY TEMPORARY PAYEMENT PATCH	LSB	4-13-73	WBL

REVISIONS

CITY OF LAS VEGAS NEVADA
DEPARTMENT OF PUBLIC WORKS
SERVICES DIVISION
EAST BONANZA PARK
SEWER LINE

W.O. NO. 3177	F.B. NO.	DATE	DRAWING NO.
SC. (H) 1"=100'	SC. (V) NONE		
DES. L. BERNHARD			
DR. L. BRADFORD	3-1-73		FILE NO.
APPROVED BY DIRECTOR OF PUBLIC WORKS			650-22-2
			SHEET 1 OF 2