

RECEIVED
MAY 30 2008
City of Las Vegas

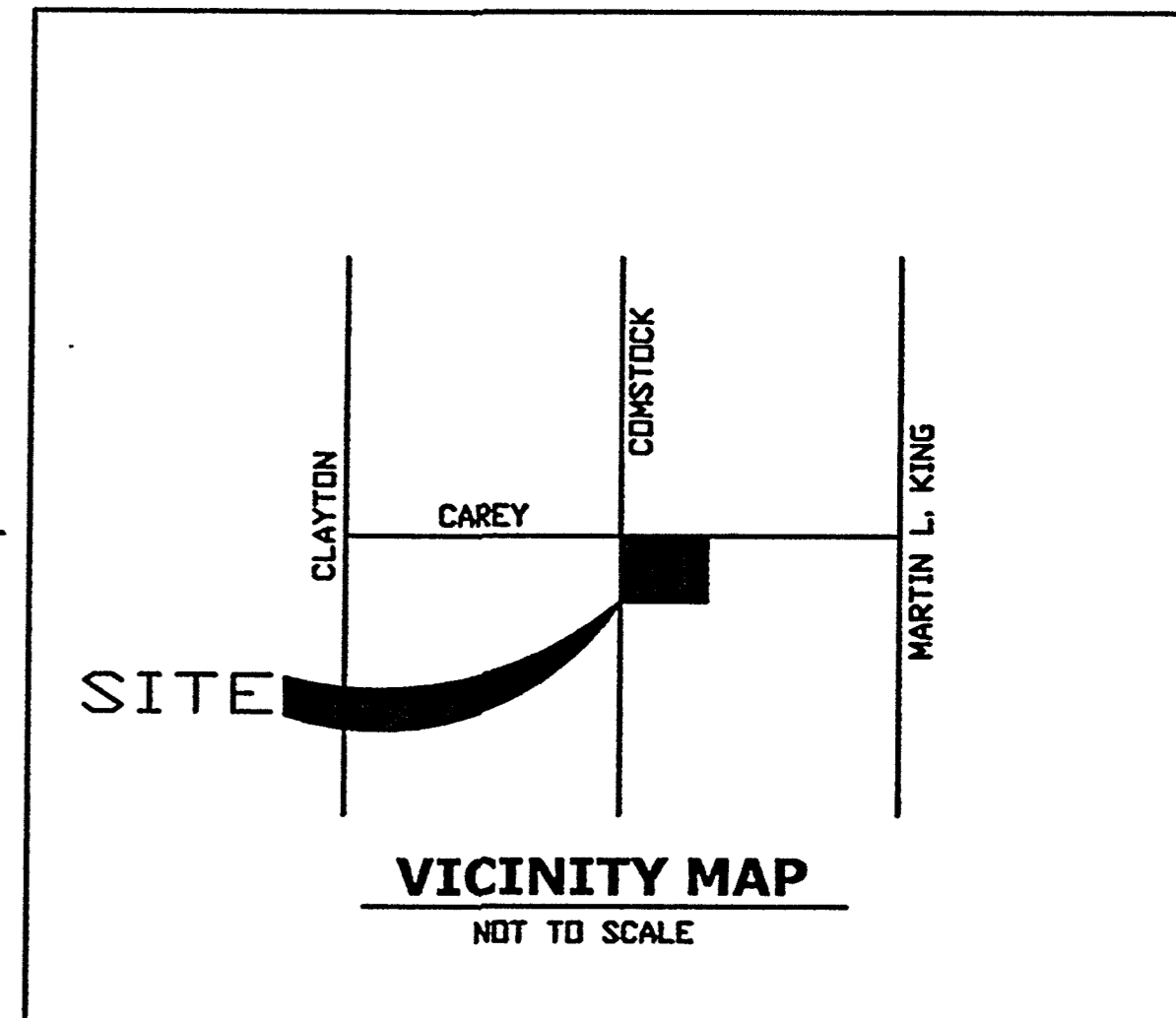
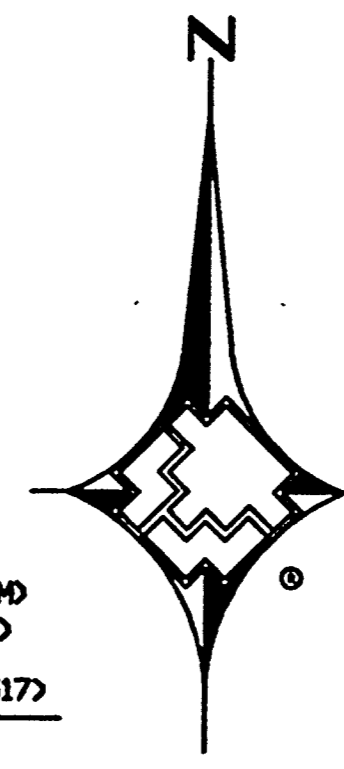
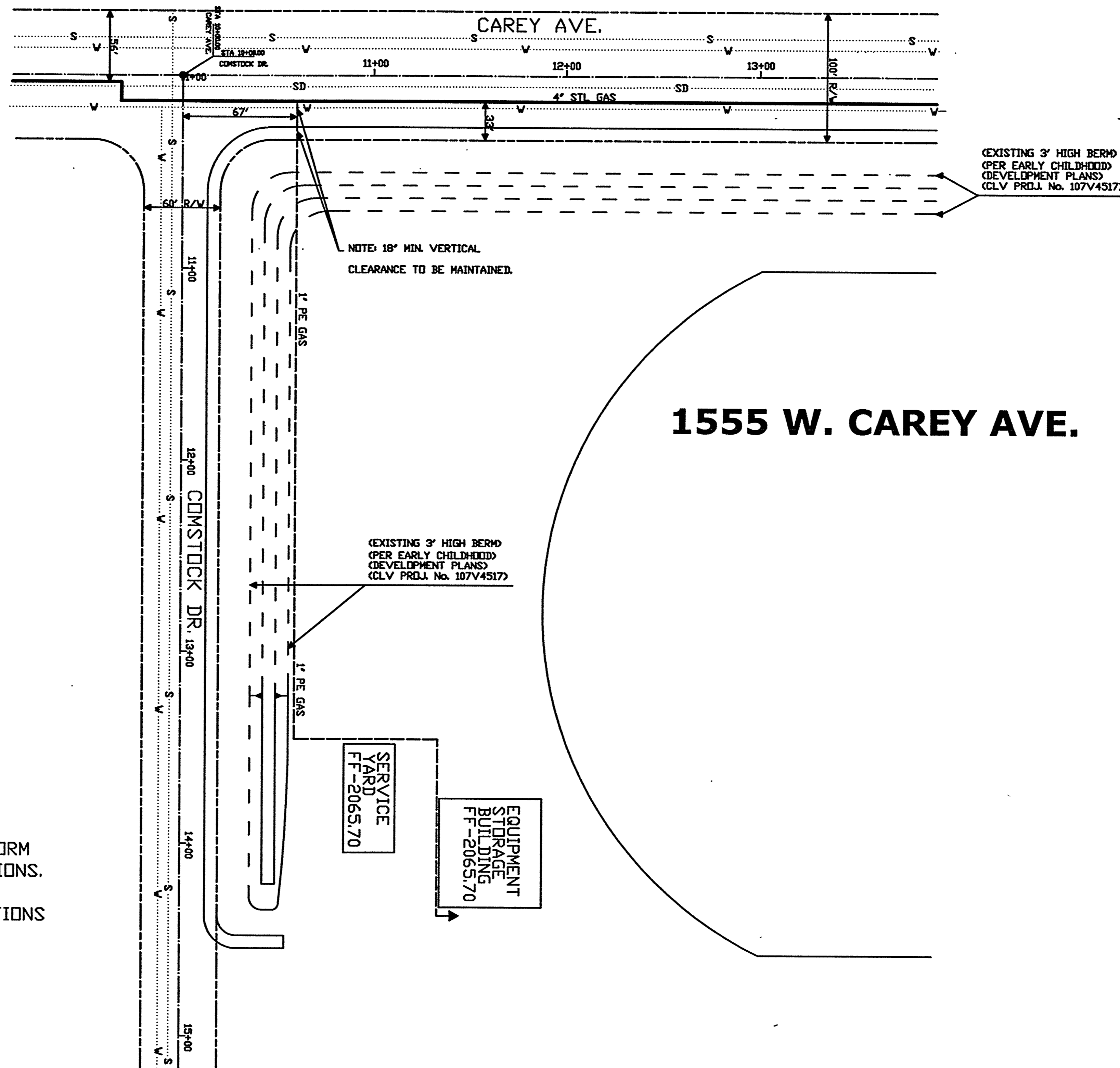
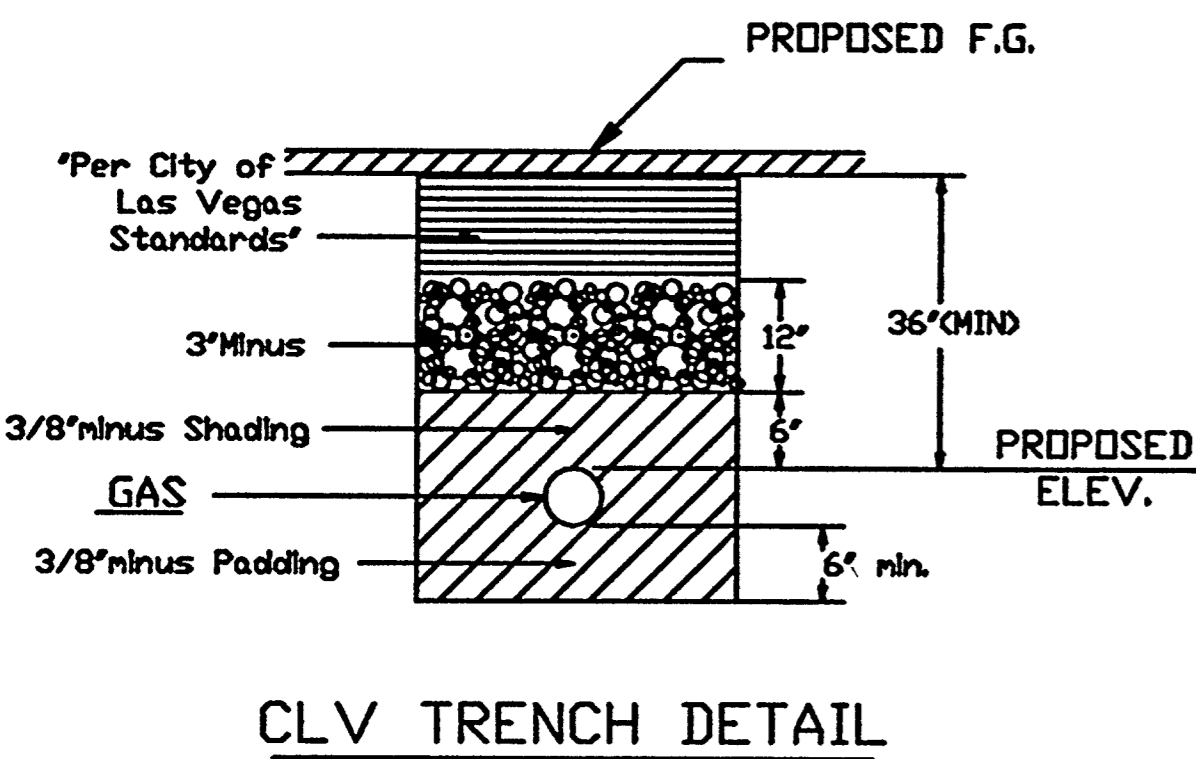

LEGEND

- Proposed gas main
- Proposed gas service
- Existing gas main
- Right of Way

CONSTRUCTION NOTES:

- SUGGESTED GAS LOCATIONS ARE TO CLEAR SUBSTRUCTURES. LOCATE IN FIELD.
- ALL PIPELINE CONSTRUCTION SHALL CONFORM TO APPLICABLE JURISDICTION SPECIFICATIONS.
- GAS MAINS SHALL BE PURGED PER OPERATIONS MANUAL.
- CITY OF LAS VEGAS PERMIT REQUIRED.
- DO NOT SCALE THIS DRAWING.

City of Las Vegas

Total footage located in Public ROW 38'

APPROVED FOR CONSTRUCTION
THIS APPROVAL IS FOR WORK IN CLV RW OR CLV EASEMENTS ONLY. OBTAINING PERMISSION OR EASEMENTS FOR WORK SHOWN ON PRIVATE PROPERTY IS THE RESPONSIBILITY OF THE UTILITY.

[Signature] 6/3/2008
Approval Date

		1' PE 320' UNIT NO. UNIT TYPE INSTL. RET. INSTL. RET. PROPOSED COMPLETED PROPERTY UNITS	AS-BUILT DRAWING-PRESSURE TEST DATA PIPE DIA. TEST MEDIUM TEST METHOD PIPE LENGTH GAUGE CHART PIPE TYPE WATER GAUGE/ PRESS REC SW SOAP NDA DURATION START END TEST PRES. USED TIME DATE PERFORMED BY	VISUAL INSPECTION CERTIFICATION I HAVE VISUALLY INSPECTED ALL HEATED FUSINGS, SOLVENT CEMENT, MECHANICAL JOINTS, AND WELDS THAT I HAVE PERFORMED NAME DATE AS-BUILTS ACCEPTED BY DATE POSTED BY DATE POSTING QCD BY DATE	CONSTRUCTION INSPECTOR FOREMAN REVIEWED BY PERMIT INFORMATION Tax Code Area-02-0200 CITY OF LAS VEGAS	ISOLATION AREA 83 LOCATION T20S R61E S21 V. R. NO. 839296 ATLAS #/TILE # x621 y502	ENGINEER/TECHNICIAN WILLIAM GRENNAN PHONE 702-365-2173 ACCOUNT REP. JOHN WRIGHT PHONE 702-528-7729 PROJECT CONTACT JOHN WRIGHT SHEET NO. 1 OF 1 SCALE N/A DATE 05/14/2008 DWN. BY SVG CHKD. BY APPVD. BY TITLE DR. WILLIAM U. PEARSON PARK CITY OF LAS VEGAS 650.102-SWG
--	--	---	--	---	---	---	---

MAY 30 2008 #28204 MLK AND CAREY PARK