

SECTION 1133  
SCALE 1/2" = 1'-0"

DIGESTER CONTROL BLDG NO. 1  
SCALE 1/4" = 1'-0"

UNIT NO.	SERVICE	VOLTS	C.F.M. & STATIC PRESSURE	CONTROL	REMARKS
CF-1	FUME HOOD NO. 1	480, 3φ	750 @ 3"	SWITCH	
CF-2	FUME HOOD NO. 2	480, 3φ	750 @ 3"	SWITCH	
CF-3	VENT HOOD	480, 3φ	1000 @ 3 1/2"	SWITCH	
PF-1	ATTIC VENTILATION	480, 3φ	800 @ 1/4"	T	
PF-2	DIGESTER BLDG. NO. 1 VENTILATION	120V, 1φ	2000 @ 1/4"	TIMER & ON-OFF PUSHBUTTONS	18" φ, REPLACE EXISTING
PF-3	CHLORINE BLDG VENTILATION	480, 3φ		TIMER & ON-OFF PUSHBUTTONS	EXIST NEW CONTROL
PRV-1	DIGESTER BLDG. NO. 2 VENTILATION	480, 3φ		TIMER & ON-OFF PUSHBUTTONS	EXIST NEW CONTROL

- LEGEND**
- AHU AIR HANDLING UNIT
  - CF CENTRIFUGAL FAN
  - CFM CUBIC FEET PER MINUTE
  - EA EXHAUST AIR
  - FRP FIBERGLASS REINFORCED POLYESTER
  - PF PROPELLER FAN
  - PRV POWER ROOF VENTILATOR
  - RA RETURN AIR
  - SA SUPPLY AIR
  - SD SUPPLY DIFFUSER
  - SR SUPPLY REGISTER
  - T THERMOSTAT
  - THERMOSTAT THERMOSTAT ROOF

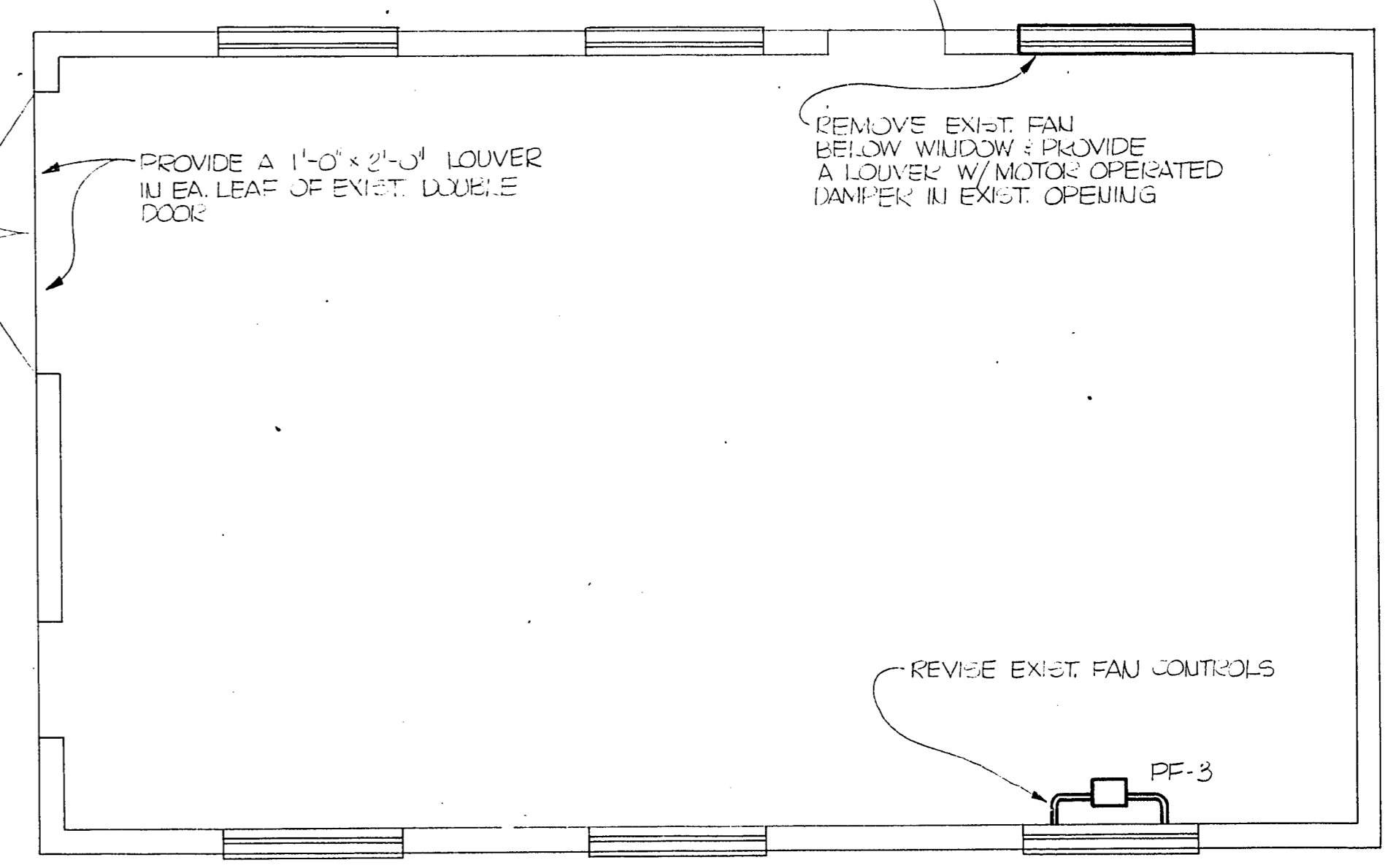

CHLORINE BLDG  
SCALE 1/4" = 1'-0"

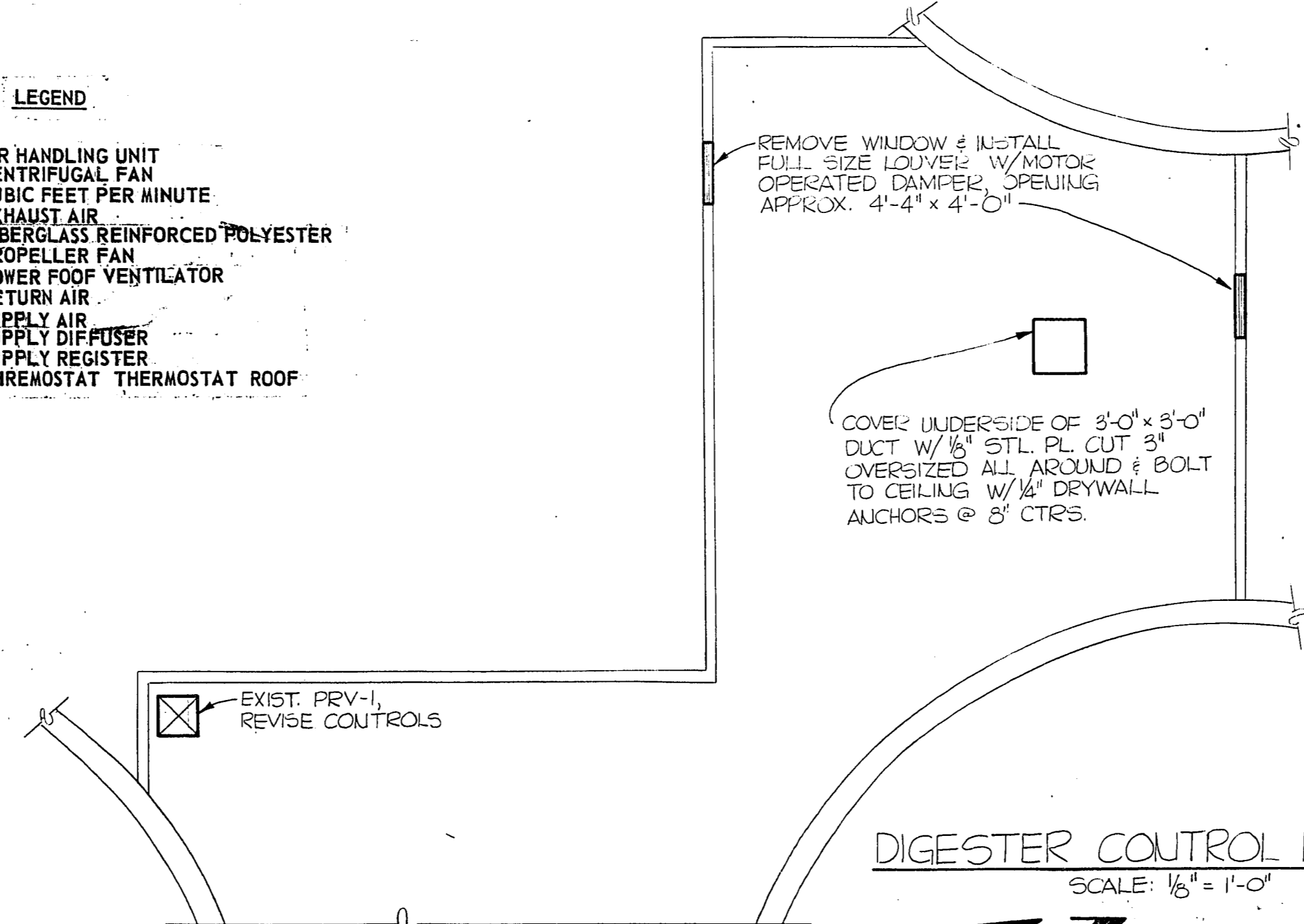
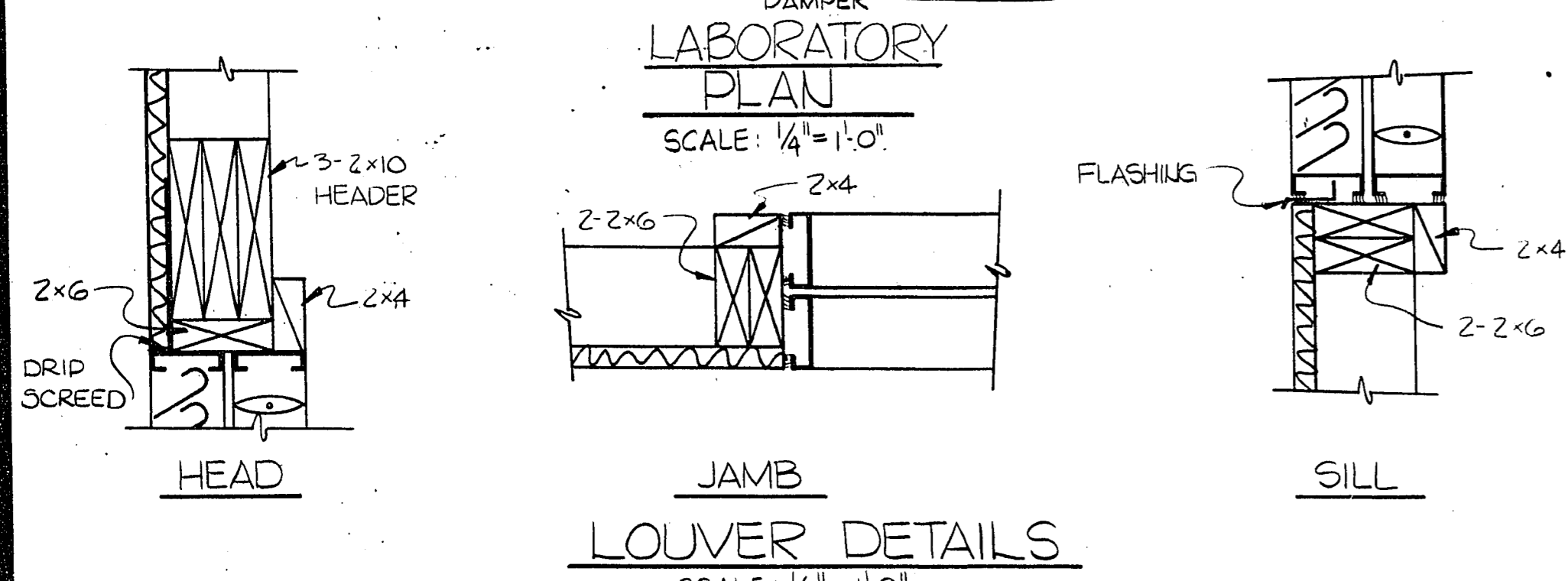

DIGESTER CONTROL BLDG. NO. 2  
SCALE 1/8" = 1'-0"

3115 C

NO.	BY	REVISION	DATE
1	AS BUILT		8-11-82
2	ELC	REVIEW CORRECTIONS & UPDATING	9-8-80

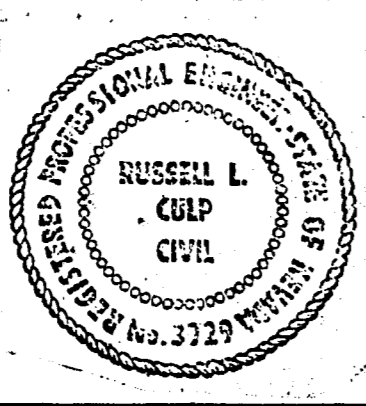

Designed BRW  
 Drawn GES  
 Checked WFE  
 Approved Russell L. Culp

PROJECT NO. 396  
 DATE JULY 28, 1980

**CULP/WESNER/CULP**  
 EL DORADO HILLS, CALIFORNIA  
 SANTA ANA, CALIFORNIA

CITY OF LAS VEGAS, NEVADA  
 WASTEWATER TREATMENT PLANT  
 EXPANSION - CONTRACT NO. 5

MODIFICATION OF  
 SECONDARY SETTLING BASINS,  
 DIGESTERS, LABORATORY  
 AND CHLORINATION FACILITIES

HEATING, VENTILATING  
 & AIR CONDITIONING

SHEET **33**  
 OF 40

CONFORMS TO CONSTRUCTION RECORDS

3-7-34