

Call before you Dig  
1-800-227-2600  
Call before you Overhead  
1-702-593-6111

APN-125-13-401-008  
(VACANT)

APN-125-13-401-007  
(EXISTING RESIDENCE)

EXISTING RESIDENCE  
EXISTING RESIDENCE  
EXISTING RESIDENCE  
VACANT

BOYD LANE  
LANDSCAPE  
ST. LIGHT CONDUIT  
3" INTERCONNECT

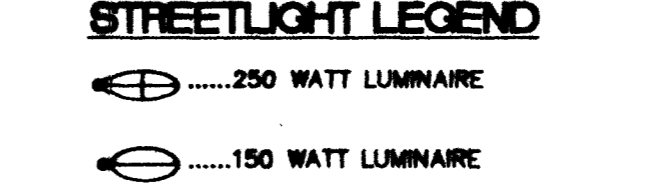
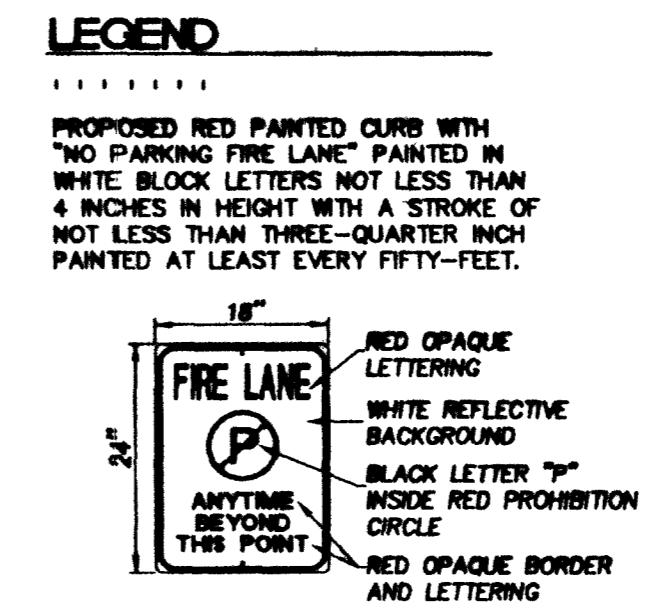
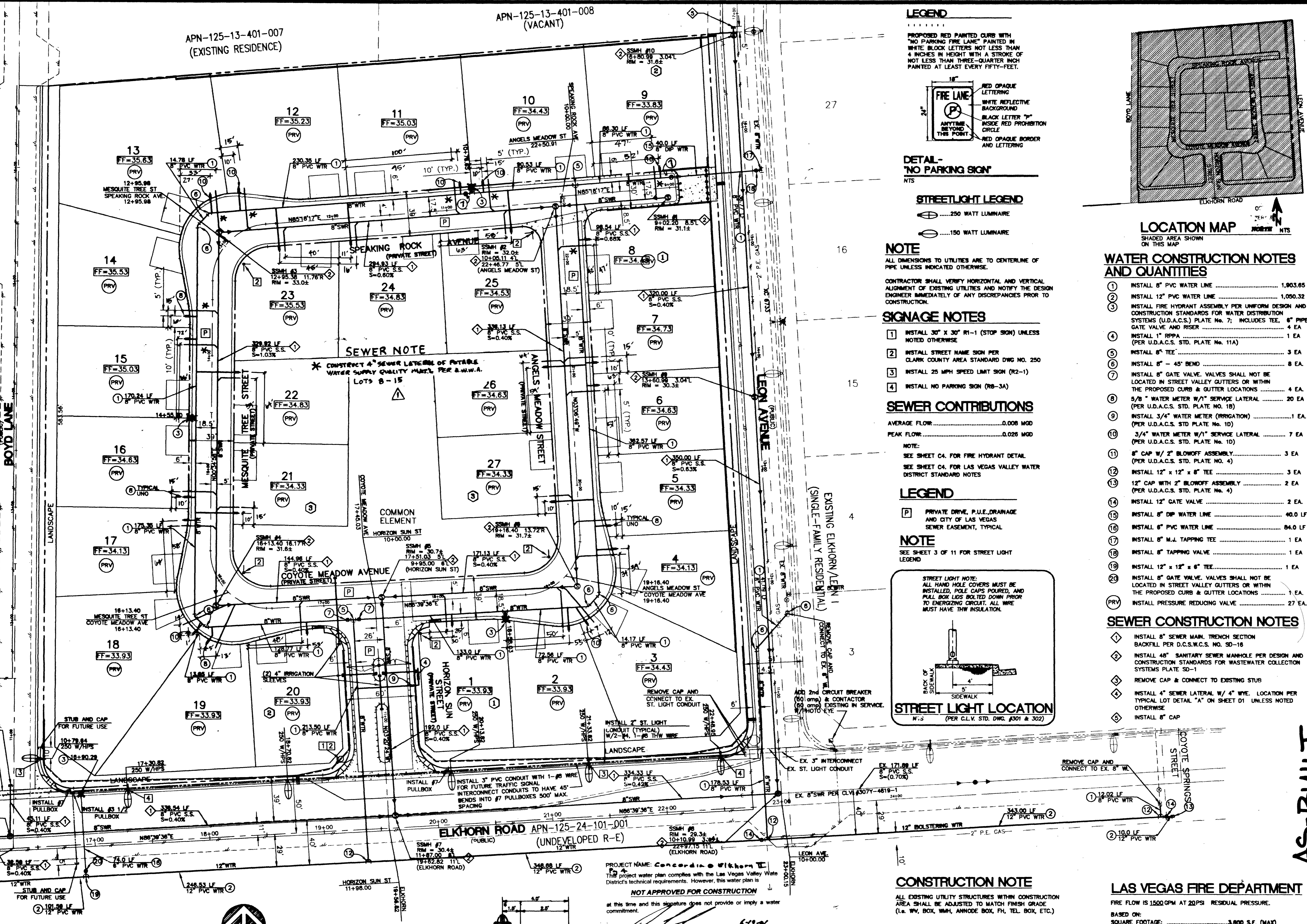

**NOTE**  
ALL DIMENSIONS TO UTILITIES ARE TO CENTERLINE OF PIPE UNLESS INDICATED OTHERWISE.

**CONTRACTOR SHALL VERIFY HORIZONTAL AND VERTICAL ALIGNMENT OF EXISTING UTILITIES AND NOTIFY THE DESIGN ENGINEER IMMEDIATELY OF ANY DISCREPANCIES PRIOR TO CONSTRUCTION.**

**SIGNAGE NOTES**  
1. INSTALL 30" X 30" R1-1 (STOP SIGN) UNLESS NOTED OTHERWISE  
2. INSTALL STREET NAME SIGN PER CLARK COUNTY AREA STANDARD DWG NO. 250  
3. INSTALL 25 MPH SPEED LIMIT SIGN (R2-1)  
4. INSTALL NO PARKING SIGN (R8-3A)

**SEWER CONTRIBUTIONS**  
AVERAGE FLOW: 0.008 MG/D  
PEAK FLOW: 0.026 MG/D

**NOTE:**  
SEE SHEET C4 FOR FIRE HYDRANT DETAIL  
SEE SHEET C4 FOR LAS VEGAS VALLEY WATER DISTRICT STANDARD NOTES

**LEGEND**  
P PRIVATE DRIVE, P.U.E., DRAINAGE AND CITY OF LAS VEGAS SEWER EASEMENT, TYPICAL

**NOTE**  
SEE SHEET 3 OF 11 FOR STREET LIGHT LEGEND

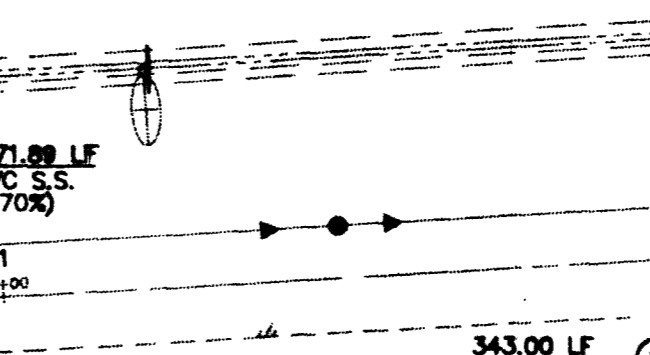
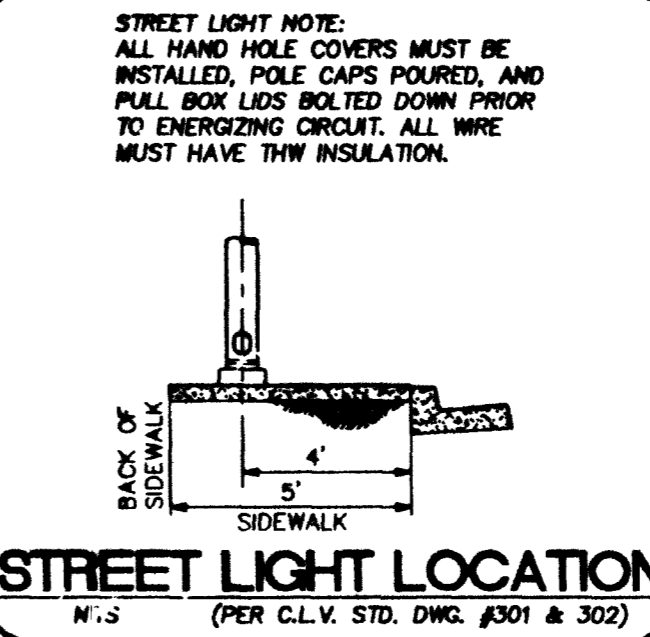
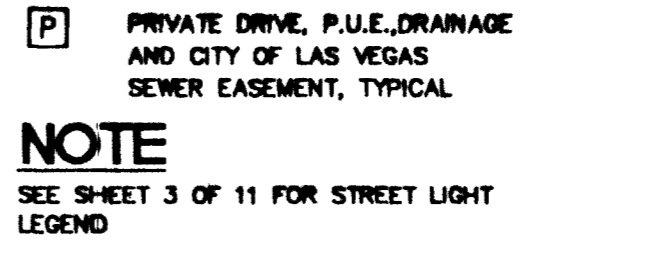

**CONSTRUCTION NOTE**  
ALL EXISTING UTILITY STRUCTURES WITHIN CONSTRUCTION AREA SHALL BE ADJUSTED TO MATCH FINISH GRADE (I.E. W.P. BOX, W.M., ANHODE BOX, P.H., TEL. BOX, ETC.)

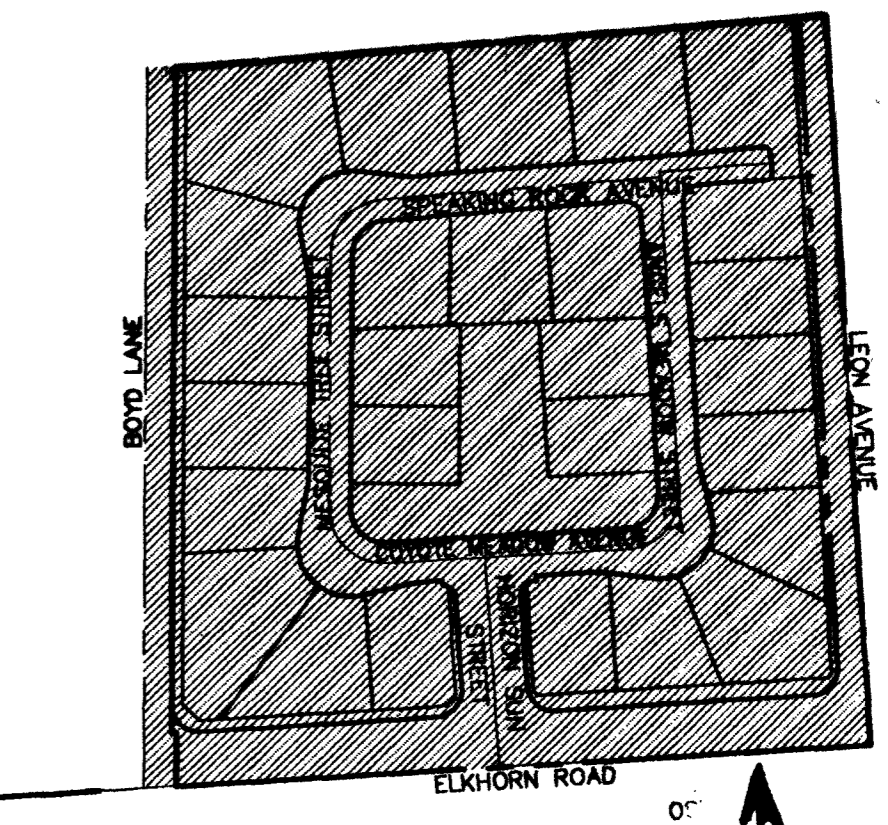

**LOCATION MAP**  
SHADDED AREA SHOWN ON THIS MAP

**WATER CONSTRUCTION NOTES AND QUANTITIES**

- 1. INSTALL 8" PVC WATER LINE ..... 1,903.65 LF
- 2. INSTALL 12" PVC WATER LINE ..... 1,050.32 LF
- 3. INSTALL FIRE HYDRANT ASSEMBLY PER UNIFORM DESIGN AND CONSTRUCTION STANDARDS FOR WATER DISTRIBUTION SYSTEMS (U.D.A.C.S.) PLATE No. 7, INCLUDES TEE, 6" PIPE, GATE VALVE AND RISER ..... 4 EA
- 4. INSTALL 1" RPPA (PER U.D.A.C.S. STD. PLATE No. 11A) ..... 1 EA
- 5. INSTALL 8" TEE ..... 3 EA
- 6. INSTALL 8" - 45° BEND ..... 8 EA
- 7. INSTALL 8" GATE VALVE. VALVES SHALL NOT BE LOCATED IN STREET VALLEY GUTTERS OR WITHIN THE PROPOSED CURB & GUTTER LOCATIONS ..... 4 EA
- 8. 5/8" WATER METER W/1" SERVICE LATERAL ..... 20 EA (PER U.D.A.C.S. STD. PLATE No. 18)
- 9. INSTALL 3/4" WATER METER (IRRIGATION) ..... 1 EA (PER U.D.A.C.S. STD. PLATE No. 10)
- 10. 3/4" WATER METER W/1" SERVICE LATERAL ..... 7 EA (PER U.D.A.C.S. STD. PLATE No. 10)
- 11. 8" CAP W/ 2" BLOWOFF ASSEMBLY ..... 3 EA (PER U.D.A.C.S. STD. PLATE No. 4)
- 12. INSTALL 12" x 12" x 8" TEE ..... 3 EA
- 13. 12" CAP WITH 2" BLOWOFF ASSEMBLY ..... 2 EA (PER U.D.A.C.S. STD. PLATE No. 4)
- 14. INSTALL 12" GATE VALVE ..... 2 EA
- 15. INSTALL 8" DIP WATER LINE ..... 40.0 LF
- 16. INSTALL 8" PVC WATER LINE ..... 84.0 LF
- 17. INSTALL 8" M.J. TAPPING TEE ..... 1 EA
- 18. INSTALL 8" TAPPING VALVE ..... 1 EA
- 19. INSTALL 12" x 12" x 8" TEE ..... 1 EA
- 20. INSTALL 8" GATE VALVE. VALVES SHALL NOT BE LOCATED IN STREET VALLEY GUTTERS OR WITHIN THE PROPOSED CURB & GUTTER LOCATIONS ..... 1 EA
- 21. INSTALL PRESSURE REDUCING VALVE ..... 27 EA

**SEWER CONSTRUCTION NOTES**

- 1. INSTALL 8" SEWER MAIN. TRENCH SECTION BACKFILL PER D.G.S.W.C.S. NO. S0-16
- 2. INSTALL 48" SANITARY SEWER MANHOLE PER DESIGN AND CONSTRUCTION STANDARDS FOR WASTEWATER COLLECTION SYSTEMS PLATE S0-1
- 3. REMOVE CAP & CONNECT TO EXISTING STUB
- 4. INSTALL 4" SEWER LATERAL W/ 4" WYE. LOCATION PER TYPICAL LOT DETAIL "A" ON SHEET D1 UNLESS NOTED OTHERWISE
- 5. INSTALL 8" CAP

**LAS VEGAS FIRE DEPARTMENT**  
FIRE FLOW IS 1500 GPM AT 20PSI RESIDUAL PRESSURE.

BASED ON:  
SQUARE FOOTAGE: 3,800 S.F. (MAX)  
BUILDING HEIGHT: 24' (MAX)  
NUMBER OF STORES: 2 (MAX)  
OCCUPANCY: SINGLE FAMILY  
FULL AUTOMATIC FIRE SPRINKLERS: NO

REVIEW BY: *[Signature]* DATE: 6/19/01

APPROVED FOR CONSTRUCTION

DATE: 7/17/01

**REDUCED PRESSURE PRINCIPLE ASSEMBLY, 1-1/2"**  
APPROVED REDUCED PRESSURE PRINCIPLE ASSEMBLY(S) SHALL BE INSTALLED PER THE UDACS PLATE NO. 11A. NO WATER SHALL BE TAKEN FROM A SERVICE REQUIRING BACKFLOW PREVENTION UNTIL THE REDUCED PRESSURE PRINCIPLE ASSEMBLY HAS BEEN SUCCESSFULLY TESTED BY THE LVWD. ANY BLOCK WALL OR OTHER FENCE MATERIAL SHALL BE DESIGNED AND CONSTRUCTED AROUND THE OUTSIDE OF THE EASEMENT(S) TO ALLOW THE DISTRICT DIRECT ACCESS FROM THE ADJACENT RIGHT-OF-WAY.

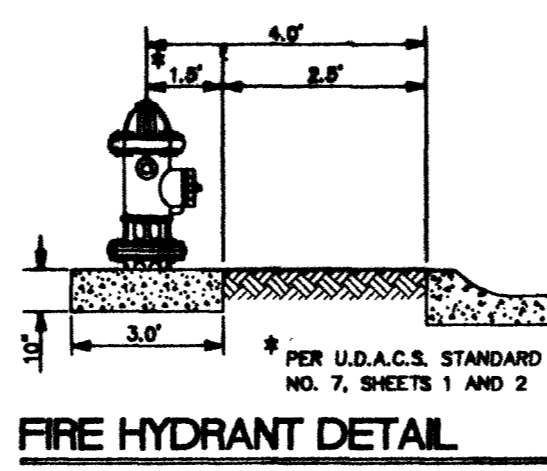
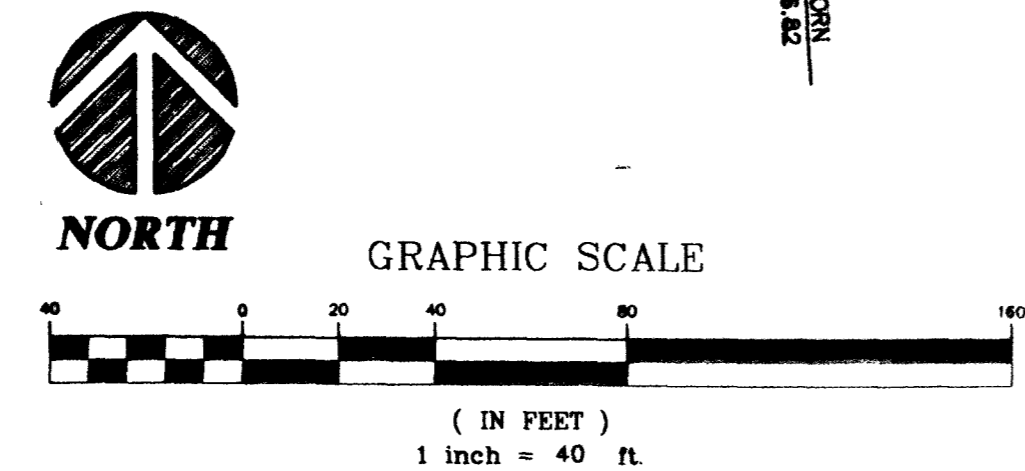

**BENCHMARK**  
BEING THE CITY OF NORTH LAS VEGAS BM, #518118 (11-V90-13E4), 50' WEST OF BLM BRASS CAP @ DECATUR BLVD. & FARM ROAD. ELEVATION = 707.9639 METERS = 2,322.71 FEET. (N.A.V.D. 1988) (ELEVATION BASED ON CITY OF LAS VEGAS VERTICAL DATUM)

**BASIS OF BEARING**  
BEING THE NORTH LINE OF THE LOT 83, AS IT IS SHOWN ON THE RECORD OF SURVEY IN FILE 52, OF SURVEYS, PAGE 70, OFFICIAL RECORDS OF CLARK COUNTY, NEVADA, WHICH BEARS: SOUTH 85°04'37" WEST.

SCALE: 1"=40'  
DRAWN BY: SSC  
CHECKED BY: SSC/JML  
PROJECT DATE: 03-2007  
JOB No. 01-9005-05  
PLOT DATE: 04-26-2007

CONCORDIA & ELKHORN/LEON  
CITY OF LAS VEGAS

MASTER UTILITY PLAN and  
STREET LIGHT INFORMATION

CONCORDIA HOMES

STATE OF NEVADA  
JAMES W. LELAND  
CIVIL ENGINEER  
No. 4532

6280 S. Valley View Blvd  
Suite 200  
Las Vegas, NV 89118  
Tel: (702) 986-5008  
Fax: (702) 986-0047

AS-BUILT

CONSULTANTS, INC.  
ENGINEERING · PLANNING · LAND SURVEYING

SHEET  
U1  
4 OF 11

AGENCY DWG. NO.  
307Y-4674