

**SAFETY ALERT**  
**Call before you Overhead**  
 593-6111  
 OVERHEAD SERVICE ALERT

**Call before you Dig**  
 1-800-227-2600  
 UNDERGROUND SERVICE ALERT

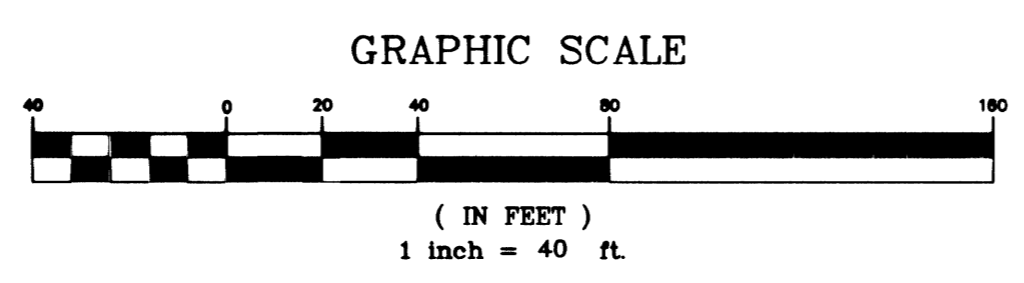
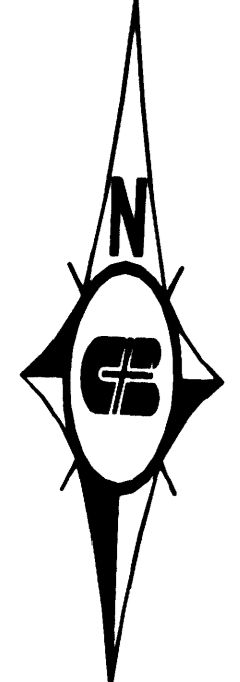

**BENCHMARK**  
 CITY OF LAS VEGAS BENCHMARK #23 1LV9025N4 BEING AN ALCAP ON REBAR AT THE CENTERLINE INTERSECTION OF CENTENNIAL PKWY. AND BRADLEY ROAD.  
 NAVD88 ELEVATION: 2302.77' = 701.8865 METERS

**BASIS OF BEARING**  
 NORTH 88°46'05" EAST BEING THE CENTERLINE OF AZURE DRIVE AS SHOWN ON RECORDS OF SURVEY FILE 52 PAGE 70 AND FILE 90 PAGE 44 IN THE OFFICE OF THE COUNTY RECORDER, CLARK COUNTY NEVADA.

**ESTIMATED QUANTITIES**  
 NOTE: SEE SHEET 5 FOR QUANTITIES

(UNDEVELOPED) APN 125-25-101-018

LOT#	DRIVEWAY C.L.	SEWER LATERAL	WATER LATERAL
NOTE: SEE SHEET 5 FOR STATIONING			

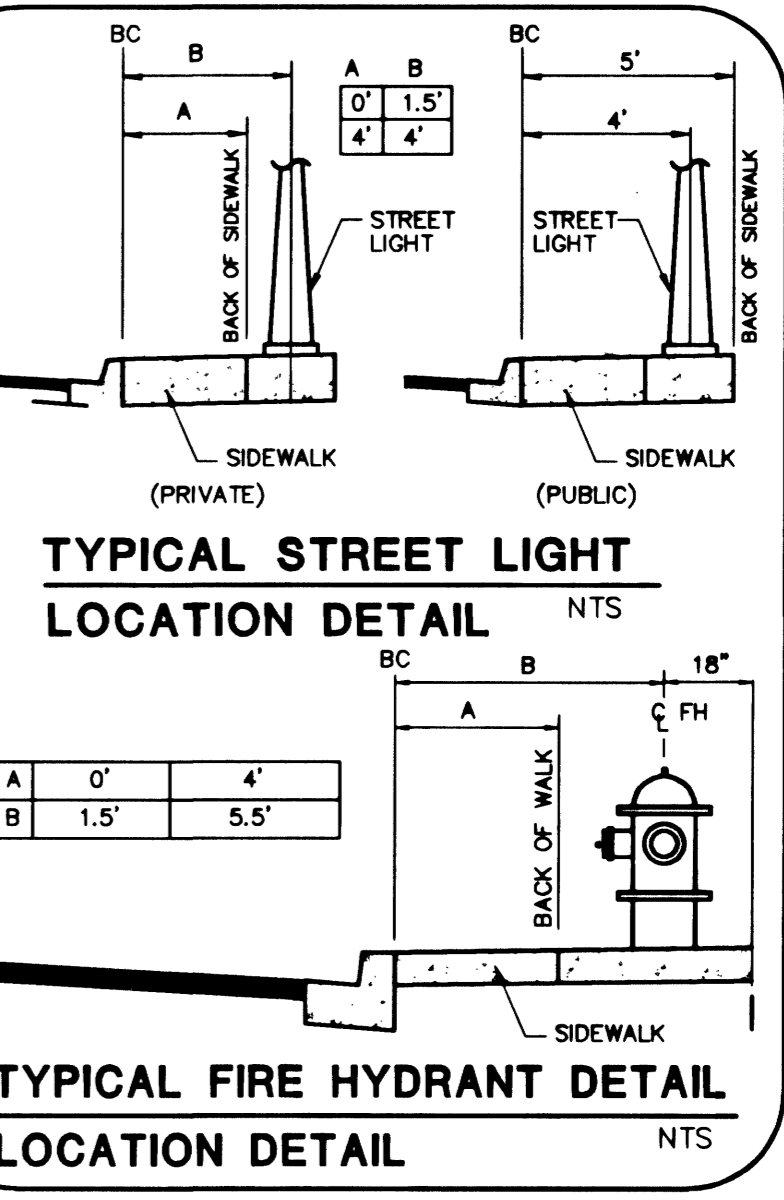
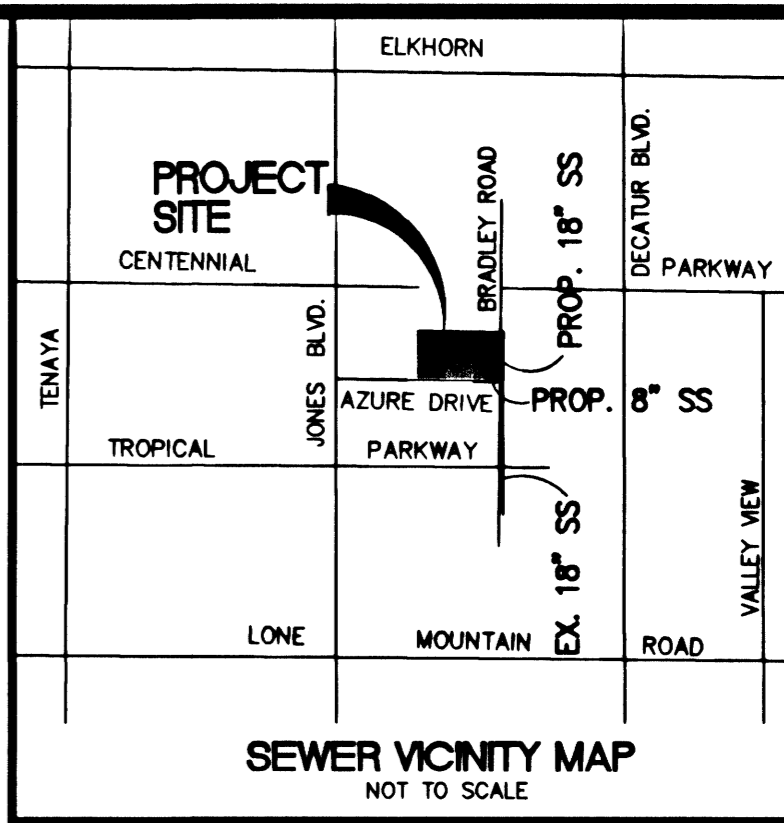

**RECORD DRAWING**  
 THESE RECORD DRAWINGS HAVE BEEN PREPARED BASED ON INFORMATION PROVIDED BY OTHERS. THE ENGINEER HAS NOT VERIFIED THE ACCURACY OF SUCH INFORMATION AND SHALL NOT BE RESPONSIBLE FOR ANY ERRORS OR OMISSIONS WHICH MAY BE INCORPORATED HEREIN AS A RESULT

**MATERIAL NOTES**  
 1. ALL SEWER LINES MADE OF SDR35 PVC. JM MANUFACTURER

**(1) 1 1/2" REDUCED PRESSURE PRINCIPLE ASSEMBLY**  
 APPROVED REDUCED PRESSURE PRINCIPLE ASSEMBLY(S) SHALL BE INSTALLED PER THE UDACS PLATE NO. 11A. NO WATER SHALL BE TAKEN FROM A SERVICE REQUIRING BACKFLOW PREVENTION UNTIL THE REDUCED PRESSURE PRINCIPLE ASSEMBLY HAS BEEN SUCCESSFULLY TESTED BY THE LVWD.  
 ANY BLOCK WALL OR OTHER FENCE MATERIAL SHALL BE DESIGNED AND CONSTRUCTED AROUND THE OUTSIDE OF THE EASEMENT(S) TO ALLOW DISTRICT DIRECT ACCESS FROM THE ADJACENT RIGHT-OF-WAY.

**EASEMENT NOTE:**  
 ALL STREETS HERE ARE DESIGNATED AS PRIVATE STREETS, PUBLIC UTILITY EASEMENTS, PUBLIC SEWER EASEMENTS PUBLIC DRAINAGE EASEMENTS TO BE PRIVATELY MAINTAINED UNLESS OTHERWISE NOTED. SEE FINAL MAP OF EAGLE CREEK II - PHASE 1

**FIRE HYDRANT INSTALLATION**  
 FIRE HYDRANT(S) TO BE INSTALLED IN ACCORDANCE WITH THE UDACS STANDARD PLATE NO. 7

**APPROVALS**  
 APPROVAL OF THESE PLANS SHALL NOT BE CONSTRUED TO BE A PERMIT FOR OR AN APPROVAL OF ANY VIOLATION OF ANY OF THE PROVISIONS OF THE STATE OR COUNTY LAWS. G.P.M.  
 CLV FIRE DEPARTMENT DATE \_\_\_\_\_  
 LAS VEGAS VALLEY WATER DISTRICT DATE \_\_\_\_\_

**FUTURE LATERAL LOCATIONS**

LOT#	DRIVEWAY C.L.	SEWER LATERAL	WATER LATERAL
75	7+32.56	7+12.84	7+18.84
76	7+95.93	7+54.56	7+60.56
77	8+25.93	8+42.15	8+48.15
78	8+84.78	8+82.15	8+88.15
79	9+14.78	9+37.81	9+43.81
80	9+74.84	9+51.81	9+57.81
81	10+04.84	10+28.34	10+22.34
82	10+66.18	10+42.34	10+48.34
83	10+84.27	10+62.23	10+68.23
84	10+28.18	10+43.23	10+49.23
85	9+96.18	9+73.18	9+79.18
86	9+36.12	9+53.18	9+59.18
87	9+06.12	8+83.05	8+89.05
88	8+45.02	8+63.05	8+69.05
89	8+15.02	7+95.99	7+89.99
90	7+52.88	7+76.99	7+70.99
91	7+02.39	7+02.39	7+08.39
92	14+58.07	14+43.25	14+37.25
93	14+88.07	15+08.97	15+02.97
94	15+34.40	15+49.36	15+55.36
95	13+63.64	11+25.95	14+31.95
96	13+93.64	14+10.83	14+04.83
97	14+42.21	14+30.83	14+24.83
98	14+73.21	14+89.64	14+83.64
99	15+28.19	15+09.84	15+03.84
100	15+35.3	15+10.09	15+04.09
101	14+59.75	14+90.09	14+84.09
102	14+29.75	13+99.48	14+05.77
103	13+61.64	13+85.48	13+79.48
104	13+31.64	13+13.70	13+07.70
105	12+85.70	12+72.03	12+66.03
106	17+32.60	17+31.08	17+25.08
107	17+80.80	17+83.90	17+77.90
108	18+22.54	18+08.35	18+02.35
109	18+07.14	18+27.22	18+21.22
110	17+51.71	17+40.48	17+34.48
111	16+95.71	16+80.83	16+74.83
112	16+32.47	16+53.68	16+47.68
113	16+02.47	15+88.56	15+82.56
114	15+43.28	15+67.88	15+61.88
115	15+13.28	14+94.81	14+88.81
116	14+55.12	14+68.48	14+62.48
117	14+25.12	14+05.54	14+00.54
118	13+78.54	13+78.54	13+72.54
119	13+34.54	13+14.05	13+08.05
120	12+72.33	12+93.47	12+87.47
121	12+23.93	12+23.93	12+17.93
122	11+89.81	12+03.78	12+07.78
123	11+59.81	11+39.82	11+43.82
124	11+01.00	11+15.00	11+21.00
125	10+71.00	10+51.00	10+57.00

**FIRE FLOW DATA**  
 FIRE FLOW REQUIREMENT IS 1500 GALLONS PER MINUTE AT 20 P.S.I. (POUNDS PER SQUARE INCH) RESIDUAL.  
 BASED ON SQUARE FOOTAGE AREA 1775  
 LARGEST AREA BETWEEN AREA SEPARATION N/A  
 HEIGHT ONE STORY  
 TYPE OF CONSTRUCTION SN  
 EXPOSURES 10' MIN.  
 SPRINKLER SYSTEM NONE  
 OCCUPANCY SINGLE FAMILY  
 ROOF CONSTRUCTION TILE

NO.	DATE	BY	REVISION

**Pulte Homes**  
 An American Favorite

**Carter Burgess**  
 6655 Bermuda Road  
 Las Vegas, NV 89119  
 (702) 938-5400 Fax: (702) 938-5454

**UTILITY PLAN OFF SITE SEWER**

**EAGLE CREEK II PHASE 1**

DESIGNED BY: [Signature]  
 CHECKED BY: [Signature]  
 PROJECT NO: 15-07-100-100-100  
 SCALE: 1"=40' HORIZ. VERT. NONE  
 SHEET 6 OF 19 SHEETS  
 DRAWING NO. 3074-4614-1

43417

AS-BUILT

L:\981919\DesignPH1\8189-05U-AS-BUILTS.DWG CITY OF LAS VEGAS