

NOTE:
EXISTING SEWER INFORMATION PER ELKHORN PONDEROSA II PLANS CITY OF LAS VEGAS PLANS NO. 307885

DEER SPRINGS WAY PLAN
SCALE: H 1"=30' V: 1"=3'

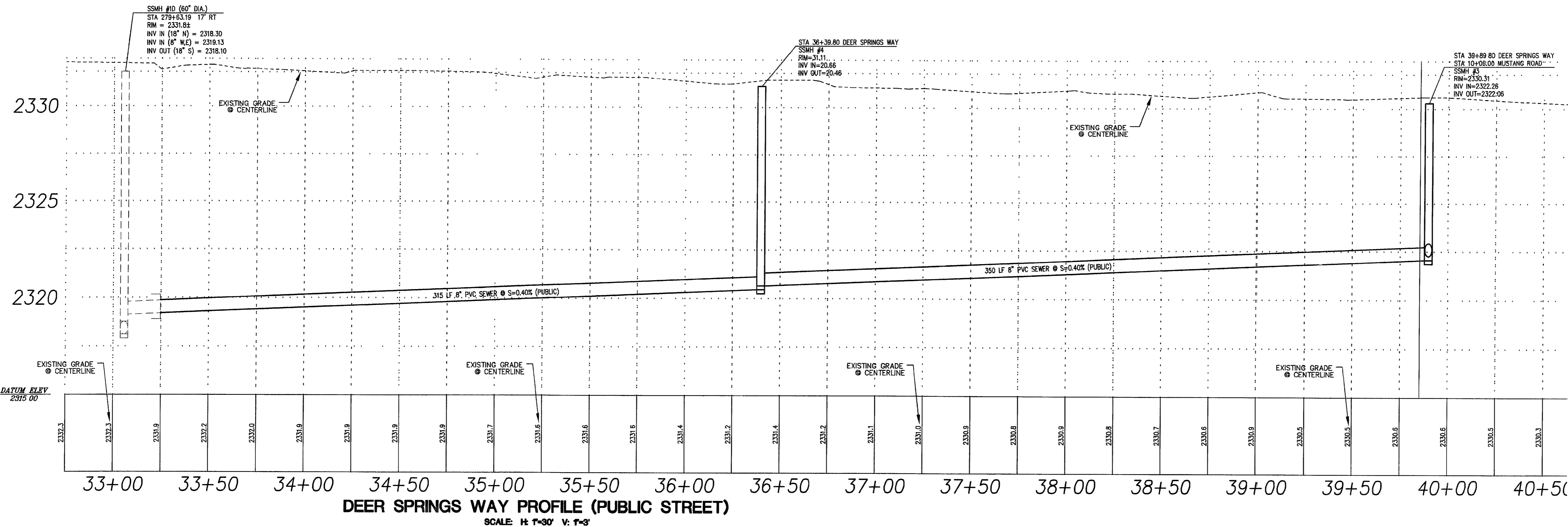

DEER SPRINGS WAY PROFILE (PUBLIC STREET)
SCALE: H 1"=30' V: 1"=3'

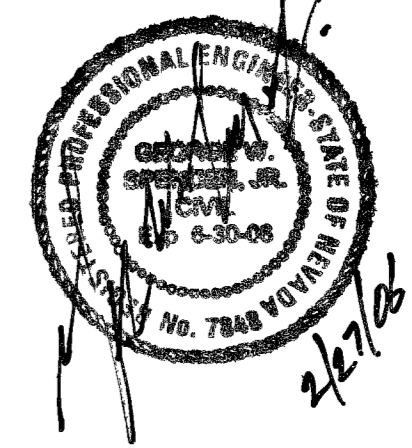

CLARK COUNTY
DEPARTMENT OF DEVELOPMENT
SERVICES
Acceptance of plans for filing
By: _____
Acceptance of these plans for filing shall not be construed to be a permit for or an approval of any violation of any of the provisions of the state or county laws and/or specifications. Clark County shall be held free from damages which may result from the construction of the improvements from the engineering design depicted herein.
Note: Power poles and/or other existing facilities not in proper location based on proposed improvements shown herein will be relocated at no expense to Clark County.

APPROVALS

COUNTY OF CLARK FIRE DEPARTMENT APPROVED _____ DATE _____
Approval of these plans shall not be construed to be a permit for, or an approval of, any violation of any provisions of the state or county laws. Fire flow: _____ GPM at 20 P.S.I. residual.

NOTE
CONTRACTOR SHALL FIELD VERIFY DEPTH OF GAS LINE PRIOR TO CONSTRUCTION

BASIS OF BEARINGS

THE BASIS OF BEARINGS FOR THIS SURVEY IS THE NORTH LINE OF THE NORTHWEST ONE-QUARTER OF SECTION 23, TOWNSHIP 19 SOUTH, RANGE 60 EAST, M.D.M. WHICH BEARS NORTH 89°32'55" EAST AS SHOWN IN THE OFFICE OF THE CLARK COUNTY, NEVADA RECORDER IN FILE 86 OF SURVEYS ON PAGE 86.

BENCHMARK

ELEVATION = 2332.78 feet (NAVD 88 datum)
(711.033 meters)
CLARK COUNTY BENCHMARK #18 SLV80 2304 CITY OF LAS VEGAS RIVET AND ROUND PLATE IN CONCRETE CYLINDER, NORTHWEST CORNER OF DEER SPRINGS WAY AND TORREY PINES DRIVE.

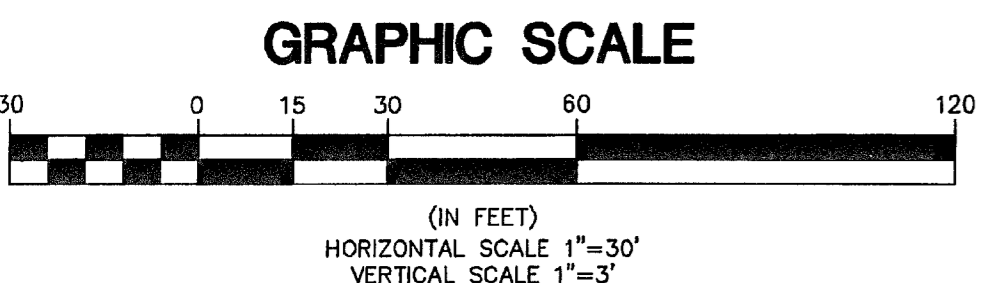

WATER CONST. NOTES

- ① REMOVE CAP & B.O., CONNECT INTO EX. 10" W.L. STUB PER UDACS PLATE NO. 4A
- ② INSTALL 8" GATE VALVE PER UDACS PLATE #2. VALVES SHALL NOT BE LOCATED IN STREET VALLEY GUTTERS
- ③ INSTALL CAP & 2" BLOWOFF ASSEMBLY PER UDACS PLATE NO. 4A
- ④ INSTALL 8" TEE
- ⑤ INSTALL 8" X 6" TEE
- ⑥ INSTALL FIRE HYDRANT ASSEMBLY PER UNIFORM DESIGN AND CONSTRUCTION STANDARDS FOR WATER DISTRIBUTION SYSTEMS (UDS) PLATE NO. 7, AND THE LOCATION SHALL BE DETERMINED BY USD 516
- ⑦ INSTALL 8" X 6" REDUCER
- ⑧ INSTALL 1" LATERAL & 3/4" METER PER UDACS PLATE 10
- ⑨ INSTALL 10" X 8" REDUCER

SEWER CONST. NOTES

- ① INSTALL 48" SSMH PER CCWRD STD DWG # SD-1
- ② INSTALL 8" PVC SEWER MAIN PER SD-16A
- ③ INSTALL 6" SEWER LATERAL FOR SERVICE AT S=2.0% PER SD-17
- ④ TRENCH 6' WIDE AND REPAVE 12' WIDE AC PATCH PER CC STD DWG #503 WITH 3" AC OVER 6" TYPE II AGG. BASE, MATCH EX. EDGE OF AC TO C/L OF STREET

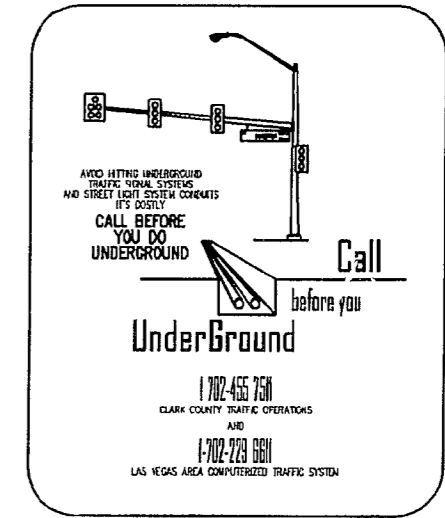
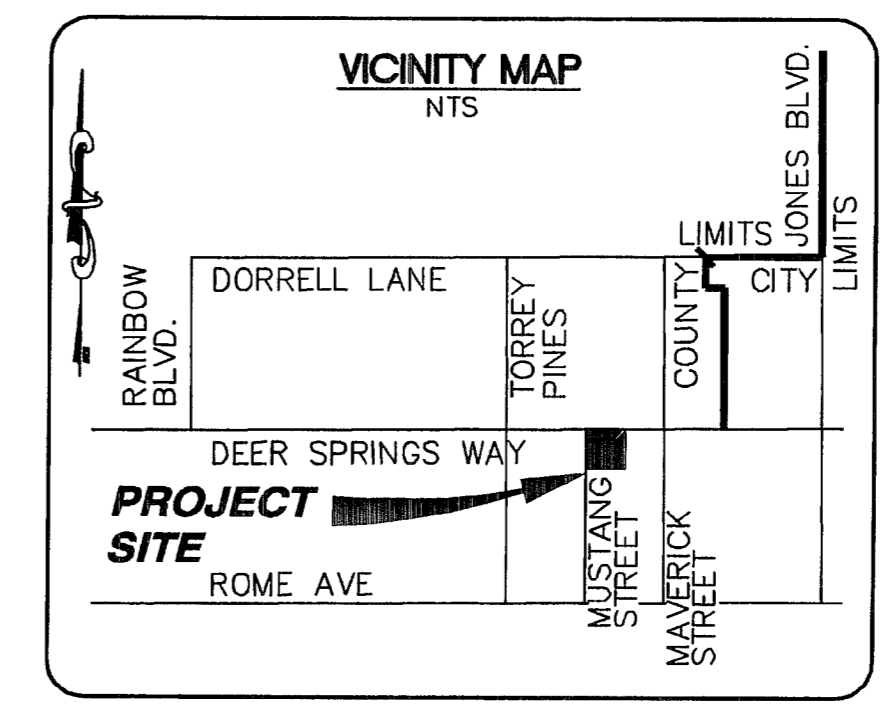

CALL BEFORE YOU OVERHEAD
1-702-593-6111
NEVADA POWER DEPARTMENT AND SHEET SERVICES DEPARTMENT

NOTICE!
EXISTING UTILITIES ARE SHOWN ON PLANS FOR THE CONVIENIENCE OF THE CONTRACTOR ONLY. THE CONTRACTOR IS RESPONSIBLE FOR THE PROTECTION OF ALL UTILITIES. THE ENGINEER BEARS NO RESPONSIBILITY FOR UTILITIES NOT SHOWN OR SHOWN INCORRECTLY.

AVOID CUTTING UNDERGROUND UTILITIES. IT'S COSTLY!
Call BEFORE YOU Dig
1-800-227-2600
NEVADA POWER DEPARTMENT AND SHEET SERVICES DEPARTMENT

REV	DATE	BY	REVISION

DR HORTON INC.
6645 ESCONDIDO BLDG 6 STE 105
LAS VEGAS, NV 89119
(702) 435-4888
ALPHA
ENGINEERING COMPANY
3321 N. Buffalo Dr., Ste. 200
Las Vegas, NV 89129
Telephone: (702) 877-1300 Fax: (702) 877-0300

ELKHORN PONDEROSA III
PLAN AND PROFILE DEER SPRINGS WAY SEWER EXTENSION

DRAWN BY: _____
DESIGNED BY: _____
CHECKED BY: _____
PROJECT NO: 410166
SCALE: 1"=30'

SHEET **PP2**
7 OF 8 SHEETS
DRAWING NO **HTE #05-24198**
CLV # 3074953-3