

**NOTE:**  
EXISTING SEWER INFORMATION PER ELKHORN PONDEROSA II PLANS CITY OF LAS VEGAS PLANS NO. 307V995

**DEER SPRINGS WAY PLAN**  
SCALE: H 1"=30' V 1"=3'

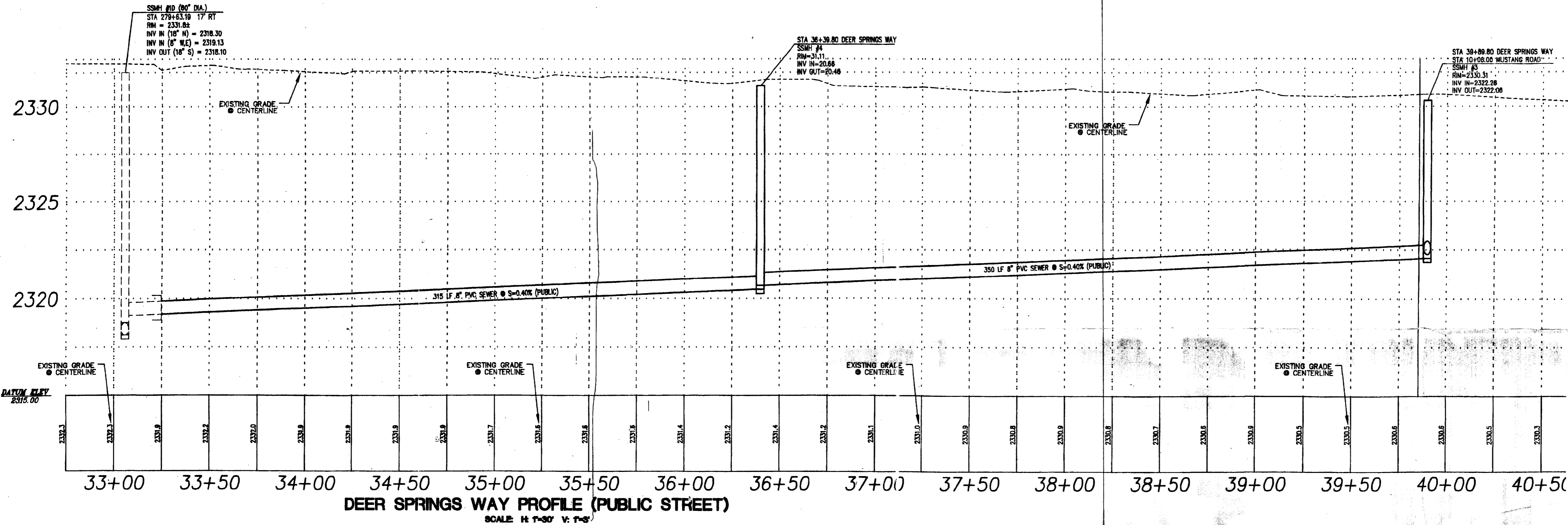

**DEER SPRINGS WAY PROFILE (PUBLIC STREET)**  
SCALE: H 1"=30' V 1"=3'

**ASBUILT**

**BASIS OF BEARINGS**

THE BASIS OF BEARINGS FOR THIS SURVEY IS THE NORTH LINE OF THE NORTHWEST ONE-QUARTER OF SECTION 23, TOWNSHIP 19 SOUTH, RANGE 60 EAST, M.D.M. WHICH BEARS NORTH 89°32'35" EAST AS SHOWN IN THE OFFICE OF THE CLARK COUNTY, NEVADA RECORDER IN FILE 86 OF SURVEYS ON PAGE 96.

8" SDR 35	DIAMOND PLASTIC	
MANHOLE	ROCKWAY	

**BENCHMARK**

ELEVATION = 2332.78 feet (NAVD 88 datum) (711.033 meters)  
CLARK COUNTY BENCHMARK #18 SLV90 2304 CITY OF LAS VEGAS RISET AND ROUND PLATE IN CONCRETE CYLINDER, NORTHWEST CORNER OF DEER SPRINGS WAY AND TORREY PINES DRIVE.

**NOTE**

CONTRACTOR SHALL FIELD VERIFY DEPTH OF GAS LINE PRIOR TO CONSTRUCTION

**GRAPHIC SCALE**

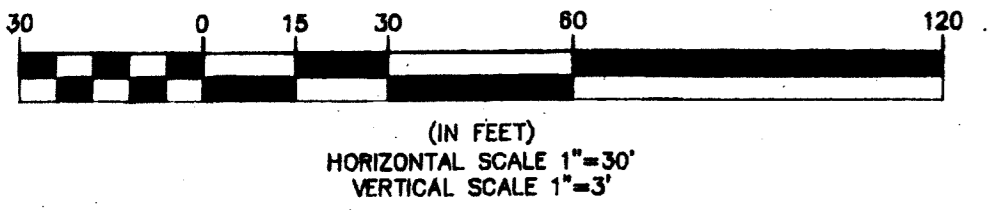

**WATER CONST. NOTES**

- ① REMOVE CAP & B.O., CONNECT INTO EX. 10" WL STUB PER UDACS PLATE NO. 4A 3 EA
- ② INSTALL 6" GATE VALVE PER UDACS PLATE NO. 4A. VALVES SHALL NOT BE LOCATED IN STREET VALLEY CUTTERS 1 EA
- ③ INSTALL CAP & 2" BLOWOFF ASSEMBLY PER UDACS PLATE NO. 4A 1 EA
- ④ INSTALL 6" TEE 1 EA
- ⑤ INSTALL 6" x 6" TEE 2 EA
- ⑥ INSTALL FIRE HYDRANT ASSEMBLY PER UNIFORM DESIGN AND CONSTRUCTION STANDARDS FOR WATER DISTRIBUTION SYSTEMS (UDS) PLATE No. 7, AND THE LOCATION SHALL BE DETERMINED BY USD 516 2 EA
- ⑦ INSTALL 6" x 6" REDUCER 1 EA
- ⑧ INSTALL 1" LATERAL & 3/4" METER PER UDACS PLATE 10 4 EA
- ⑨ INSTALL 10" x 6" REDUCER 1 EA

**SEWER CONST. NOTES**

- ◇ INSTALL 48" SSMH PER CCWWD STD DWG # 30-1 4 EA
- ◇ INSTALL 6" PVC SEWER MAIN PER 30-16A 1038 LF
- ◇ INSTALL 6" SEWER LATERAL FOR SERVICE AT S=2.0% PER 30-17 174 LF
- ◇ TRENCH 6" WIDE AND REPAVE 12" WIDE AC PATCH PER CC STD DWG #503 WITH 3" AC OVER 6" TYPE II AGG. BASE, MATCH EX. EDGE OF AC TO C/A OF STREET.

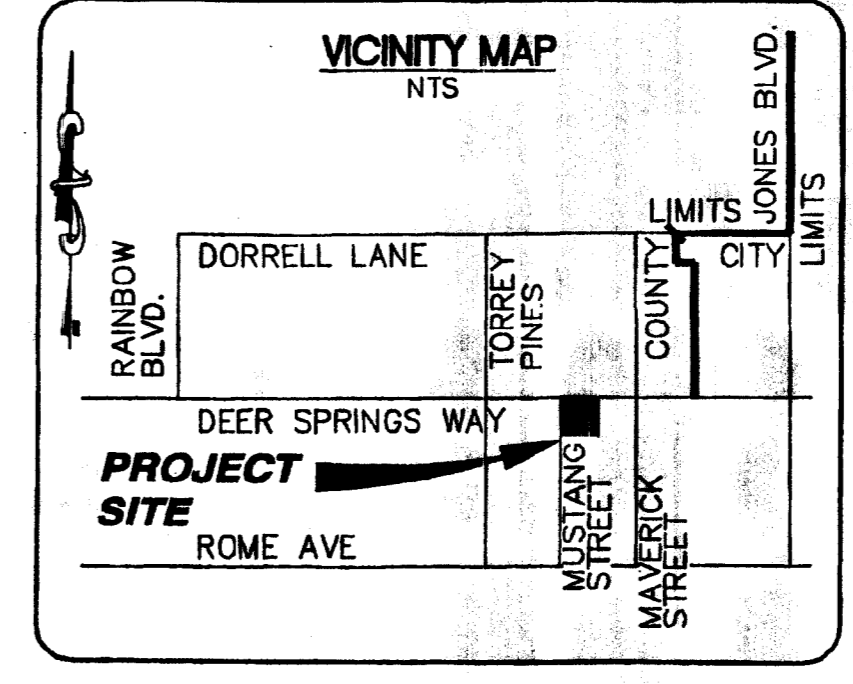

CLARK COUNTY  
DEPARTMENT OF DEVELOPMENT SERVICES  
Acceptance of plans for filing  
By: *May 14 2006*  
Acceptance of these plans for filing shall not be construed to be a permit for or an approval of any violation of any of the provisions of the state or county laws and/or specifications. Clark County shall be held free from damages which may result from the construction of the improvements from the engineering design depicted herein.  
Note: Power poles and/or other existing facilities not in proper location based on proposed improvements shown hereon will be relocated at no expense to Clark County.

**CALL BEFORE YOU OVERHEAD**  
1-702-593-6111  
NEVADA POWER DEPARTMENT AND SAFETY SERVICES DEPARTMENT

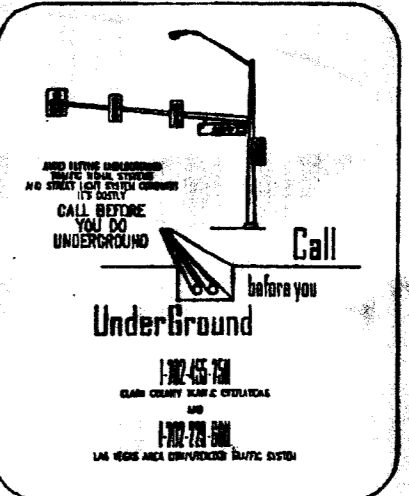

**NOTICE!**  
EXISTING UTILITIES ARE SHOWN ON PLANS FOR THE CONVEYANCE OF THE CONTRACTOR ONLY. THE CONTRACTOR IS RESPONSIBLE FOR THE PROTECTION OF ALL UTILITIES. THE ENGINEER BEARS NO RESPONSIBILITY FOR UTILITIES NOT SHOWN OR SHOWN INCORRECTLY.  
**Call Before You Dig**  
1-800-227-2600  
UNDERGROUND SERVICE DATA

**DR HORTON, INC.**  
6845 ESCONDIDO BLDG 6, STE105  
LAS VEGAS, NV, 89119  
(702) 435-4888

**ENGINEERING COMPANY**  
3321 N. Buffalo Dr., Ste. 200  
Las Vegas, NV 89115  
Telephone: (702) 872-1300 Fax: (702) 877-0300

**ALPHA &**

**ELKHORN PONDEROSA III**

**PLAN AND PROFILE DEER SPRINGS WAY SEWER EXTENSION**

SHEET: 06/06/05  
DESIGNED BY: 06/06/05  
CHECKED BY: 06/06/05  
PROJECT NO: 410166  
SCALE: 1"=30'

**PP2**  
7 OF 8 SHEETS  
DRAWING NO.  
**HTE #05-24198**

105380

307V255-3