

UTILITY NOTE

UTILITY LOCATION SHOWN HEREON ARE APPROXIMATE ONLY. IT SHALL BE THE CONTRACTORS RESPONSIBILITY TO DETERMINE THE EXACT VERTICAL AND HORIZONTAL LOCATION OF ALL EXISTING UNDERGROUND UTILITIES PRIOR TO COMMENCING CONSTRUCTION. NO REPRESENTATION IS MADE THAT ALL EXISTING UTILITIES ARE SHOWN HEREON. THE ENGINEER ASSUMES NO RESPONSIBILITY FOR UTILITIES NOT SHOWN OR UTILITIES NOT SHOWN IN THEIR PROPER LOCATION.

Call before you dig
1-800-227-2600

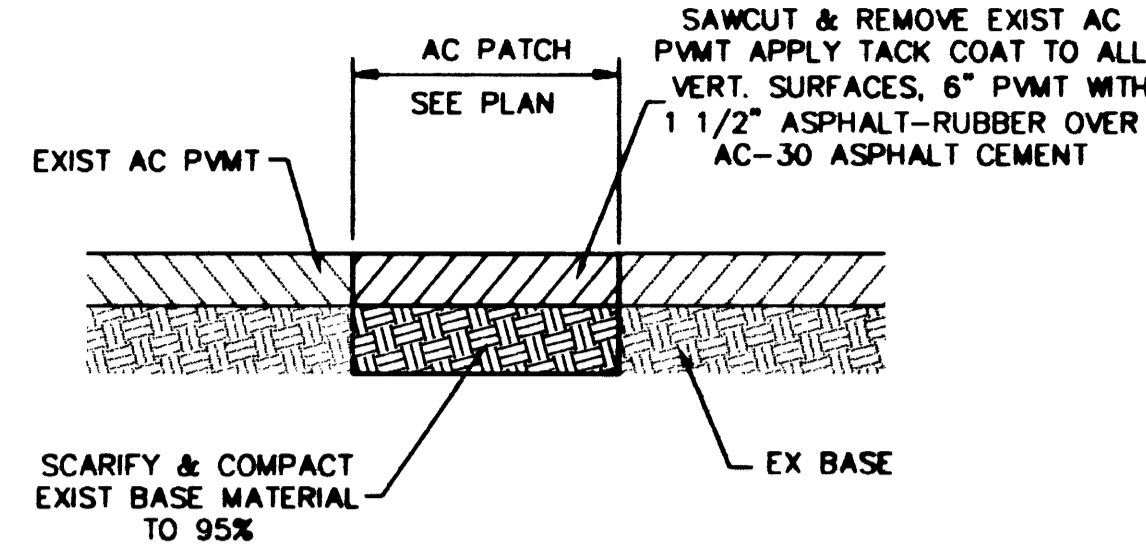

PAVEMENT PATCH
NO SCALE

BASIS OF BEARINGS:

N 00°41'40" W - EAST LINE OF THE NORTH EAST QUARTER OF SECTION 25, TOWNSHIP 20 SOUTH, RANGE 60 EAST, M.D.M., CLARK COUNTY, NEVADA, BEING THE CENTERLINE OF DECATUR BOULEVARD, AS SHOWN ON THE FINAL MAP OF GOLFRIDGE TERRACE UNIT NO. 1, RECORDED IN BOOK 5, PAGE 55 OF CLARK COUNTY, NEVADA, RECORDER'S OFFICE.

BENCHMARK:

CLV BM 1LV0130W4 - RIVET & PLATE IN TOP OF CURB AT THE SOUTHEAST RETURN OF WASHINGTON AVENUE AND DECATUR BOULEVARD. ELEVATION = 2202.70 FEET (NAVD88)

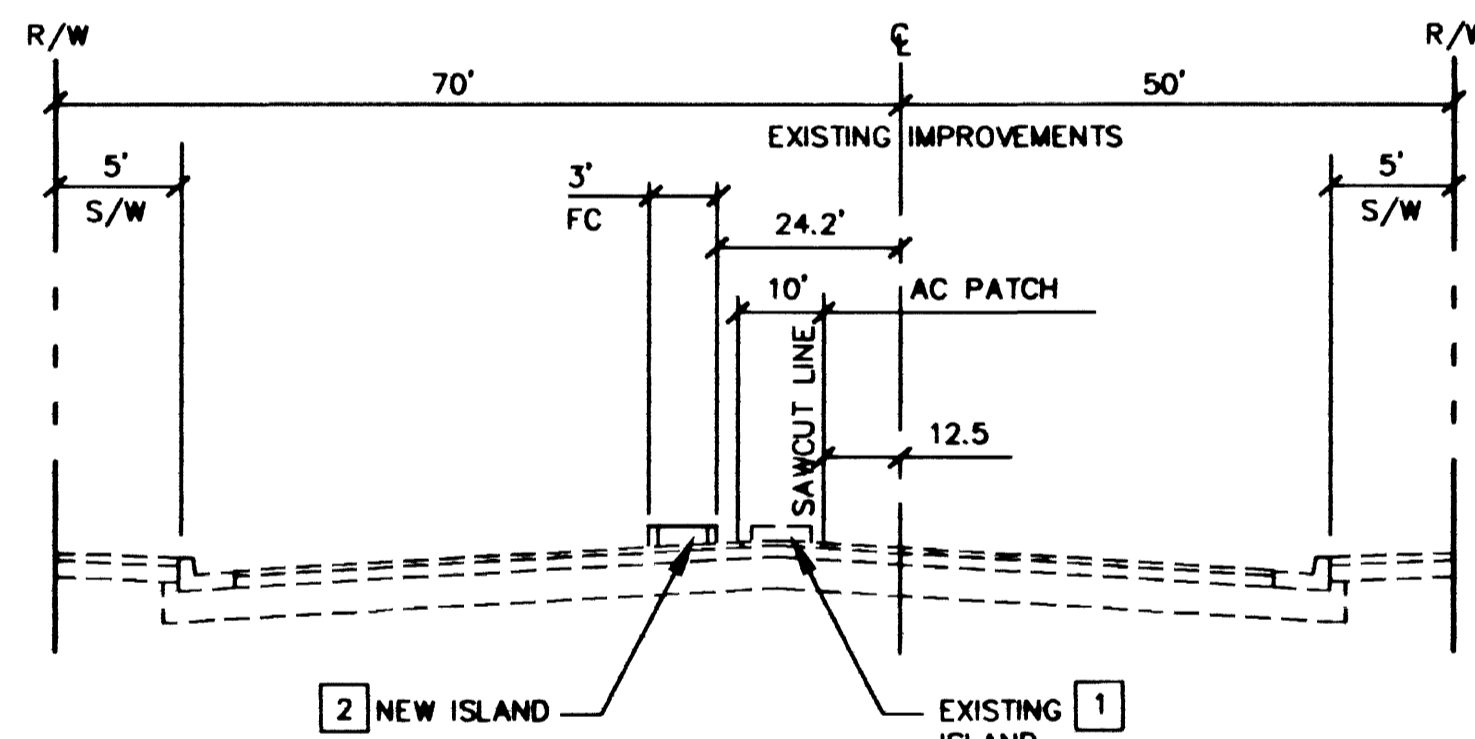
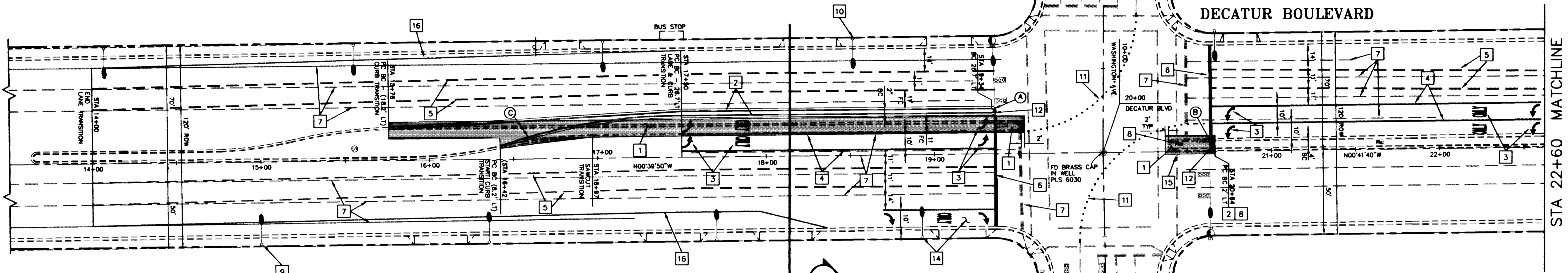
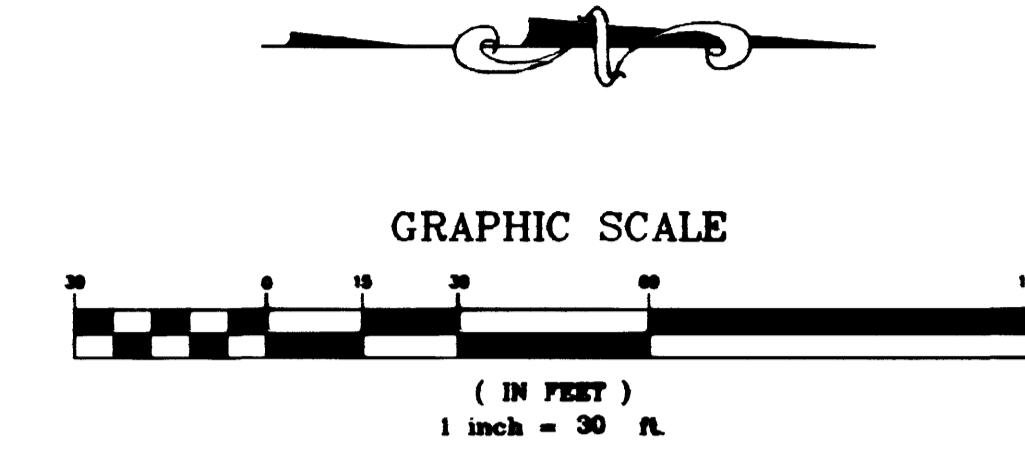

SECTION "A"
NO SCALE

BACK OF CURB CURVE DATA

CURVE	RADIUS	LENGTH	TAN	DELTA
(A)	1.00'	3.14'	∞	180°00'00"
(B)	2.00'	6.28'	∞	180°00'00"
(C)	330.00'	109.86'	55.44'	19°04'27"

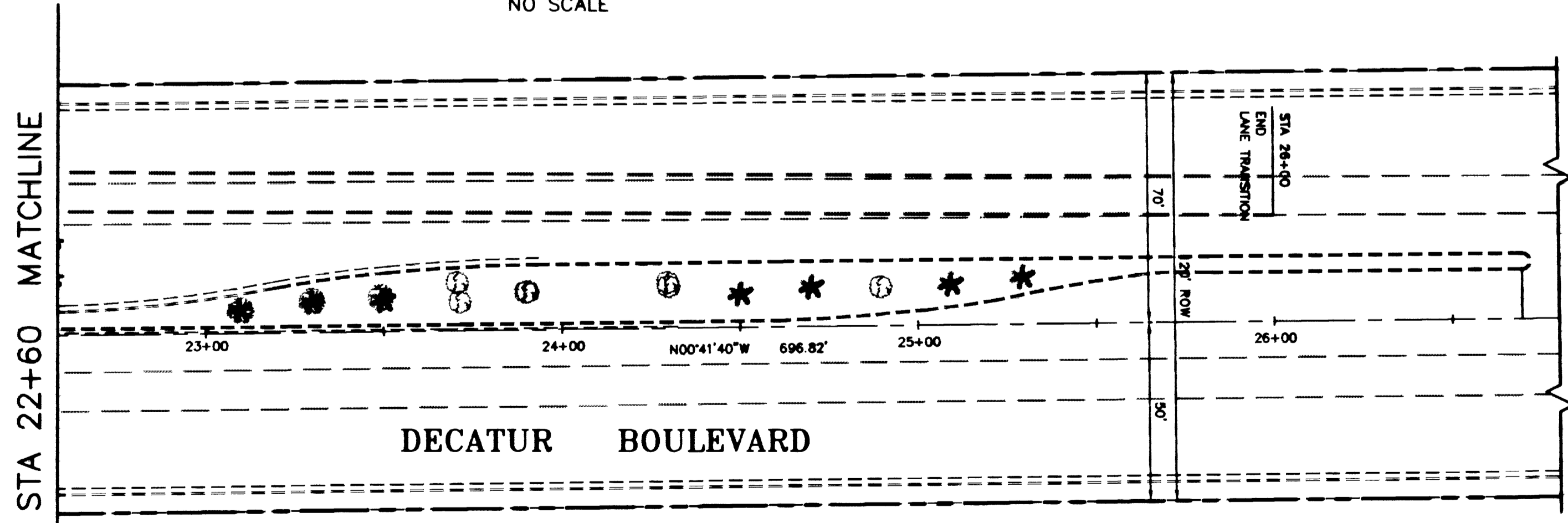

DECATUR BOULEVARD

CONSTRUCTION NOTES

- REMOVE EXISTING MEDIAN ISLAND TO LIMITS SHOWN ON PLANS AND CONSTRUCT AC PAVEMENT PER DETAIL THIS SHEET. MATCH EXISTING.
- CONSTRUCT PORTLAND CEMENT CONCRETE MEDIAN ISLAND PER U.S.D. No. 218. WITH "L" TYPE ISLAND CURB PER U.S.D. No. 219. SEE PLAN FOR LOCATION. MATCH EXISTING.
- INSTALL TYPE I WHITE COLD POLYMER FILM "ONLY" AND ARROW SYMBOL MARKING PER U.S.D. No. 246.
- INSTALL ADDED TURN LANE PAVEMENT MARKERS PER U.S.D. No. 246.
- INSTALL LANE LINE DELINEATION PAVEMENT MARKERS PER U.S.D. No. 244A.
- INSTALL TYPE I WHITE COLD POLYMER FILM 24" WIDE STOPBAR.
- REMOVE PAVEMENT MARKERS AS NEEDED.
- REMOVE EXISTING PULLBOX, MAKE A CONTINUOUS CONDUIT RUN AND REPULL WIRE.
- INSTALL TRAFFIC SIGN R7-11 AT LOCATION SHOWN PER U.S.D. No. 249.
- INSTALL TRAFFIC SIGN R8-3A AT LOCATION SHOWN PER U.S.D. No. 249.
- INSTALL "CAT TRACKS" PAVEMENT MARKERS (R=70').
- INSTALL MEDIAN NOSE MARKINGS PER U.S.D. No. 248.
- A SAFE SCHOOL ROUTE MUST BE MAINTAINED AT ALL TIMES.
- INSTALL TRAFFIC SIGN R3-7R, PAVEMENT MARKINGS AND SIGNAGE PER U.S.D. No. 246.2.
- INSTALL TYPE I WHITE COLD POLYMER FILM CROSS WALK. MATCH EXISTING.
- INSTALL TYPE I WHITE COLD POLYMER FILM 4" WIDE EDGE LINE.

LEGEND

- EXISTING
- HANDICAP RAMP
- SANITARY SEWER MANHOLE
- POWER POLE
- TRAFFIC SIGNAL PULL BOX
- SIGN
- WATER VALVE
- FIRE HYDRANT
- WATER METER
- STREET LIGHT
- PAVEMENT MARKINGS
- TRAFFIC SIGNAL HEAD
- CENTER LINE
- CURB & GUTTER
- RIGHT-OF-WAY
- BACK OF SIDEWALK
- MEDIAN ISLAND
- BACK OF CURB
- FACE OF CURB
- LIMITS OF MEDIAN ISLAND REMOVAL AND AC PATCH

DEPARTMENT OF PUBLIC WORKS
ENGINEERING DESIGN SECTION
CITY ENGINEER: CHARLE KAKOWSKI, P.E.
PROJECT MANAGER: THERESA M. HANRAHAN, P.E.
DESIGNED BY: RC
DRAWN BY: RC
CHECKED BY: TMH
HORIZONTAL SCALE: 1" = 30'
VERTICAL SCALE: N/A
DATE: DECEMBER 20, 2000

IMPROVEMENT AND STRIPING PLAN
DECATUR BOULEVARD
DUAL LEFT TURN LANE

TITLE: SHEET:
REGISTERED PROFESSIONAL ENGINEER-STATE OF NEVADA
THERESA M. HANRAHAN
CIVIL
NO. 5888

Sheet SH 3
3 of 4
DRAWING NO. 113-173
BID# 01.1730.10

GENERAL NOTE

1. ALL DIMENSIONS ARE GIVEN IN FEET AND INCHES. DIMENSIONS IN PARENTHESES ARE GIVEN IN METERS. DIMENSIONS IN FEET AND INCHES SHALL BE USED UNLESS OTHERWISE SPECIFIED.

SCALE OF DRAWING

1" = 10'-0" (1:120) FOR ALL DIMENSIONS UNLESS OTHERWISE SPECIFIED.

REVISIONS

NO. 1. CORRECTED FOR THE USE OF THE DESIGNER.



PAVEMENT PATCH
IN PLACE

