

NO.	DATE	BY	APPROV.	REVISION DESCRIPTION
1	10/23/08	KDS	[Signature]	ISSUE FOR PERMITS
2	11/15/08	KDS	[Signature]	REVISED TRASH ENCLOSURES AND PRIVATE FIRE LINE LOCATION
3	11/15/08	KDS	[Signature]	ADD WATER METERS/REV. EMT

**KEY MAP**  
SCALE: 1" = 400'

**WATER CONSTRUCTION NOTES**

- "POINT OF CONNECTION" REMOVE CAP AND BLOW OFF PER UDACS PLATE NO. 4A, NOTE NO. 1, AND CONNECT TO EXISTING 10" STUB \*SEE NOTE 1
- "POINT OF CONNECTION" REMOVE CAP AND BLOW OFF PER UDACS PLATE NO. 4A, NOTE NO. 1, AND CONNECT TO EXISTING 8" STUB \*SEE NOTE 1
- INSTALL 1" COPPER WATERLINE (PUBLIC)
- INSTALL 1" METER AND 1" R.P.P.A. (IRRIGATION) (BRASS PIPING BETWEEN METER AND R.P.P.A.) PER UDACS PLATE NO. 1D & 11A
- INSTALL 1-1/2" METER AND 1-1/2" R.P.P.A. (BRASS PIPING BETWEEN METER AND R.P.P.A.) PER UDACS PLATE NO. 1D & 11A
- INSTALL 2" METER AND 2" R.P.P.A. (BRASS PIPING BETWEEN METER AND R.P.P.A.) PER UDACS PLATE NO. 1D & 11A
- INSTALL 1-1/2" PVC WATERLINE (PUBLIC)
- INSTALL 2" PVC WATERLINE (PUBLIC)
- INSTALL 3" PVC WATERLINE (DOMESTIC) (PRIVATE)
- "POINT OF CONNECTION" INSTALL 12" X 12" MJ OR APPROVED EQUAL TAPPING SLEEVE W/ TAPPING VALVE PER UDACS PLATE NO. 22 & 8
- INSTALL 6" 90° BEND PER UDACS PLATE NO. 5
- INSTALL 6" X 1-1/2" SERVICE SADDLE PER UDACS PLATE NO. 1D
- INSTALL 6" X 1" SERVICE SADDLE PER UDACS PLATE NO. 1D
- INSTALL 6" 45° BEND PER UDACS PLATE NO. 5
- INSTALL 6" PVC FIRE (PRIVATE) (FIRE)
- INSTALL 6" 11.25° BEND PER UDACS PLATE NO. 5
- INSTALL 6" 22.5° BEND PER UDACS PLATE NO. 5
- INSTALL 16" 45° BEND PER UDACS PLATE NO. 5
- INSTALL 12" X 10" REDUCER PER UDACS PLATE NO. 3
- INSTALL 12" X 8" REDUCER PER UDACS PLATE NO. 3
- INSTALL 12" X 8" TEE PER UDACS PLATE NO. 5
- INSTALL 10" 90° BEND PER UDACS PLATE NO. 5
- INSTALL 8" X 8" REDUCER PER UDACS PLATE NO. 3
- INSTALL 10" PVC WATERLINE (PUBLIC)
- INSTALL 10" GATE VALVE PER UDACS PLATE NO. 3 & 8
- INSTALL 10" X 6" REDUCER PER UDACS PLATE NO. 3
- INSTALL 10" 45° BEND PER UDACS PLATE NO. 5
- INSTALL 10" D.C.D.A. PER UDACS PLATE NO. 11C
- INSTALL 12" PVC WATERLINE (FIRE) (PRIVATE)
- INSTALL 12" 5° BEND RESTRAINED JOINT
- INSTALL 12" 11.25° BEND PER UDACS PLATE NO. 5
- INSTALL 12" 22.5° BEND PER UDACS PLATE NO. 5
- INSTALL 12" 45° BEND PER UDACS PLATE NO. 5
- INSTALL 12" 90° BEND PER UDACS PLATE NO. 5
- INSTALL 12" TEE PER UDACS PLATE NO. 5
- INSTALL 12" GATE VALVE PER UDACS PLATE NO. 3 & 8
- INSTALL 12" X 6" REDUCER PER UDACS PLATE NO. 3
- INSTALL 12" X 6" TEE PER UDACS PLATE NO. 5
- INSTALL 6" X 2" SERVICE SADDLE PER UDACS PLATE NO. 1D
- INSTALL 10" X 1-1/2" SERVICE SADDLE PER UDACS PLATE NO. 1D
- INSTALL 10" X 2" SERVICE SADDLE PER UDACS PLATE NO. 1D
- INSTALL 16" X 10" TEE PER UDACS PLATE NO. 5
- INSTALL 12" PVC WATERLINE (PUBLIC)
- INSTALL 16" PVC WATERLINE (PRIVATE) (FIRE)
- INSTALL 16" 11.25° BEND PER UDACS PLATE NO. 5
- INSTALL 16" 22.5° BEND PER UDACS PLATE NO. 5
- NOT USED
- INSTALL 16" 90° BEND PER UDACS PLATE NO. 5
- INSTALL 16" TEE PER UDACS PLATE NO. 5
- INSTALL 16" X 6" TEE PER UDACS PLATE NO. 5
- INSTALL 16" X 10" REDUCER PER UDACS PLATE NO. 3
- INSTALL 6" BLOWOFF PER UDACS PLATE NO. 4B
- INSTALL 16" GATE VALVE PER UDACS PLATE NO. 3 & 8
- INSTALL 16" X 6" REDUCER PER UDACS PLATE NO. 3
- INSTALL 12" X 10" TEE PER UDACS PLATE NO. 5
- INSTALL 16" X 12" REDUCER PER UDACS PLATE NO. 3
- INSTALL STD. FIRE HYD. W/ ASSY. PER UDACS PLATE NO. 7
- STUB AND CAP WATER PER UDACS PLATE NO. 4A
- INSTALL 6" CAP W/ 2" BLOW OFF ASSY. PER UDACS PLATE NO. 4A
- INSTALL PRIVATE FIRE HYD W/ ASSY. TO INCLUDE 12" X 6" TEE AND 6" GATE VALVE PER UDACS PLATE NO. 7
- INSTALL PRIVATE FIRE HYD W/ ASSY. TO INCLUDE 16" X 6" TEE AND 6" GATE VALVE PER UDACS PLATE NO. 7
- INSTALL 8" X 6" TEE PER UDACS PLATE NO. 5
- INSTALL 4" AIR-VAC PER UDACS PLATE NO. 37
- INSTALL 16" DIP WATERLINE (PUBLIC)
- INSTALL 12" DIP WATERLINE (PUBLIC)
- INSTALL 6" PVC WATERLINE (PUBLIC)
- INSTALL 10" X 6" TEE PER UDACS PLATE NO. 5
- INSTALL 10" DIP WATERLINE (PUBLIC)
- INSTALL 12" DIP WATERLINE (PUBLIC)
- INSTALL 6" PVC WATERLINE (PUBLIC)
- INSTALL 16" X 8" REDUCER PER UDACS PLATE NO. 3

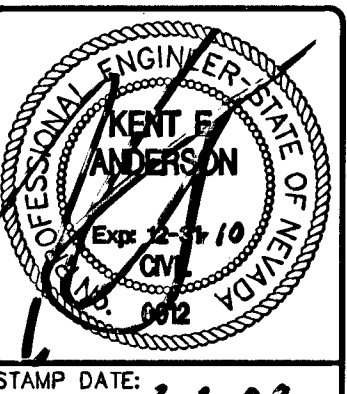

3610 North Rancho Drive  
Las Vegas, Nevada 89130  
Telephone: (702) 646-9700  
Fax: (702) 646-4145

**SOUTHWEST ENGINEERING**  
LAND PLANNING • DEVELOPMENT

**UTILITY PLAN III**

**DECATUR & TROPICAL**  
DECATUR 215, LLC

CITY OF LAS VEGAS

PROJECT: 1074968

WORK ORDER NO: 070819

DESIGN BY: KDS

DRAWN BY: KDS/WK

DATE: Oct 23, 2008

SCALE: 1" = 40'

SHEET 22 OF 45 SHEETS

CLV DWG NO. 1074968

**FIRE WATER AT DOMESTIC WATER CROSSING**  
ALL NON-POTABLE FIRE WATER LINES CROSSING POTABLE DOMESTIC WATER LINES ARE TO BE INSTALLED WITH "A VERTICAL SEPARATION OF NO LESS THAN SIX INCHES..." AND IN ACCORDANCE WITH UDACS 2.20.01, 2.04.05, 2.19.02.B1 AND 2.10.02.B2."

**NOTE**  
ALL ABOVE GROUND UTILITY APPURTENANCES SHALL CONFORM TO THE REQUIREMENTS OF TITLE 19.12.040.

**APPROVAL FOR CONSTRUCTION**

[Signature]  
FIRE MARSHAL

10/29/08  
DATE

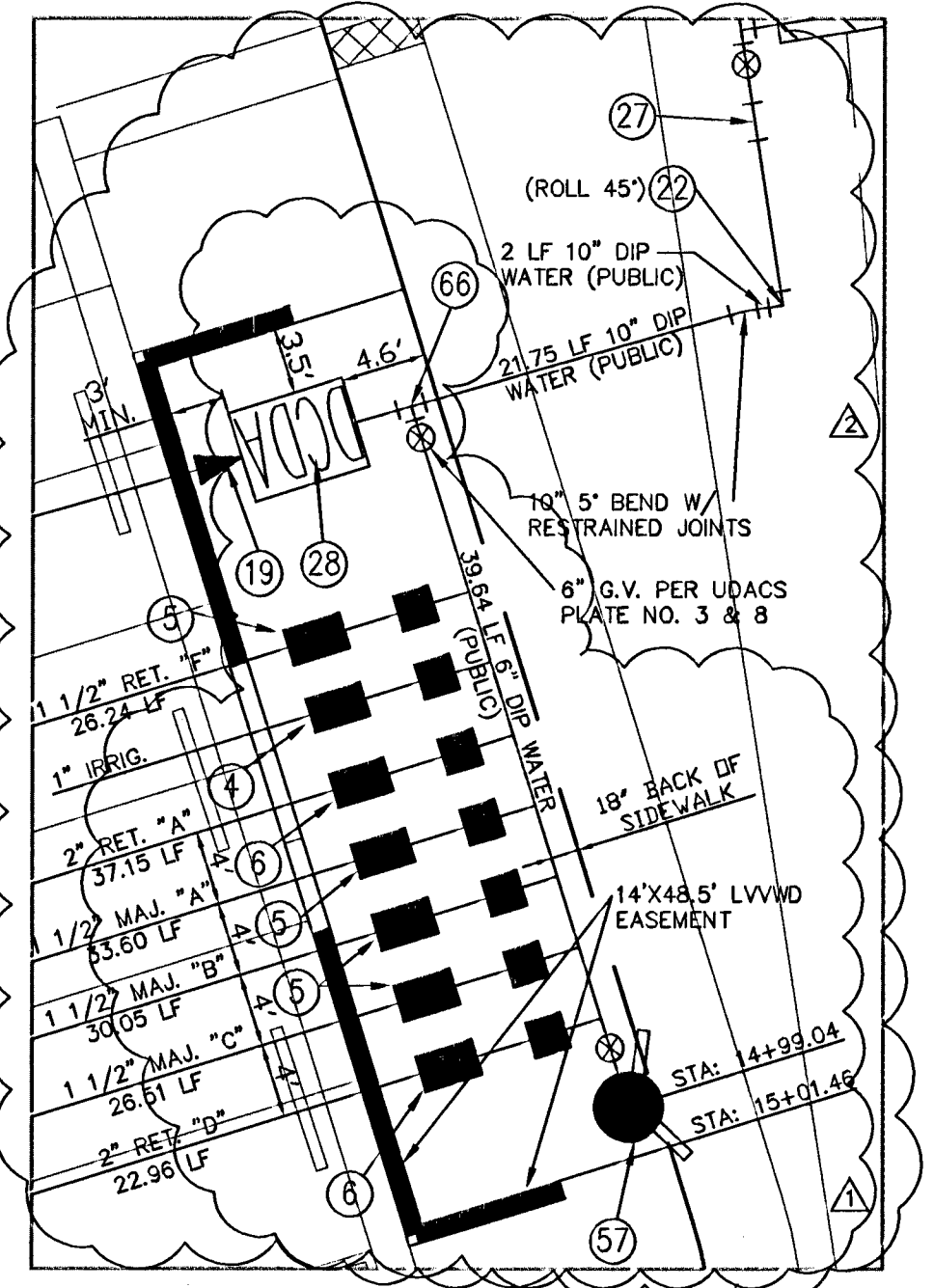
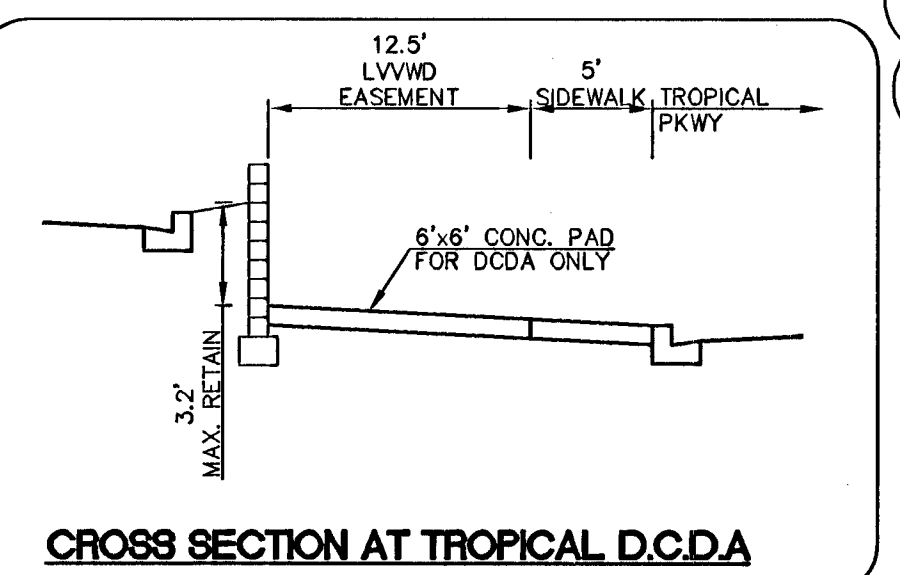

**LINE TABLE**

LINE	LENGTH (LF)
L20	121.18
L21	100.77
L22	90.58
L23	81.89
L24	7.30
L25	74.08
L28	83.92
L27	93.77
L28	102.39
L29	34.30
L30	34.30
L31	34.30
L32	34.30
L33	507.18
L34	415.18
L35	313.69
L36	212.19

**BASIS OF BEARING**  
NORTH 02°01'35" EAST BEING THE CENTERLINE OF DECATUR BLVD. BETWEEN TROPICAL PARKWAY AND CENTENNIAL PARKWAY IN THE NORTHWEST QUARTER (NW 1/4) OF SECTION 30, TOWNSHIP 19 SOUTH, RANGE 61 EAST, M.D.M. CLARK COUNTY, NEVADA, AS SHOWN BY MAP IN THE OFFICE OF THE CLARK COUNTY, NEVADA RECORDER IN FILE 90 OF PARCEL MAPS PAGE 69.

**BENCHMARK**  
CITY OF LAS VEGAS VERTICAL CONTROL RIVET AND PLATE IN TOP OF CURB NW CORNER OF TROPICAL PARKWAY & THOM BOULEVARD

STATION 8LV00  
256.8  
ELEVATION= 697.5653 METERS (NAV88)  
2288.60 FEET

**LEGEND**

---	RIGHT OF WAY
---	PROPERTY LINE
---	CENTER LINE
---	EXISTING CURB & GUTTER
---	EX. EDGE OF PAVEMENT
(33.18)	EXISTING GRADE/INVERT
⊗	EXISTING WATER VALVE
⊙	PROPOSED WATER VALVE
---	EXISTING WATER MAIN
---	PROPOSED WATER MAIN
⊙	EXISTING SANITARY SEWER MANHOLE
⊙	PROPOSED SANITARY SEWER MANHOLE
---	EXISTING SANITARY SEWER MAIN
---	PROPOSED SANITARY SEWER MAIN
⊙	EXISTING FIRE HYDRANT
⊙	PROPOSED FIRE HYDRANT
---	EXISTING GAS MAIN
---	FINISH FLOOR
FF= 88.00	

**APPROVAL FOR CONSTRUCTION**

[Signature]  
LAS VEGAS VALLEY WATER DISTRICT  
PROJECT # 115171

1ST. APPROVED 6-16-08  
DATE 11/15/08  
(SHEETS: 1, 2, 9, 19-22, 24-27, 33, 34, 41)

**NOTE**  
SEE SHEET 2 FOR SEWER AND STORM DRAIN MANHOLE TABLE

**FIRE HYDRANT NOTE**  
PUBLIC FIRE HYDRANTS LOCATED ON DECATUR BOULEVARD AND TROPICAL PARKWAY ARE RATED FOR 1500 GPM.

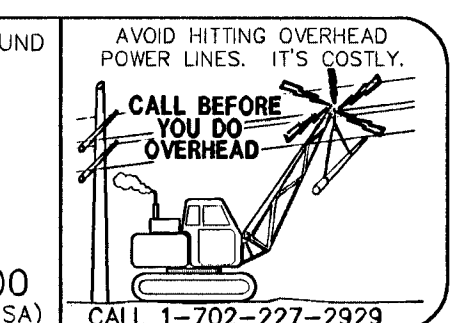

**NOTICE TO CONTRACTOR I**  
EXISTING UTILITY LOCATIONS SHOWN HEREON ARE APPROXIMATE ONLY. IT SHALL BE THE CONTRACTOR'S RESPONSIBILITY TO DETERMINE THE EXACT VERTICAL AND HORIZONTAL LOCATION OF ALL EXISTING UNDERGROUND UTILITIES PRIOR TO COMMENCING CONSTRUCTION. NO REPRESENTATION IS MADE THAT ALL EXISTING UTILITIES ARE SHOWN HEREON. THE ENGINEER ASSUMES NO RESPONSIBILITY FOR UTILITIES NOT SHOWN OR UTILITIES NOT SHOWN IN THEIR PROPER LOCATION.

**CALL before you Dig**  
1-800-227-2600  
UNDERGROUND SERVICE (USA)

FOR CONTINUATION SEE SHEET 23

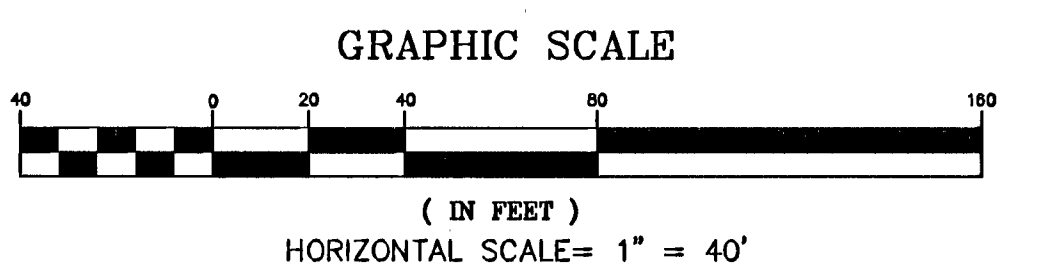

116254  
114433

1127324