

T,R,S: 1959-24
 APN: 12624201001, 002, 005

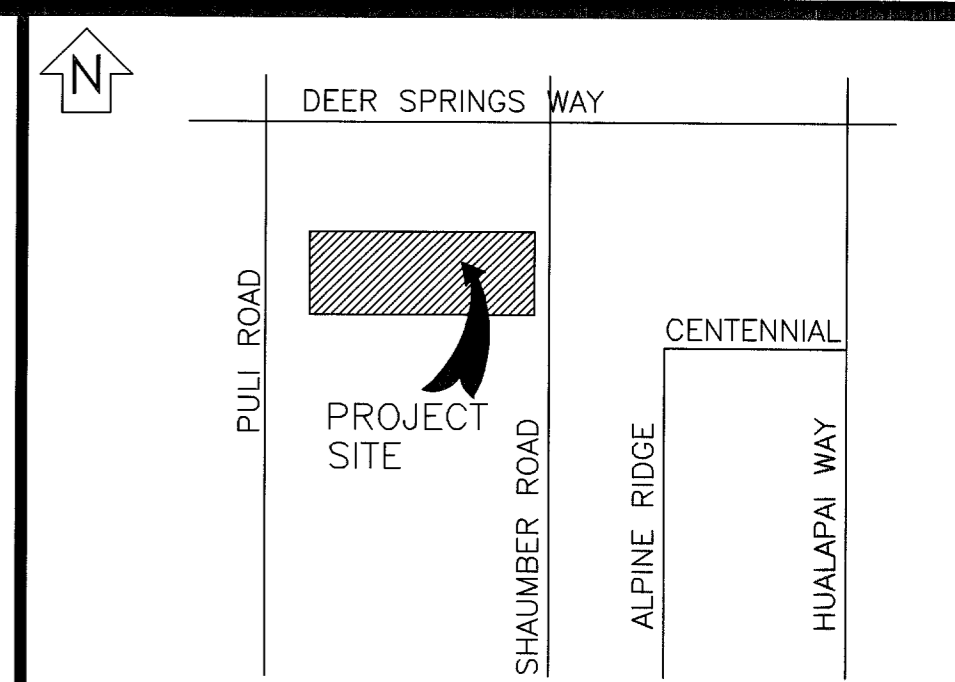

VICINITY MAP
(NOT TO SCALE)

EVERY EFFORT HAS BEEN MADE TO IDENTIFY ALL NPC FACILITIES. THE CUSTOMER SHALL CONFIRM THE EXISTENCE AND LOCATION OF THESE FACILITIES.

AVOID HITTING OVERHEAD POWER LINES IT'S COSTLY.
 CALL BEFORE YOU DIG OVERHEAD

AVOID CUTTING UNDERGROUND UTILITY LINES IT'S COSTLY.
 Call before you Dig.
 1-800-227-2600
 UNDERGROUND SERVICE (USA)

CALL 1-702-227-2929

FIRE HYDRANT CLEARANCE:
 6' MIN RADIUS REQUIRED FROM CIRCUMFERENCE OF HYDRANT TO ANY ABOVE GROUND EQUIPMENT INCLUDING MANHOLES AND SWITCHBOXES.
 3' MIN RADIUS FROM CIRCUMFERENCE OF HYDRANT TO ALL UNDERGROUND HANDHOLES, PULLBOXES AND SPLICEBOXES.

REVISIONS

NO.	DESCRIPTION	DATE	G.A.
1	CHANGE LOT NUMBERS, RELOCATE STREET LIGHTS AND ADD STREET LIGHT SERVICE	04/07/2006	

DCA

TYPE OF EASEMENT:	JPA NOTES:
<input type="checkbox"/> AERIAL	<input type="checkbox"/> SPRINT CONTACT: N/A
<input type="checkbox"/> STANDARD	<input type="checkbox"/> PHONE NUMBER:
<input type="checkbox"/> R/W-31	<input type="checkbox"/> DATE OF CONTACT:
<input type="checkbox"/> UNDERGROUND	<input type="checkbox"/> TO SET NEW POLES
<input type="checkbox"/> AS BUILT UNDERGROUND	<input type="checkbox"/> TO STAKE NEW POLES
<input type="checkbox"/> R.O.E./R/W-5-COM	<input type="checkbox"/> TO PROVIDE POLES
<input type="checkbox"/> 3rd PARTY	<input type="checkbox"/> FT. CLASS
<input type="checkbox"/> UNDERGROUND BY EXHIBIT	<input type="checkbox"/> FT. CLASS
<input type="checkbox"/> (N-DOT) PERMIT	<input type="checkbox"/> TO DIG POLE HOLES
<input type="checkbox"/> (BLM) PERMIT	<input type="checkbox"/> TO REMOVE EX. POLES
<input type="checkbox"/> RAILROAD-UPRR-PERMIT	
<input type="checkbox"/> SO. NEVADA WATER PERMIT	
<input type="checkbox"/> NOT REQUIRED	
<input type="checkbox"/> Misc. Info	
	JPA#: N/A

NPC INFORMATION:

COORDINATOR: KATHY CUNNINGHAM
 PHONE: 657-4313
 DESIGNER: GLEN STANDRIDGE/BELLA
 DCA: 657-4355
 INSPECTOR: 274-7051
 SCHEDULING: 657-4114,657-4116,657-4118
 DISTRICT: LAS VEGAS

CUSTOMER INFORMATION:

APPLICANT: PULTE HOMES
 ENGINEER: G.C. WALLACE
 CONTACT: PAUL DAVIS 683-0709
 APPROVAL DATE: 08-16-2005

GOVERNMENT INFORMATION:

AGENCY: CITY OF LAS VEGAS
 APPROVAL DATE: See Sheet 1

NEVADA POWER COMPANY

EASTON PLACE AT
 PROVIDENCE PHASE 2
 SHAUMBER & DEER SPRINGS
 WAY

PROJ. ID: 178659 SCALE: 1" = 50'
 SHEET #: 2 OF 3 DATE: 05/13/2005

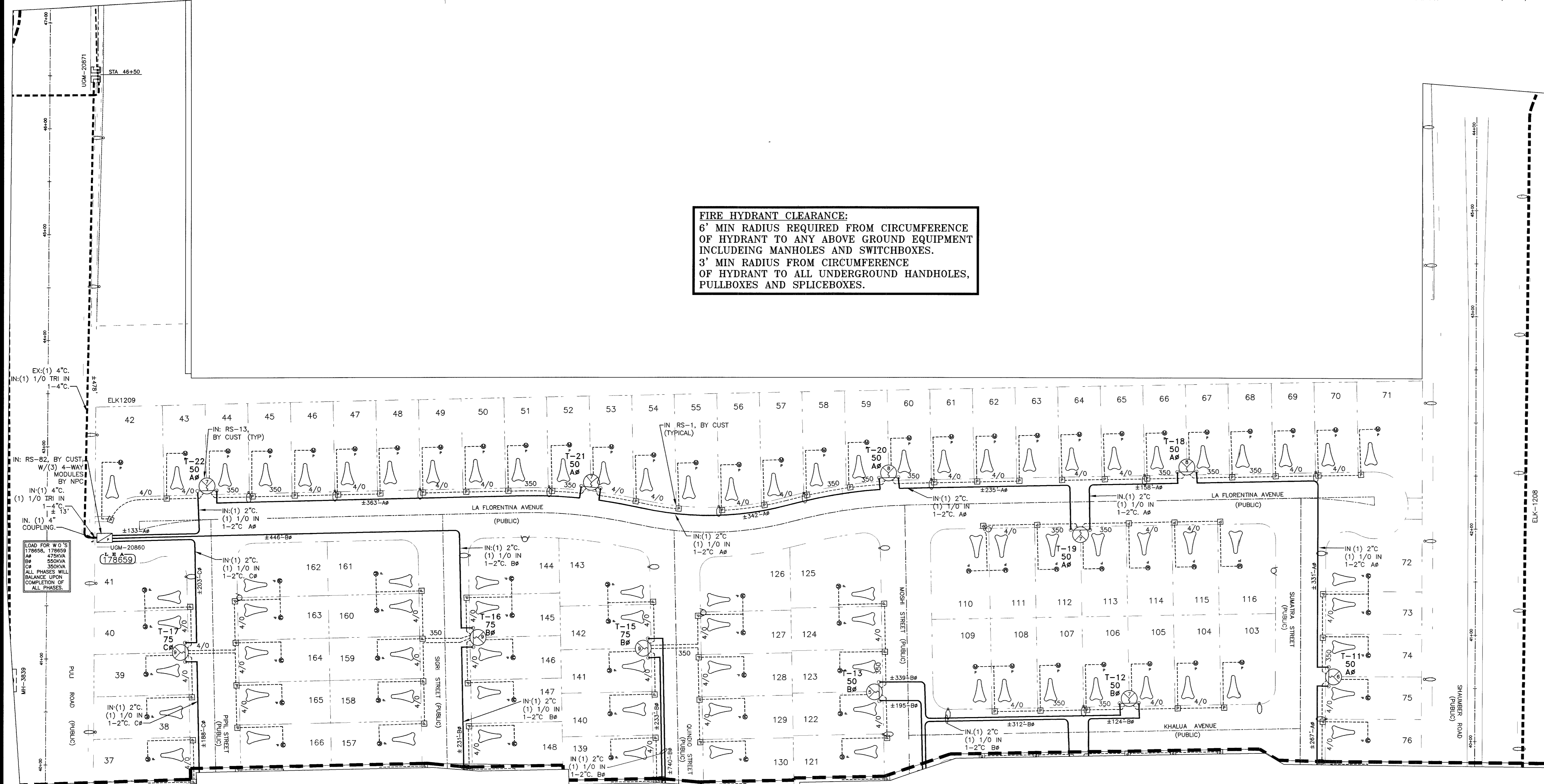

MATCH LINE - SEE SHEET 3 OF 3

PURPOSE OF PROJECT:
 TO PROVIDE POWER TO NEW
 161 UNITS SUBDIVISION
 200A, 120/240V, 1Ø, 3W

CITY OF LAS VEGAS
 PERMIT REQUIRED*
 CONTACT CLV LAND DEVELOPMENT (229-6371)
 CLV CONSTRUCTION SERVICES MUST BE
 NOTIFIED 24 HOURS PRIOR TO COMMENCING
 CONSTRUCTION (229-6337)

CONSTRUCTION OF THIS JOB
 IS CONTINGENT UPON THE
 COMPLETION OF WR# 175890
178658.

*NPC INSPECTOR MUST BE NOTIFIED BY
 FAX 48 HOURS PRIOR TO COMMENCING
 CONSTRUCTION & WILL VERIFY CITY PERMIT
 FOR WORK DONE IN STREETS OR SIDEWALK.
 FAX PERMIT TO:
 LAS VEGAS NORTH (657-4354)
 LAS VEGAS SOUTH (HENDERSON): 558-4740
 LAS VEGAS SOUTH (SPRING VALLEY): 252-4828

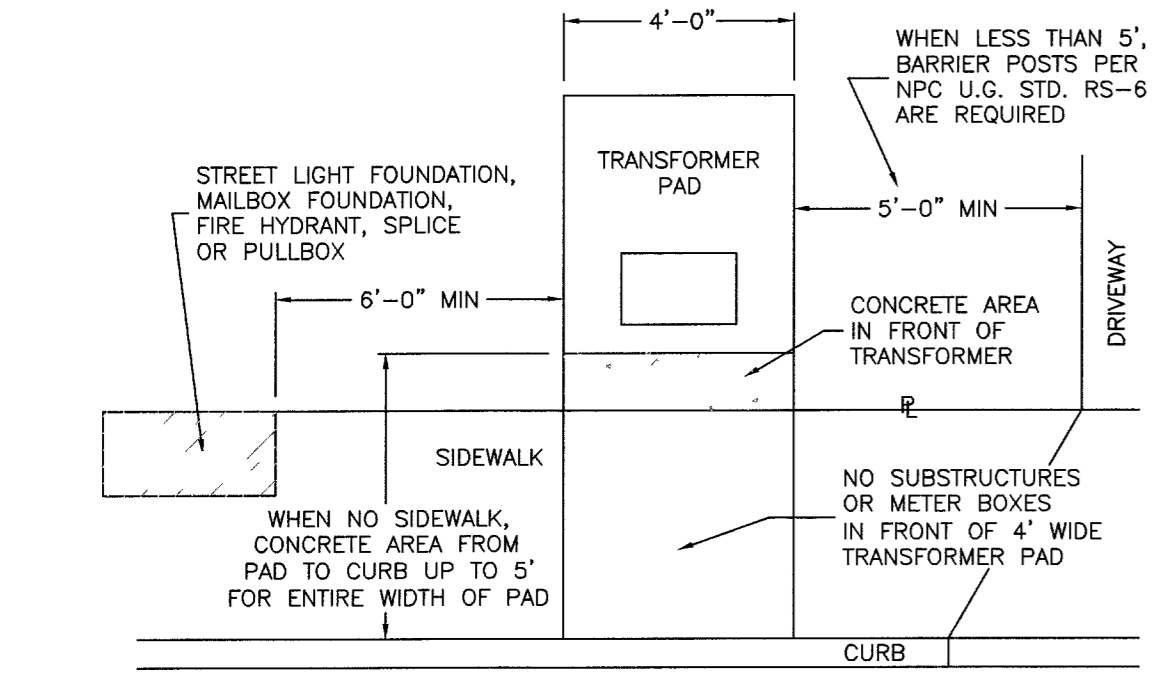

RESIDENTIAL TRANSFORMER LOCATION DETAIL
 NPC U.G. STD RS-5

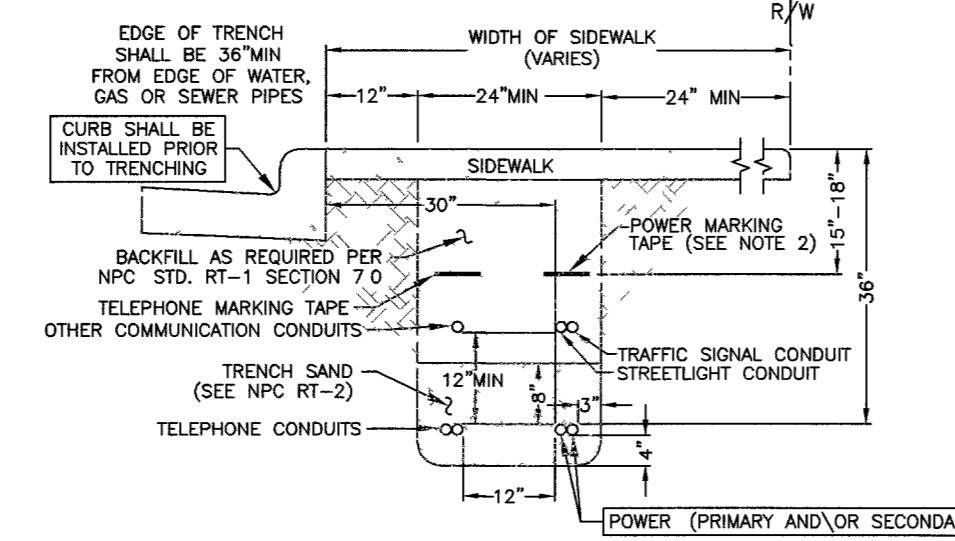

SIDEWALK TRENCH DETAIL
 NPC U.G. STD RT-7 (REV 4/8/02)
 (RESIDENTIAL OR COMMERCIAL)

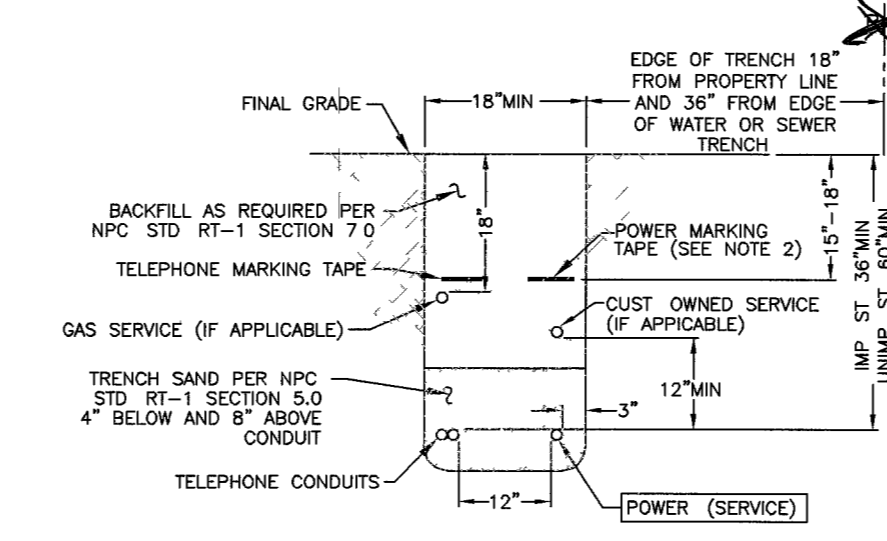

TRENCH DETAIL
 NPC U.G. STD RT-8 (REV 4/8/02)
 (RESIDENTIAL SERVICE)

UNLESS OTHERWISE NOTED:

ALL SERVICE CONDUCTOR: 2/0 AL TRI.
 ALL TRANSFORMERS: 7200-120/240V-1Ø PM
 COMBINED A/C TONNAGE: 5 TONS
 NUMBER OF UNITS: 161
 MAIN SIZE: 200 AMPS
 ESTIMATED KVA PER UNIT: 6 KVA
 SQ. FT. OF LARGEST HOME: 1,850 FT²

CIVIL LINETYPE LEGEND

	PROPOSED	EXISTING
CENTERLINE	---	---
PROPERTY LINE/ROW	---	---
CURB	---	---
EDGE OF PAVEMENT	---	---
EDGE OF SIDEWALK	---	---
SEWER LINE	---	---
WATER LINE	---	---
GAS LINE	---	---
TELEPHONE LINE	---	---
CABLE TV LINE	---	---
STORM DRAIN LINE	---	---
FIRE HYDRANT	---	---
STREET LIGHT	---	---
STREET LIGHT SERVICE	---	---

92704