

**NOTES**

1. Check conduit and cable schedule for cable & wire size.
2. The routing and termination of conduit and the placing of poles and cabinets shall be as indicated on plans. All changes shall be approved by the Traffic Engineer.
3. Signal cable shall be a 10 & 20 conductor #14 A.W.G. cable I.M.S.A. Spec. 20-1.
4. Loop cable shall be one twisted pair of #12 A.W.G. cable I.M.S.A. Spec. 19-2.
5. All signal lenses shall be 12" glass.
6. Call detectors to be connected during phase red for one detection and then disconnected.
7. Controller shall be housed in a Type "R" cabinet with exhaust fan and thermostat control.
8. Cabinet shall be painted white inside and out.
9. Each loop detector lead-in represents a separate amplifier unit required (10 required).
10. All necessary amplified units, modules, light control units, flashers, etc. shall be wired in cabinet to activate the five-phase operation as shown in diagram. All necessary equipment except the modules and amplifiers shall be wired into the cabinet for future eight-phase operation.
11. Each streetlight luminaire shall be fused in cabinet using in-line fuseholders.
12. All pedestrian push-button signs shall be 9" x 12" with full mounting bracket.
13. All cable and wiring shall be installed terminal to terminal; no splices allowed.
14. Poles "A", "B", "C", "D" shall have internally illuminated street name signs installed. The signs shall be wired to the luminaire photo cell for control.
15. Street name sign on Pole "A" and "D" shall read Durango Drive; on Pole "C" and "B" shall read Sahara Avenue. (All signs shall be double faced.)
16. All signal poles shall conform to C.L.V. standard spec. 404.402 & 404.406.
17. Loop detectors to be located by C.L.V. in the field.
18. Luminaire shall be 400-watt high-pressure sodium with MCIII distribution and individual P.E. control and built-in ballast.

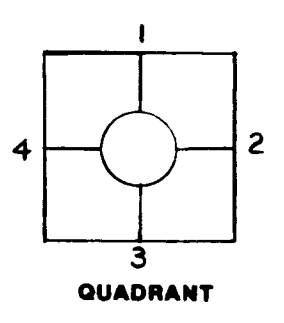

- NOTES**
19. LOOP DETECTORS SHALL BE INSTALLED UNDER THIS CONTRACT.
  20. CONDUIT RUNS 1, 2, AND 3, SHALL BE INSTALLED UNDER THIS CONTRACT.
  21. SIGNAL HEADS TO BE FURNISHED BY THE CITY OF LAS VEGAS.
  22. "LEFT TURN ON GREEN ARROW ONLY" SIGNS SHALL BE FURNISHED BY THE CONTRACTOR.
  23. NEW WORK SHOWN BY SHADED AREAS

LEFT TURN ON LEFT ARROW ONLY  
R3-A2

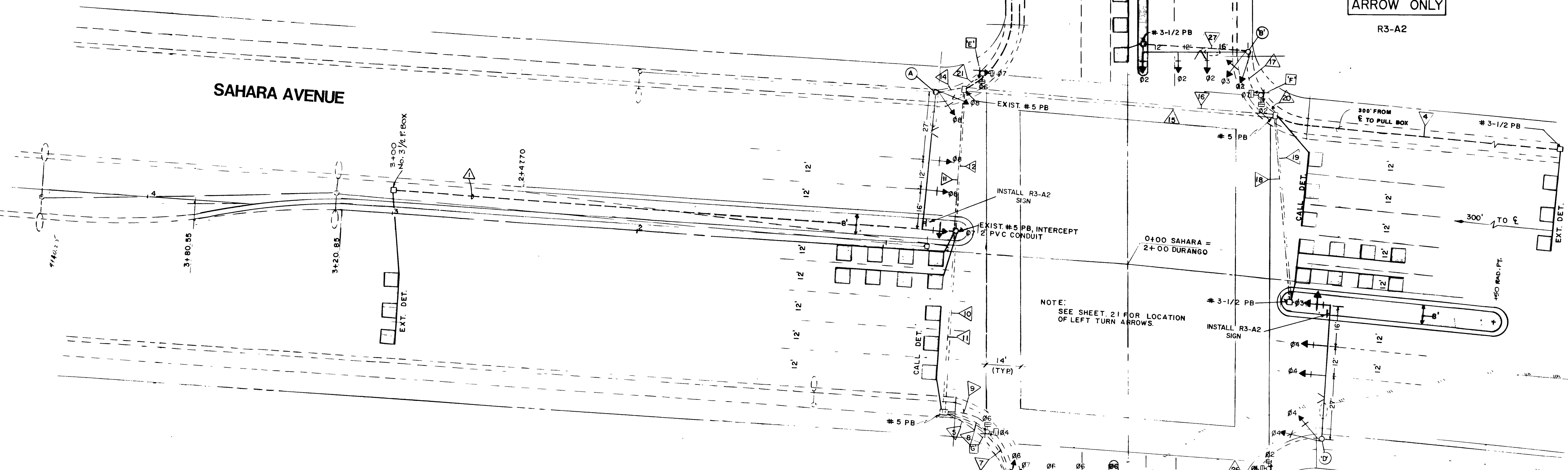

**CONDUIT & CABLE SCHEDULE**

RUN No.	FROM	TO	CONDUIT SIZE	SIGNAL CABLE DET. LEADS	10 COIL 2000N 3/4 WAVE 14AWG	LIGHTING CIR. INTERCONNECT	LOOPS L.W. FLASH 3/4 WAVE 12AWG	SERVICE
1	PULL BOX	PULL BOX	2"			x		
2	PULL BOX	PULL BOX	2"			x		
3	PULL BOX	PULL BOX	2"			x		
4	PULL BOX	PULL BOX	2"			x		
5	CONTROLLER	PULL BOX	3"			x		
6	CONTROLLER	POLE "C"	2"	x		x		
7	POLE "C"	PULL BOX	2"	x				
8	PULL BOX	POLE "G"	2"		x			
9	CONTROLLER	PULL BOX	2"	x	x	x		
10	PULL BOX	PULL BOX	2"			xxx	x	
11	PULL BOX	PULL BOX	2"	x		x		
12	PULL BOX	PULL BOX	2"			xxx	x	
13	SERVICE	CONTROLLER	2"					x
14	PULL BOX	POLE "A"	2"	x	x	x		
15	PULL BOX	PULL BOX	2"			xxx	x	
16	PULL BOX	PULL BOX	2"		x			
17	PULL BOX	POLE "B"	2"	x	x	x		
18	PULL BOX	PULL BOX	2"			xxx		
19	PULL BOX	PULL BOX	2"			xxx		
20	PULL BOX	POLE "F"	2"	x				
21	PULL BOX	POLE "E"	2"	x				
22	CONTROLLER	PULL BOX	2"		x	x		
23	CONTROLLER	PULL BOX	2"			xxx		
24	PULL BOX	PULL BOX	2"			x		
25	PULL BOX	POLE "H"	2"	x				
26	PULL BOX	POLE "D"	2"	x	x	x		
27	PULL BOX	POLE "B"	2"			x		

**POLE SCHEDULE**

No.	STATION	GA.	TYPE	SIGNAL ARM		LUM. ARM	SIGNALS (VEH)		SIGNALS (PED.)		PED. PUSH BUTTON	
				QUAD.	LENGTH		QUAD.	LENGTH	QUADRANT	MOUNTING	QUADRANT	ARROW
A		X	X	3	55'	3	15'	MAST ARM (2) M-2, M-3				
B		X	X	4	40'	4	15'	MAST ARM (2) M-2, M-3				
C		X	X	2	40'	2	15'	MAST ARM (2) M-2, M-3				
D		X	X	1	55'	1	15'	MAST ARM (2) M-2, M-3				
E		1	B						TOP	W-3T	1	L
F		1	B						TOP	W-3T	4	R
G		1	B						TOP	W-3T	4	R
H		1	B						TOP	W-3T	3	R

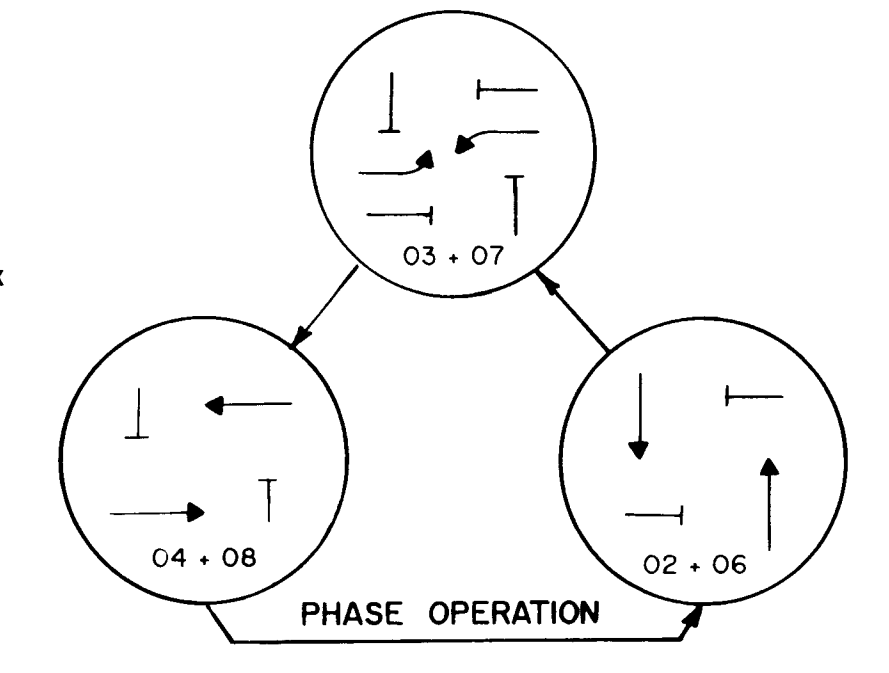

W.A.	Scale (v)	Date	Design by	Date
Fid. bk. no.	Scale (h) 1" = 20'	Date	Design by	Date
Approved by	Approved by	Approved by	Approved by	Approved by
15/10/2009	15/10/2009	15/10/2009	15/10/2009	15/10/2009
<b>Department of Public Works</b> Traffic Engineering Division				
<b>TRAFFIC DELINEATION &amp; SIGNING</b>				
DURANGO DRIVE SAHARA AVE. TO CHARLESTON BLVD.				
Drawing no. 208-V 390				25/28

13-388

107-V1660

