

LEGAL DESCRIPTION

A PART OF DESERT PINES CONDOMINIUMS UNIT 1, IN BOOK 85 OF PLATS PAGE 91 AND ALL OF DESERT PINES CONDOMINIUMS UNIT 2, IN BOOK 87 OF PLATS PAGE 83, BEING A PORTION OF THE NORTH HALF (N1/2) OF THE NORTHEAST QUARTER (NE 1/4) OF SECTION 11, TOWNSHIP 20 SOUTH, RANGE 60 EAST, M.D.M., CITY OF LAS VEGAS, CLARK COUNTY, NEVADA, AS SHOWN BY MAP IN THE OFFICE OF THE CLARK COUNTY NEVADA RECORDER IN FILE 91 OF PARCEL MAPS PAGE 93.

BASIS OF BEARING

NORTH 83°59'05"WEST BEING THE NORTH LINE OF THE NORTHEAST QUARTER (NE 1/4) OF THE NORTHEAST QUARTER (NE 1/4) OF SECTION 11, TOWNSHIP 20 SOUTH, RANGE 60 EAST, M.D.M., CITY OF LAS VEGAS, CLARK COUNTY, NEVADA, AS SHOWN BY MAP IN THE OFFICE OF THE CLARK COUNTY NEVADA RECORDER IN FILE 91 OF PARCEL MAPS PAGE 93.

UNDEVELOPED
PARCEL 2
PM FILE 91 P 93
APN 138-11-502-003

BACK OF CURB CURVE TABLE

CURVE	DELTA	RADIUS	LENGTH	TANGENT
C1	78°25'07"	20.00	27.37	16.32
C2	90°00'00"	2.00	3.14	2.00
C3	90°00'00"	2.00	3.14	2.00
C4	90°00'00"	2.00	3.14	2.00
C5	117°31'17"	199.00	38.97	19.55
C6	90°21'36"	20.00	31.54	20.13
C7	16°28'59"	236.00	67.89	34.18
C8	81°08'34"	20.00	28.32	17.12
C9	103°45'32"	2.00	3.62	2.55
C10	90°00'00"	2.00	3.14	2.00
C11	90°00'00"	2.00	3.14	2.00
C12	85°05'53"	20.00	29.70	18.36
C13	85°05'53"	57.00	84.66	52.32
C14	90°00'01"	2.00	3.14	2.00
C15	89°59'59"	2.00	3.14	2.00
C16	94°51'48"	20.00	33.11	21.77
C17	85°08'13"	20.00	29.72	18.37
C18	94°51'47"	20.00	33.11	21.77
C19	85°08'13"	20.00	29.72	18.37
C20	94°51'47"	20.00	33.11	21.77
C21	85°08'12"	20.00	29.72	18.37
C22	94°51'48"	10.00	16.56	10.89
C23	93°34'16"	20.00	32.66	21.29
C24	26°03'28"	50.00	22.74	11.57
C25	26°03'28"	50.00	22.74	11.57
C26	94°19'11"	2.00	3.29	2.16
C27	82°08'33"	20.00	28.66	17.42
C28	90°00'00"	2.00	3.14	2.00
C29	90°00'00"	2.00	3.14	2.00
C30	86°18'03"	20.00	30.12	18.75
C31	97°16'11"	2.00	3.40	2.27
C32	86°25'46"	20.00	30.17	18.79
C33	55°09'53"	30.00	28.88	15.67
C34	55°09'53"	57.00	54.88	29.78
C35	90°00'00"	2.00	3.14	2.00

- FIRE LANE NOTES**
- PAINT CURB RED WITH "FIRE LANE NO PARKING"
 - INSTALL "NO PARKING FIRE LANE" SIGN

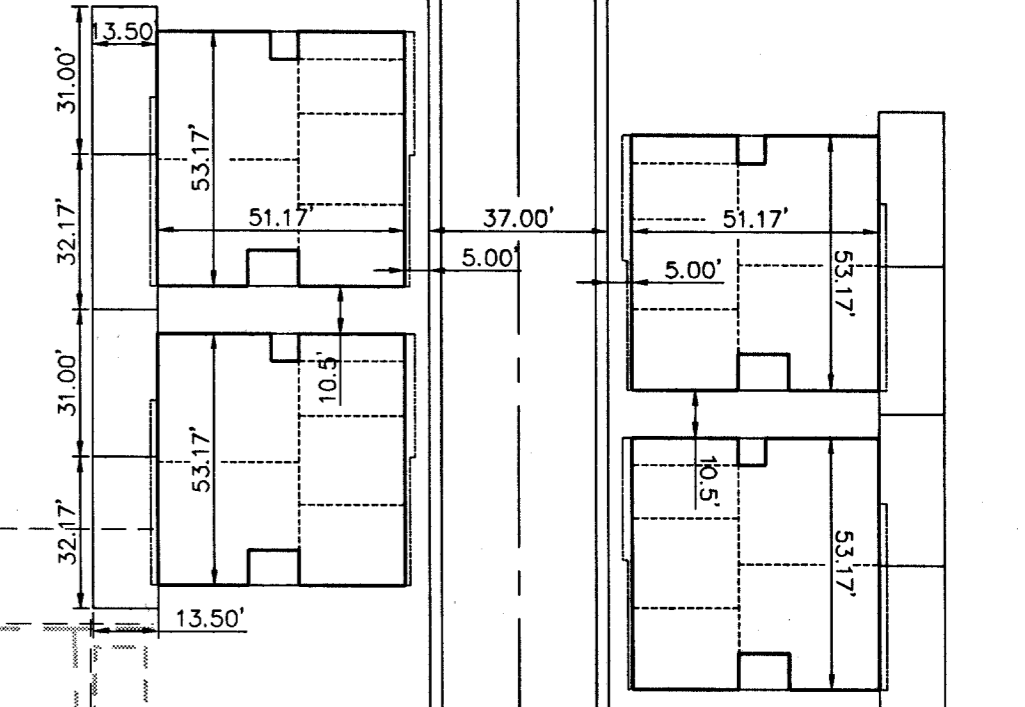
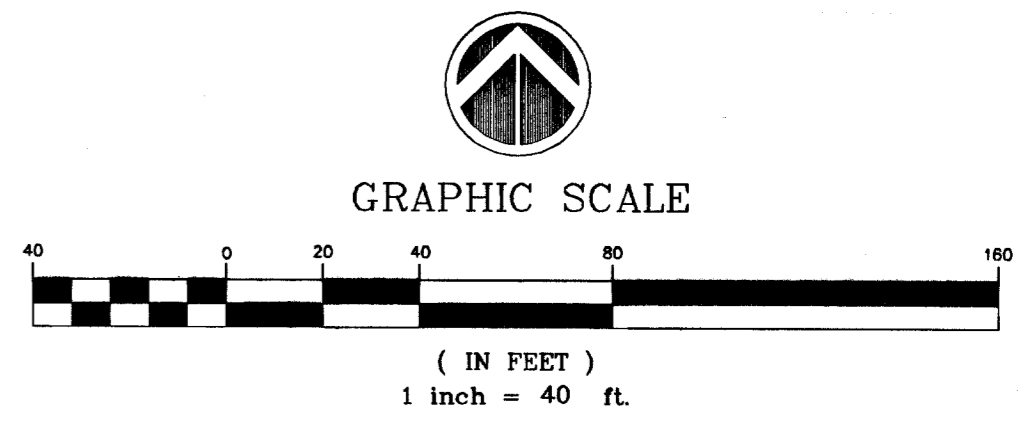

WORK ORDER NO. 021218
DESIGN BY: TEAM 1
DATE: 03-21-03
SCALE: 1"=40'
CADFILE: dpcHC
SHEET 3 OF 7 SHEETS
CLV DWG NO. 1071476

HORIZONTAL CONTROL AND HC ACCESS ROUTE UNIT 2

DESERT PINES CONDOS
KB HOME
CITY OF LAS VEGAS

REVISION DESCRIPTION
NO. DATE BY APPLICANT
1 7/29/03 CP
2 8/1/03 CP
3 9/15/03 CP
4 10/1/03 CP
5 3/14/04 CP

3610 North Ranch Drive
Las Vegas, Nevada 89130
Telephone: (702) 646-9700
Fac: (702) 646-4143

ENGINEERING
SOUTHWEST
LAND PLANNING • DEVELOPMENT

NEVADA

54931 55725 55610 58175 58610 66171

