

EXISTING MOLASKY MIDDLE SCHOOL
APN #135-09-001-004

SSMH No. 1
STA: 186+17.74
TMH=45.842
INV IN=2337.10 E
N 26790+25.12
E 751178.65

SSMH No. 1
STA: 186+17.74
TMH=45.842
INV IN=2337.10 E
N 26790+25.12
E 751178.65

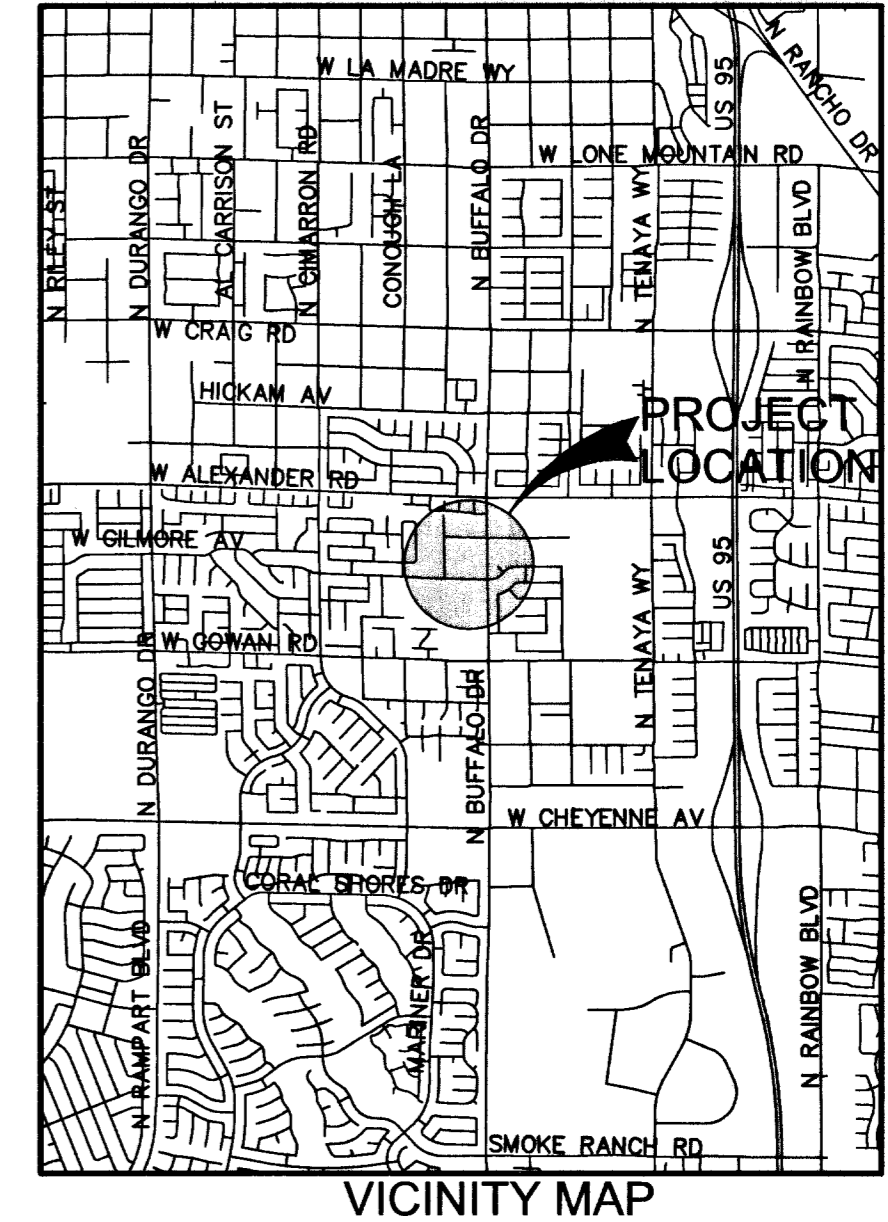
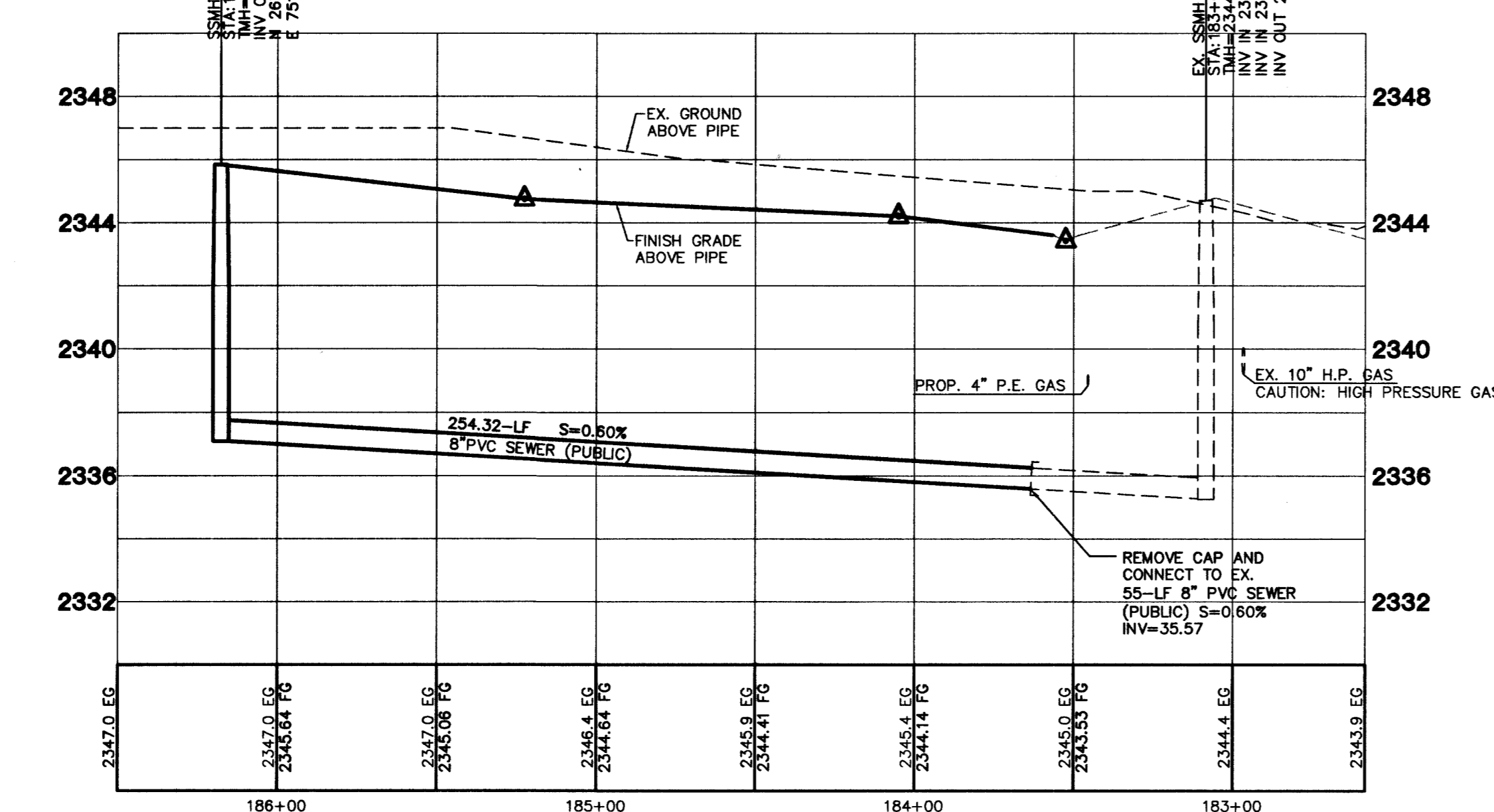

PROFILE SCALES:
HORZ. = 1" = 40'
VERT. = 1" = 4'

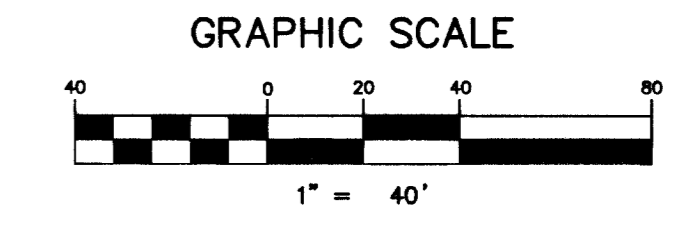

CONTRACTOR NOTE:
CONTRACTOR SHALL VERIFY HORIZONTAL AND VERTICAL LOCATION OF EXISTING UTILITIES AND NOTIFY THE DESIGN ENGINEER IMMEDIATELY OF ANY DISCREPANCIES PRIOR TO CONSTRUCTION.

ALL SEWER/STORM DRAINS CROSSING WATER LINES MUST CONFORM TO SECTION 2.19 OF THE UNIFORM DESIGN AND CONSTRUCTION STANDARDS FOR POTABLE WATER SYSTEMS (UDACS) FOR WATER AND STORM MAIN CROSSINGS AND CLEARANCES.

ESTIMATE OF QUANTITIES LEGEND
1 BLOCK NUMBER

PROJECT BENCHMARK
PROJECT DATUM: NORTH AMERICAN VERTICAL DATUM (NAVD88)
CLARK COUNTY BENCHMARK #RL-V08 968
NAVD88 ELEVATION: 721.081 METERS (2365.76 FEET)
RIVET AND WASHER AT GOWAN AND CONOUGH

BASIS OF BEARINGS
NORTH 01°17'17" WEST, BEING THE WEST LINE OF THE SOUTHWEST QUARTER (SW 1/4) OF THE NORTHEAST QUARTER (NE 1/4) OF SECTION 9, TOWNSHIP 20 SOUTH, RANGE 80 EAST, M.D.M., CLARK COUNTY, NEVADA, AS SHOWN ON THAT RECORD OF SURVEY, ON FILE IN THE COUNTY RECORDER'S OFFICE, CLARK COUNTY, NEVADA, IN FILE 92 OF SURVEYS, AT PAGE 50.

Avoid overhead power line contact. It's costly.
Call before you Overhead
1-702-227-2929

Avoid cutting underground utility lines. It's costly.
Call before you Dig
1-800-227-2600

NEVADA HOMES GROUP INC. 6885 W SAHARA STE #201 LAS VEGAS, NV 89117 (702) 220-6200 FAX (702) 257-7715		CITY OF LAS VEGAS	
SEWER PLAN AND PROFILE RORY COURT		DAY DAWN ESTATES UNIT 4	
DRAWN BY: MDO	DESIGNED BY: MDO	CHECKED BY: MEN	PROJECT NO: 6232-4
SEPT. '03	SEPT. '03	SEPT. '03	SCALE: 1" = 40' HORIZ. NA VERT.
DRAWING NO. 107Y4748-4		SHEET 8 OF 8 SHEETS	

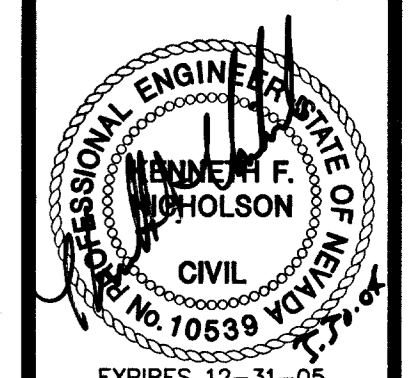

6044