

**CITY OF LAS VEGAS GRADING NOTES**

- IN THE EVENT THAT ANY UNFORSEEN CONDITIONS NOT COVERED BY THESE NOTES ARE ENCOUNTERED DURING GRADING OPERATIONS, THE OWNER/ENGINEER SHALL BE IMMEDIATELY NOTIFIED FOR DIRECTION.
- IT SHALL BE THE RESPONSIBILITY OF THE CONTRACTOR TO PERFORM ALL NECESSARY CUTS AND FILLS WITHIN THE LIMITS OF THIS PROJECT AND THE RELATED OFF-SITE WORK, SO AS TO GENERATE THE DESIRED SUBGRADE AND SLOPES SHOWN.
- CONTRACTOR SHALL TAKE RESPONSIBILITY FOR ALL EXCAVATION, ADEQUATE SHORING SHALL BE DESIGNED AND PROVIDED BY THE CONTRACTOR TO PREVENT UNDERMINING OF ANY ADJACENT FEATURES OR FACILITIES AND/OR CAVING OF THE EXCAVATION.
- THE CONTRACTOR IS WARNED THAT AN EARTHWORK BALANCE WAS NOT NECESSARILY DONE FOR THIS PROJECT. ANY ADDITIONAL MATERIAL REQUIRED OR LEFTOVER MATERIAL FOLLOWING EARTHWORK OPERATIONS BECOMES THE RESPONSIBILITY OF THE CONTRACTOR. THE GRADING CONTRACTOR IS RESPONSIBLE TO COORDINATE WITH THE OWNER TO PROVIDE FOR THE REQUIREMENTS OF THE PROJECT STORM WATER POLLUTION PREVENTION PLAN (SWPPP) AND ASSOCIATED.
- CONTRACTOR SHALL GRADE TO THE LINES AND ELEVATIONS SHOWN ON THE PLANS WITHIN THE FOLLOWING HORIZONTAL AND VERTICAL TOLERANCES AND DEGREES OF COMPACTION, IN THE AREAS INDICATED:

- HORIZONTAL - VERTICAL COMPACTION**
- PAVEMENT AREA SUBGRADE 0.1+ 0.01 to 0.11 See Soils Report
  - ENGINEERED FILL 0.5+ 0.1 to 0.11 See Soils Report
  - COMPACTION TESTING WILL BE PERFORMED BY THE OWNER OR HIS REPRESENTATIVE.
- ALL CUT AND FILL SLOPES SHALL BE PROTECTED UNTIL EFFECTIVE EROSION CONTROL HAS BEEN ESTABLISHED.
  - THE USE OF POTABLE WATER WITHOUT A SPECIAL PERMIT FOR BUILDING OR CONSTRUCTION PURPOSES INCLUDING CONSOLIDATION OF BACKFILL OR DUST CONTROL IS PROHIBITED. THE CONTRACTOR SHALL OBTAIN ALL NECESSARY PERMITS FOR CONSTRUCTION WATER.
  - THE CONTRACTOR SHALL MAINTAIN THE STREETS, SIDEWALKS AND ALL OTHER PUBLIC RIGHT-OF-WAY IN A CLEAN, SAFE AND USABLE CONDITION. ALL SPILLS OF SOIL, ROCK OR CONSTRUCTION DEBRIS SHALL BE PROMPTLY REMOVED FROM ALL T E PUBLICLY OWNED PROPERTY DURING CONSTRUCTION AND UPON COMPLETION OF THE PROJECT. ALL ADJACENT PROPERTY, PRIVATE OR PUBLIC SHALL BE MAINTAINED IN A CLEAN, SAFE AND USABLE CONDITION.
  - IN THE EVENT THAT ANY TEMPORARY CONSTRUCTION ITEM IS REQUIRED THAT IS NOT SHOWN ON THESE DRAWINGS, THE OWNER AGREES TO PROVIDE AND INSTALL SUCH ITEM AT HIS OWN EXPENSE AND AT THE DIRECTION OF THE CITY ENGINEER. TEMPORARY CONSTRUCTION INCLUDES DITCHES, BERMS, ROAD SIGNS AND BARRICADES, ETC.

| DRAINAGE BOND TABLE                      |            |
|--|------------|
| PRIVATE FLOOD CONTROL IMPROVEMENTS       | QUANTITY   |
| BLOCK WALL WITH 2 COURSES OF SOLID GROUT | 2,064 L.F. |
| BLOCK WALL WITH 3 COURSES OF SOLID GROUT | 960 L.F.   |
| 1 COURSE STEM WALL                       | 1,268 L.F. |
| 2 COURSE STEM WALL                       | 939 L.F.   |

| SIDEWALK RAMPS TABLE    |         |         |      |
|-------------------------|---------|---------|------|
| PER STD. DWG 235 CASE 1 |         |         |      |
| NO.                     | DIM "A" | DIM "B" | CASE |
| 1                       | 8.0'    | 8.0'    | II   |
| 2                       | 4.5'    | 9.5'    | I    |

**NOTE:**  
SEE SHEET C4 FOR CLARK COUNTY TRAFFIC NOTES.

**LEGEND**

- FG FINISH GRADE
- FL FLOW LINE
- TC TOP OF CURB
- TRC TOP OF ROLL CURB
- EAC EDGE OF ASPHALT PAVEMENT
- FUT FUTURE
- EXIST EXISTING (EX.)
- VC VALLEY GUTTER
- NG NATURAL GROUND
- H.P. HIGH POINT
- L.P. LOW POINT
- C/L CENTER LINE
- O/C OFFSET CROWN
- BCR BACK OF CURB
- BCR BEGIN CURB RETURN
- TF TOP OF FOOTING
- GB GRADE BREAK
- PC POINT OF CURVATURE
- PT POINT OF TANGENCY
- PRC POINT OF REVERSE CURVATURE
- TOP TOP OF COMPOUND CURVATURE
- BVC BEGIN VERTICAL CURVE
- MVC MID-POINT OF VERTICAL CURVE
- EVC END VERTICAL CURVE
- PRVC POINT OF REVERSE VERTICAL CURVE
- VPI VERTICAL POINT OF INTERSECTION
- TPW TOP OF PLANTER WALL
- TRW TOP OF RETAINMENT WALL
- TOP TOP OF CHANNEL/SCARP
- TOE TOE OF CHANNEL/SCARP
- TOB TOE OF BOX
- PP POWER POLE
- TRANS. TRANSITION
- RET. RETAINMENT
- INT. INTERSECTION
- D.G. DESIGN GRADE
- TSW TOP OF SIDEWALK
- FF FINISH FLOOR
- GFF GARAGE FINISH FLOOR
- BFE BASE FLOOD ELEVATION
- R/W RIGHT-OF-WAY
- S/W SIDEWALK
- EX. CONTOUR (5' INTERVAL)
- EX. CONTOUR (1' INTERVAL)
- PROPOSED CONTOUR
- PROPOSED PAD GRADE
- FUT, EXIST. PAD GRADE
- SLOPE AND FLOW DIRECTION
- EDGE OF EXIST. A.C.
- SAW CUT & MATCH A.C.
- SIDEWALK RAMP
- PAD SWALE SLOPES
- SCARP AREA
- LOT NUMBER
- RETAINING HEIGHT (FEET)
- SIGHT VISIBILITY ZONES
- PROJECT BOUNDARY LINE
- SETBACK LINE
- R/W OR P/L
- EXIST. IMPROVEMENTS
- FUTURE IMPROVEMENTS
- CENTER LINE
- RETAINING WALL
- CONC. BLOCK WALL
- EXIST. CONC. BLOCK WALL
- EXIST. DIRT ROAD
- EXIST. AC
- CONSTRUCTION PHASE LINE OR UNIT BOUNDARY LINE
- MATCHLINE

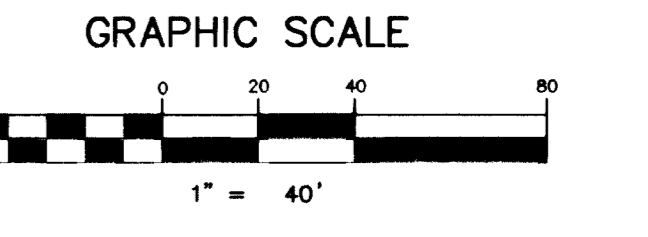
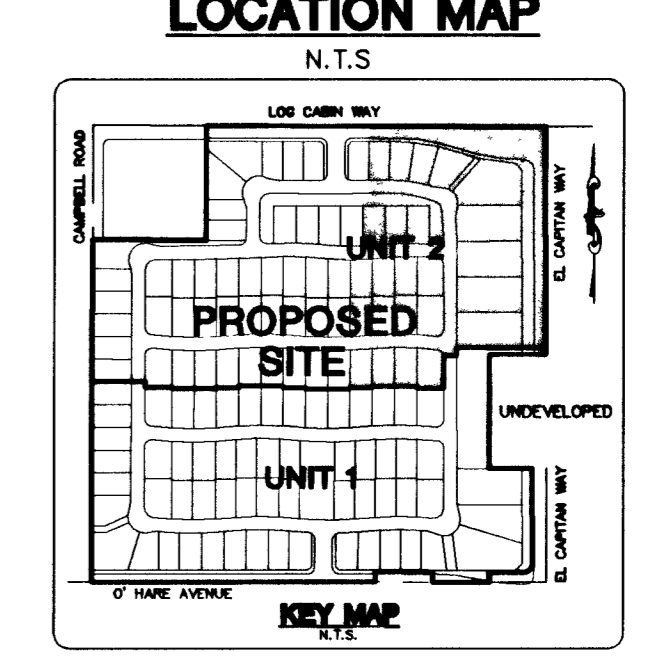
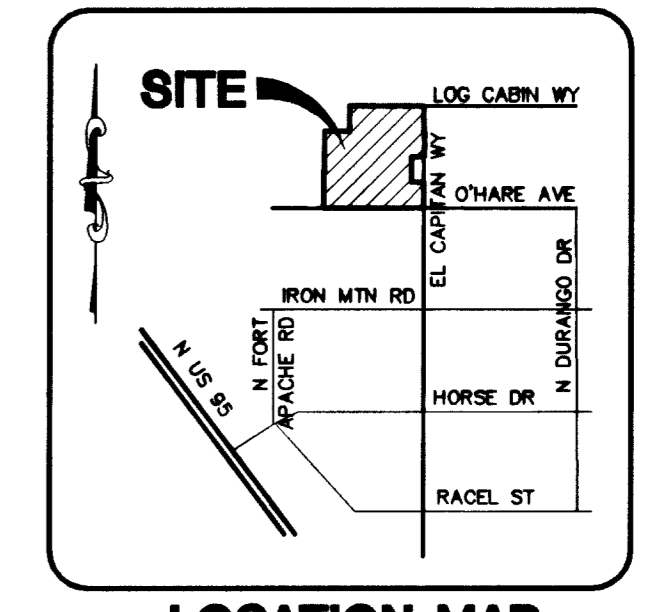

**BASIS OF BEARING**

NORTH 89°48'22" WEST - BEING THE BEARING OF THE NORTH LINE OF THE SOUTHWEST QUARTER (SW 1/4) OF SECTION 5, TOWNSHIP 19 SOUTH, RANGE 60 EAST, M.D.M., CLARK COUNTY, NEVADA, AS SHOWN BY THAT PLAT ON FILE IN THE OFFICE OF THE COUNTY RECORDER, CLARK COUNTY, NEVADA, IN BOOK 92 OF PLATS, AT PAGE 17.

**BENCHMARK**

CITY OF LAS VEGAS BENCHMARK 8LV90-8NES  
NAD83 ELEV: 771.94 METERS (2532.63 FEET)  
BLM BRASS CAP LOCATED AT DURANGO DRIVE AND IRON MOUNTAIN ROAD.

**FOR ALL GRADING & STREET SECTIONS SEE SHEET D1**

**CONTRACTOR NOTE:**

CONTRACTOR SHALL VERIFY HORIZONTAL AND VERTICAL LOCATION OF EXISTING UTILITIES AND NOTIFY THE DESIGN ENGINEER IMMEDIATELY OF ANY DISCREPANCIES PRIOR TO CONSTRUCTION.

**PRIVATE STREET NOTE:**

PRIVATE STREETS ARE P.U.E.S. C.L.V. PUBLIC SEWER EASEMENTS, AND PUBLIC DRAINAGE EASEMENT ARE TO BE PRIVATELY MAINTAINED.

**CONSTRUCTION NOTES:**

- (A) CONSTRUCT "L" CURB & GUTTER PER STD. # 216
- (B) CONSTRUCT 5' SIDEWALK PER STD. # 234
- (C) CONSTRUCT 8' CROSS GUTTER PER STD. # 228
- (D) CONSTRUCT SIDEWALK RAMP PER STD. # 235
- (E) CONSTRUCT "ROLL" CURB & GUTTER PER STD. # 217A
- (F) CONSTRUCT DEPRESSED CURB PER DETAIL SHEET D1
- (G) CONSTRUCT SIDEWALK UNDERDRAIN PER STD. # 236
- (H) CONSTRUCT 10' CURB TRANSITION "ROLL" TO "L"

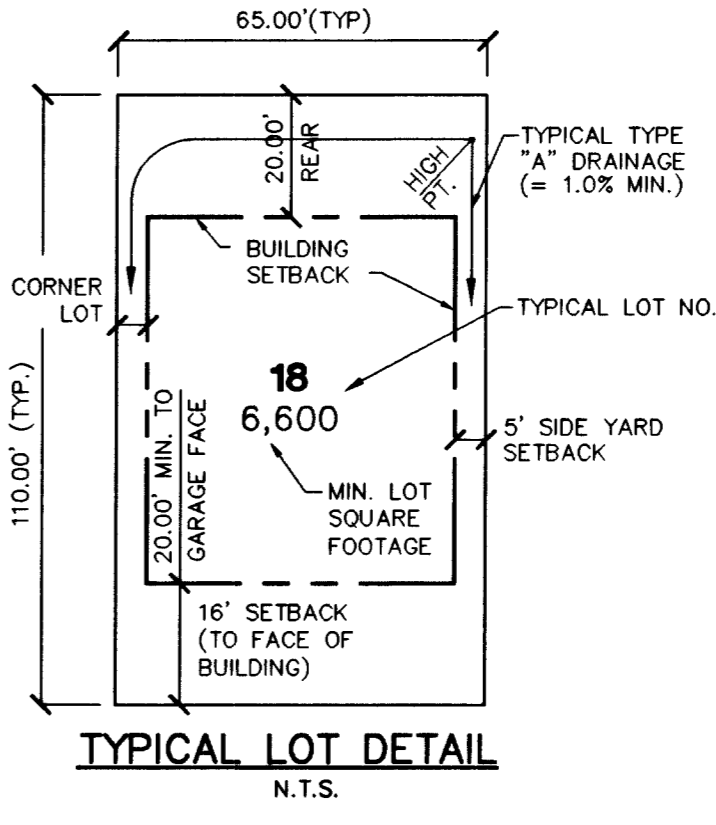

**CLARK COUNTY DEPARTMENT OF DEVELOPMENT SERVICES**

Acceptance of plans for filing  
By *Jack Beaton 1-29-03*  
As Engineer in Charge  
This acceptance is given on the condition that the applicant shall be held responsible for the accuracy of the information provided and for the compliance of the project with all applicable laws, codes, and regulations. Clark County shall be held harmless from any claims or damages which may result from the construction of the improvements from the engineering design depicted herein.

**NOTE:** Power poles and/or other existing facilities not in proper location based on proposed improvements shown herein will be relocated at no expense to Clark County.

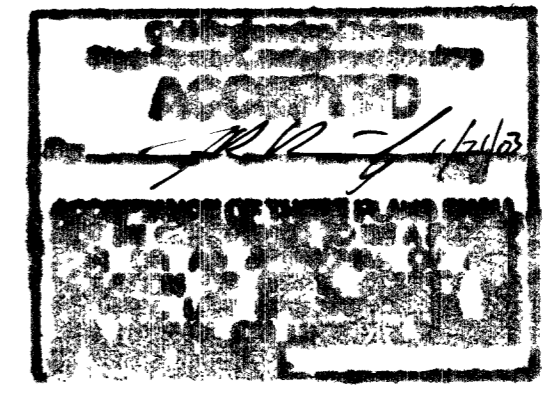

Call before you Dig  
1-800-227-2600

Call before you Overhead  
1-702-593-6111

I CERTIFY THAT THIS GRADING PLAN IS IN CONFORMANCE WITH THE APPROVED DRAINAGE STUDY ON FILE AT CITY OF LAS VEGAS NEVADA FOR THIS PROJECT.  
*Christopher R. Grubbs* 12/20/02  
CHRISTOPHER R. GRUBBS NO. 13956 DATE

**STERLING S. DEVELOPMENT**  
CITY OF LAS VEGAS, NEVADA  
2727 SOUTH RAINBOW BOULEVARD LAS VEGAS, NEVADA 89146-5148  
PH. (702) 873-7550 FAX (702) 362-2597  
neveda CONSULTING ENGINEERS • PLANNERS • LAND SURVEYORS

**GRADING / TRAFFIC PLAN**

**EL CAPITAN / O'HARE UNIT 2**

DRAWN BY: \_\_\_\_\_  
DESIGNED BY: \_\_\_\_\_  
CHECKED BY: \_\_\_\_\_  
PROJECT NO: 6018  
SCALE: 1"=40' HORIZ. VERT. N/A  
SHEET: GR2  
8 OF 29 SHEETS  
DRAWING NO. 1071-4732-2