

BLOW-OFF ASSEMBLY

SCALE: 1" = 40'

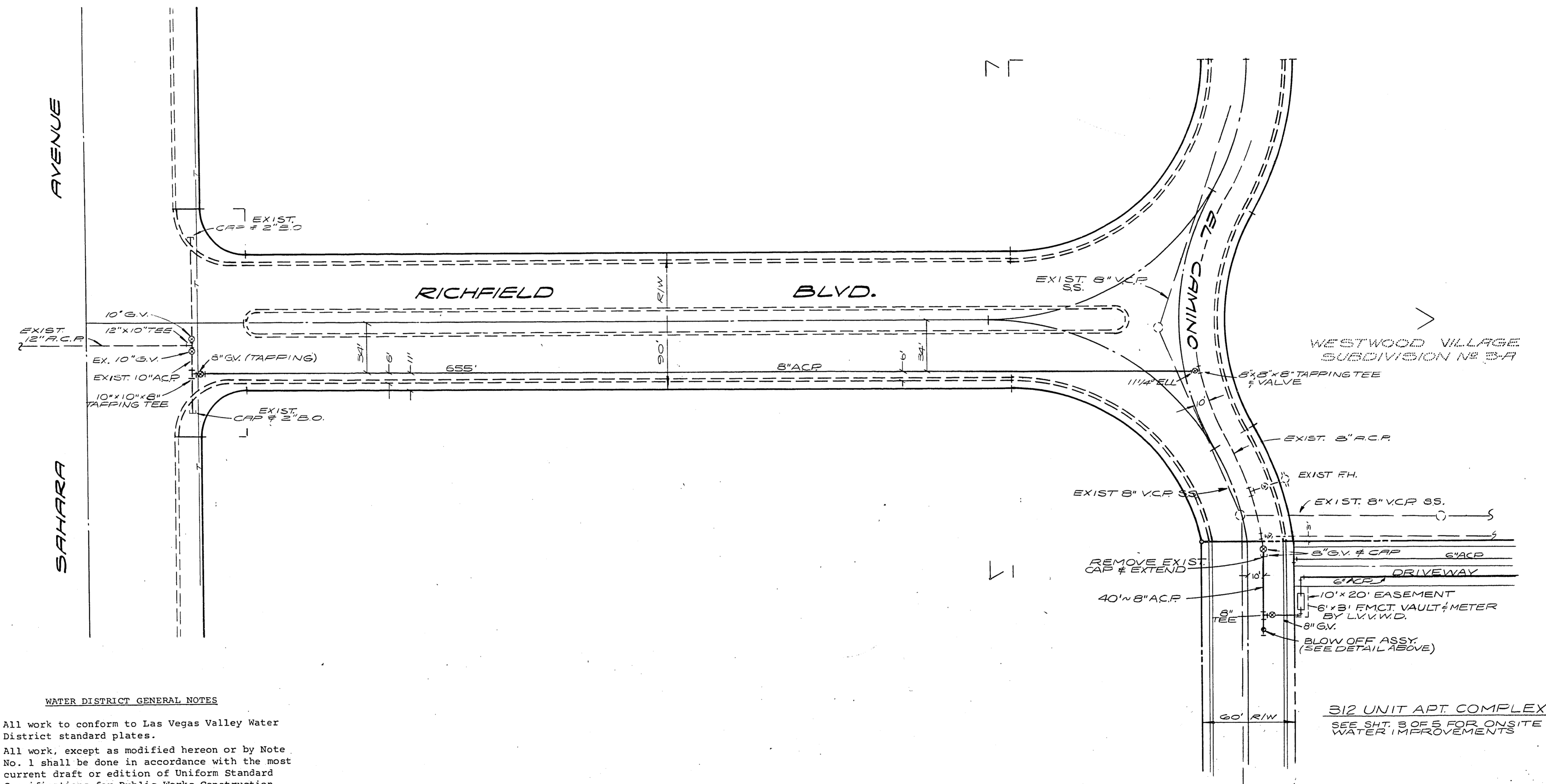

WATER DISTRICT GENERAL NOTES

1. All work to conform to Las Vegas Valley Water District standard plates.
2. All work, except as modified hereon or by Note No. 1 shall be done in accordance with the most current draft or edition of Uniform Standard Specifications for Public Works Construction Offsite Improvements Clark County Area, 1976.
3. Notice to be given Engineering Department of the Las Vegas Valley Water District 48 hours prior to actual construction.
4. Service saddles or tapped collars will be required on all services, double tap collars are not permitted.
5. All lines to be pressure tested to 200 psi.
6. All valve boxes shall have concrete collars at surface of paved areas.
7. Deflection angle shall not exceed 5 degrees per 13 foot section of pipe for pipe sizes smaller than 10 inches and shall not exceed 3 degrees for pipe sizes 10 inches and larger.
8. All meters shall be located outside of driveways.

APPROVALS

William Harris 5/2/77
 CITY OF LAS VEGAS
 CITY ENGINEER

Robert DeWalt 5-2-77
 CITY OF LAS VEGAS
 FIELD OPERATIONS ENGINEER

Myra Webb 4/13/77
 LAS VEGAS VALLEY WATER DISTRICT
 DATE

George J. ... 4-27-77
 CLV FIRE DEPARTMENT
 DATE

NO.	REVISIONS	DESCRIPTION/DATE	BY

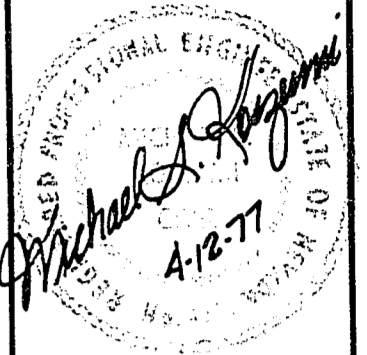

SPARKS, NEVADA
 LAS VEGAS, NEVADA
 SEATTLE, WASHINGTON
incorporated
SEA
 ENGINEERS/PLANNERS
 ARCHITECTS

A.S. SPANOS
312 UNIT APARTMENT COMPLEX
OFF-SITE WATER PLAN
 LAS VEGAS, NEVADA

JOB NO. 2-0102-008
DESIGNED <i>Holt</i>
DRAWN <i>WST</i>
COMP. <i>TK</i>
CHECKED <i>TK</i>
DATE FEB. 1977
SHEET NO.

4
 4 OF 5 SHEETS