

QUANTITIES

1. 2" A.C.	989 SF
2. CONC. C&G	309 LF
3. CONC. SIDEWALK	1543 SF
4. CONC. V. G.	1 EA. 203 SF
5. 100W. HPS LUMINAIRE	2 EA.
6. 1 1/2" PVC CONDUIT	318 LF

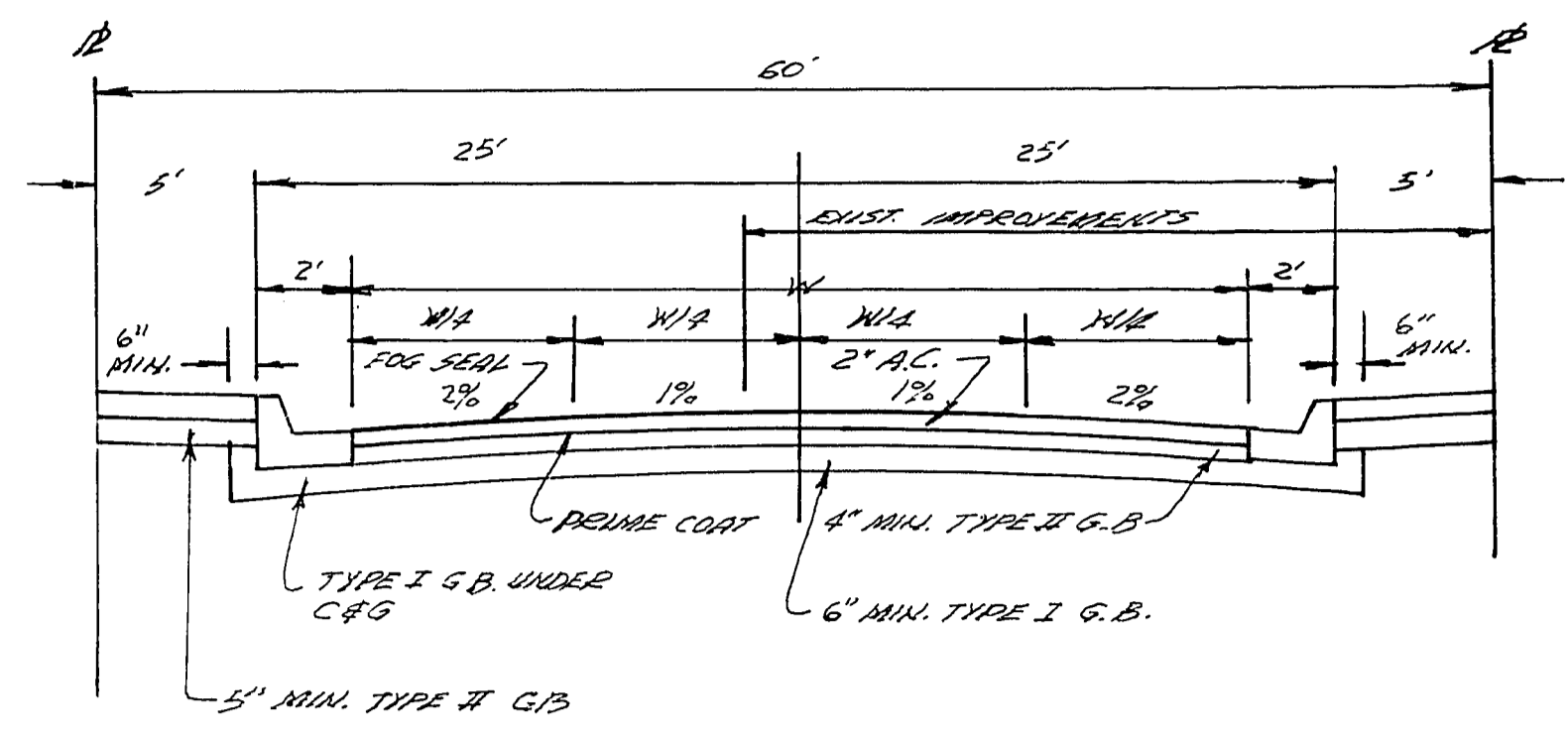
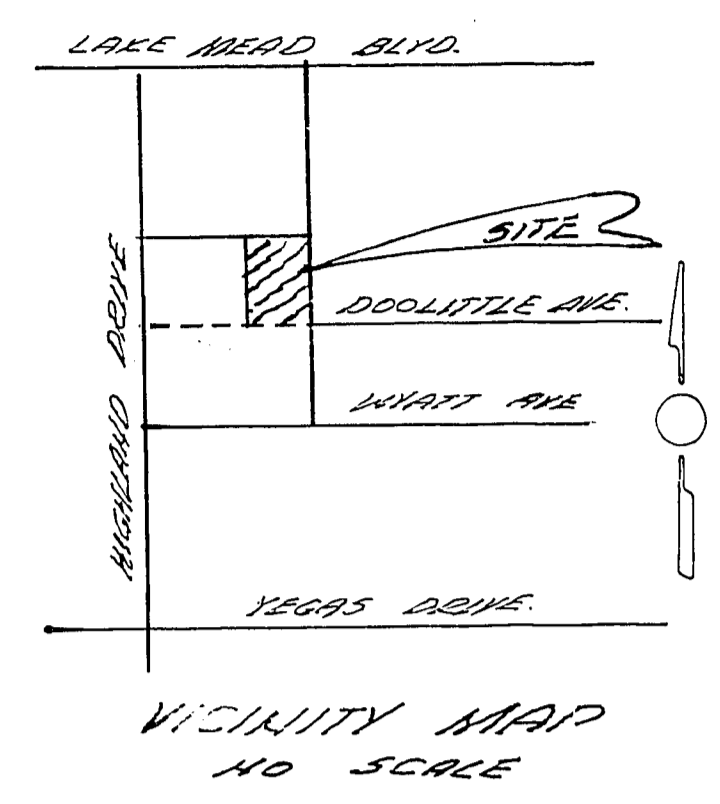
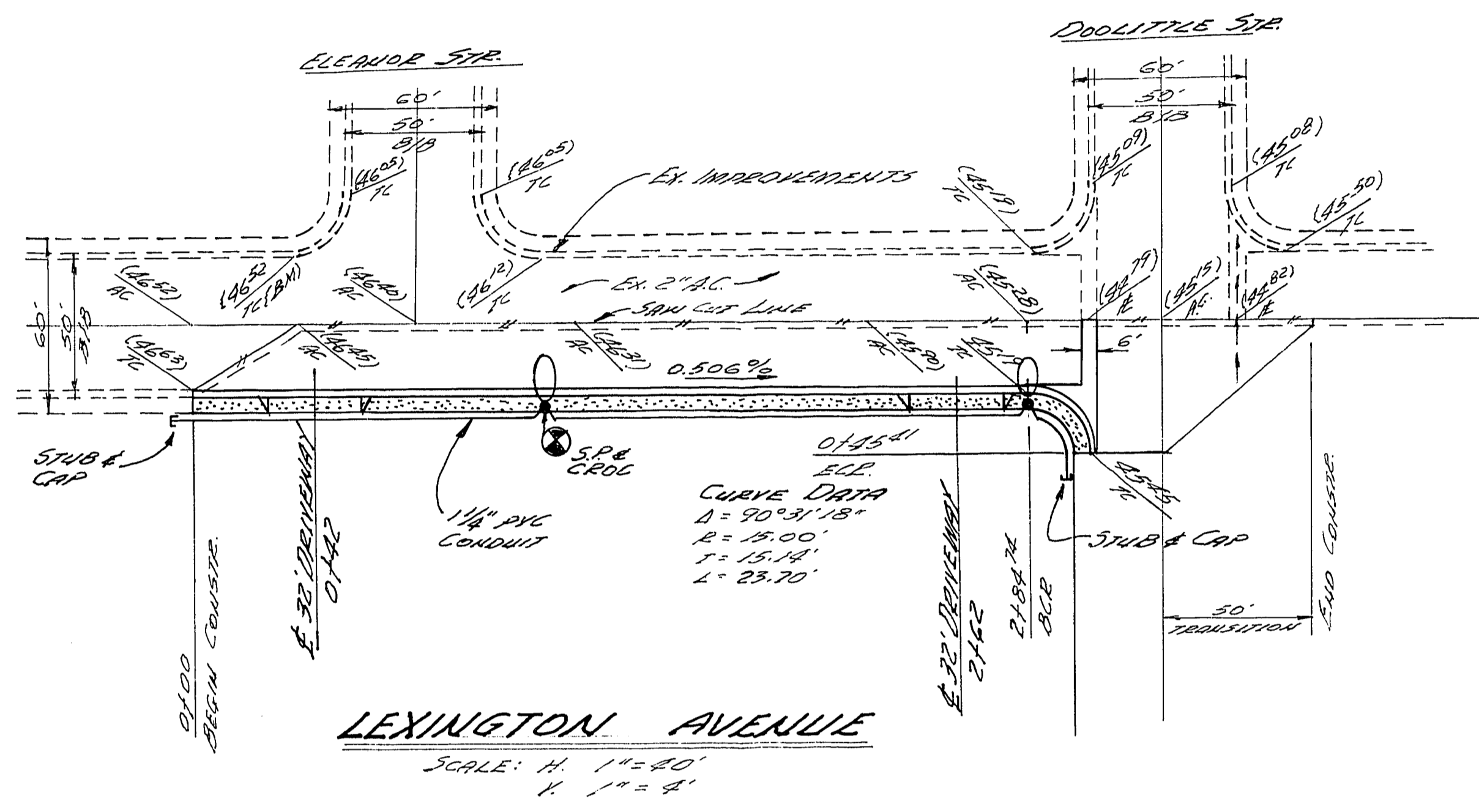

NOTES

ALL CONSTRUCTION SHALL CONFORM TO LATEST STANDARD DRAWINGS AND THE STANDARD SPECIFICATIONS FOR PUBLIC WORKS CONST., CLARE COUNTY, NEBRASKA, 1978 EDITION.

SERVICE WIRE = 2#25 & 1#6 THW

FIELD WIRE = 2#4'S THW & 1#6 GREEN

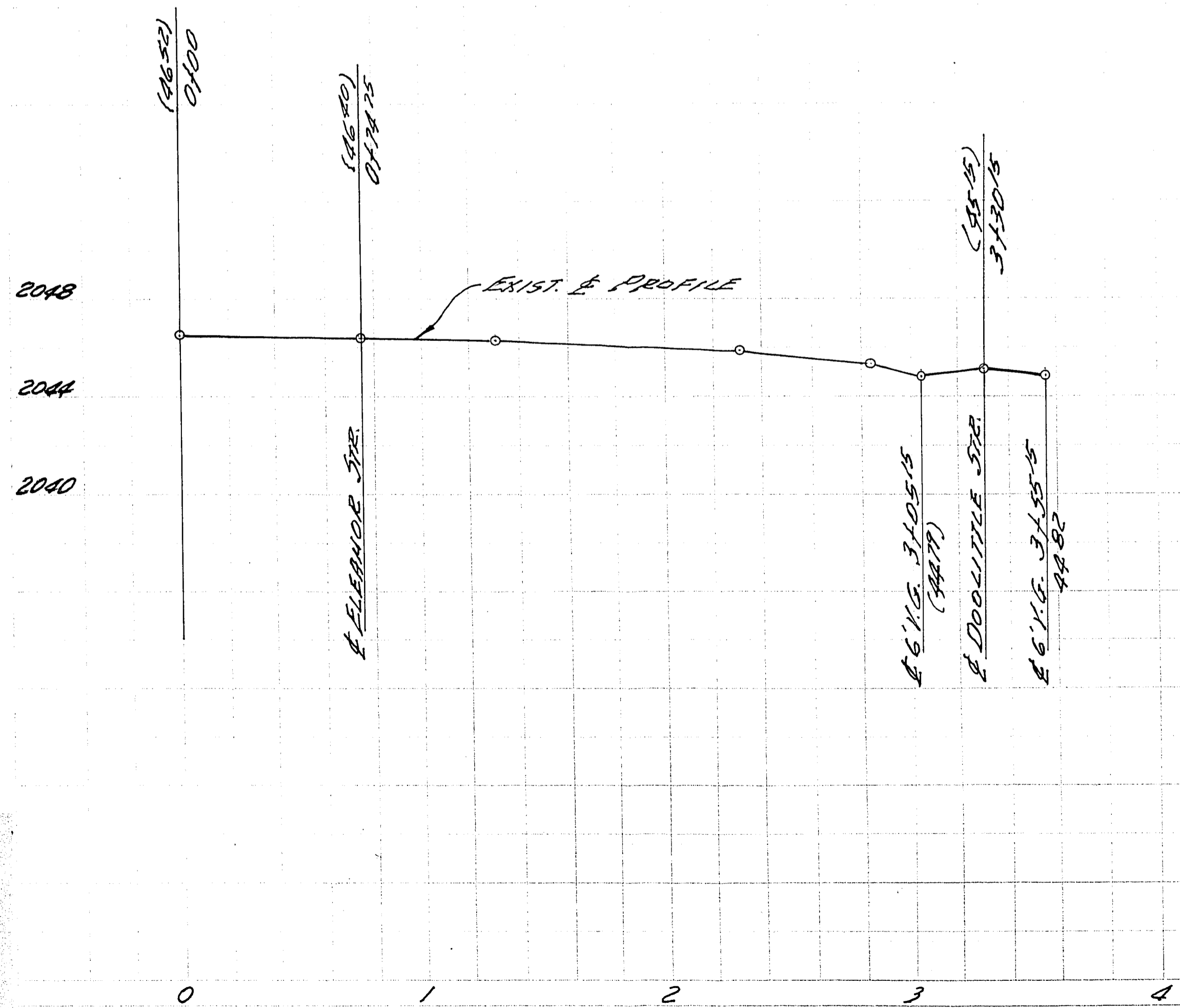

BENCH MARK:
C.L.V. # 06121/D10
ELEV. 2046.52

APPROVALS:

Jan 7 1979
CLV CITY ENGINEER DATE

E. J. [Signature]
CLV QUALITY CONTROL ENGINEER DATE 3/3/79

[Signature]
ELECTRICAL COORDINATOR DATE 5/28/79

[Signature]
CLV TRAFFIC ENGINEER DATE 6-14-79

[Signature]
FIRE DEPARTMENT DATE 8-7-79

[Signature]
CLV ELECT. SUPERVISOR DATE 8-8-79

SUBMITTED BY:
Mark C. Rudy
MARK C. RUDY, P.E. DATE
NEB. REG. NO. #1726

NOTE: OFFSITE IMPROVEMENTS ON DOOLITTLE ARE TO BE INSTALLED IN THREE YEARS.

OFF SITE IMPROVEMENTS
FOR
EVERGREEN BAPTIST CHURCH