

JOB NO. 660.D.12

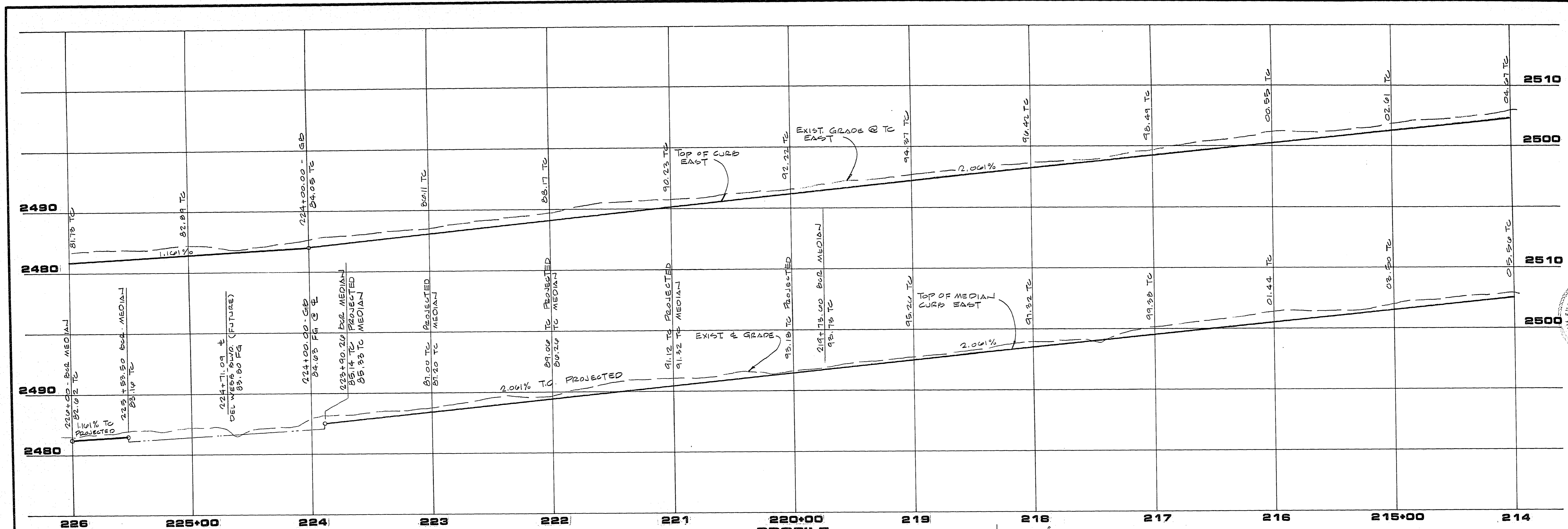

**BCR CURVE DATA**

NO	Δ	R	L	T
B	180° 00' 00"	2.83'	8.39'	-
C	11° 28' 42"	300.00'	00.10'	30.15'
D	11° 28' 42"	300.00'	00.10'	30.15'
E	16° 17' 36"	5.00'	14.03'	30.30'
F	18° 42' 24"	150.00'	48.97'	24.71'

**PROFILE**  
 SCALE: HORIZ. 1"=40'  
 VERT. 1"=8'

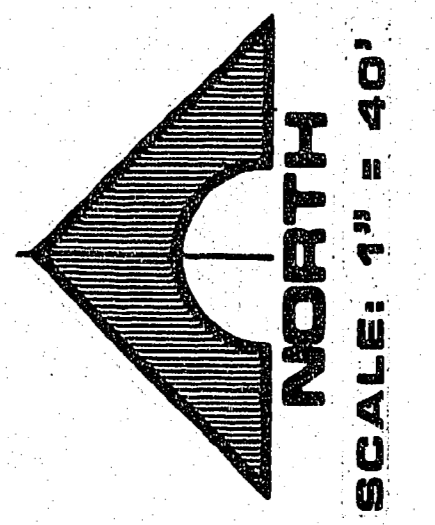
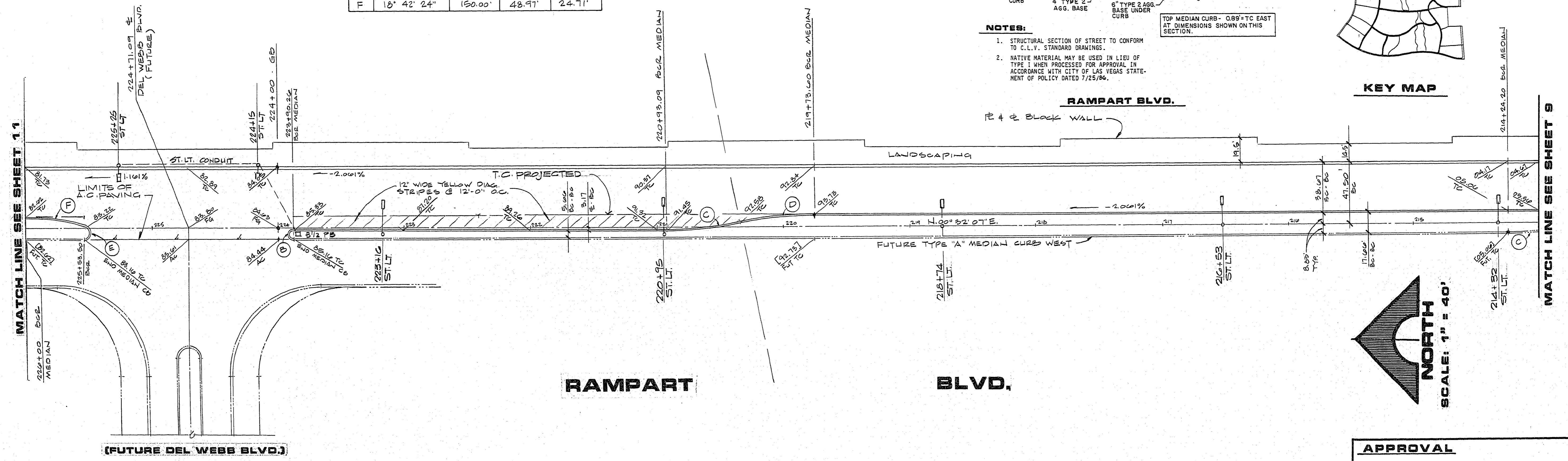
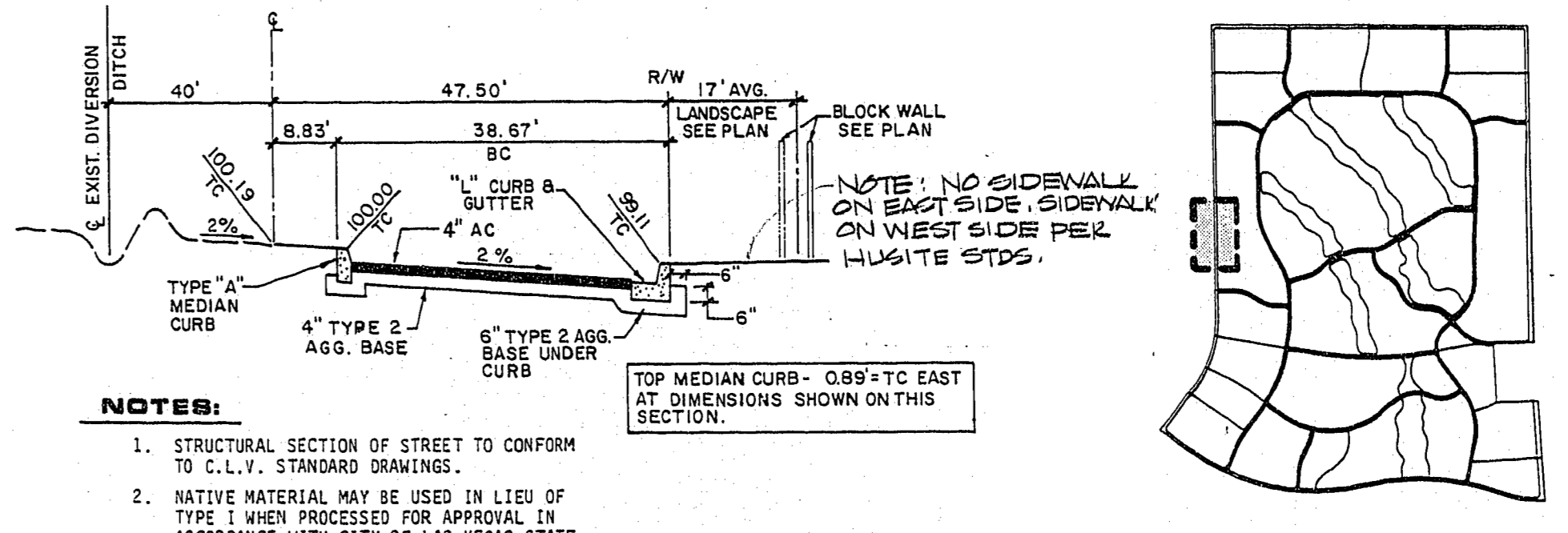

**APPROVAL**  
 N/A  
 CLV CHIEF LAND DEVELOPMENT  
 DATE

RECOMMENDED BY <i>Jan 21, 2012</i>	DATE 1-22-88	DESCRIPTION
REV	DATE	DESCRIPTION
3383	1-22-88	REV. NO.
<p>DESERT SHORES DEVELOPMENT COMPANY          DESERT SHORES - PHASE IA          RAMPART BLVD.          STA. 214+00.00 TO STA. 226+00.00</p>		
<p>G.C. WALLACE, INC.          Engineering/Architecture          1555 SOUTH RAINBOW BLVD. LAS VEGAS, NEVADA 89109</p>		
SHEET		10
OF 23 SHEETS		