

PROFILE
 HORIZ. 1"=40'
 VERT. 1"=8'

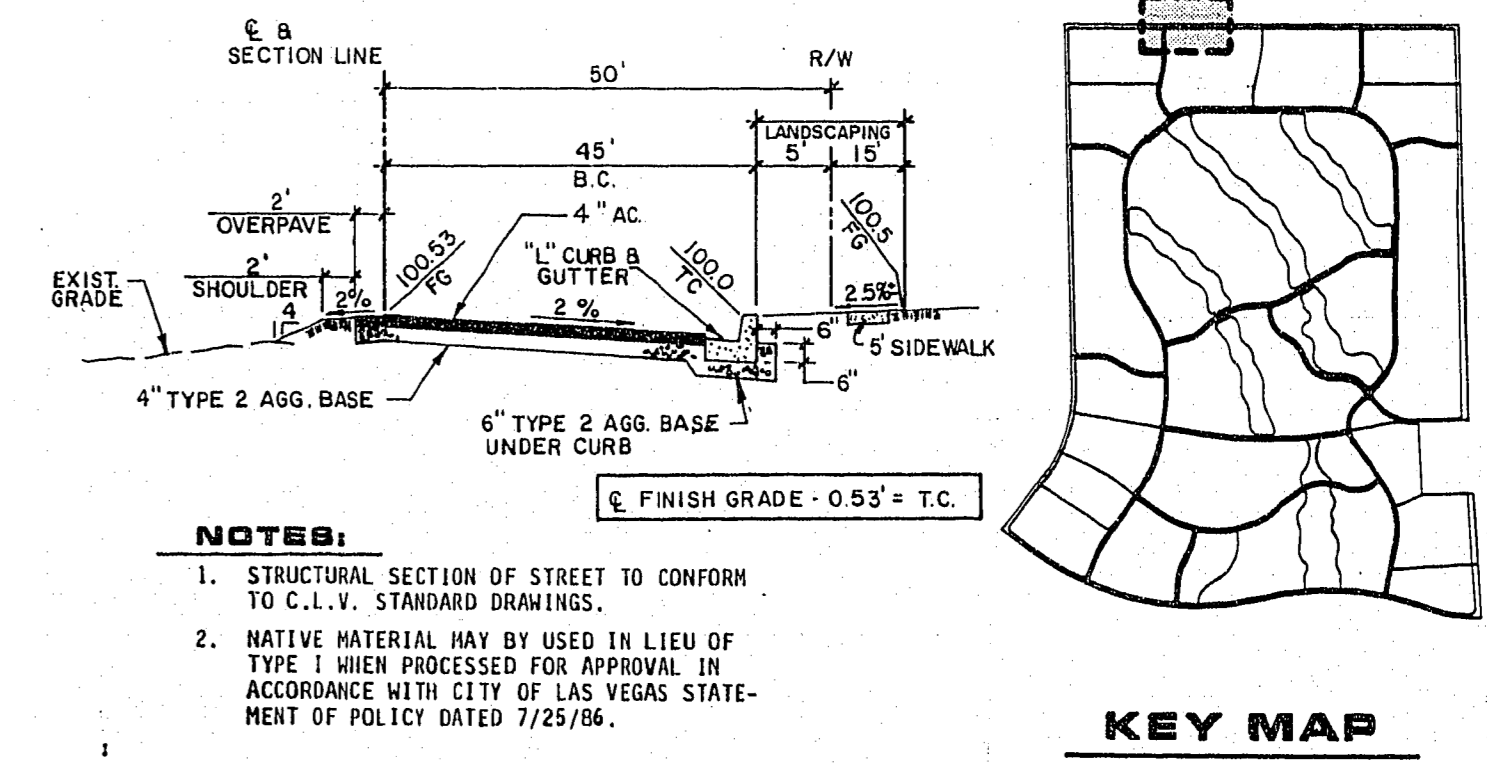

- NOTES:**
- STRUCTURAL SECTION OF STREET TO CONFORM TO C.L.V. STANDARD DRAWINGS.
 - NATIVE MATERIAL MAY BE USED IN LIEU OF TYPE I WHEN PROCESSED FOR APPROVAL IN ACCORDANCE WITH CITY OF LAS VEGAS STATEMENT OF POLICY DATED 7/25/86.

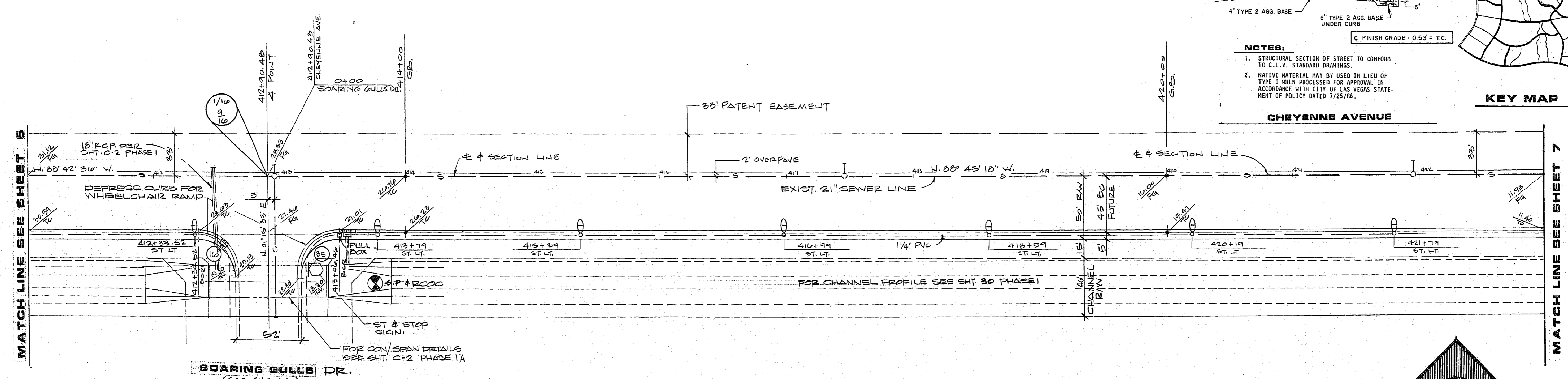

MATCH LINE SEE SHEET 5

MATCH LINE SEE SHEET 7

CHEYENNE AVENUE

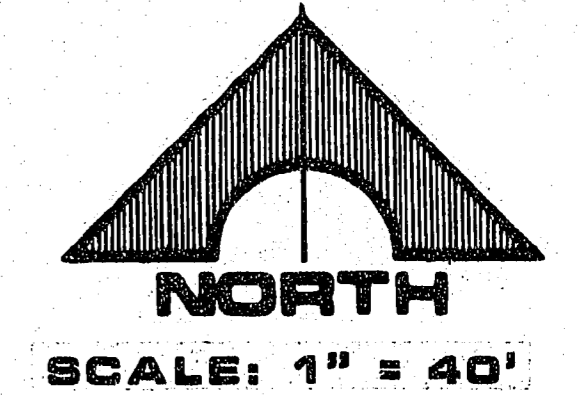

BCR CURVE DATA

NO	Δ	R	L	T
10	89° 58' 09"	30.00'	47.11'	29.98
33	89° 59' 09"	30.00'	47.12'	29.99

APPROVAL
 [Signature]
 CLV CHIEF LAND DEVELOPMENT
 DATE 5-29-88

REVISIONS	DATE	DESCRIPTION
1	1-27-88	16-88 APP. ED. CON. / GRAN.
2	5-29-88	DATE

RECOMMENDED BY: [Signature]
 DATE: 5-29-88

155 SOUTH RAINBOW BLVD. LAS VEGAS, NEVADA 89101

G.C. WALLACE, INC.
 Engineering/Architecture

DESERT SHORES DEVELOPMENT COMPANY
 DESERT SHORES - PHASE 1A
 CHEYENNE AVENUE
 STA. 411 + 00.00 TO STA 423 + 00.00

SHEET 8 OF 23 SHEETS

JOB NO. 660.012