

STR. 144+20 MATCH LINE - SEE SHEET 43

STR. 156+20 MATCH LINE - SEE BELOW LEFT

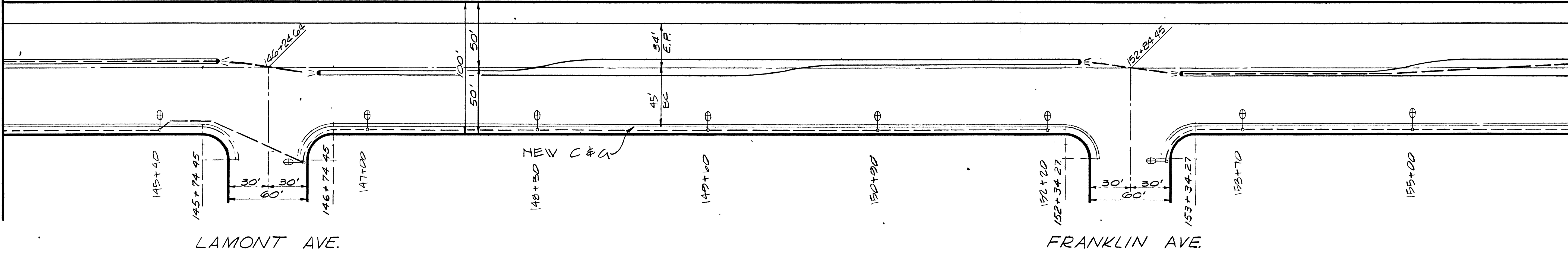

LAMONT AVE.

FRANKLIN AVE.

STR. 156+20 MATCH LINE SEE ABOVE RIGHT

STR. 167+00 MATCH LINE - SEE BELOW LEFT

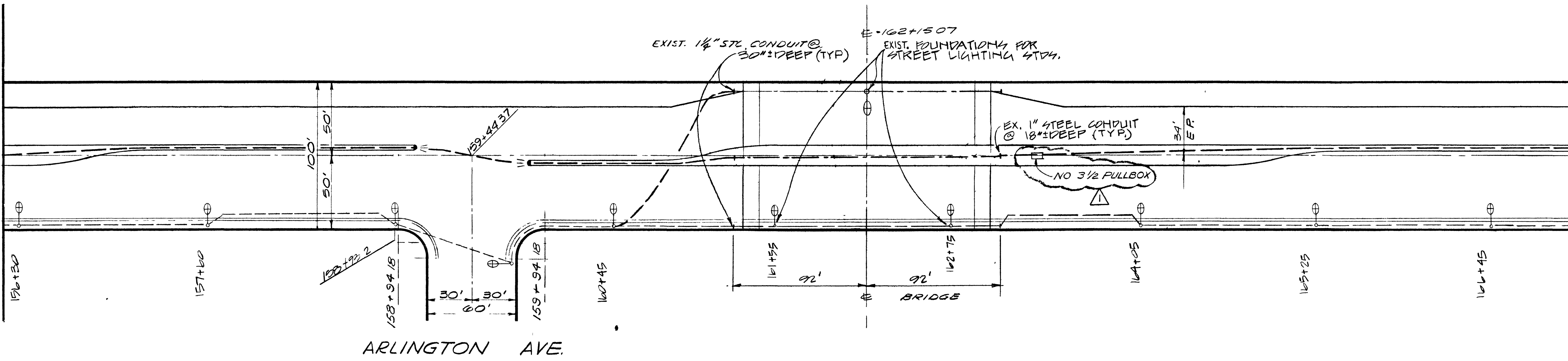

ARLINGTON AVE.

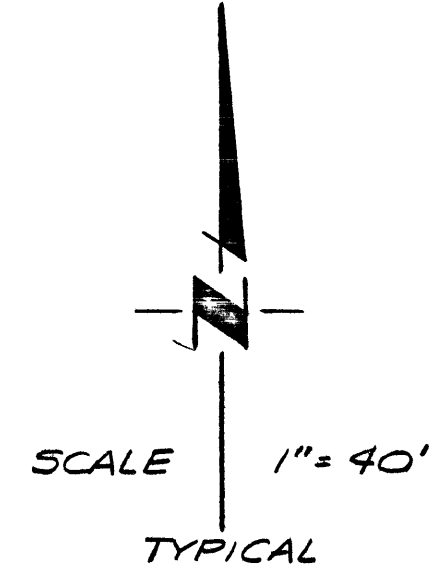

STR. 167+00 MATCH LINE - SEE ABOVE RIGHT

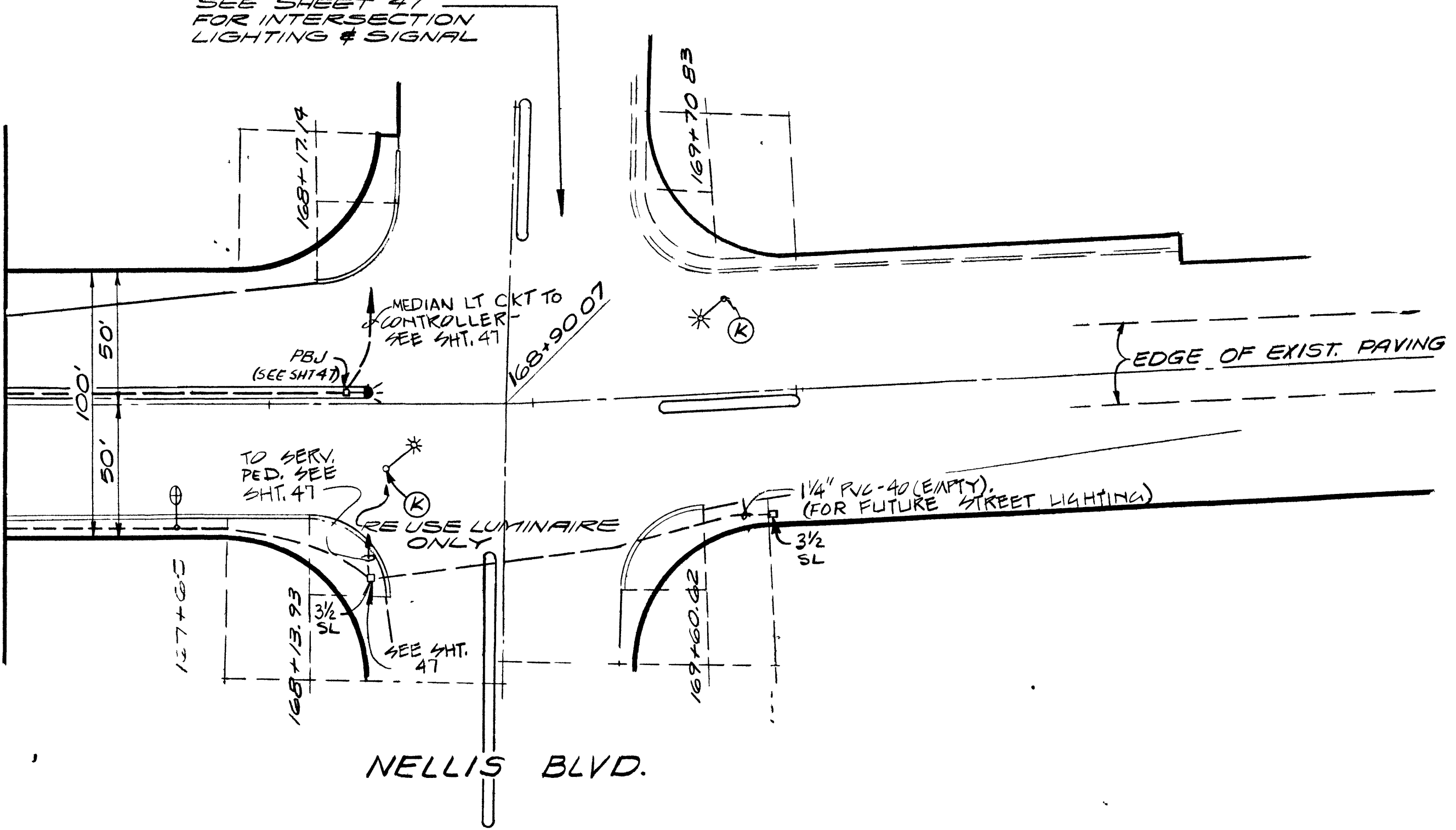

NELLIS BLVD.

NOTE:
 USE MODIFIED STREET LIGHT STANDARD
 W/ 29'-5" MOUNTING HEIGHT AT STA
 161+55, 162+15.07 & 162+75 (3 REQ'D)

Horbert fluid REE 3447

AS BUILT DRAWING.

REV	DATE	DESCRIPTION
1	05-27-15	AS BUILT
2	08-15-15	DATE
3	08-15-15	DATE
4	08-15-15	DATE
5	08-15-15	DATE

WALLACE - MONTGOMERY, A JOINT VENTURE
 G. C. WALLACE, Consulting Engineer
 MONTGOMERY ENGINEERS OF NEVADA
 735-5709
 LAS VEGAS, NEVADA

REGIONAL STREET AND HIGHWAY COMMISSION, CLARK CO., NEV
 EAST CHARLESTON BLVD FROM FREMONT ST. TO NELLIS BLVD
STREET AND MEDIAN LIGHTING PLAN
 144+20 TO 172+30

SHEET
44
 OF 53 SHEETS