

SCALE: HORIZ. 1"=40'
VERT. 1"=4'

▲ BENCH MARK
STA 111+05.81' N. OF & ON
EAST SIDE OF MOONLIGHT
DR. WHITE BOLT ON COLLAR
ON FH. ELEV. = 1756.75
CLW DATUM

EXIST. CURB, CUTTER & SIDEWALK
TO BE REMOVED & REPLACED

EXIST. TC (EXIST. TC)

EXIST. POINT

EXIST. GROUND

EXIST. GROUND

EXIST. GROUND

EXIST. GROUND

EXIST. GROUND

EXIST. GROUND

EXIST. GROUND

EXIST. GROUND

Δ	90° 01' 20"	25.00'	25.01'	39.25'
∠	89° 58' 40"	25.00'	24.99'	39.25'
R				
T				
L				

CURVE DATA, BACK OF CURB

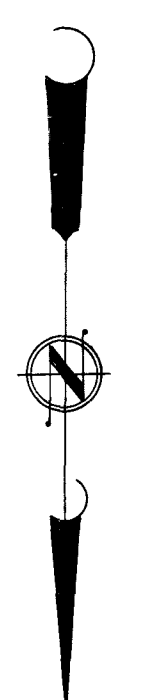
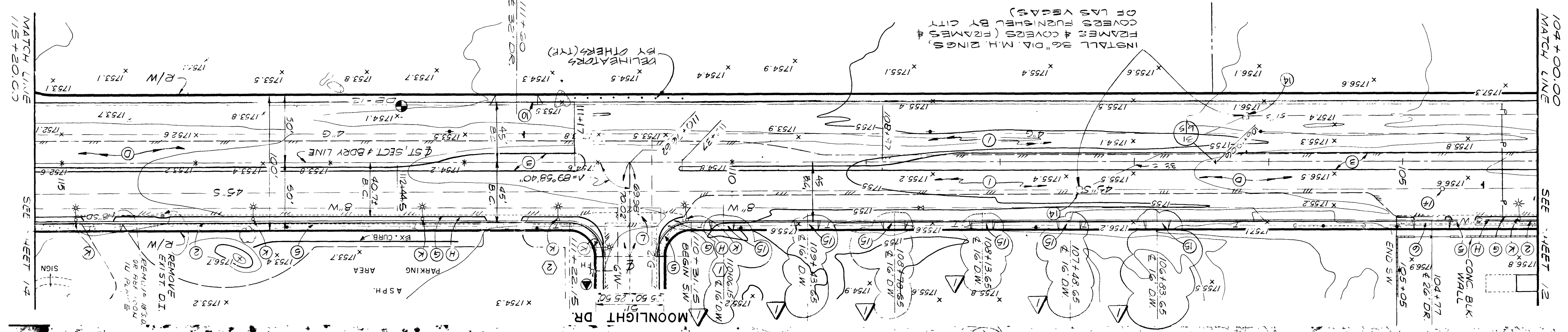

AS BUILT DRAWING

107-V-943
OF 3 SHEETS

SHEET
3

REGIONAL STREET AND HIGHWAY COMMISSION, CLARK CO., NEV.
EAST CHARLESTON BLVD. FROM FREMONT ST. TO NELLIS BLVD.
PLAN AND PROFILE
104+00 TO 115+20

WALLACE - MONTGOMERY, A JOINT VENTURE
G. C. WALLACE, Consulting Engineer
735-5199
MONTGOMERY ENGINEERS OF NEVADA
735-7198
LAS VEGAS, NEVADA

REVISIONS
NO. DATE
18/15 5/1/72
23/15 5/2/73
23/15 5/2/73

REV	DATE	DESCRIPTION
1	5-5-73	AS-BUILT

