

29+85.00 CONST. 18' COMM. D/W
 30+50.50 32.5' LT. REMOVE EXIST. D.I.
 30+50.50 33.75' LT. CONST. J.B. TYPE I
 30+59.69 CONST. D.I. TYPE II
 30+50.50 33.75' LT. TO 30+59.69 40' LT.
 INSTALL 12' L.F. 18' S.S.P.

30+14.91 CONST. D.I. TYPE I
 30+33.0 23' RT. CONST. J.B. TYPE II
 30+30.5 34.2' RT. TO 30+33.0 23' RT.
 REMOVE EXIST. D.I. & I.I.F.
 15' R.C.P.
 30+14.91 45' RT. TO 30+33.0 23' RT.
 INSTALL 29' L.F. 15' S.S.P.
 0+86.00 TO 2+64.50 (8th. ST.)
 CONST. 5' S/W.

- NOTES: 1. SEE SHEET No. 18 FOR LATERAL DETAILS.
 2. SEE SHEETS No. 19 & 20 FOR STORM DRAIN DETAILS.
 3. SEE SHEET No. 3 FOR A.C. TRANSITION AND FOR COMM. D/W TRANSITIONS.
 4. SEE SHEET No. 4 FOR PRIVATE WALK TRANSITIONS.
 5. SEE SHEET No. FOR CONCRETE TRANSITIONS SECTION C-C.
 6. WHEEL-CHAIR RAMP SHALL BE CONSTRUCTED AT ALL CURB RETURNS, SEE SHEET No. 21 FOR DETAILS.
 7. TRIMMING OF BUSHES MAY BE REQUIRED BY THE ENGINEER. ALL WORK TO BE PERFORMED BY THE CITY FORCES.

D-LOAD CHART

| LEG | D-LOAD U.L.T. |
|-----|---------------|
| ▲ | 2885 |
| ▲ | 2358 |

CURVE DATA

| NO. | LOC. | RAD. | DELTA | TAN | LENGTH |
|-----|------|------|--------------|--------|--------|
| 1 | B.C. | 20' | 62° 08' 59" | 12.05' | 21.69' |
| 2 | B.C. | 20' | 118° 15' 45" | 33.46' | 41.28' |
| 3 | B.C. | 20' | 113° 27' 17" | 30.48' | 39.60' |
| 4 | B.C. | 20' | 66° 07' 59" | 13.02' | 23.08' |

| | | |
|-----------------------|---|-------------------|
| Scale (H) 1" = 20' | Scale (V) 1" = 2' | W.O. no. 7719 |
| Fid. bk. no. 70-5X | Date | Drawn by P. WHITE |
| Design by C. KREHNOVI | Approved by the Director of Public Services | Date |
| Revisions | | Date |

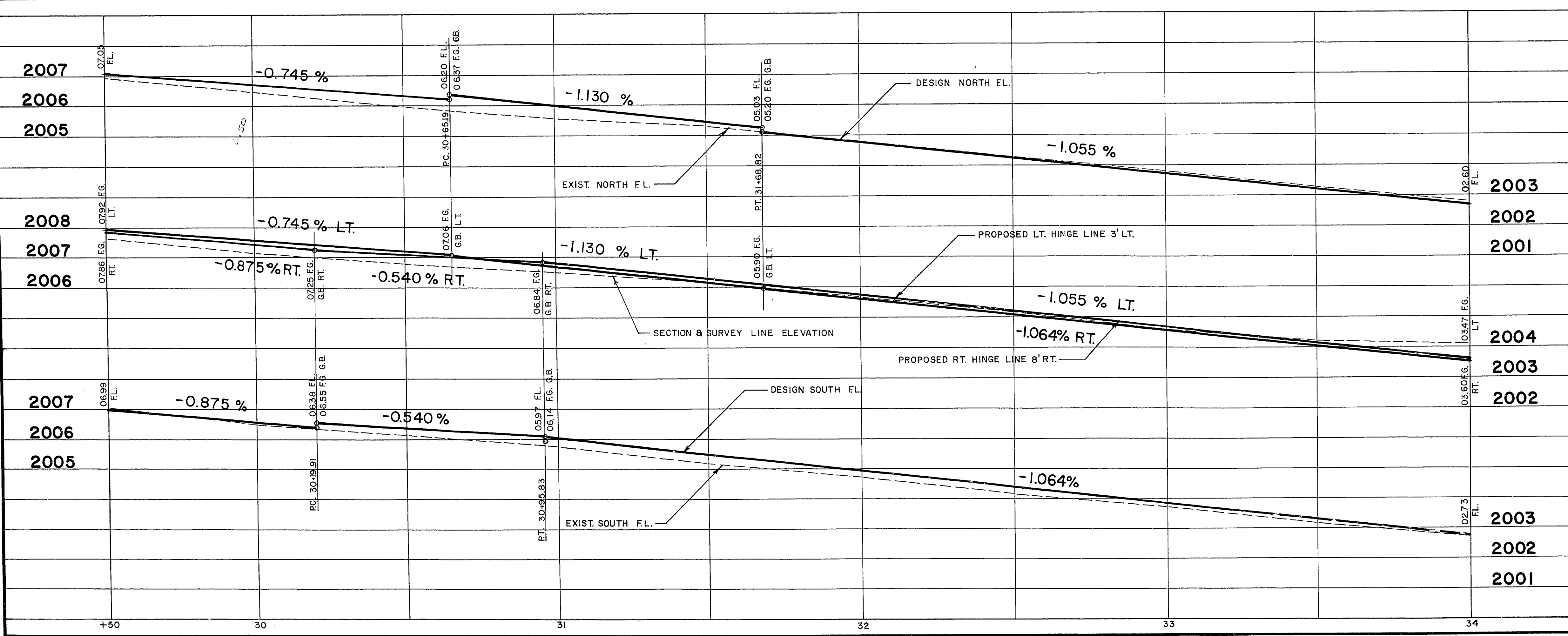

Department of Public Services Engineering Design Division

PLAN AND PROFILE

EAST CHARLESTON BLVD.
 MAIN ST. TO 10th. ST.
 PHASE I

Drawing no. 107V-829A 11/38

17-4-111