

NOTE: FOR CURVE DATA; SEE PLAN & PROFILE SHT. No. 9

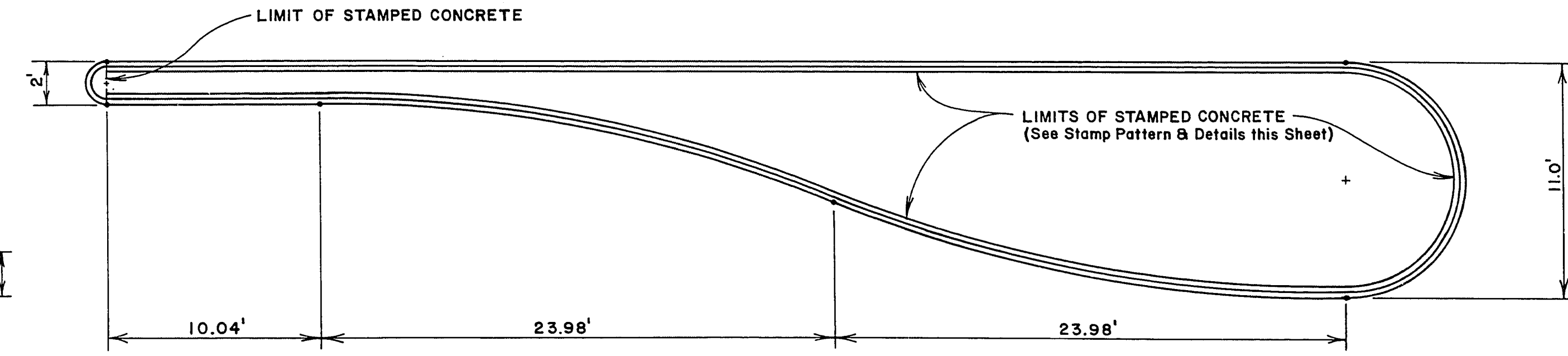

TYPICAL ISLAND DETAILS

SCALE: 1" = 5'

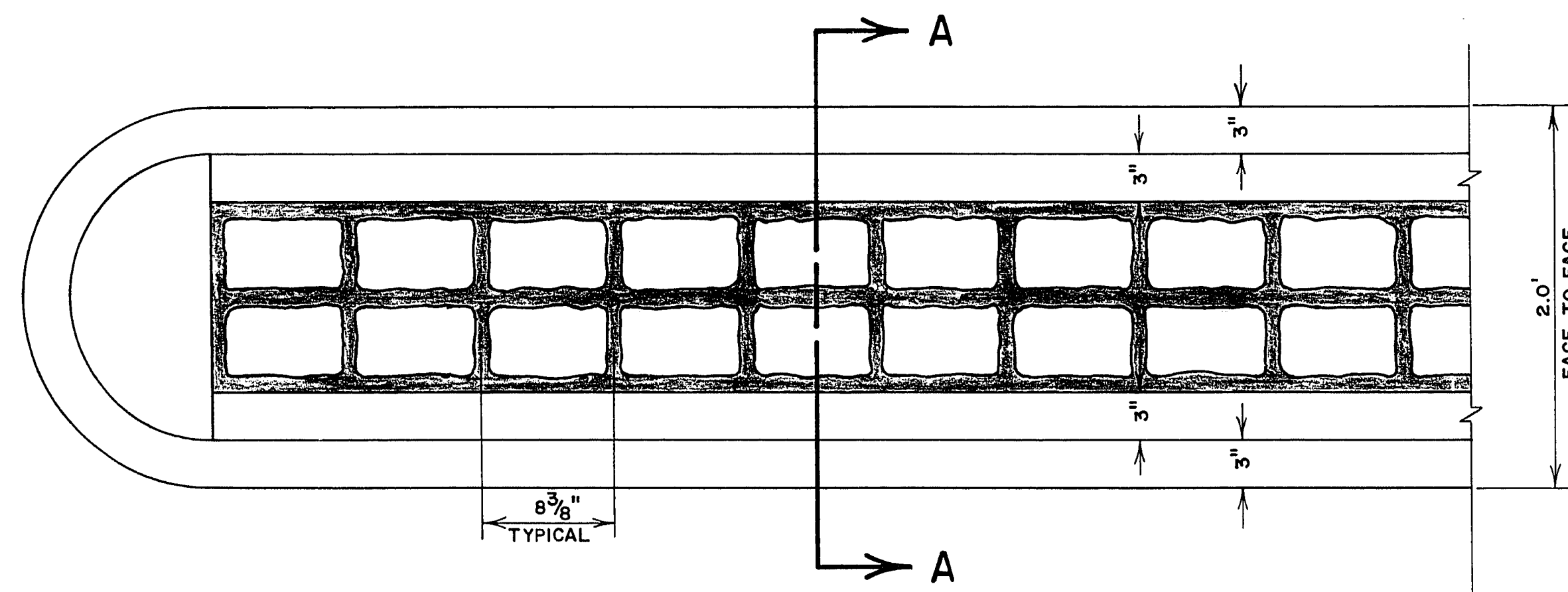

2' ISLAND STAMP DETAIL

SCALE: 1" = 1.5'

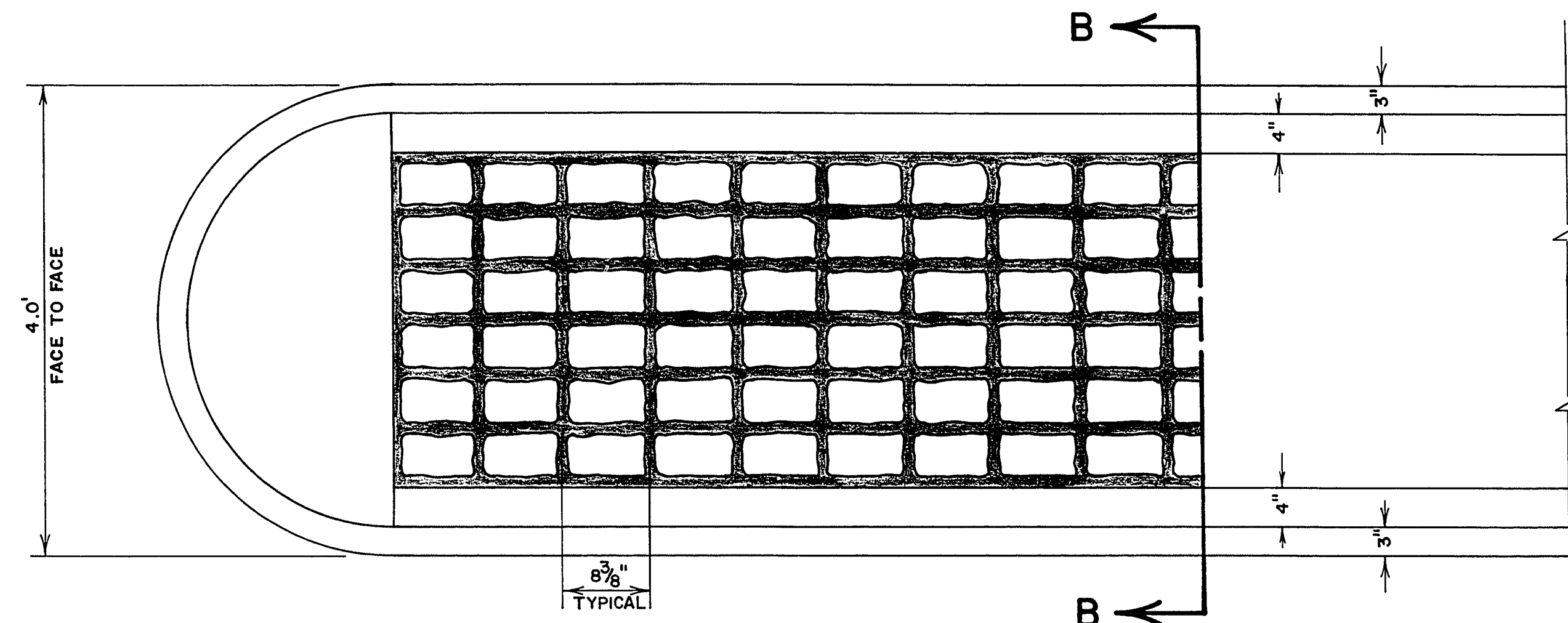

4' ISLAND STAMP DETAIL

SCALE: 1" = 1'

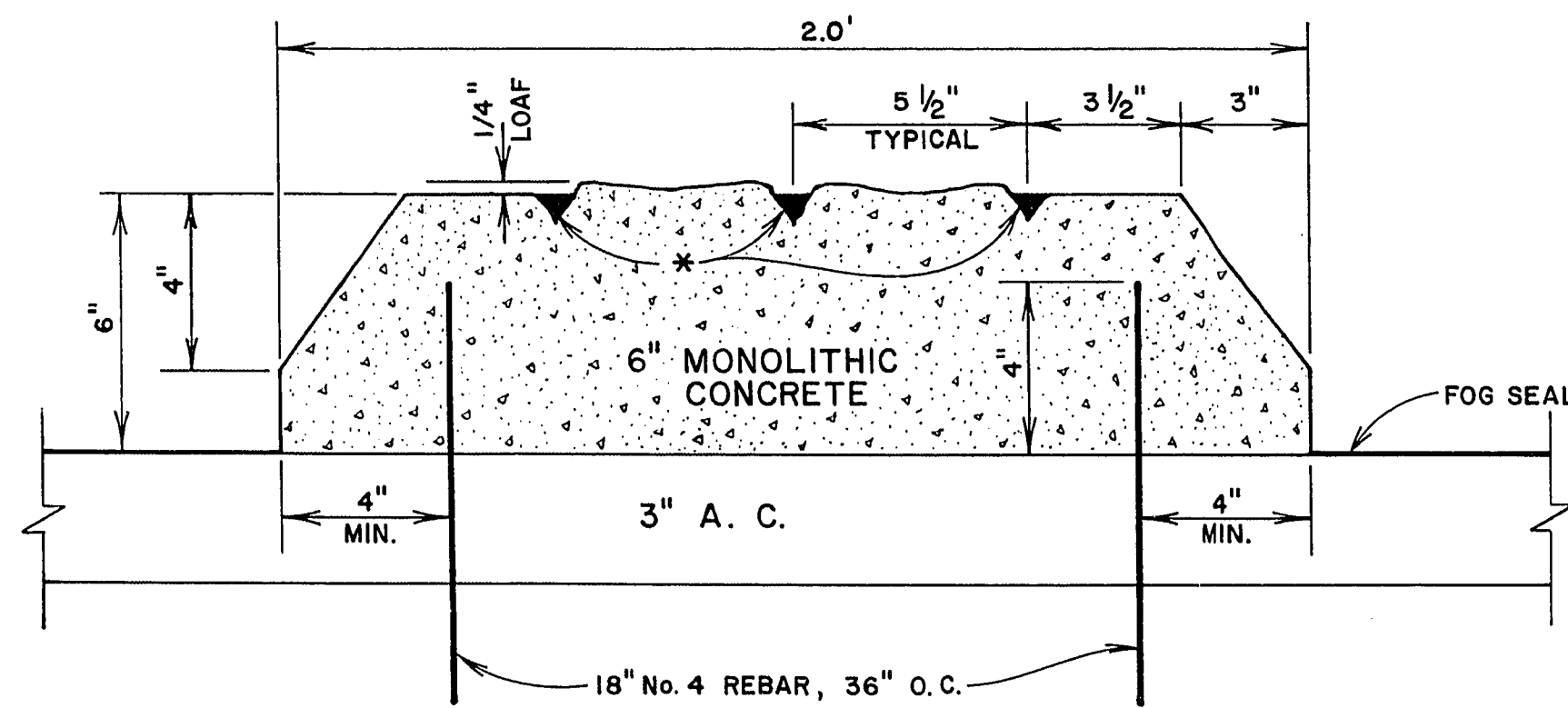

SECTION A - A

SCALE: 1" = 4"

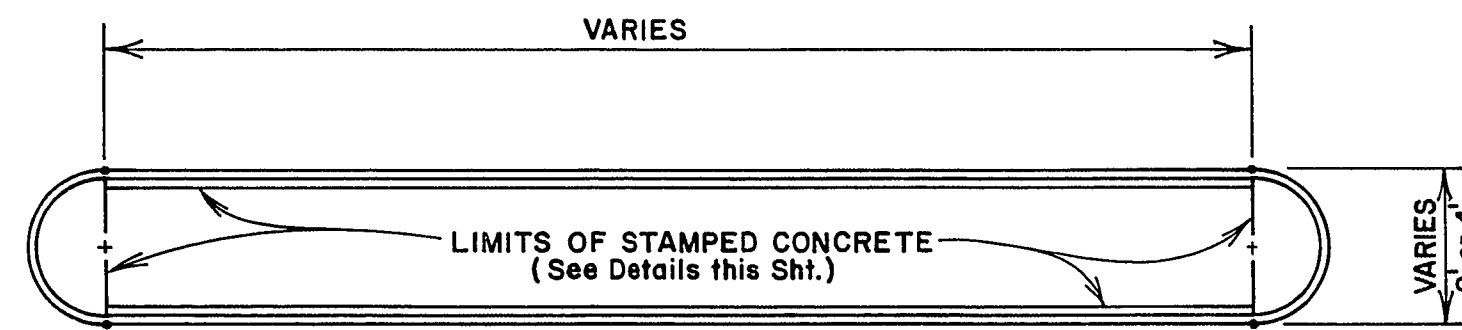

TYPICAL ISLAND DETAIL

NO SCALE

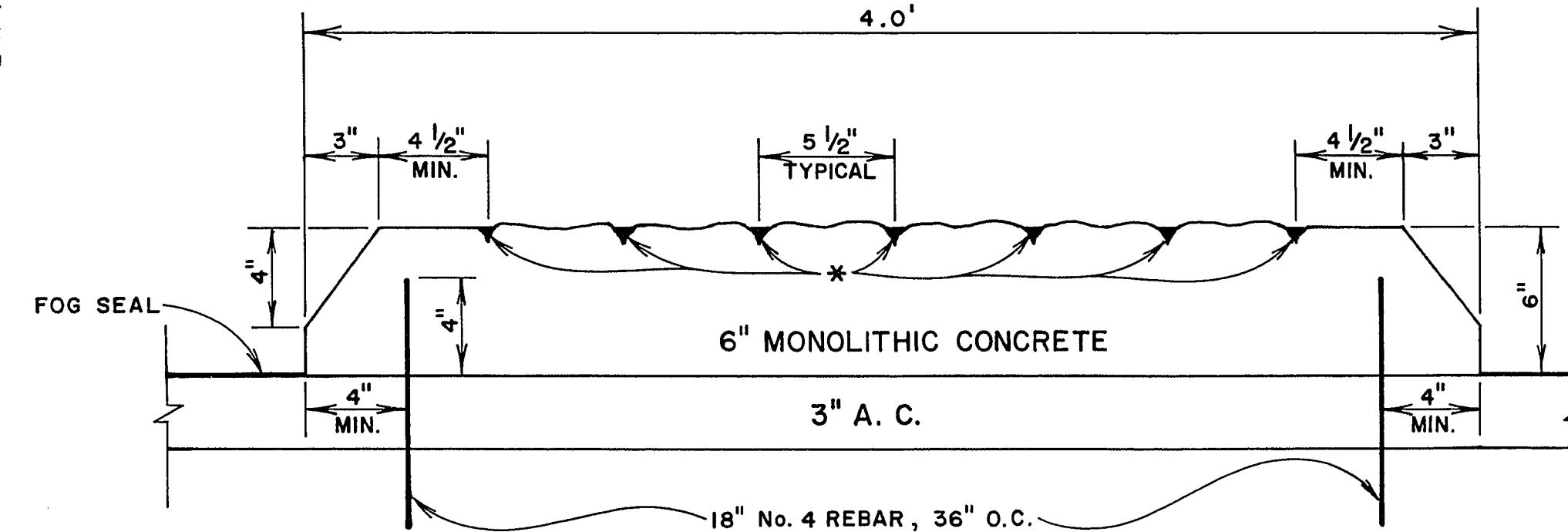

SECTION B - B

SCALE: 1" = 6"

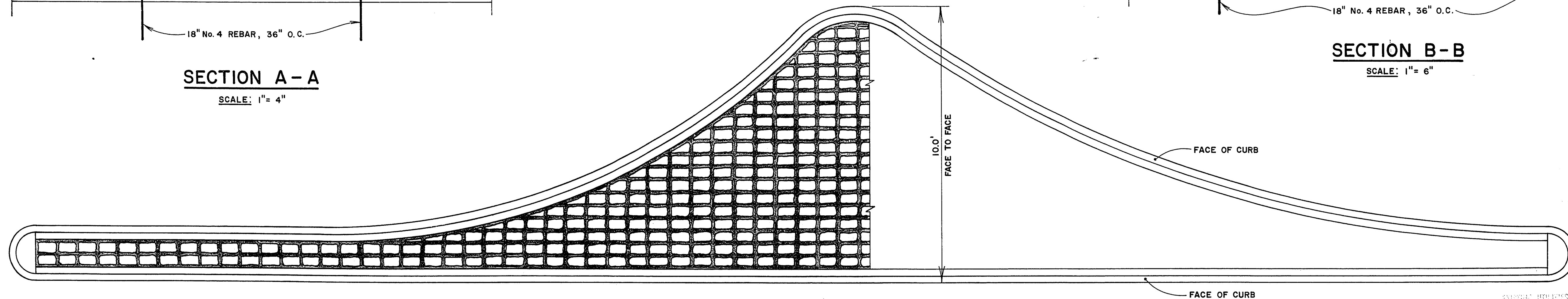

TOP VIEW OF COBBLESTONE STAMP PATTERN

SCALE: 1" = 2'

Scale (h) AS SHOWN	Scale (v) NONE	W.O. no. 7719
Fid. bk. no. 70-5X	Date	
Design by C. KREHNOVI	Drawn by S. S. NORATH	Date
Approved by the Director of Public Services		Date
Revisions		Date

C. Krehnovi
2/15/79

Department of Public Services Engineering Design Division
STAMPED CONCRETE ISLAND
DETAILS
(ADDITIVE ALTERNATE)

EAST CHARLESTON BLVD.
MAIN ST. TO 10th ST.
PHASE I

Drawing no. 107V-829 A 22/38

FEB 19 1979

CONTRACT MEMORANDUM NO. 107V-829 A, THE PLANS FOR THE CONSTRUCTION OF THE STAMPED CONCRETE ISLANDS AT THE INTERSECTION OF EAST CHARLESTON BLVD. AND MAIN ST. TO 10th ST. PHASE I, ARE HEREBY APPROVED FOR THE CITY OF LAS VEGAS. THE CONTRACTOR SHALL BE RESPONSIBLE FOR OBTAINING ALL NECESSARY PERMITS AND FOR THE PROTECTION OF ALL UTILITIES AND EXISTING STRUCTURES. THE CONTRACTOR SHALL ALSO BE RESPONSIBLE FOR THE PROTECTION OF ALL ADJACENT PROPERTIES AND FOR THE PROTECTION OF ALL ADJACENT TRAFFIC. THE CONTRACTOR SHALL ALSO BE RESPONSIBLE FOR THE PROTECTION OF ALL ADJACENT UTILITIES AND EXISTING STRUCTURES. THE CONTRACTOR SHALL ALSO BE RESPONSIBLE FOR THE PROTECTION OF ALL ADJACENT PROPERTIES AND FOR THE PROTECTION OF ALL ADJACENT TRAFFIC.

17-4-120