

11-4-60

STA. 44+00 TO STA. 49+00 - CLARK COUNTY

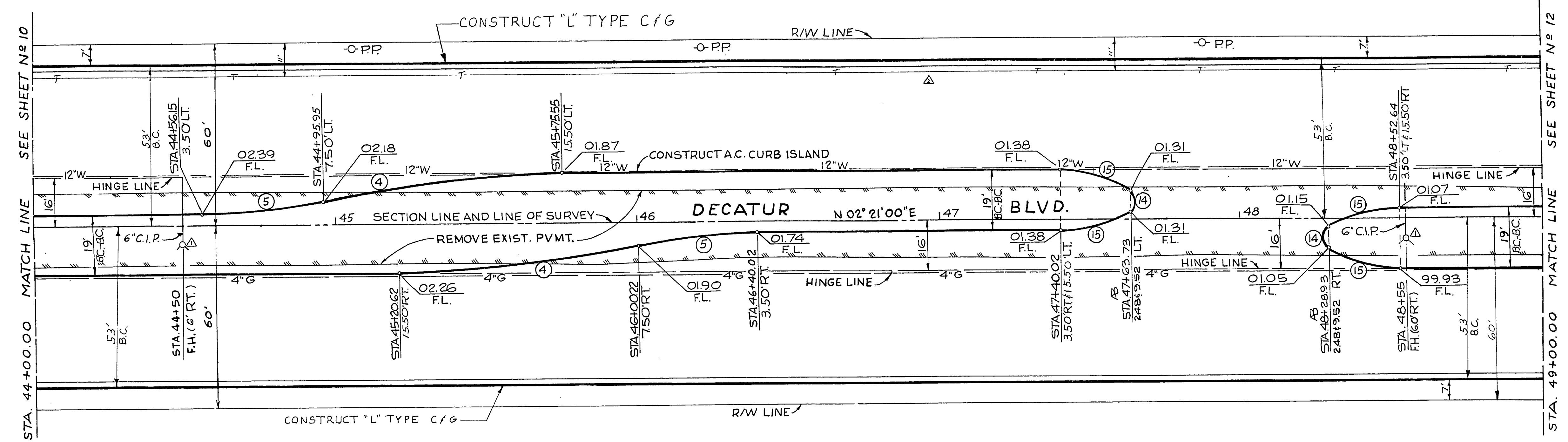

STA. 44+00 TO STA. 49+00 - CLARK COUNTY

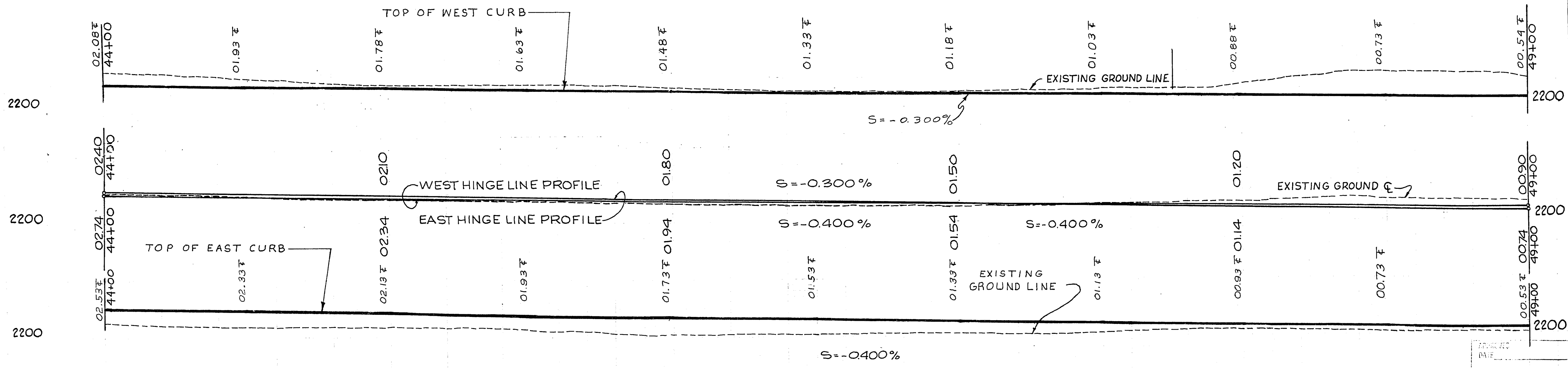

ITEM	DESCRIPTION	R.S.H.	CL.V. S.A.D.	CL.V.	CC.S.A.D.	TOTAL	UNIT
201100	EXCAVATION	1527			463	1730	C.Y.
302100	TYPE I GRAVEL BASE	433			170	603	C.Y.
302200	TYPE II GRAVEL BASE	433			89	522	C.Y.
320100	BIT. PENETRATION	955			775	955	S.Y.
333500	1/2" OPEN GRADE PLANK	3934			775	4712	S.Y.
334210	A.C. CURB (ISLAND)	852			775	852	L.F.
334212	G.A.C. PAVEMENT	3534			775	4712	S.Y.
340190	24" L TYPE CURB HYDRANT			2	1000	1000	L.F.
500500	INSTALL FIRE HYDRANT			2		2	EACH

CURVE	DELTA	RADIUS	LENGTH	TANGENT
④	11°28'42"	400.00'	80.13'	40.20'
⑤	11°28'42"	200.00'	40.07'	20.10'
⑥	12°23'22"	4.00'	8.61'	7.43'
⑦	28°18'19"	50.00'	24.70'	12.61'

REV	DATE	DESCRIPTION	APP.
1	3-27-69	DELETE 6" GATE VALVE'S AT FIRE HYDRANTS	
2	3-27-69	MOVED FIRE HYDRANTS TO CENTER OF ISLAND	
3	3-27-69	ADDED TELEPHONE CONDUIT	

CITY OF LAS VEGAS, NEVADA
ENGINEERING DEPARTMENT

DECATUR BLVD.
WASHINGTON AVE. TO U.S. HIGHWAY N° 95
STA. 44+00.00 TO STA. 49+00.00

W.D. 75 TO F 4810 DATE 3/5/69 HORIZONTAL SCALE 1" = 20'

DESIGN G.E.C. DRAWN HURTADO 12-6-66 VERTICAL SCALE 1" = 5'

CHECKED S.C.D. CONSULTING ENG. 5-17-61 F.B.N.P.

TRAFFIC ENG. CITY ENGINEER

PREPARED BY TYSON ENGINEERING COMPANY INC. SHEET 11 OF 42

"AS CONSTRUC"