

DECATUR

BOULEVARD

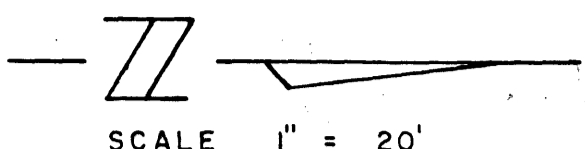

EXISTING B.C. CURVE DATA  
 $\Delta = 89^\circ 38' 35''$   
 $R = 20.00'$   
 $T = 19.88'$   
 $L = 31.29'$

EXISTING B.C. CURVE DATA  
 $\Delta = 90^\circ 21' 25''$   
 $R = 20.00'$   
 $T = 20.12'$   
 $L = 31.54'$

| ITEM   | DESCRIPTION                 | QUANTITY | UNIT |
|--------|-----------------------------|----------|------|
| 201.1  | ROADWAY EXCAVATION          | 95.1     | CY   |
| 340.3  | CONCRETE SIDEWALK           | 25.0     | SF   |
| 340.2  | ISLAND CURB (CONCRETE)      | 5.12     | LF   |
| 340.1  | CONCRETE CURB & GUTTER      | 4.8      | LF   |
| 512.51 | ADJUST MANHOLE              | 1        | EA   |
| 302.1  | TYPE I GRAVEL BASE          | 94.9     | CY   |
| 302.2  | TYPE II GRAVEL BASE         | 5.71     | CY   |
| 320.2  | ISLAND SUBGRADE TREATMENT   | 26.9     | SY   |
| 334.6  | ASPHALTIC CONCRETE 3        | 55.36    | SY   |
| 334.3  | ASPHALTIC CONCRETE 1 1/2"   | 5.23     | SY   |
| 334.22 | A.C. SHOULDER CURB          | 43.0     | LF   |
| 334.21 | A.C. ISLAND CURB            | 2.95     | LF   |
| 333.1  | FOG SEAL COAT               | 60.58    | SY   |
| 420.0  | SURVEY MONUMENT             | 1        | E.A. |
| 340.31 | CONCRETE (ISLAND SURFACING) | 3.52     | SF   |

| NO. | DELTA        | RADIUS | TANGENT | LENGTH |
|-----|--------------|--------|---------|--------|
| 8   | 16° 15' 37"  | 150.00 | 21.43   | 42.57  |
| 9   | 20° 36' 08"  | 90.00  | 16.36   | 32.36  |
| 10  | 138° 47' 44" | 4.00   | 10.64   | 9.69   |
| 11  | 180° 00' 00" | 1.50   | 4.71    | 4.71   |
| 2   | 16° 15' 37"  | 150.00 | 21.43   | 42.57  |

NOTE: ALL DIMENSIONS WHERE A.C. CURB IS BEING CONSTRUCTED ARE TO THE BACK OF THE FUTURE CONCRETE CURB SEE DETAIL, SHEET 11-

EXISTING UTILITIES ARE LOCATED ON THE PLANS FOR THE CONVENIENCE OF THE CONTRACTOR ONLY. THE CONTRACTOR SHALL BEAR FULL RESPONSIBILITY FOR PROTECTING ALL UTILITIES AND THE CITY BEARS NO RESPONSIBILITY FOR UTILITIES NOT SHOWN ON THE PLANS OR NOT IN THE LOCATION SHOWN ON THE PLANS.

ON AND OFF RAMPS TO LAS VEGAS EXPRESSWAY PROPOSED STATE HIGHWAY CONSTRUCTION AS SHOWN ON ADVANCE PRINT, PROJECT NO. 70304-1. DATED JAN. 10, 1967.

PROJECT BENCH MARK (STEEL PIN)  
 70' EAST OF STATION 24+00  
 ELEVATION = 2199.882

PLAN  
 DATE: \_\_\_\_\_ BY: \_\_\_\_\_  
 CHECKED: \_\_\_\_\_  
 NOTE: BOOK ALIGNMENT (SHOWN) IS TO BE MAINTAINED.

PROFILE  
 DATE: \_\_\_\_\_ BY: \_\_\_\_\_  
 CHECKED: \_\_\_\_\_  
 NOTE: GRADES CHECKED. STRUCTURE NOTATIONS CHECKED.

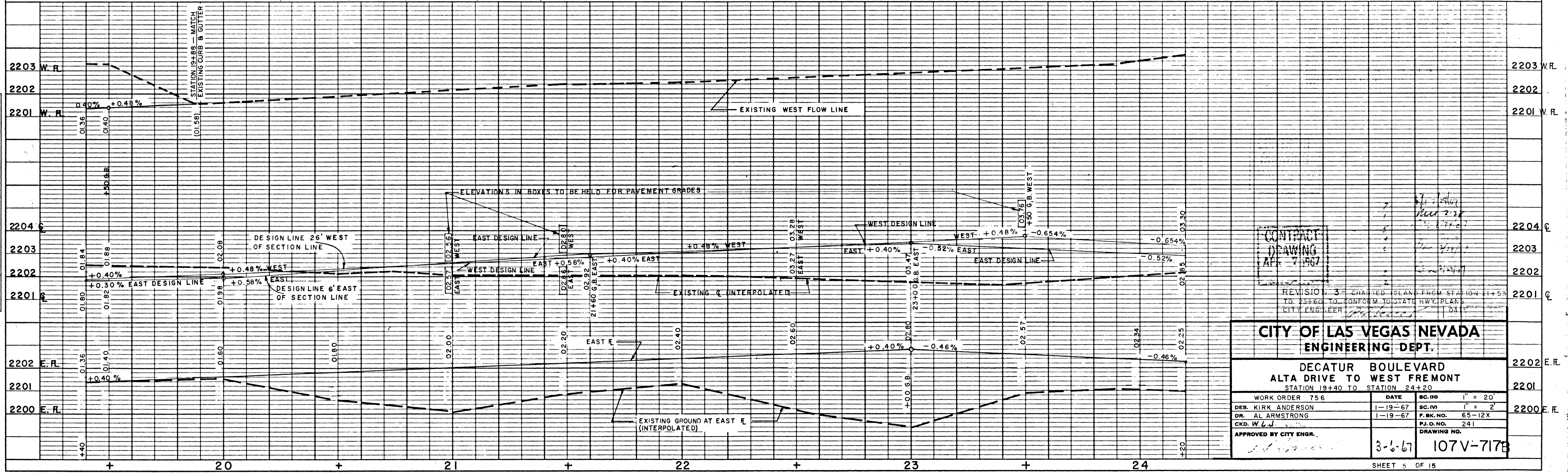
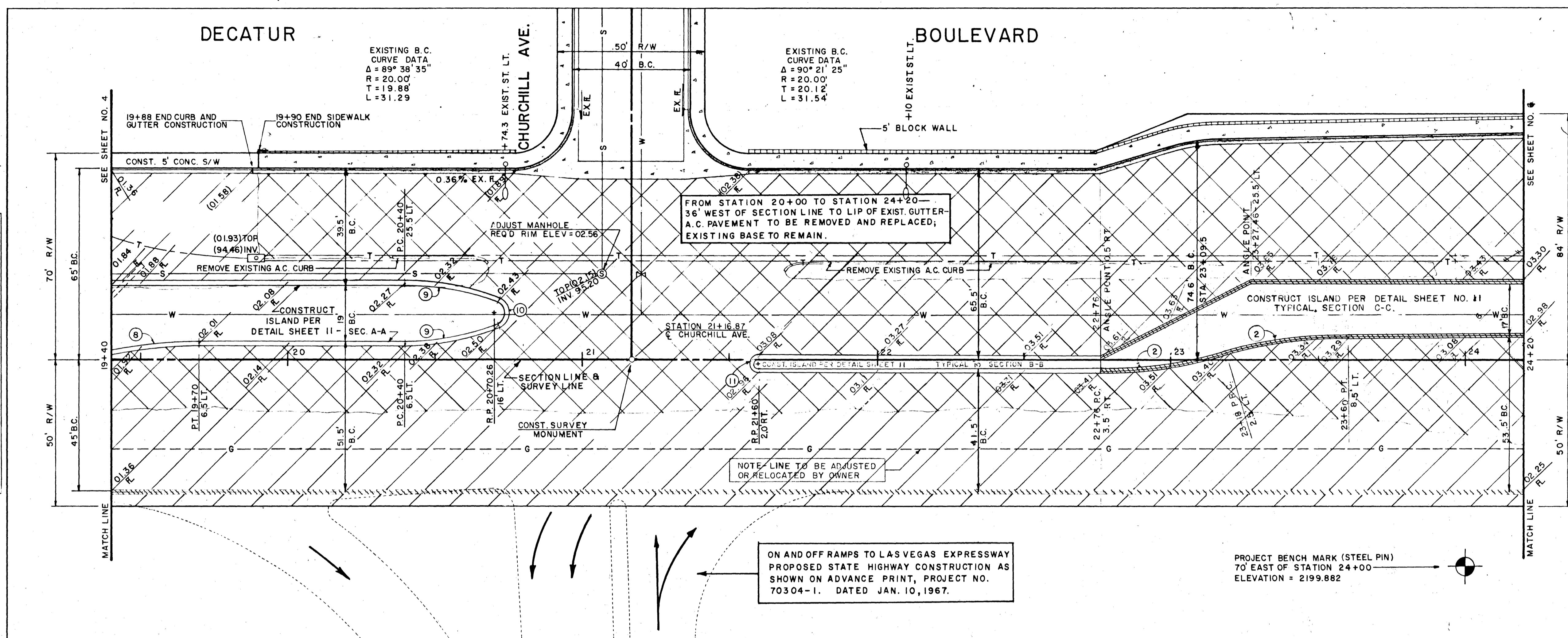

REVISION 3 CHANGED ISLAND FROM STATION 21+55 TO 23+60 TO CONFORM TO STATE HWY PLANS  
 CITY ENGINEER: \_\_\_\_\_ DATE: \_\_\_\_\_

**CITY OF LAS VEGAS NEVADA**  
**ENGINEERING DEPT.**

**DECATUR BOULEVARD**  
**ALTA DRIVE TO WEST FREMONT**  
 STATION 19+40 TO STATION 24+20

|                        |              |                       |
|------------------------|--------------|-----------------------|
| WORK ORDER 756         | DATE 1-19-67 | SC. 119 1" = 20'      |
| DR. AL ARMSTRONG       | 1-19-67      | SC. 119 1" = 2'       |
| CHK. W.L.              |              | P. BK. NO. 65-12X     |
| APPROVED BY CITY ENGR. | 3-6-67       | P.L.O. NO. 241        |
|                        |              | DRAWING NO. 107V-717B |

