

PLAN VIEW
STA: 0+00.00 TO 1+91.38

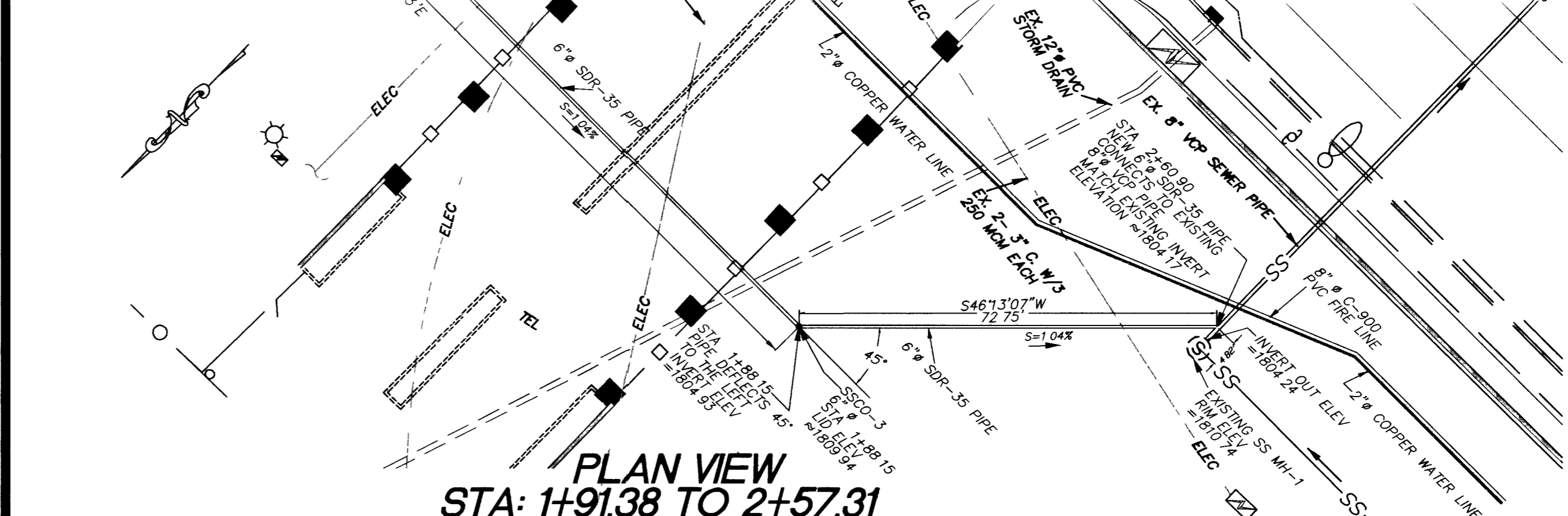

PLAN VIEW
STA: 1+91.38 TO 2+57.31

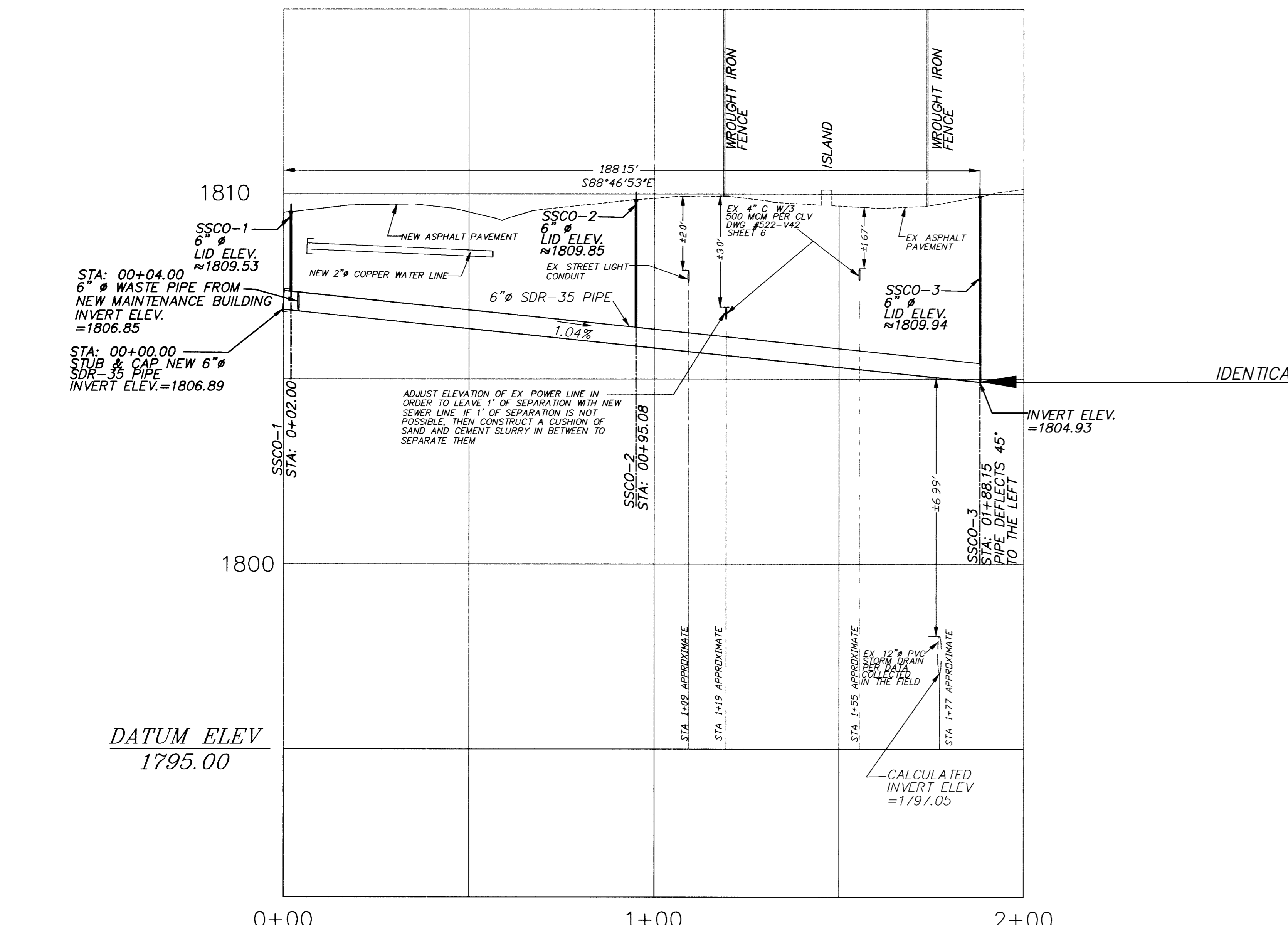

PROFILE VIEW
STA: 0+00.00 TO 1+91.38

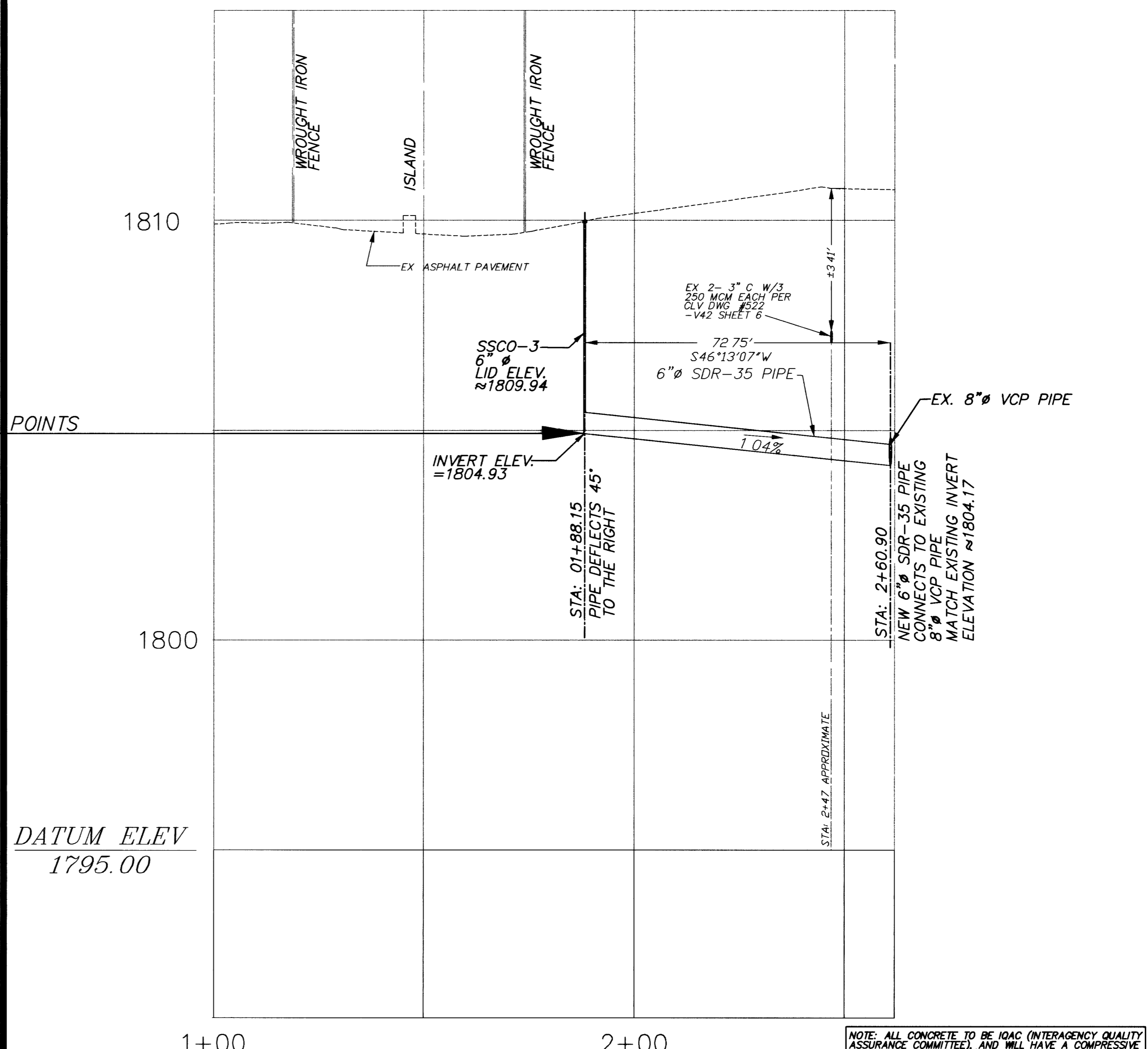

PROFILE VIEW
STA: 1+91.38 TO 2+57.31

- LEGEND**
- CONTROL POINT
 - MATCH LINE
 - FLOW LINE
 - EXISTING SOIL
 - EXISTING CONCRETE PAVEMENT TO BE REMOVED
 - EXISTING SLURRY SEAL LAYER TO BE REMOVED
 - EXISTING ASPHALT PAVEMENT TO BE REMOVED
 - EXISTING ASPHALT PAVEMENT TO BE REMOVED BY OTHERS
 - EXISTING ASPHALT PAVEMENT TO REMAIN
 - EXISTING ASPHALT PAVEMENT AND NECESSARY BASE OR NATIVE MATERIAL TO BE REMOVED
 - NEW ASPHALT PAVEMENT
 - NEW 3" A.C. PAVEMENT OVER 8" TYPE II AGGREGATE BASE
 - NEW CONCRETE SLAB (BY OTHERS)
 - EXISTING ELECTRIC VAULT/PULL BOX
 - EXISTING ELECTRIC METER
 - EXISTING PARKING LIGHT
 - EXISTING PROPANE TANK

- EXISTING CHAIN LINK FENCE TO BE REMOVED
- EXISTING CHAIN LINK FENCE
- EXISTING STORM DRAIN MANHOLE
- STREET LIGHT
- POWER OR TELEPHONE POLE
- EXISTING DROP INLET
- EXISTING GUARD POST
- NEW GUARD POST
- EXISTING SHED
- (XXXX.XX) FINISHED GRADE
- (XXXX.XX) EXISTING SLOPE
- XXXX.XX PROPOSED SLOPE
- "THROUGH LANE-USE ARROW" SYMBOL
- EXISTING BLOCK WALL
- PARKING STRIPPING
- PHYSICALLY CHALLENGED PERSON PARKING

- 6" CONCRETE WHEEL BLOCK
- SIGN
- EXISTING ELECTRIC MAIN SERVICE SWITCHBOARD
- EXISTING ELECTRIC TRANSFORMER
- NEW ELECTRIC TRANSFORMER
- NEW ELECTRIC PULLBOX
- NEW ELECTRIC PANEL

UTILITY NOTE:
UTILITY LOCATIONS SHOWN HEREON ARE APPROXIMATE ONLY. IT SHALL BE THE CONTRACTOR'S RESPONSIBILITY TO DETERMINE THE EXACT VERTICAL AND HORIZONTAL LOCATION OF ALL EXISTING UNDERGROUND UTILITIES PRIOR TO COMMENCING CONSTRUCTION. NO REPRESENTATION IS MADE THAT ALL EXISTING UTILITIES ARE SHOWN HEREON. THE ENGINEER ASSUMES NO RESPONSIBILITY FOR UTILITIES NOT SHOWN OR UTILITIES IN THEIR PROPER LOCATION.

KEY NOTES

REMOVAL ITEMS:

- A REMOVE EXISTING CONCRETE PAVEMENT
- B REMOVE EXISTING SLURRY SEAL LAYER
- C REMOVE NECESSARY BASE AND/OR NATIVE MATERIAL TO ACCOMMODATE NEW ASPHALT PAVEMENT AND BASE OR NEW CONCRETE PAV. GUTTER AND BASE OR NEW "I" TYPE CONCRETE CURB & GUTTER AND BASE TO THE GRADES AND SLOPES SHOWN ON PLANS
- D REMOVE EXISTING ASPHALT PAVEMENT
- E SAW CUT LINE
- F REMOVE EXISTING CHAIN LINK FABRIC TO ALLOW FOR GRADING AND PAVING
- G REMOVE A PORTION OF EXISTING CHAIN LINK FENCE TO ACCOMMODATE NEW ENTRANCE DIMENSIONS
- H REMOVE EXISTING CHAIN LINK FENCE GATE
- I REMOVE EXISTING CHAIN LINK FENCE
- J REMOVE EXISTING PARKING LIGHT BASE
- K PROTECT IN PLACE
- L REMOVE EXISTING CONCRETE COLLAR AND MAINTAIN GRATE ELEVATION
- M REMOVE NECESSARY SECTIONS OF EXISTING SIDEWALK, CURB & GUTTER TO ACCOMMODATE NEW SIDEWALK DRAIN
- N REMOVE EXISTING CONCRETE BUMPER BLOCK
- O REMOVE EXISTING DECOMPOSED GRANITE AND NATIVE MATERIAL TO ACCOMMODATE NEW CONCRETE PAN GUTTER WITH CURB WALL AND BASE TO THE GRADES AND SLOPES SHOWN ON PLANS
- P REMOVE NECESSARY BLOCK WALL AND BLOCK WALL FOOTING TO ACCOMMODATE BLOCK WALL OPENING PER DETAIL 3 ON SHEET # 8
- Q REMOVE NECESSARY PORTIONS OF EXISTING CHAIN LINK FENCE TO ACCOMMODATE NEW 3'0" WIDE CHAIN LINK PEDESTRIAN GATE
- R REMOVE NECESSARY SECTIONS OF EXISTING CONCRETE ISLAND, TO ACCOMMODATE NEW SANITARY SEWER PIPE OR NEW DOMESTIC WATER LINE OR NEW FIRE LINE. SAWCUT TO THE NEAREST WEAKENED JOINT

CONSTRUCTION ITEMS:

- 1 CONSTRUCT 3" HOT PLANT MIX RECYCLED BITUMINOUS PAVEMENT CATEGORY II TYPE 3 OVER 6" OF TYPE II AGGREGATE BASE COMPACTED TO 95% SCARIFY AND RECOMPACT 3" OF NATIVE MATERIAL TO 95%
- 2 CONSTRUCT CONCRETE PAN GUTTER PER SECTION A ON SHEET # 7
- 3 CONSTRUCT 6'0" x 6'0" CONCRETE SPLASH PAN PER DETAIL 1 ON SHEET # 7
- 4 PROVIDE & INSTALL 6" SDR-35 PIPE TO EXISTING SANITARY SEWER PIPE PER USD DWG # 503 & 505
- 5 CONSTRUCT CONCRETE COLLAR PER USD DWG # 408
- 6 CONSTRUCT CONCRETE FILLED 8" DIAMETER X 4' HIGH STEEL BOLLARD, SEE DETAIL 2 ON SHEET # 7
- 7 REMOVE & REPLACE EXISTING PULL BOX AND CONCRETE COLLAR, NEW PULL BOX TO BE TRAFFIC RATED
- 8 CONSTRUCT SIDEWALK DRAIN PER USD DWG # 236
- 9 INSTALL 6" HIGH CHAIN LINK FENCE PER USD DWG # 252
- 10 MATCH LINE, NEW A.C. OR CONCRETE TO MATCH EXISTING OR NEW
- 11 CONSTRUCT NECESSARY CONCRETE SIDEWALK TO MATCH EXISTING PER USD DWG # 234
- 12 CONSTRUCT 1/2" TYPE CONCRETE CURB & GUTTER PER USD DWG # 216
- 13 CONSTRUCT 1/2" EXPANSION JOINT PER DETAIL 4 ON SHEET # 9
- 14 CONSTRUCT BLOCK WALL OPENING PER DETAIL 3 ON SHEET # 8
- 15 CONSTRUCT NECESSARY 8" HIGH BLOCK WALL W/CAP TO REPLACE REMOVED BLOCK WALL AREAS PER DETAIL 3 ON SHEET # 8 & DETAIL 9-103-2 BY CLV BUILDING & SAFETY
- 16 CONSTRUCT CONCRETE PAN GUTTER WITH CURB WALL PER SECTION D ON SHEET # 7
- 17 NOT USED
- 18 CONSTRUCT 3" HOT PLANT MIX RECYCLED BITUMINOUS PAVEMENT CATEGORY II TYPE 3 OVER 6" MINIMUM OF TYPE II AGGREGATE BASE COMPACTED TO 95% SUBGRADE SHALL BE SCARIFIED & RECOMPACTED TO 95% IN AREAS WHERE ADDITIONAL FILL IS REQUIRED, SCARIFY AND RECOMPACT 3" OF EXISTING AGGREGATE BASE OR NATIVE SUBGRADE TO 95% ADD ANY NECESSARY NEW TYPE II AGGREGATE BASE AND COMPACT TO 95% TO MEET GRADES & SLOPES SHOWN ON PLANS
- 19 CONSTRUCT FULL DEPTH A.C. PATCH PER USD DWG # 504
- 20 NOT USED
- 21 INSTALL 6" HIGH, 3'0" WIDE CHAIN LINK PEDESTRIAN GATE PER USD DWG # 253

- 21 PROVIDE & INSTALL NEW 6" SDR-35 PIPE, INSTALL PER USD DWG # 503 & 505
- 22 CONNECT NEW 6" SDR-35 PIPE TO EXISTING SANITARY SEWER PIPE PER USD DWG # 503 & 505
- 23 PROVIDE & INSTALL 6" SANITARY SEWER CLEAN OUT PER DETAIL NO 8 ON SHEET # 9
- 24 UTILITY CROSSING CONTRACTOR TO USE CAUTION WHEN WORKING AROUND EXISTING UTILITY LINES
- 25 CONSTRUCT REQUIRED PORTIONS OF CONCRETE ISLAND TO MATCH EXISTING ISLAND CONDITIONS
- 26 PROVIDE & INSTALL NEW 2" COPPER WATER LINE, INSTALL PER USD DWG # 503, UDACS PLATE NO 6B AND DETAIL NO 7 ON SHEET # 9
- 27 PROVIDE & INSTALL NEW 8" C-900 PVC FIRE LINE, INSTALL PER USD DWG # 517 & UDACS PLATE NO 8
- 28 PROVIDE & INSTALL NEW 2" BALL VALVE AND VALVE BOX, INSTALL PER USD DWG # 517 & UDACS PLATE NO 8
- 29 PROVIDE & INSTALL NEW 8" GATE VALVE AND VALVE BOX, INSTALL PER USD DWG # 517 & UDACS PLATE NO 8
- 30 PROVIDE & INSTALL NEW FIRE HYDRANT ASSEMBLY & VALVE, INSTALL PER USD DWG # 516 & UDACS PLATE NO 7
- 31 CONNECT NEW 8" C-900 PVC FIRE LINE WITH 10" x 6" TEE AND 8" GATE VALVE TO EXISTING 10" C-900 PVC FIRE LINE PER USD DWG # 516 & UDACS PLATE NO 7
- 32 CONNECT NEW 2" WATER LINE TO EXISTING 1" WATER LINE WITH 1" x 1" TEE, 1" BALL VALVE W/VALVE BOX AND 1" x 2" INCREASER STUB & CAP NEW 8" C-900 PVC FIRE LINE
- 33 TO 34 NOT USED

NOTE: ALL CONCRETE TO BE IOAC (INTERAGENCY QUALITY ASSURANCE COMMITTEE) AND WILL HAVE A COMPRESSIVE STRENGTH AT 28 DAYS OF:

MASONRY FENCE WALL FOOTING = 4500 PSI.
ALL OTHER = 3000 PSI.

NOTE: ALL REINFORCING STEEL SHALL BE INTERMEDIATE GRADE ASTM A615-40.

PROFESSIONAL ENGINEER STATE OF NEVADA
HECTOR M. ESQUEDEA
ESQUEDEA CIVIL
Exp. 12-31-2008
No. 14703
06-03-2008

LEGEND OF ABBREVIATIONS:
CENTERLINE OF BONANZA RD. BETWEEN PECOS RD & SANDHILL RD. AS SHOWN ON THE FINAL MAP OF "SMITH'S NO. 367 SUBDIVISION" RECORDED IN BOOK 73 OF PLATS, PAGE 31, CLARK COUNTY, NEVADA, RECORDS' FILED IN CLV DIV. 2107-25566 RIVET & PLATE IN TOP OF CURB, W/S OF BONANZA RD. +/- 200' W OF FAMILY COURT CENTER ELEV. 1806.39' (NAVDB8)

NO.	DATE	REVISIONS	DESCRIPTION

DEPARTMENT OF FIELD OPERATIONS
STREETS AND SANITATION DIVISION
DEPUTY DIRECTOR OF FIELD OPERATIONS: JERRY WALKER, P.E.

DESIGN BY: HME, P.E.
DRAWN BY: HME, P.E.
CHECKED BY: CF

HORIZONTAL SCALE: 1:20
VERTICAL SCALE: 1:2
DATE: JUNE 2008

TITLE: EMPLOYEE PARKING LOT AND STORAGE AREA AT EAST YARD

SHEET: 12 of 16

SANITARY SEWER PROFILES

HANSEN # 28148 107V5059

F:\#Depot\Streets\#Depot\Street Rehab\PROJECTS\Hector Projects\Maintenance Bldg East Yard\Draws\Civil\Draws\Employee Parking Lot + storage area at East Yard.dwg

CLV EMPLOYEE PARKING LOT AND STORAGE AREA AT EAST YARD(1005)