

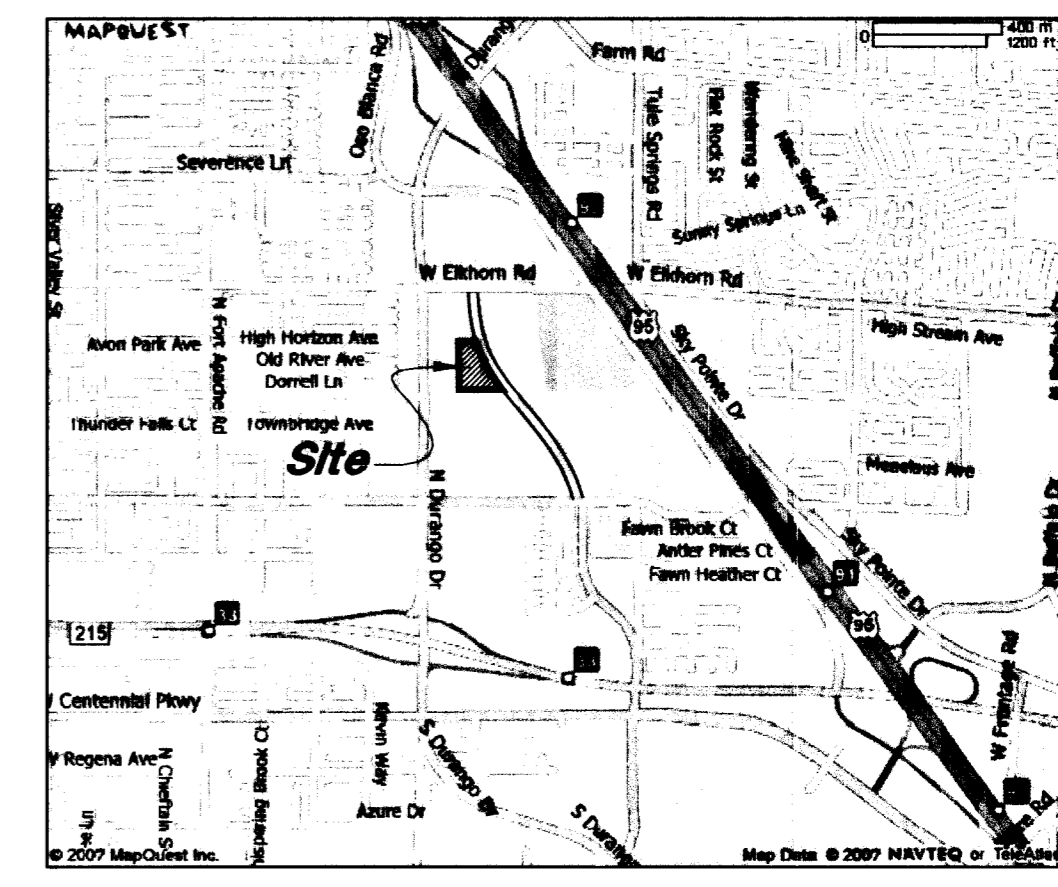

Scale: 1" = 40'

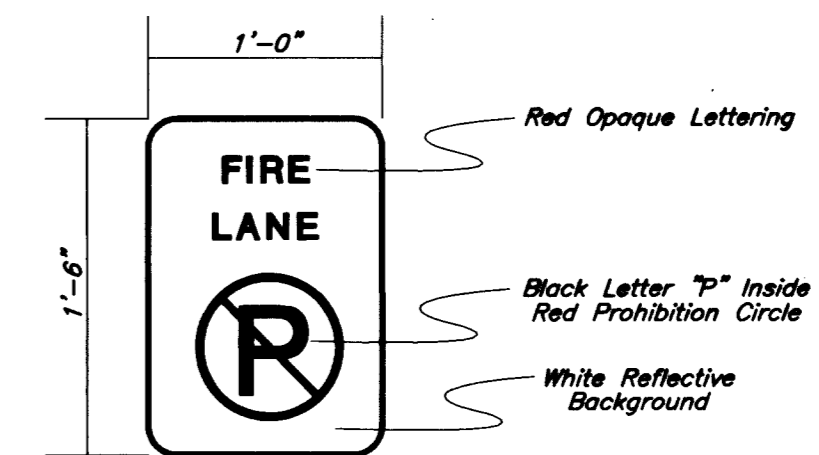

Vichity Map
Not to Scale



Sign Specifications
Minimum Specifications of "No Parking Fire Lane" Signs
Size: 1' Wide x 1'-6" Long as Required
Lettering: Block Letters 2 1/2" in Height with a Stroke of 1"
Color: Red and Black on White Luminous Background
Verbage: Fire Lane
Symbol: International No Parking Symbol
Height: To be installed not less than Six Feet nor more than Ten Feet from Ground Level

Fire Lane Sign Detail
No Scale

Fire Lane Notes:

- Fire Lane Limits (24' Min.)
- Fire Lane Limits (24' Min.)
- Const. Fire Lane Sign (See Detail this Sheet)
- Typical Turning Radius
- Indicates Red Painted Curb with "NO PARKING - FIRE LANE" stenciled
- Fire Department Connection
- Fire Hydrant
- Existing Fire Hydrant

Fire Flow Data:

Based On:
Fire Flow Requirement is 2,575 gallons per minute @ 20 PSI residual pressure per 2003 UFC.

Job Name	
Square Footage:	5750.9
Largest Area Between 4-hour Area	
Separation Walls:	N/A
Building Height:	35'-0"
Number of Stories:	2
Type of Construction:	II-B
Occupancy:	B
Full Automatic Fire Sprinkler System:	Yes
Fire Flow:	4375 GPM

Call before you Dig.
"811"
or
1-800-227-2600

Call before you OVERHEAD
1-702-227-2929

Las Vegas Fire Department
[Signature] 4-17-08
Date: _____
Approval of these plans shall not be construed to be a permit for, or an approval of, any violation of any of the provisions of the state or county laws.

Basis of Bearings

North 00°07'03" West being the West line of the Northwest Quarter (NW 1/4) of the Northeast Quarter (NE 1/4) of Section 20, Township 19 South, Range 60 East, M.D.M., Clark County, Nevada as shown on the Record of Survey File 145, Page 15, of Official Records on file in the Clark County, Nevada Recorder's Office.

Benchmark

City of Las Vegas Benchmark Book (12/2/2002) No. 0C90-211W5
Being a rivet and square aluminum plate in top center of headwall on the west side of Highway 95 near mile marker 88.70.
Elevation = 756.408 (meters) / 2481.65 (U.S. Survey feet)
North American Vertical Datum of 1988

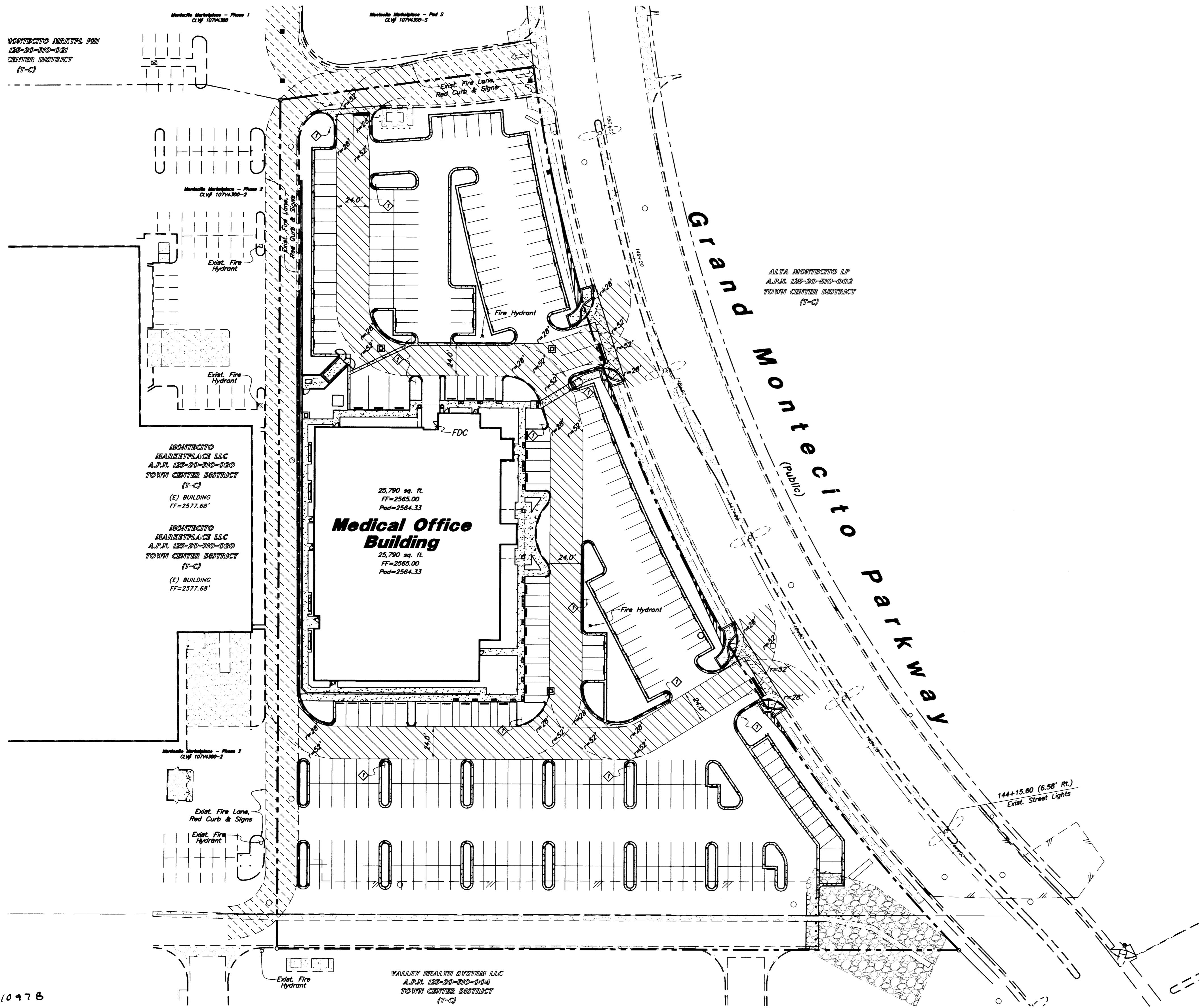

GREAT BASIN ENGINEERING - SOUTH
CONSULTING ENGINEERS and LAND SURVEYORS
2010 North Redwood Road, P.O. Box 16747
Salt Lake City, Utah 84116
Tel: (801)521-8551 Fax: (801)521-8551

Fire Lane Plan
Dorrell Medical Office Building
Grand Montecito Parkway & Dorrell Lane
Las Vegas, Nevada

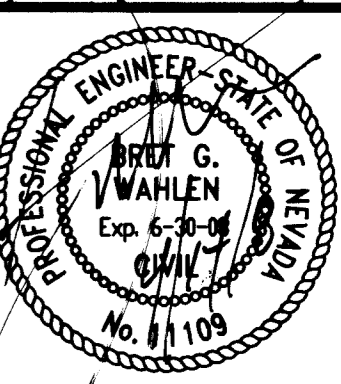

18 Mar, 2008

SHEET NO.
C1.1

107V5038

11097B

H27076