

NORTH LAS VEGAS BENCHMARK

REF. NO. 26
 BENCHMARK NAME: NLY9131N4
 RIVET AND 2" ROUND ALUMINUM DISK, STAMPED NORTH LAS VEGAS BM NO. NLY9131N4, SET IN THE TOP OF CURB,
 LOCATED APPROX. 14' WEST OF THE SOUTHWEST WEST COR AT THE INTERSECTION OF ANN RD. AND VALLEY DRIVE.
 ELEV. 674.368 METERS (NAVD '88)
 2212.49 FEET

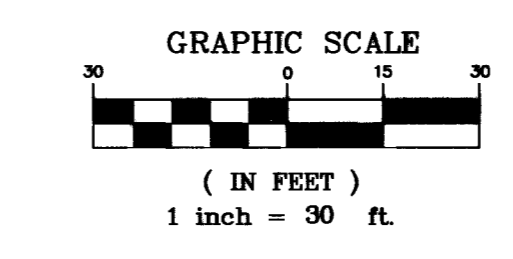

CONSTRUCTION NOTES:

- RED PAINTED CURB - SIGNED "NO PARKING" EVERY 100'
- INSTALL R1-1 "STOP SIGN" PER DETAIL THIS SHEET
- INSTALL R7-1 APR PER DETAIL THIS SHEET
- INSTALL BOLLARDS PER UDACS PLATE NO. 23

LINE TABLE

LINE	LENGTH	BEARING
L1	10.33	N00°00'11"W
L2	58.82	N00°00'11"W
L3	8.00	S89°59'49"W
L4	14.50	N00°00'11"W
L5	1.51	N00°00'11"W
L6	3.75	N00°00'11"W
L7	7.88	N90°00'00"W
L8	111.89	N89°59'49"E
L9	109.13	N89°59'49"E
L10	15.15	N00°00'11"W
L11	15.15	N00°00'11"W
L12	67.14	N00°00'11"W
L13	2.92	S00°00'00"E
L14	8.33	N89°59'59"W
L15	11.51	N90°00'00"W
L16	2.92	S00°00'00"E
L17	12.10	S89°59'59"E
L18	31.92	S88°51'16"E
L19	31.91	S89°59'49"W
L20	32.00	N89°52'31"E
L21	18.36	N89°54'46"W
L22	16.50	S89°52'31"W
L23	0.50	N00°07'29"W
L24	15.75	N89°52'31"E
L25	1.50	N00°07'29"W
L26	16.60	S89°52'31"W
L27	14.96	N89°52'31"E
L28	28.86	S89°52'31"W
L29	25.76	S89°52'31"W
L30	7.48	N90°00'00"W
L31	26.00	S89°52'20"W
L32	8.50	S00°03'27"W
L33	0.50	S89°52'31"W
L34	0.93	S00°02'46"W
L35	16.24	S00°07'28"E
L36	70.00	S89°52'31"W
L37	0.14	N89°52'31"E
L38	13.47	S00°07'29"E
L39	3.23	N89°52'31"E
L40	49.96	N89°56'05"W
L41	16.49	S00°03'56"W
L42	18.07	S00°03'55"W
L43	18.02	N90°00'00"W
L44	13.50	N90°00'00"W
L45	83.02	N90°00'00"W
L46	5.00	N02°24'58"E
L47	135.57	S89°58'49"W
L48	127.12	S90°00'00"W
L49	14.00	N00°00'11"W
L50	14.58	N89°52'15"E
L51	11.87	N90°00'00"W
L52	32.02	N89°56'05"W
L53	55.00	S00°07'29"E
L54	144.06	S89°58'49"W
L55	27.00	S00°00'11"E
L56	27.00	N00°00'11"W
L57	1.50	N00°07'29"W
L58	25.00	S89°52'31"W
L59	126.13	S88°51'09"E

CURVE TABLE

CURVE	LENGTH	RADIUS	DELTA	TANGENT
C1	3.85	1.22	180°00'00"	INFINITE
C2	8.32	4.50	105°59'31"	5.97
C3	22.57	80.87	15°59'31"	11.36
C4	3.32	1.50	125°32'33"	2.94
C5	8.03	8.50	54°06'37"	4.34
C6	2.53	10.00	14°28'50"	1.27
C7	8.64	5.50	90°00'00"	5.50
C8	19.17	12.50	87°32'20"	12.04
C9	0.79	0.25	180°00'00"	INFINITE
C10	6.28	2.00	180°00'00"	INFINITE
C11	3.81	1.19	183°19'02"	41.10
C12	0.00	1.22	0°00'00"	0.00
C13	5.63	2.00	161°32'54"	12.29
C14	5.15	1.65	178°51'06"	164.59
C15	3.93	1.25	180°00'00"	INFINITE
C16	2.36	1.50	90°00'00"	1.50
C17	2.36	1.50	90°00'00"	1.50
C18	2.36	1.50	90°00'00"	1.50
C19	3.92	2.50	89°57'12"	2.50
C20	15.70	11.50	78°14'42"	9.35
C21	12.53	9.50	75°35'01"	7.37
C22	2.74	1.50	104°36'25"	1.94
C23	0.79	0.50	90°00'00"	0.50
C24	2.36	1.50	89°48'36"	1.50
C25	3.93	2.50	90°03'55"	2.50
C26	12.58	4.00	180°07'50"	INFINITE
C27	10.47	10.00	60°00'00"	5.77
C28	11.46	10.00	65°41'03"	6.45
C29	2.99	1.50	114°18'57"	2.32
C30	9.35	3.00	178°02'45"	231.09
C31	38.71	25.00	88°42'34"	24.44
C32	23.90	15.00	91°17'26"	15.34
C33	1.57	0.50	180°00'00"	INFINITE
C34	1.57	0.50	180°00'00"	INFINITE
C35	1.57	0.50	180°00'00"	INFINITE

ONLY FIRE DEPT. FIRE FLOW DATA AND REQUIREMENTS

BUILDING HEIGHT (IN FEET)	BUILDING 1	BUILDING 2	BUILDING 3
	35' MAX.	35' MAX.	35' MAX.
FULLY AUTOMATED SPRINKLER SYSTEM (ASSUME 50% REDUCTION)	YES	YES	NO
OCCUPANCY:	M/B	M/S-1,B	M
TYPE OF CONSTRUCTION	TYPE V - B	TYPE V - B	TYPE V - B
NUMBER OF STORIES	1	1	1
BASED ON SQUARE FOOTAGE	6,719 Sq. Ft.	7,236 Sq. Ft.	4,336 Sq. Ft.
LARGEST AREA BETWEEN 4-HOUR SEPERATION WALLS	2	2	2
ESTIMATED FIRE FLOW REQUIREMENTS PER MINUTE AT 20 PSI RESIDUAL PRESSURE	1,688 gpm	1,688 gpm	1,750 gpm

REVIEWED AND VERIFIED BY: _____ DATE: _____

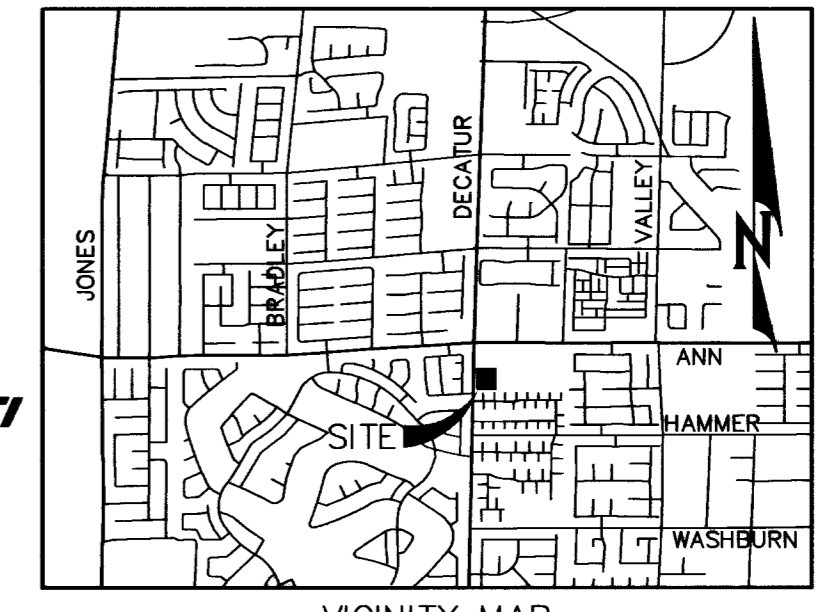

LEGEND

EXISTING	PROPOSED
STRIPING	STRIPING
CENTERLINE	CENTERLINE
PROPERTY LINE	PROPERTY LINE
RIGHT OF WAY	RIGHT OF WAY
FUTURE R/W	FUTURE R/W
EDGE OF PAVEMENT	EDGE OF PAVEMENT
CONTOUR W/ ELEVATION	CONTOUR W/ ELEVATION
CURB & GUTTER	CURB & GUTTER
WALL, TYPE AS NOTED	WALL, TYPE AS NOTED
AC SWALE	AC SWALE
LANDSCAPING	LANDSCAPING
PAINTED CURBS	PAINTED CURBS
AC PAVEMENT	AC PAVEMENT
FINISH GRADE	FINISH GRADE
TOP OF CURB	TOP OF CURB
FLOWLINE	FLOWLINE
FOC	FACE OF CURB
HIGH POINT	HP
EDGE OF PAVEMENT	EP
SIDEWALK	SW
TRASH ENCLOSURE	TRASH ENCLOSURE
FINISHED FLOOR	FF = 2230.15
PAD	PAD = 2228.15
SCARP	SCARP
GRADE BREAK	GRADE BREAK
HC ACCESS	HC ACCESS
FIRE ROUTE	FIRE ROUTE
PROPOSED FIRE HYDRANT	PROPOSED FIRE HYDRANT
FDC (FIRE DEPARTMENT CONNECTION)	FDC (FIRE DEPARTMENT CONNECTION)
CONCRETE SIDEWALK	CONCRETE SIDEWALK
STREET LIGHT	STREET LIGHT
EXISTING ASPHALT CONCRETE	EXISTING ASPHALT CONCRETE
RA	RA
RR	RR
	ROOF ACCESS RISER ROOM

Call before you Dig
 1-800-432-5300
 1-702-455-7544

Call before you Overhead
 1-702-227-2929

UTILITY LOCATIONS SHOWN HEREON ARE APPROXIMATE ONLY. IT SHALL BE THE CONTRACTOR'S RESPONSIBILITY TO DETERMINE THE EXACT HORIZONTAL AND VERTICAL LOCATION OF ALL EXISTING UNDERGROUND OR OVERHEAD UTILITIES PRIOR TO COMMENCING CONSTRUCTION. NO REPRESENTATION IS MADE THAT ALL EXISTING UTILITIES ARE SHOWN HEREON. THE ENGINEER ASSUMES NO RESPONSIBILITY FOR UTILITIES NOT SHOWN OR UTILITIES NOT SHOWN IN THEIR PROPER LOCATION.

BASIS OF BEARINGS

SOUTH 01°08'48" WEST BEING THE WEST LINE OF THE NORTHWEST QUARTER (NW 1/4) SECTION 31, TOWNSHIP 19 SOUTH, RANGE 61 EAST, M.D.M., AS SHOWN IN FILE 106, ON PAGE 82 ON FILE IN THE OFFICE OF THE CLARK COUNTY RECORDER, CLARK COUNTY, NEVADA.

GEOTECHNICAL

GEOTECHNICAL REPORT BY: ACCLAIM MATERIAL TESTING & INSPECTION, LLC
 FILE NO.: 06030
 DATE: MARCH 27, 2006
 UPDATE: MARCH 28, 2007

FLOOD DATA

COMMUNITY-PANEL NUMBER 32003C1765E, EFFECTIVE SEPTEMBER 27, 2002
 A FLOOD ZONE "X" IS DEFINED AS A NON-SPECIAL FLOOD HAZARD AREA THAT IS DETERMINED TO BE OUTSIDE THE 0.2% ANNUAL CHANCE (500-YEAR) FLOODPLAIN.

LANDSCAPE NOTE:

ALL LANDSCAPE IS TO BE PROVIDED AND PRIVATELY MAINTAINED PER THE "TITLE 17" REQUIREMENTS AND STANDARDS

LEGAL DESCRIPTION:

A PARCEL OF LAND SITUATED IN SECTION 31, TOWNSHIP 19 SOUTH, RANGE 61 EAST, M.D.M., SAID PARCEL BEING A PORTION THE NORTHWEST QUARTER (NW 1/4) OF THE NORTHWEST QUARTER (NW 1/4).

APPROVAL

CARLTON URBAN, P.E. DATE _____
 TRANSPORTATION SERVICES ADMINISTRATOR

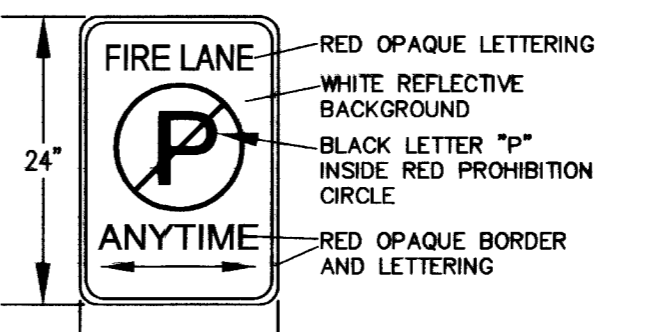

SIGN DETAIL ~ R7-1APR
 NOT TO SCALE

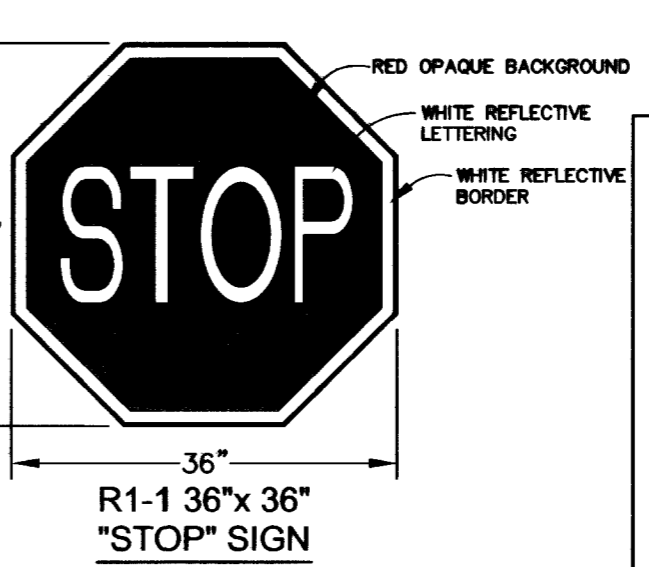

R1-1 36"x 36" "STOP" SIGN
 NOT TO SCALE

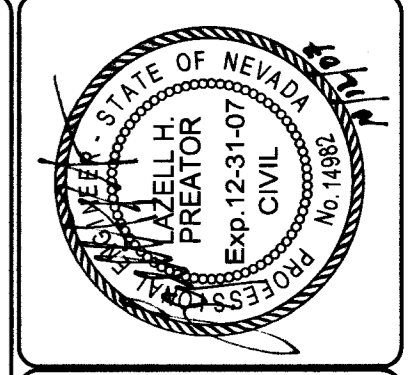

DEVELOPER
 DECATUR COURT, LLC
 10877 WILSHIRE BLVD.
 SUITE 803
 LOS ANGELES, CA 90024
 PHONE: (210)208-7770
 FAX: (310)208-7685

DESIGNED: TG	PROJ. NO.: SB06011	APP. BY
CHECKED: RG <td>DWGNAME: 06011-GD.DWG <td></td> </td>	DWGNAME: 06011-GD.DWG <td></td>	
NO. _____ <td>DESCRIPTION <td></td> </td>	DESCRIPTION <td></td>	
DATE _____ <td></td> <td></td>		

TRAFFIC & FIRE PLAN
 DECATUR COURT
 ANN ROAD AND DECATUR BLVD.
 CLARK COUNTY
 NEVADA

AMTI • SUNBELT
 ENGINEERING • PLANNING • SURVEYING
 720 SUSANNA WAY
 HENDERSON, NV 89011
 (702) 242-9908
 FAX (702) 242-9915

SHEET
C6
 6 OF 7 SHEETS
 CNL# 29838

DATE: 11/23/09
 1074956