

MONUMENT TIE MAP FOR EAGLE CREEK II PHASE 3
 AS SHOWN ON THAT CERTAIN MAP ON FILE IN THE OFFICE OF THE COUNTY
 RECORDER, CLARK COUNTY, NEVADA, IN BOOK 102, OF PLATS, PAGE 65. SITUATE IN
 THE NORTH HALF (N 1/2) OF SECTION 25, TOWNSHIP 19 SOUTH, RANGE 60 EAST,
 M.D.M., CITY OF LAS VEGAS, CLARK COUNTY, NEVADA

CURVE TABLE:

CURVE	DELTA ANGLE	RADIUS	ARC LENGTH	TANGENT
C1	09°06'49"	1130.81'	179.87'	90.13'
C2	13°41'59"	100.00'	23.91'	12.01'
C3	06°51'41"	355.06'	42.52'	21.29'
C4	01°21'58"	1000.00'	23.84'	11.92'
C5	13°10'31"	800.00'	183.96'	92.39'
C6	11°00'30"	800.00'	153.71'	77.09'
C7	01°15'19"	800.00'	17.53'	8.76'
C8	21°01'46"	1000.00'	367.03'	185.60'
C9	11°37'23"	522.92'	106.08'	53.22'
C10	02°20'50"	885.36'	36.27'	18.14'
C11	14°25'50"	800.00'	201.49'	101.28'
C12	04°25'44"	2000.00'	154.60'	77.34'
C13	00°17'38"	885.36'	4.54'	2.27'
C14	02°38'28"	885.36'	40.81'	20.41'
C15	04°38'23"	1152.81'	93.35'	46.70'
C16	00°20'45"	1000.00'	6.03'	3.02'
C17	01°01'13"	1000.00'	17.81'	8.90'

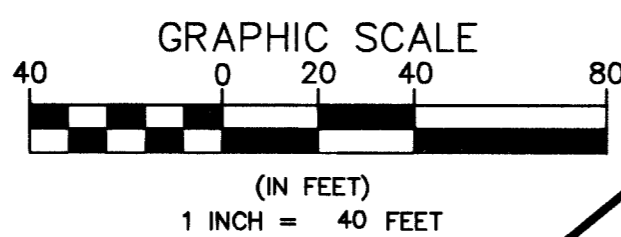
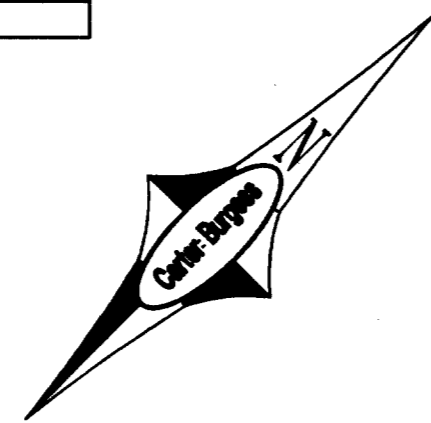

JONES BOULEVARD
 FOUND PK. AND WASHER
 PER BOOK 102, PAGE 65
 N1/16
 26/25
 116S
 800E

FOUND BEARINGS -
 AZURE DRIVE
 N88°46'05"E 388.07'
 N88°46'05"E 235.02'
 N88°46'05"E 26.06'

FOUND ALUMINUM CAP STAMPED
 PLS 601 PER BOOK 102,
 PAGE 65 OF PLATS
 N1/16
 26/25
 116S
 800E
 BRADLEY ROAD

- LEGEND**
- 17 LOT NUMBER / RESIDENTIAL
 - SUBDIVISION BOUNDARY LINE
 - INTERIOR RIGHT-OF-WAY LINE
 - LOT LINE
 - STREET CENTERLINE
 - FOUND MONUMENT AS NOTED
 - ▲ SET TYPE III MONUMENT STAMPED "PLS 13384"
 - SET TYPE IV REFERENCE MONUMENT STAMPED "PLS 13384"

BASIS OF BEARINGS:
 NORTH 88°46'05" EAST — BEING THE
 BEARING OF THE CENTERLINE OF AZURE
 DRIVE AS SHOWN ON THAT CERTAIN MAP
 ON FILE IN THE OFFICE OF THE CLARK
 COUNTY RECORDER, CLARK COUNTY, NEVADA
 IN FILE 52, PAGE 70 OF SURVEYS.

SURVEYOR'S CERTIFICATE:

I, STEPHEN P. GATES, A PROFESSIONAL LAND SURVEYOR,
 LICENSED IN THE STATE OF NEVADA, AS AN AGENT FOR
 CARTER AND BURGESS, INC., DO HEREBY CERTIFY THAT:

1. THIS PLAT REPRESENTS THE RESULTS OF A SURVEY
 CONDUCTED UNDER MY DIRECT SUPERVISION AT THE
 INSTANCE OF PN II INC., A NEVADA CORPORATION.
2. THE MONUMENTS HAVE BEEN SET AND THE TIE
 DISTANCES ESTABLISHED AS SHOWN HEREON. THIS SURVEY
 WAS COMPLETED ON JANUARY 26, 2004.

STEPHEN P. GATES
 PROFESSIONAL LAND SURVEYOR
 NEVADA CERTIFICATE NO. 13384

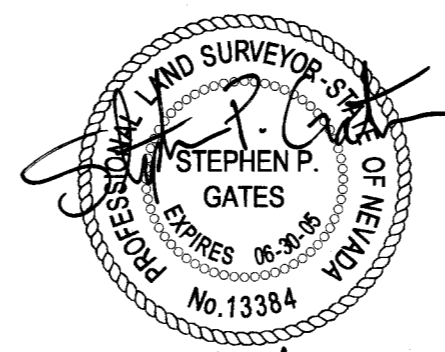

Carter-Burgess
 Consultants in Planning, Engineering,
 Construction Management, and Related Services

6655 Bermuda Road
 Las Vegas, Nevada 89119
 (702) 938-5400

RECORD OF SURVEY
 FOR
 MONUMENT TIE MAP FOR EAGLE CREEK II PHASE 3
 AS SHOWN ON THAT CERTAIN MAP ON FILE IN THE OFFICE OF THE COUNTY
 RECORDER, CLARK COUNTY, NEVADA, IN BOOK 102, OF PLATS, PAGE 65. SITUATE IN
 THE NORTH HALF (N 1/2) OF SECTION 25, TOWNSHIP 19 SOUTH, RANGE 60 EAST,
 M.D.M., CITY OF LAS VEGAS, CLARK COUNTY, NEVADA

SCALE: 1"=40'	JOB NO.: 98V189	SHEET	OF
DRAWING FILE: 8189MON-PH3	DRN. BY: JZ	1	1
DATE: 02/04	CKD. BY: 058-460-3 SPG		

FILED AT THE REQUEST OF:
 CARTER & BURGESS, INC.
 DATED _____ AT _____
 FILE _____ PAGE _____
 OF SURVEYS _____
 BOOK NO. _____
 INSTRUMENT NO. _____
 OFFICIAL RECORDS
 CLARK COUNTY, NEVADA RECORDS
 FRANCES DEANE, RECORDER
 FEE \$ _____ DEPUTY _____

NFM-0035-01