

NOTE:
THIS PROPERTY MAY HAVE STATIC WATER PRESSURE IN EXCESS OF 80 PSI. THE UNIFORM PLUMBING CODE REQUIRES THAT INDIVIDUAL, ON-SITE (PRIVATE), PRESSURE-REDUCING VALVES BE INSTALLED WHEN-EVER THE PRESSURE EXCEEDS 80 PSI. PRVS ARE THE DEVELOPER'S RESPONSIBILITY, AND WILL NOT BE INSPECTED OR INCLUDED IN THE ACCEPTANCE OF LVWD FACILITIES.

NOTE:
THE DISTRICT CANNOT GUARANTEE A WATERLOG SHUTDOWN WHERE CONNECTIONS OR REPAIRS TO EXISTING FACILITIES ARE REQUIRED. THE CONTRACTOR SHALL ENSURE ALL LABOR AND EQUIPMENT IS AVAILABLE TO REMOVE FUGITIVE WATER THAT MAY IMPROVE CONSTRUCTION AT ALL TIMES. COORDINATION WITH INSPECTION DIVISION MUST TAKE PLACE PRIOR TO ANY TRAIL SHUTDOWN. CONTRACTOR TO INSTALL TEMPORARY SERVICE TO ENSURE PROPER SHUTDOWN IN THE EVENT NO OTHER APPURTENANCES ARE AVAILABLE.

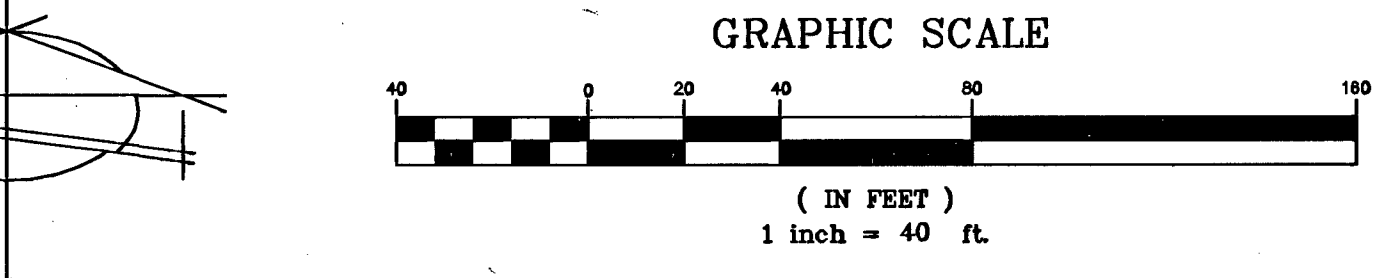
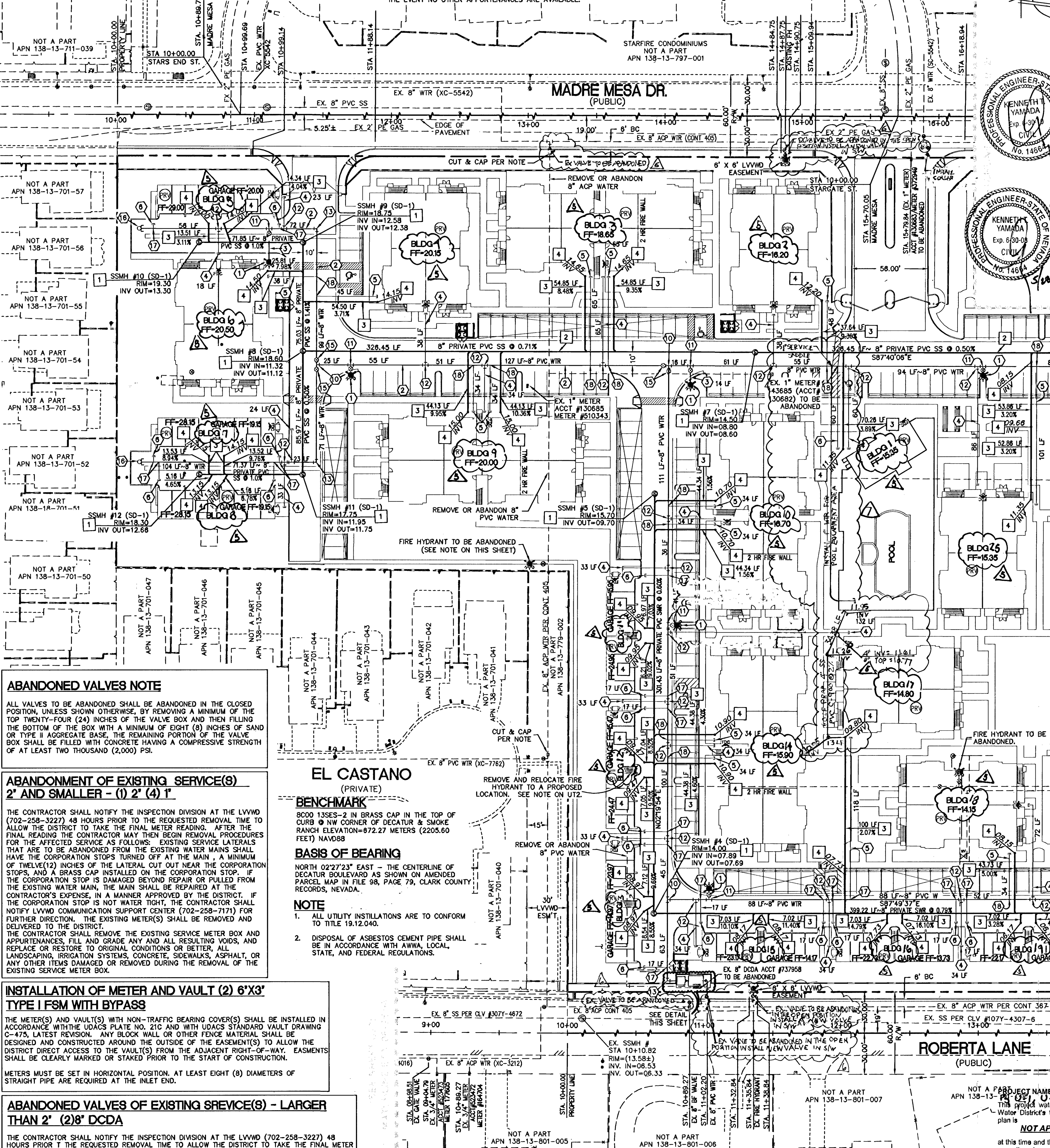

WATER CONSTRUCTION NOTES

ITEM	UNIT	PUBLIC	PRIVATE	QUANTITY
1. INSTALL FIRE HYDRANT ASSEMBLY PER UDS PLATE NO. 7	EA	-	8	8
2. INSTALL 8" PVC (CLASS 150) WATER LINE	LF	600	2689	3289
3. INSTALL 6" PVC (CLASS 150) WATER LINE	LF	-	103	103
4. INSTALL 4" PVC WATER LINE	LF	-	1559	1559
5. INSTALL 2" WATER SERVICE	LF	-	1004	1004
6. INSTALL 1-1/2" WATER SERVICE	LF	-	365	365
7. NOT IN USE 8"	EA	-	-	-
8. INSTALL 8" REDUCED PRESSURE PRINCIPLE ASSEMBLY (RPPA) PER UDCAS PLT. 11C	EA	2	-	2
9. ABANDON EX 8" DCCA AND INSTALL 8" X 3" TYPE I FSM	EA	2	-	2
10. PER UDS PLT. NO. 21C	EA	1	4	5
11. INSTALL 8" X 8" TEE W/THRUST BLOCK PER UDS PLT. NO. 5	EA	-	8	8
12. INSTALL 8" X 4" TEE W/THRUST BLOCK PER UDS PLT. NO. 5	EA	-	25	25
13. INSTALL 8" 90° BEND W/THRUST BLOCK PER UDS PLT. NO. 5	EA	-	8	8
14. INSTALL 8" X 6" REDUCER	EA	-	4	4
15. INSTALL 8" GATE VALVE	EA	1	8	9
16. INSTALL 8" MANUAL BLOW-OFF ASSEMBLY PER UDS PLT. NO. 4A	EA	1	2	3
17. INSTALL 1-1/2" SERVICE SADDLE	EA	-	23	23
18. INSTALL 2" SERVICE SADDLE	EA	-	21	21

SEWER CONSTRUCTION NOTES

ITEM	UNIT	PUBLIC	PRIVATE	QUANTITY
1. INSTALL 48" DIA. SANITARY SEWER MANHOLE PER STD. DWG. NO. SD-1	EA	1	11	12
2. INSTALL 8" PVC (SDR-35) SEWER MAIN	LF	-	2275	2275
3. INSTALL 4" PVC (SDR-35) SEWER LATERAL	LF	-	1329	1329
4. INSTALL 4" SANITARY SEWER CLEANOUT	EA	-	48	48

PRIVATE MANHOLE SCHEDULE

MANHOLE	TYPE	RIM	INV IN	INV OUT	DEPTH
SSMH #1	SD-1	09.32	01.58	01.38	08.33
SSMH #2	SD-1	10.80	03.00	02.80	08.00
SSMH #3	SD-1	11.70	04.55	04.35	07.35
SSMH #4	SD-1	14.00	07.89	07.69	08.31
SSMH #5	SD-1	15.70	-	09.70	06.00
SSMH #6	SD-1	13.10	08.97	08.77	06.35
SSMH #7	SD-1	14.50	08.80	08.60	05.90
SSMH #8	SD-1	18.60	11.32	11.12	07.48
SSMH #9	SD-1	18.75	12.58	12.38	06.37
SSMH #10	SD-1	19.30	-	13.30	06.00
SSMH #11	SD-1	17.75	11.95	11.75	06.00
SSMH #12	SD-1	18.30	-	12.68	05.64



REDUCED PRESSURE PRINCIPLE ASSEMBLY (2) 8" RPPA
APPROVED REDUCED PRESSURE PRINCIPLE ASSEMBLY(S) SHALL BE INSTALLED PER THE U.D.A.C.S. PLATE NO. 11C. NO WATER SHALL BE TAKEN FROM A SERVICE REQUIRING BACKFLOW PREVENTION UNTIL THE REDUCED PRESSURE PRINCIPLE ASSEMBLY HAS BEEN SUCCESSFULLY TESTED BY THE LVWD. ANY BLOCK WALL OR OTHER FENCE MATERIAL SHALL BE DESIGNED AND CONSTRUCTED AROUND THE OUTSIDE OF THE EXISTING VALVE TO ALLOW THE DISTRICT DIRECT ACCESS TO THE VALVES FROM THE ADJACENT RIGHT-OF-WAY. EASEMENT SHALL BE CLEARLY MARKED OR STAKED PRIOR TO THE START OF CONSTRUCTION.

RELOCATION OF PRIVATE FIRE HYDRANTS (4)
(EXTENSION OF EXISTING LATERAL)
THE CONTRACTOR SHALL REMOVE AND RELOCATE BOTH THE UPPER AND LOWER BARRELS OF THE EXISTING FIRE HYDRANT(S) WHERE SHOWN, EXTEND THE EXISTING LATERAL AS REQUIRED, AND REINSTALL SUCH HYDRANT(S) AT THE NEW LOCATION(S) INDICATED. FIRE HYDRANTS SHALL BE TESTED PRIOR TO AND AFTER RELOCATION, UNDER THE DIRECTION OF THE DISTRICT, TO ENSURE QUALITY. INSTALLATION SHALL BE IN ACCORDANCE WITH UDCAS PLATE 7. LATERALS MADE OF UNAPPROVED MATERIALS SHALL BE REPLACED FROM THE MAIN TO THE FIRE HYDRANT. RELOCATIONS WHERE THE LATERAL CANNOT BE EXTENDED SHALL BE TESTED AS NEW INSTALLATIONS.

FIRE HYDRANT AND LATERAL ABANDONMENT
WHERE SHOWN ON THE DRAWING, THE CONTRACTOR SHALL ABANDON THE EXISTING FIRE HYDRANT(S) BY REMOVING BOTH THE UPPER AND LOWER FIRE HYDRANT BARRELS SO THAT NO PORTION OF THE REMAINING FIRE HYDRANT ASSEMBLY IS CLOSER THAN TWO(2) FEET TO THE EXISTING GRADE. THE EXISTING HYDRANT SHALL BE DELIVERED TO THE DISTRICT. THE EXISTING VALVE SHALL BE ABANDONED IN A CLOSED POSITION, UNLESS SHOWN OTHERWISE, BY REMOVING A MINIMUM OF THE TOP TWENTY-FOUR(24) INCHES OF THE VALVE BOX AND THEN FILLING THE BOTTOM OF THE BOX WITH A MINIMUM OF EIGHT(8) INCHES OF SAND OR TYPE II AGGREGATE BASE. THE REMAINING PORTION OF THE VALVE BOX SHALL BE FILLED WITH CONCRETE HAVING A COMPRESSIVE STRENGTH OF AT LEAST TWO-THOUSAND(2,000) PSI. THE REMAINING PORTION OF THE LATERAL SHALL BE CUT WITHIN THREE(3) FEET OF THE ABANDONED VALVE, OR AS SHOWN ON PLANS, AND TAPPED. THE EXISTING CONCRETE HYDRANT PAD SHALL BE REMOVED.

DISCLAIMER NOTE
UTILITY LOCATIONS SHOWN HEREON ARE APPROXIMATE ONLY. IT SHALL BE THE CONTRACTOR'S RESPONSIBILITY TO DETERMINE THE EXACT HORIZONTAL AND VERTICAL LOCATION OF ALL EXISTING UNDERGROUND AND OVERHEAD UTILITIES PRIOR TO COMMENCING CONSTRUCTION. NO REPRESENTATION IS MADE THAT ALL EXISTING UTILITIES ARE SHOWN HEREON. THE ENGINEER ASSUMES NO RESPONSIBILITY FOR UTILITIES NOT SHOWN OR UTILITIES NOT SHOWN IN THEIR PROPER LOCATION.

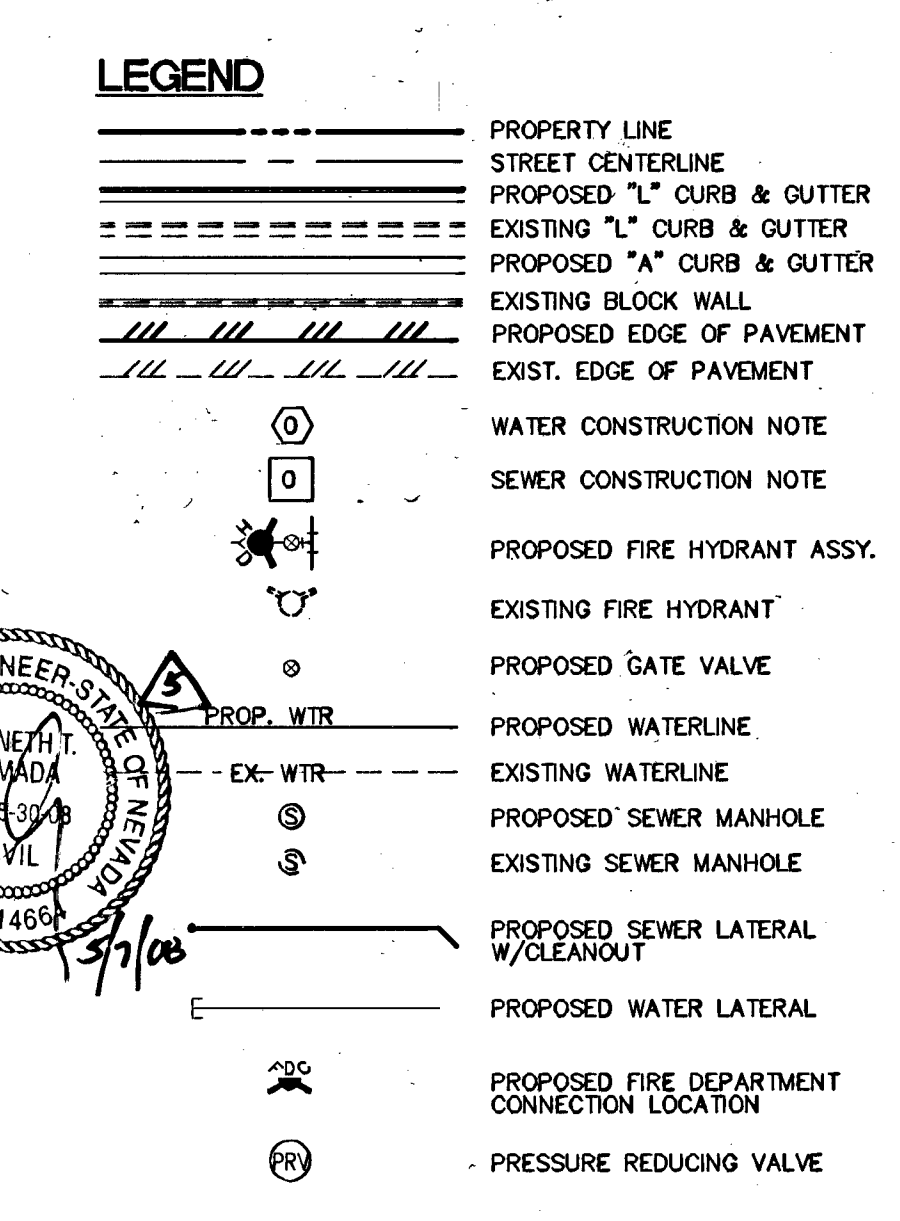
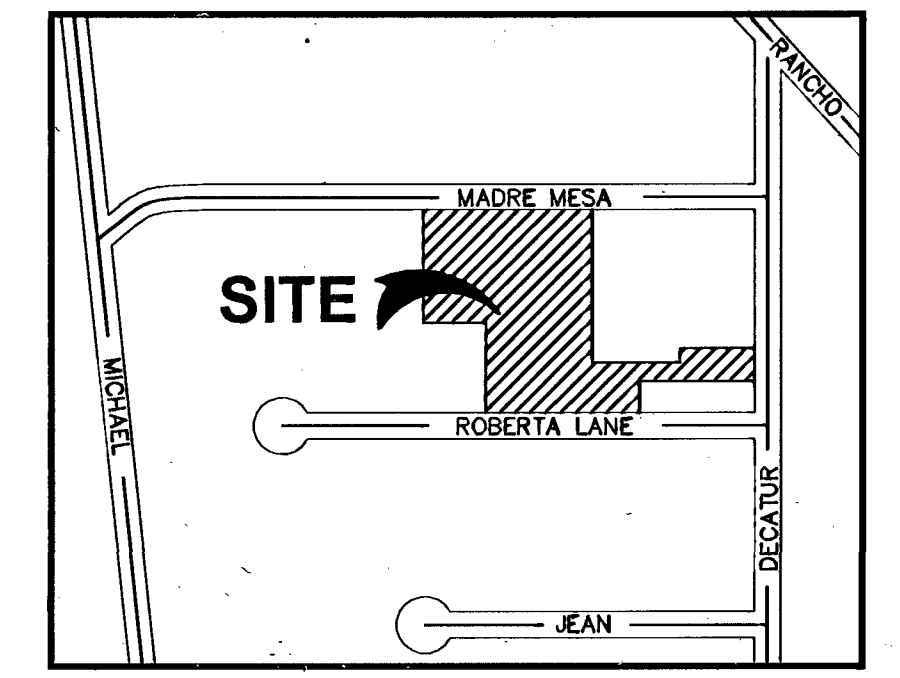

FIRE FLOW CALCULATIONS
FIRE FLOW REQUIREMENT IS 1750 GALLONS PER MINUTE AT 20 PSI RESIDUAL PRESSURE.
BASED ON:
SQUARE FOOTAGE: 16,182 SQUARE FEET
LARGEST AREA BETWEEN 4-HOUR AREA SEPARATION WALLS: N/A SQUARE FEET
BUILDING HEIGHT: 35' MAX
NUMBER OF STORIES: 2 FLOORS
TYPE OF CONSTRUCTION: V-B
OCCUPANCY: R
FULL AUTOMATIC FIRE SPRINKLER SYSTEM: NO YES
REVIEWED BY: Robert Bell DATE: 12/7/06
LAS VEGAS FIRE DEPT.

CUT AND CAP
THE LATERAL MUST BE CUT WITHIN THREE(3) FEET OF THE ABANDONED VALVE, OR AS SHOWN ON PLANS, AND CAPPED. THE CONTRACTOR SHALL CUT THE EXISTING PIPE WHERE SHOWN ON THE DRAWING, AND INSTALL A CAP COMPLETE WITH THRUST BLOCK. WHERE A JOINT OR COUPLING IN THE EXISTING PIPE IS UNCOVERED AT THE CUT AND CAP LOCATIONS, THE INSTALLATION OF A PLUG MAY BE PERMITTED WITH DISTRICT APPROVAL. A CONCRETE THRUST BLOCK SHALL BE INSTALLED AT ALL CAP OR PLUG LOCATIONS, IN ACCORDANCE WITH THE PROVISIONS OF UDCAS PLATE 5.

AVERAGE = 3402 FU x 0.45 ERU x 250 GPD = 0.3827 MGD
FU ERU
PEAK = 3.4 x 0.3827 = 1.3012 MGD

ABANDONED VALVES NOTE
ALL VALVES TO BE ABANDONED SHALL BE ABANDONED IN THE CLOSED POSITION, UNLESS SHOWN OTHERWISE, BY REMOVING A MINIMUM OF THE TOP TWENTY-FOUR (24) INCHES OF THE VALVE BOX AND THEN FILLING THE BOTTOM OF THE BOX WITH A MINIMUM OF EIGHT (8) INCHES OF SAND OR TYPE II AGGREGATE BASE. THE REMAINING PORTION OF THE VALVE BOX SHALL BE FILLED WITH CONCRETE HAVING A COMPRESSIVE STRENGTH OF AT LEAST TWO THOUSAND (2,000) PSI.

ABANDONMENT OF EXISTING SERVICE(S) 2" AND SMALLER - (1) 2" (4) 1"
THE CONTRACTOR SHALL NOTIFY THE INSPECTION DIVISION AT THE LVWD (702-258-3227) 48 HOURS PRIOR TO THE REQUESTED REMOVAL TIME TO ALLOW THE DISTRICT TO TAKE THE FINAL METER READING. AFTER THE FINAL READING THE CONTRACTOR MAY THEN BEGIN REMOVAL PROCEDURES FOR THE AFFECTED SERVICE AS FOLLOWS: EXISTING SERVICE LATERALS THAT ARE TO BE ABANDONED FROM THE EXISTING WATER MAINS SHALL HAVE THE CORPORATION STOPS TURNED OFF AT THE MAIN, A MINIMUM OF TWELVE(12) INCHES OF THE LATERAL CUT OUT NEAR THE CORPORATION STOPS, AND A BRASS CAP INSTALLED ON THE CORPORATION STOP. IF THE CORPORATION STOP IS DAMAGED BEYOND REPAIR OR PULLED FROM THE EXISTING WATER MAIN, THE MAIN SHALL BE REPAIRED AT THE CONTRACTOR'S EXPENSE, IN A MANNER APPROVED BY THE DISTRICT. IF THE CORPORATION STOP IS NOT WATER TIGHT, THE CONTRACTOR SHALL NOTIFY LVWD COMMUNICATION SUPPORT CENTER (702-258-7171) FOR FURTHER DIRECTION. THE EXISTING METER(S) SHALL BE REMOVED AND DELIVERED TO THE DISTRICT.
THE CONTRACTOR SHALL REMOVE THE EXISTING SERVICE METER BOX AND APPURTENANCES, FILL AND GRADE ANY AND ALL RESULTING VOIDS, AND REPLACE OR RESTORE TO ORIGINAL CONDITIONS OR BETTER, ALL LANDSCAPING, IRRIGATION SYSTEMS, CONCRETE, SIDEWALKS, ASPHALT, OR ANY OTHER ITEMS DAMAGED OR REMOVED DURING THE REMOVAL OF THE EXISTING SERVICE METER BOX.

EL CASTANO (PRIVATE) BENCHMARK
8000 135E-2 IN BRASS CAP IN THE TOP OF CURB @ NW CORNER OF DECATUR & SMOKE RANCH ELEVATION=672.27 METERS (2205.60 FEET) NAVD88
BASIS OF BEARING
NORTH 02°27'23" EAST - THE CENTERLINE OF DECATUR BOULEVARD AS SHOWN ON AMENDED PARCEL MAP IN FILE 98, PAGE 79, CLARK COUNTY RECORDS, NEVADA.
NOTE
1. ALL UTILITY INSTALLATIONS ARE TO CONFORM TO TITLE 19.12.040.
2. DISPOSAL OF ASBESTOS CEMENT PIPE SHALL BE IN ACCORDANCE WITH AWWA, LOCAL, STATE, AND FEDERAL REGULATIONS.

INSTALLATION OF METER AND VAULT (2) 6"X3" TYPE I FSM WITH BYPASS
THE METER(S) AND VAULT(S) WITH NON-TRAFFIC BEARING COVER(S) SHALL BE INSTALLED IN ACCORDANCE WITH THE UDCAS PLATE NO. 21C AND WITH UDCAS STANDARD WALL DRAWING 475, LATEST REVISION. ANY BLOCK WALL OR OTHER FENCE MATERIAL SHALL BE DESIGNED AND CONSTRUCTED AROUND THE OUTSIDE OF THE EASEMENT(S) TO ALLOW THE DISTRICT DIRECT ACCESS TO THE VAULT(S) FROM THE ADJACENT RIGHT-OF-WAY. EASEMENTS SHALL BE CLEARLY MARKED OR STAKED PRIOR TO THE START OF CONSTRUCTION.
METERS MUST BE SET IN HORIZONTAL POSITION. AT LEAST EIGHT (8) DIAMETERS OF STRAIGHT PIPE ARE REQUIRED AT THE INLET END.

ABANDONED VALVES OF EXISTING SERVICE(S) - LARGER THAN 2" (2)8" DCDA
THE CONTRACTOR SHALL NOTIFY THE INSPECTION DIVISION AT THE LVWD (702-258-3227) 48 HOURS PRIOR TO THE REQUESTED REMOVAL TIME TO ALLOW THE DISTRICT TO TAKE THE FINAL METER READING. AFTER THE FINAL READING, THE CONTRACTOR MAY THEN BEGIN REMOVAL PROCEDURES FOR THE AFFECTED SERVICE. THE EXISTING METER(S) SHALL BE REMOVED AND DELIVERED TO THE DISTRICT.

112676
111432
106209
99540C

18/9/06
10/3/07
12/7/06

PREPARED FOR: T.M.F. INVESTMENT
1048 IRVINE AVE #643
NEWPORT BEACH, CA 92660
PHONE: (702) 333-0716
FAX: (702) 333-0601

DATE: DECEMBER 2008
DESIGN: USR
DRAWN: UPH
CHECK: LUP
SCALE: 1"=40'

DATE: 12/7/06
DESIGN: BAUGHMAN & TURNER, INC.
DRAWN: LAND PLANNERS
CHECK: LAND SURVEYORS
SCALE: LAS VEGAS, NEVADA 89102
(702) 878-2695
(702) 870-8771

DECATUR VILLAGE APARTMENTS
UTILITY PLAN
SECTION 13, TOWNSHIP 20 SOUTH, RANGE 60 EAST, M.D.B. & M. NEVADA
CITY OF LAS VEGAS
DECATUR BLVD AND MADRE MESA DRIVE

SHEET
UT1
6 of 12
PROJ. NO.
Decatur.Village

STATE OF NEVADA
WELL & PRETREATOR
Exp. 12-31-07
CIVIL
No. 14982

CLV DWG # 107V4783

1-800-227-2600
UNDERGROUND SERVICE ONLY

1-702-227-2929
UNDERGROUND POWER SERVICE ONLY
SAFETY SERVICES DEPARTMENT

Call before you Dig
Call before you Overhead

1-702-455-7111
1-702-229-5611
LAS VEGAS AREA CONSTRUCTION TRUST FUND