

SEE SHT #8

SEE SHT #8

APN 125-20-402-007

APN 125-29-103-002

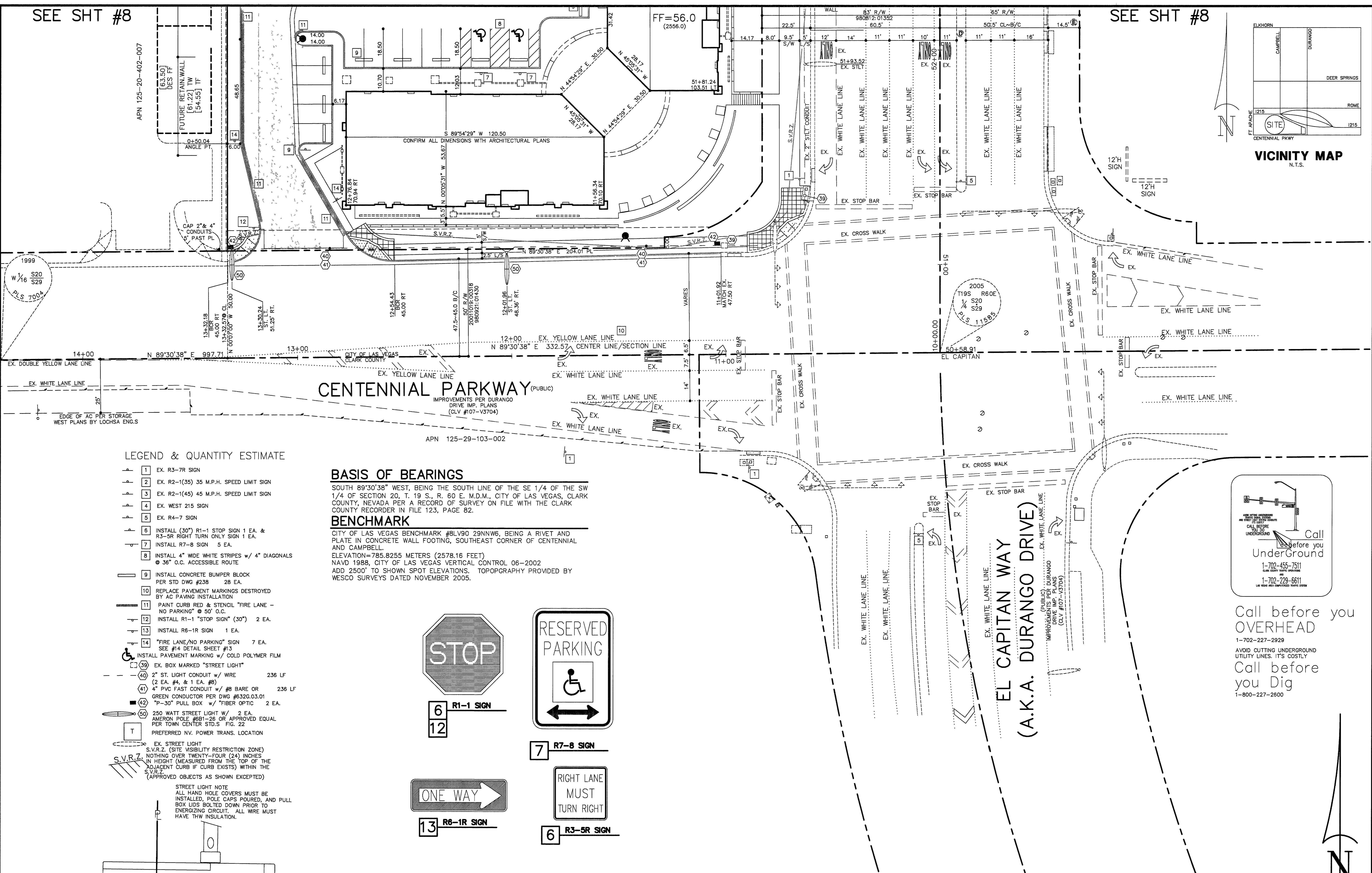
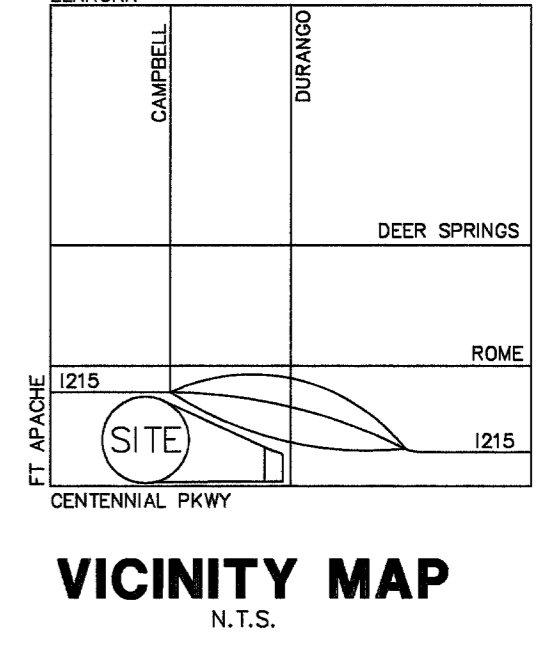

DUNNAM CIVIL ENGINEERS
3471 WEST OQUENDO ROAD SUITE 101
LAS VEGAS, NV 89118
(702) 798-1088 (702) 367-8145 FAX

DURANGO AND CENTENNIAL CENTER
TRAFFIC & STREETLIGHT PLAN (SOUTH)

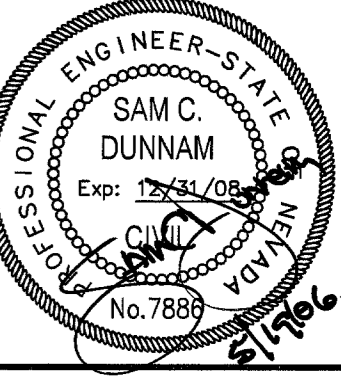

FILE NAME: INTE51T.dwg
PLOT SCALE: 1" = 20'
SHEET

9
OF TWENTY FOUR
CLV DRAWING # 10114754

LEGEND & QUANTITY ESTIMATE

- 1 EX. R3-7R SIGN
 - 2 EX. R2-1(35) 35 M.P.H. SPEED LIMIT SIGN
 - 3 EX. R2-1(45) 45 M.P.H. SPEED LIMIT SIGN
 - 4 EX. WEST 215 SIGN
 - 5 EX. R4-7 SIGN
 - 6 INSTALL (30") R1-1 STOP SIGN 1 EA. & R3-5R RIGHT TURN ONLY SIGN 1 EA.
 - 7 INSTALL R7-8 SIGN 5 EA.
 - 8 INSTALL 4" WIDE WHITE STRIPES w/ 4" DIAGONALS @ 36" O.C. ACCESSIBLE ROUTE
 - 9 INSTALL CONCRETE BUMPER BLOCK PER STD DWG #238 28 EA.
 - 10 REPLACE PAVEMENT MARKINGS DESTROYED BY AC PAVING INSTALLATION
 - 11 PAINT CURB RED & STENCIL "FIRE LANE - NO PARKING" @ 50' O.C.
 - 12 INSTALL R1-1 "STOP SIGN" (30") 2 EA.
 - 13 INSTALL R6-1R SIGN 1 EA.
 - 14 "FIRE LANE/NO PARKING" SIGN 7 EA. SEE #14 DETAIL SHEET #13
 - INSTALL PAVEMENT MARKING w/ COLD POLYMER FILM
 - 39 EX. BOX MARKED "STREET LIGHT"
 - 40 2" ST. LIGHT CONDUIT w/ WIRE (2 EA. #4, & 1 EA. #8) 236 LF
 - 41 4" PVC FAST CONDUIT w/ #8 BARE OR GREEN CONDUCTOR PER DWG #632G.03.01 236 LF
 - 42 "P-30" PULL BOX w/ FIBER OPTIC 2 EA.
 - 50 250 WATT STREET LIGHT w/ AMERON POLE #8B1-26 OR APPROVED EQUAL PER TOWN CENTER STD.'S FIG. 22
 - T PREFERRED NV. POWER TRANS. LOCATION
 - EX. STREET LIGHT
 - S.V.R.Z. (SITE VISIBILITY RESTRICTION ZONE) NOTHING OVER TWENTY-FOUR (24) INCHES IN HEIGHT (MEASURED FROM THE TOP OF THE ADJACENT CURB IF CURB EXISTS) WITHIN THE S.V.R.Z. (APPROVED OBJECTS AS SHOWN EXCEPTED)
- STREET LIGHT NOTE
ALL HAND HOLE COVERS MUST BE INSTALLED, POLE CAPS POURED, AND PULL BOX LIDS BOLTED DOWN PRIOR TO ENERGIZING CIRCUIT. ALL WIRE MUST HAVE THW INSULATION.
-

BASIS OF BEARINGS

SOUTH 89°30'38" WEST, BEING THE SOUTH LINE OF THE SE 1/4 OF THE SW 1/4 OF SECTION 20, T. 19 S., R. 60 E. M.D.M., CITY OF LAS VEGAS, CLARK COUNTY, NEVADA PER A RECORD OF SURVEY ON FILE WITH THE CLARK COUNTY RECORDER IN FILE 123, PAGE 82.

BENCHMARK

CITY OF LAS VEGAS BENCHMARK #BLV90 29NNW6, BEING A RIVET AND PLATE IN CONCRETE WALL FOOTING, SOUTHEAST CORNER OF CENTENNIAL AND CAMPBELL.
ELEVATION=785.8255 METERS (2578.16 FEET)
NAVD 1988, CITY OF LAS VEGAS VERTICAL CONTROL 06-2002
ADD 2500' TO SHOWN SPOT ELEVATIONS. TOPOGRAPHY PROVIDED BY WESCO SURVEYS DATED NOVEMBER 2005.

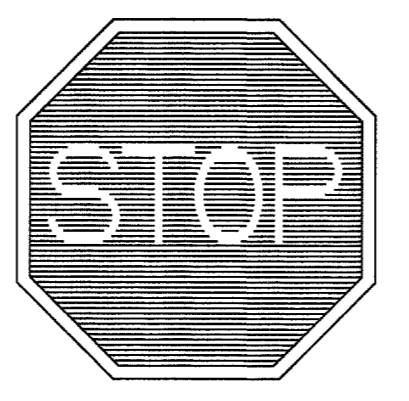

6 R1-1 SIGN
12



7 R7-8 SIGN

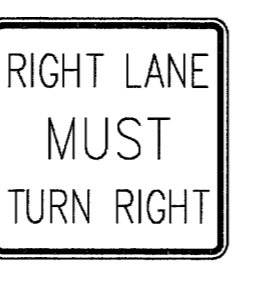

6 R3-5R SIGN

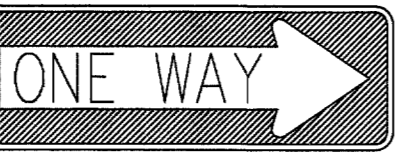

13 R6-1R SIGN

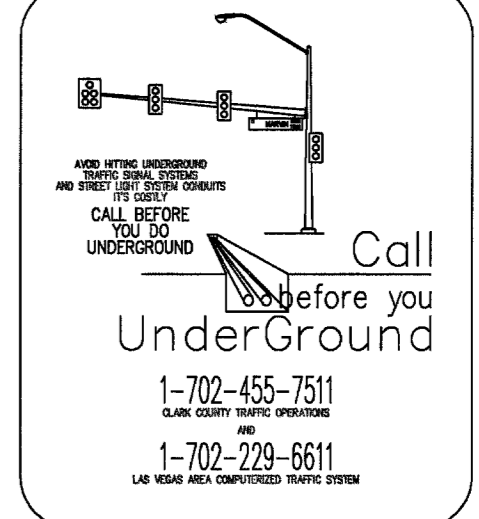

Call before you OVERHEAD
1-702-227-2929
AVOID CUTTING UNDERGROUND UTILITY LINES. IT'S COSTLY!
Call before you Dig
1-800-227-2600

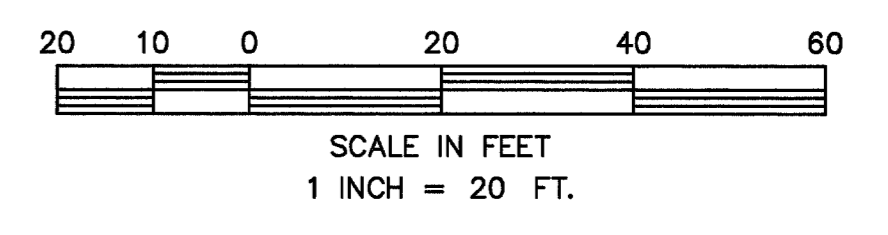

982-72