

R.P.A. LANDSCAPE ARCHITECTURE PLANNING
 CALIFORNIA
 27127 CASH AVENUE, SUITE 205
 SAN JUAN CAPISTRANO, CA 92675
 949-441-1111
 CA LICENSE # 181, 2041
 NEVADA
 10120 SOUTH EASTMAN AVE., SUITE
 HENDERSON, NV 89002
 702-462-9272
 NV LICENSE # 114
 Robert Price & Associates, Inc.

Durango & Centennial Center
 El Capitan Way (Durango) at Centennial Parkway

PROJECT NAME: Durango & Centennial Center
 SHEET TITLE: El Capitan Way (Durango) at Centennial Parkway
 REVISIONS:
 Drawn By:
 Date: February 22, 2006
 Scale:
 Sheet No:
L4.00
 10N04754

IRRIGATION LEGEND

SYM.	REQ.	MODEL NO./DESCRIPTION	GPM	PSI	PATTERN
▲	RAINBIRD	FLOOD BUBBLER #300A-F	170	30	WASHINGTONIA ROBUSTA (SEE DRIP EMITTER SCH.)
○	RAINBIRD	FLOOD BUBBLER #300A-F	170	30	PHOENIX DACTYLIFERA (SEE DRIP EMITTER SCH.)
⊕	RAINBIRD	XB SERIES DRIP EMITTER SYSTEM FOR POTS. (SEE DRIP EMITTER SCH.)			
■	RAINBIRD	A SEPARATE DRIP EMITTER SYSTEM IS REQUIRED FOR TREES 24" BOX SIZE OR LARGER. (SEE TREE DRIP EMITTER SCHEDULE BELOW.)			
⊙	RAINBIRD	FEB SERIES REMOTE CONTROL VALVE. SIZE AS INDICATED ON PLANS.			
⊕	(DRIP ASSEMBLY)	6"PEARS LINE-SIZED BALL VALVE WITH RAINBIRD FEB SERIES REMOTE CONTROL VALVE WITH SENNIGER PRESSURE REGULATOR. USE FMR-25LF - 0.5 GPM, FMR-25 MF - 6-18 GPM, FMR-25HF - 29-32 GPM, AND AGRICULTURAL PRODUCTS STRAINER USE 3/4" WITH MAX. 11 GPM, 1" WITH MAX. FLOW 28 GPM, 1-1/2" WITH MAX. FLOW 55 GPM.			
⊙	RAINBIRD	#33DRG QUICK COUPLER VALVE AND KEY. INSTALL IN BROOKS #3 VALVE BOX. 1" PVC CONNECTION TO MAIN.			
▶	HAMMOND	#890 FULL PORT LINE SIZED BALL VALVE.			
⊠	WILKINS	LINE SIZED 1" BASKET STRAINER (OR APPROVED EQUAL).			
⊠		1-1/2" WATER METER DEDICATED FOR IRRIGATION USE PROVIDED BY CONTRACTOR. VERIFY EXACT LOCATION IN THE FIELD.			
⊠	FEBCO	REDUCED PRESSURE BACKFLOW #82BYA - 1-1/2" SIZE. NOTE: INSTALL UNIT IN INSULATED FIBERGLASS ENCLOSURE APPROVED BY LAS VEGAS WATER DISTRICT.			
▲	RAINBIRD	(1) AUTOMATIC CONTROLLERS, ESP-28MC. SEE SHEETS L-400 FOR LOCATIONS. 120V ELECTRIC SERVICE REQUIRED - VERIFY EXACT LOCATION IN THE FIELD WITH OWNER'S REPRESENTATIVE. INSTALL IN STAINLESS STEEL PEDESTAL. "STRONG BOX" BY V.I.T. PRODUCTS INC. (800) 729-1314 OR APPROVED EQUAL. (SEE DETAIL).			
(NOT SHOWN)	RAINBIRD	XB EMITTER. REFER TO DRIP EMITTER LEGEND. INSTALL DIFFUSER CAP TO EACH PLANT.			
---		NON-PRESSURE LATERAL LINE CLASS 200 PVC PIPE AS SHOWN, (SOLVENT WELD). BURY A MIN. OF 12" BELOW GRADE. SIZE AS INDICATED ON PLANS.			
---		IRRIGATION MAINLINE USE SCHEDULE 40 PVC FOR SIZES 1/2" TO 1-1/2" AND CLASS 315 FOR 2" AND LARGER PIPE (SOLVENT WELD). BURY A MIN. OF 18" BELOW GRADE. SIZE AS INDICATED ON PLANS.			
---		SCH. 40 PVC ELECTRICAL SLEEVE PRIOR TO PAVING. SIZE AS PER PLAN. BURY A MIN. OF 12" BELOW GRADE. EXTEND MIN. 12" BEYOND EDGE OF PAVING.			
---		LATERAL LINE INSTALLED IN SCH 40 PVC SLEEVE PRIOR TO PAVING. (2x LATERAL PIPE SIZE, TYP. MIN. 1-1/2" SIZE.)			
---		IRRIGATION MAIN LINE INSTALLED IN SCH 40 PVC SLEEVE PRIOR TO PAVING. SIZE AS INDICATED ON PLANS. (2x MAINLINE PIPE SIZE, TYP.)			
~	HARDIE (TORO)	HARDIE BLUE LINE TUBING/ TORO EZ DRIP TUBING - 3/4" DIA. REFER TO DRIP EMITTER LEGEND. INSTALL FLUSH CAP IN EMITTER BOX.			
+		JUNCTION BETWEEN LATERAL LINE AND DRIP TUBING WITH COMPRESSION FITTING			
⊕		VALVE SIZE SYSTEM FLOW IN GPM STATION NUMBER			

DRIP EMITTER SCHEDULE

- CONTRACTOR SHALL INSTALL RAINBIRD XB EMITTERS TO MEET THE FOLLOWING SCHEDULE:

ALL 1 GALLON -	(2) XB-10 (1 GPH EACH)
ALL 5 GALLON -	(2) XB-10 (1 GPH EACH)
15 GALLON -	(4) XB-10 (1 GPH EACH)
24" BOX -	(6) XB-20 (2 GPH EACH)
36" BOX -	(8) XB-20 (2 GPH EACH)
POTS	(3) XB-10 (1 GPH EACH)
PALMS - PHOENIX	(3) RAINBIRD 1300A-F BUBBLERS (EACH) (SEE PALM TREE DETAIL)
PALMS - WASHINGTONIA	(2) RAINBIRD 1300A-F BUBBLERS (EACH) (SEE PALM TREE DETAIL)
- THE NUMBER OF EMITTERS INDICATED ON THESE PLANS ARE APPROXIMATE AND SHOULD BE VERIFIED IN THE FIELD BASED ON PLANTING INSTALLATION. CONTRACTOR SHALL REFER TO PLANTING PLAN AND EMITTER SCHEDULE ABOVE TO DETERMINE EXACT NUMBER OF EMITTERS REQUIRED.
- ALL DRIP TUBINGS SHALL BE 3/4" HARDIE BLUE LINE POLYETHYLENE TUBINGS.
- ALL LATERAL LINES FOR DRIP SYSTEM SHALL BE PVC AS SHOWN IN THE LEGEND. POLYETHYLENE TUBINGS SHALL BE CONNECTED TO THE PVC LATERAL LINES IN LOCATIONS ALONG THE LATERAL LINE ROUTE IN QUANTITIES AND LOCATIONS REQUIRED BY THE PLANT GROUPS AND THE MAXIMUM POLY TUBING RUN AS INDICATED IN THE DETAILS.
- CONNECT POLYETHYLENE TUBINGS TO PVC AS PER DETAILS AND ROUTE TUBING THROUGH PLANT MASSES. INSERT DRIP EMITTERS INTO TUBING AS CLOSE AS POSSIBLE TO PLANT MATERIALS. ROUTE 1/4" TUBING FROM EMITTER TO PLANT, MAX. DISTANCE 6 FT. COVER ALL DRIP TUBING COMPLETELY WITH SOIL AND MULCH SPECIFIED ON LANDSCAPE PLANS AND DETAILS.
- DRIP SYSTEM HAS BEEN DESIGNED TO ACCOMMODATE THE UPSIZING OF EMITTERS TO COMPENSATE FOR FUTURE PLANT GROWTH. MAINTENANCE PERSONNEL SHALL UPGRADE EMITTER SIZES AS REQUIRED TO PROVIDE ADEQUATE WATER FOR FUTURE HEALTHY PLANT GROWTH.

IRRIGATION NOTES:

- P.O.C. IS AT 2" DOMESTIC WATER METER WITH A 1-1/2" SERVICE LINE. METER LOCATION IS SHOWN ON THE SITE IRRIGATION PLAN. VERIFY SIZE, LOCATION AND PRESSURE, IN FIELD, WITH OWNER'S AUTHORIZED REPRESENTATIVE PRIOR TO COMMENCING WORK.

STATIC PRESSURE REQ.	X PSI
DESIGN PRESSURE REQ.	31 PSI
MAXIMUM DEMAND REQ.	45 GPM
- ALL LATERAL LINE AND MAINLINE INSTALLED UNDER AC PAVING TO BE PROVIDED WITH PIPE SLEEVING (2 TIMES LINE SIZE, TYP.)
- THE HARDIE BLUE LINE TUBING/ TORO EZ DRIP TUBING (OR RAINBIRD XERI-TUBE PIPING) IN PLANTER AREAS IS DIAGRAMATIC. CONTRACTOR CAN ROUTE PIPING IN A FREE FORM MANNER, AVOIDING OBJECTS LIKE LIGHT STANDARDS, TRANSFORMER PADS, EQUIPMENT VAULTS, SUB-SURFACE ROCK TOO LARGE TO REMOVE, ETC., AS LONG AS ALL PLANTS RECEIVE THE PROPER NUMBER OF EMITTERS PER SCHEDULE AND THAT THE VINYL DISTRIBUTION TUBING DOES NOT EXCEED THE MAXIMUM DESIGN LENGTHS (APPROX. 6').
- CONTRACTOR TO INSTALL ALL IRRIGATION EQUIPMENT WITHIN LIMIT OF SITE WORK AND PROPERTY LINE. IRRIGATION IS SCHEMATIC AND IS DRAIN TO SHOW FOR GRAPHIC CLARITY ONLY.
- BUBBLERS AND LATERAL LINES ARE SHOWN WITHIN PAVING AND BUILDING FOR CLARITY ONLY. ACTUAL LOCATION TO BE WITHIN PLANTER. BUBBLERS SHALL BE ALIGNED WITH TREES AND AS DIRECTED BY OWNER'S AUTHORIZED REPRESENTATIVE. CONFIRM ALL LAYOUT IN FIELD WITH OWNER'S AUTHORIZED REPRESENTATIVE PRIOR TO COMMENCING WORK.
- MAINLINE SHOWN WITHIN PAVING FOR CLARITY ONLY. MAINLINE LOCATION TO BE A MINIMUM OF 18" OFF ADJACENT HARDSCAPE AND OTHER OBSTACLES TYP. COORDINATE MAINLINE WITH UTILITIES AND SITE OBSTRUCTIONS.
- CONTRACTOR SHALL ADJUST ALL HEADS AS REQUIRED TO ACCOMMODATE ANY OBSTRUCTIONS THAT MAY OCCUR, INCLUDING BUT NOT LIMITED TO LIGHT POLES, FIRE HYDRANTS, ETC. VERIFY ALL HEAD LAYOUT WITH OWNER'S AUTHORIZED REPRESENTATIVE PRIOR TO COMMENCING WORK.

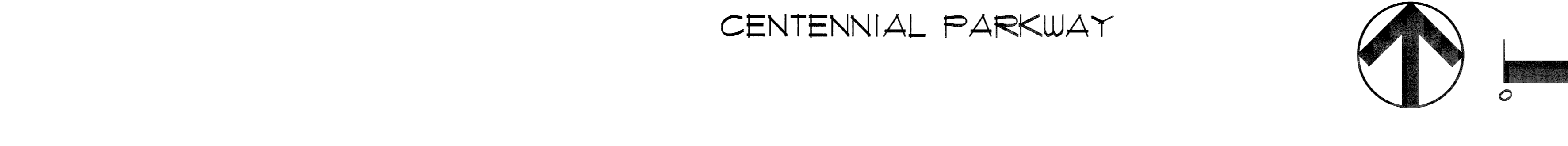
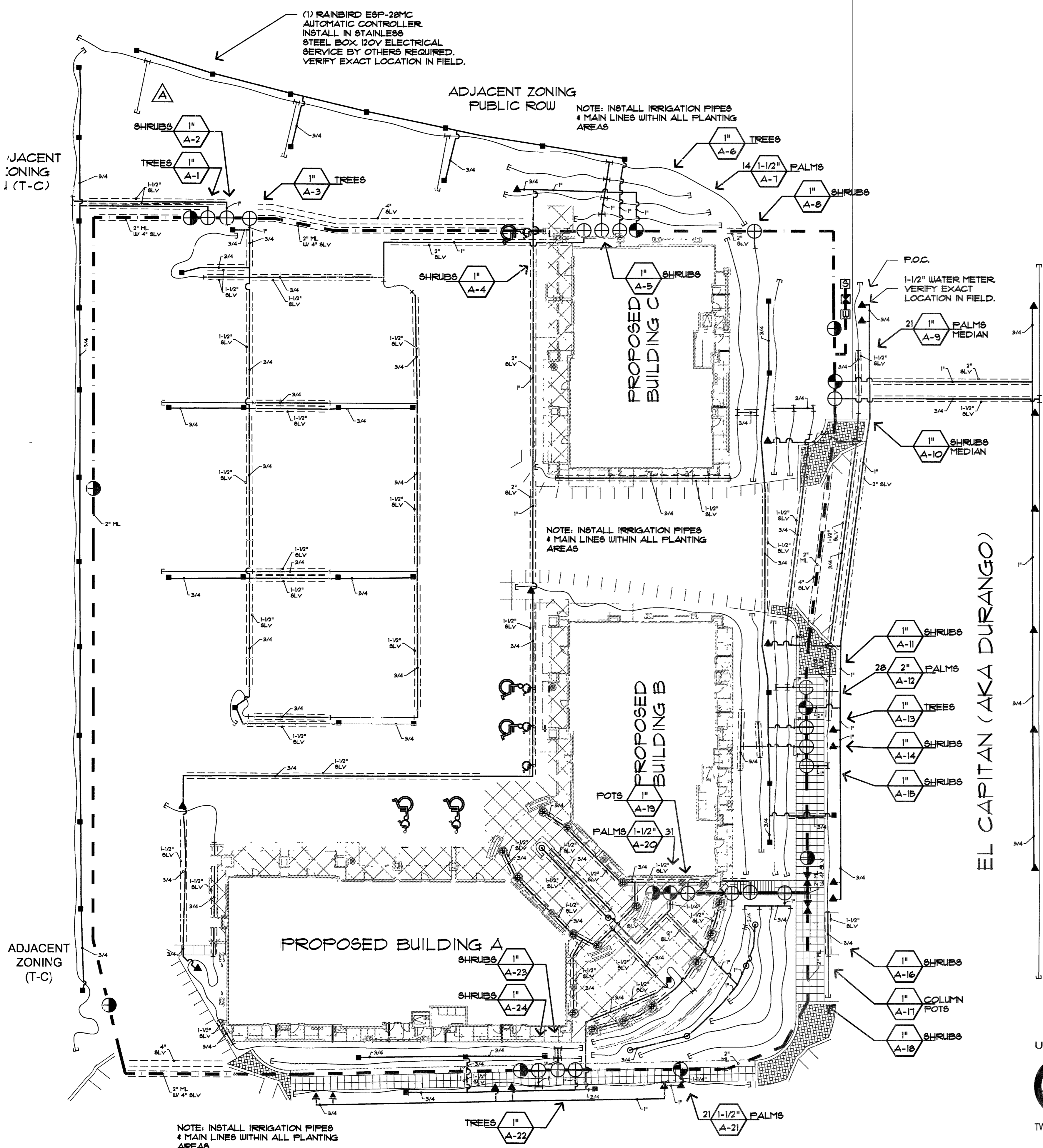

98281

CONSULTANT: R.P.A. LANDSCAPE ARCHITECTURE PLANNING
 25145 Project No.
 Las Vegas, Nevada 89018
 Phone: (702) 456-2772
 Fax: (702) 456-2773
 5960 S. Rainbow Blvd., Suite 100