

PS "PLT", MS "CD"
 I:\CAD\PL\B\B\B\5678\5678-13.DWG

04445

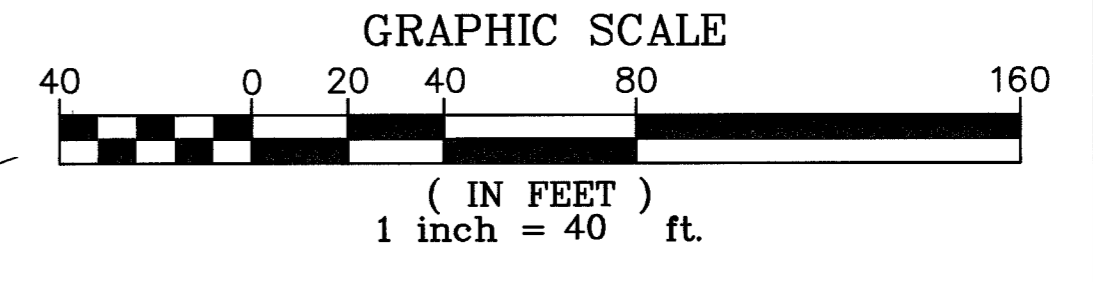
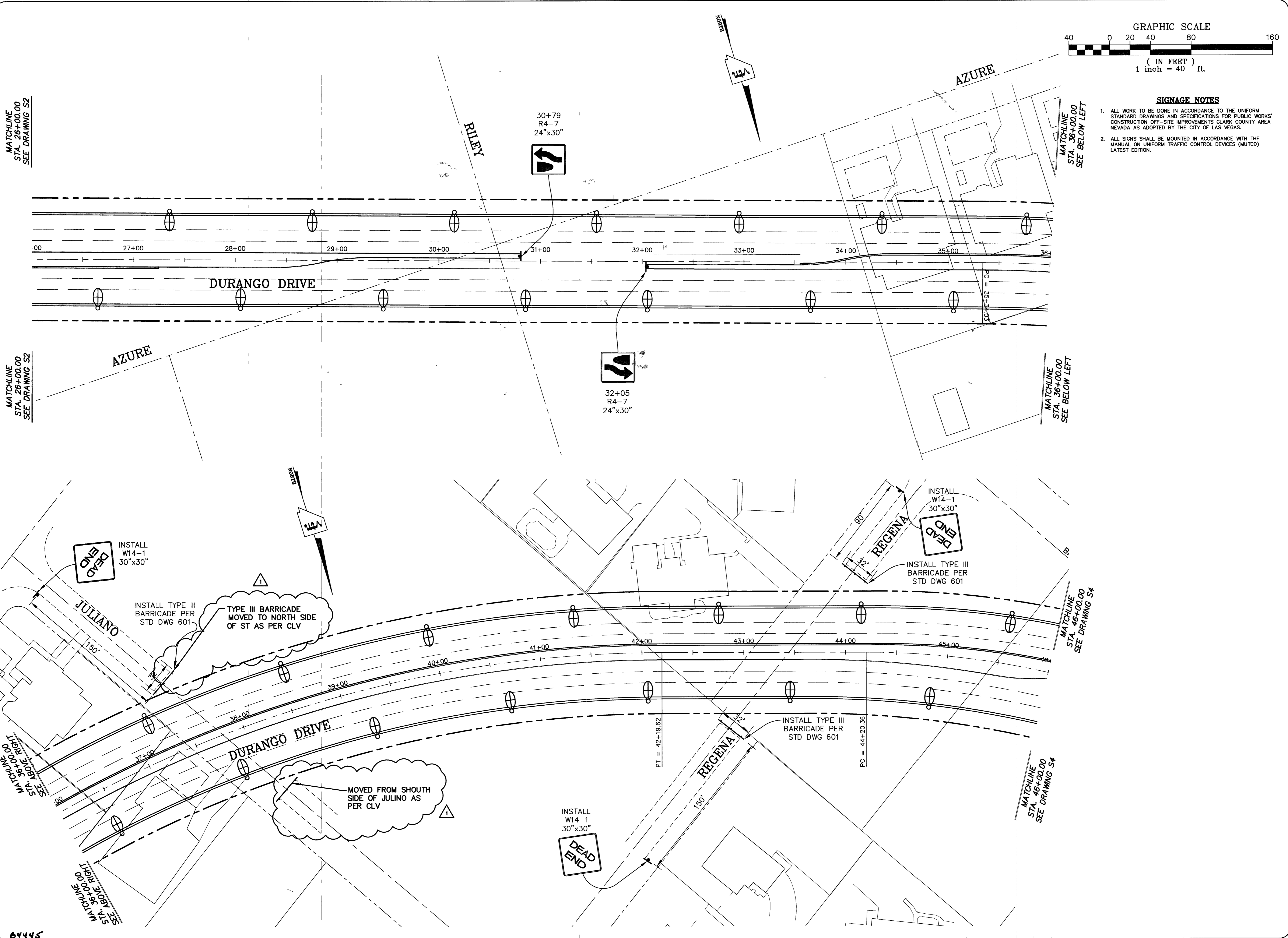

- SIGNAGE NOTES**
1. ALL WORK TO BE DONE IN ACCORDANCE TO THE UNIFORM STANDARD DRAWINGS AND SPECIFICATIONS FOR PUBLIC WORKS' CONSTRUCTION OFF-SITE IMPROVEMENTS CLARK COUNTY AREA NEVADA AS ADOPTED BY THE CITY OF LAS VEGAS.
 2. ALL SIGNS SHALL BE MOUNTED IN ACCORDANCE WITH THE MANUAL ON UNIFORM TRAFFIC CONTROL DEVICES (MUTCD) LATEST EDITION.

RECORD DRAWING INFORMATION AS PROVIDED BY TAB CONTRACTORS, INC.	
REV	DATE
1	10/19/05
BY	DB
CONSULTING ENGINEERS • PLANNERS • LAND SURVEYORS 2727 SOUTH RAINBOW BOULEVARD LAS VEGAS, NEVADA 89146-5148 PHONE (702) 873-7550 FAX (702) 362-2597	

TITLE
 SIGNING PLAN
 STA. 26+00.00 TO STA. 46+00.00
 DURANGO DRIVE

PROJECT
 DURANGO DRIVE IMPROVEMENTS
 TROPICAL PARKWAY TO I-215

ORIGINAL CONSTRUCTION DRAWINGS ARE ON FILE WITH THE CITY OF LAS VEGAS. THE DOCUMENTS WERE SEALED ON 12/10/03 BY ROBERT C. HOSEA III UNDER LICENSE NO. 10112

WO. NO. **5678**

BY **WBM**

DATE **12/05/03**

SCALE HORIZ. VERT. **1"=40'**
NA

DRAWING **03** SHEET **6** OF **11** SHEETS

RECORD DRAWINGS INFORMATION SUPPLIED BY CONTRACTOR - SEPTEMBER 2005