

PS "PLT", MS "T"
 I:\CAD\DWG\WORKS\5678\5678-SIG.DWG

62722

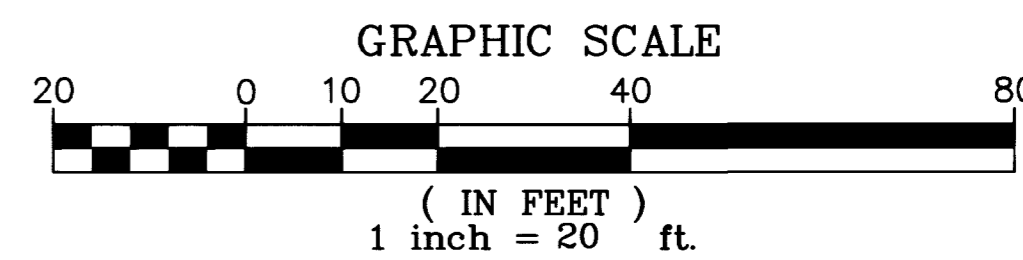
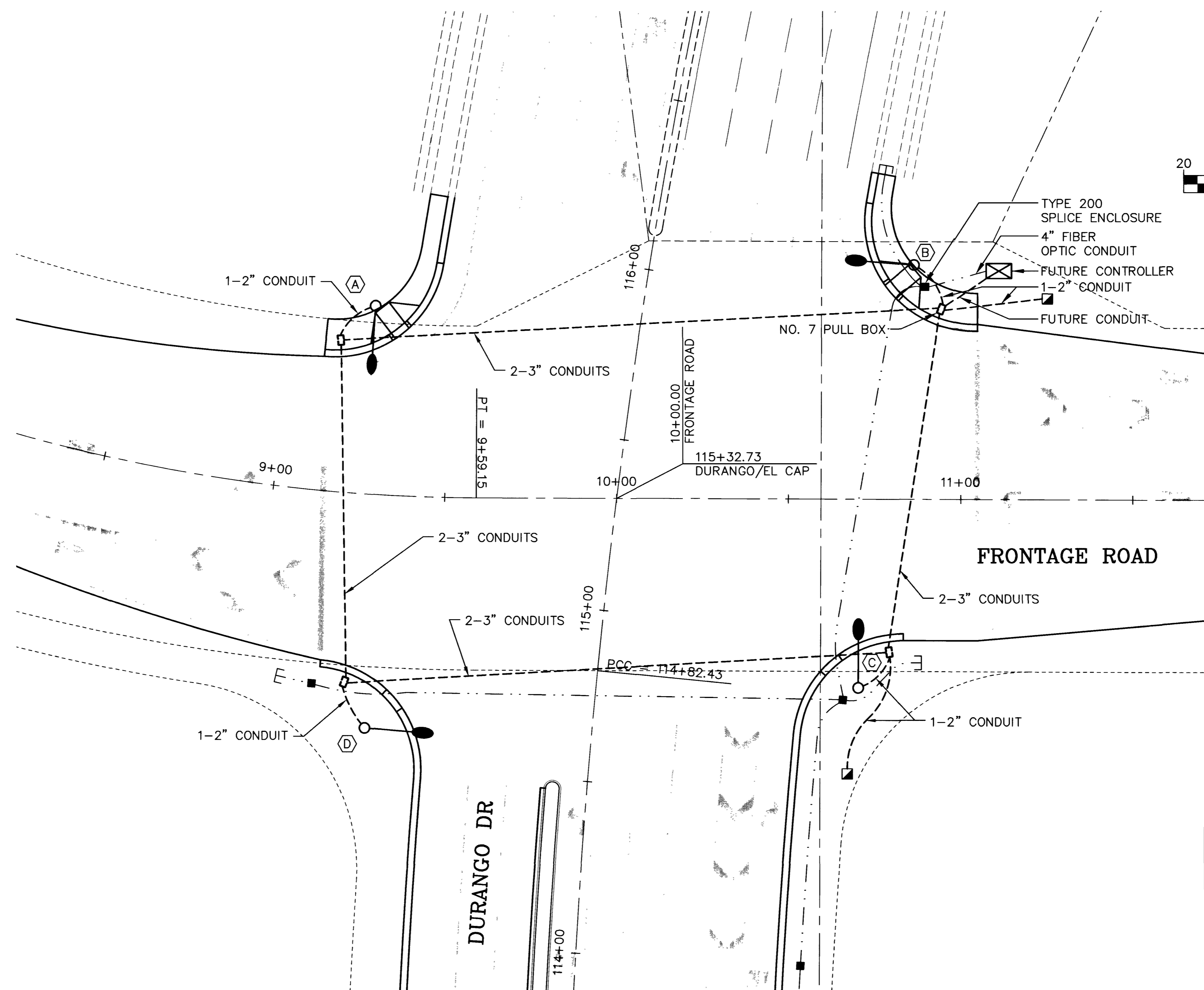

POLE SCHEDULE

POLE	LOCATION STATION	TYPE	SIGNAL ARM		LUMINAIRE ARM		SIGNAL VEHICLES		PED. SIGNAL VEHICLES		PED. PUSH BUTTONS		REMARKS
			QUAD.	LENGTH	QUAD.	LENGTH	TYPE	QUAD.	TYPE	QUAD.	QUAD.		
A	115+78.00 77.00' LT.	XX-A			1	15'							
B	116+14.00 76.00' RT.	XX-A			4	15'							
C	114+85.00 76.00' RT.	XX-A			3	15'							
D	114+60.00 66.00' LT.	XX-A			2	15'							

POLE NOTES

1. ALL POLE LOCATIONS ARE BASED FROM DURANGO DRIVE CENTERLINE STATIONING.
2. POLES A, B, C, & D SHALL HAVE A TYPE "L" FOUNDATION PER STD. DWG. NO. 404.209.

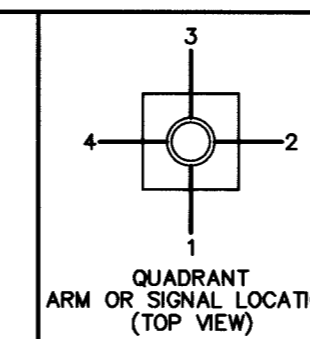

SHEET NOTES:

1. CONDUIT LOCATIONS AS SHOWN ON THE DRAWINGS ARE FOR CLARITY OF RUNS ONLY. ALL CONDUIT RUNS, EITHER SINGLE OR MULTIPLE, SHALL RUN CORNER TO CORNER. MULTIPLE RUNS NOT TERMINATING IN THE SAME PULL BOX SHALL PASS UNDER THE PULL BOX USING 90° ELBOWS AND CONTINUE TO THE NEXT CORNER OR TERMINATING POINT. ALL MULTIPLE CONDUIT RUNS SHALL BE PLACED IN THE SAME TRENCH WHENEVER POSSIBLE. THE PLACEMENT OF POLES AND CABINETS SHALL BE AS INDICATED ON THE PLANS. ALL CHANGES SHALL BE APPROVED BY THE TRAFFIC ENGINEER.
2. ALL PULLBOXES ARE NO. 5 UNLESS NOTED OTHERWISE.

SEE SHEET T9
 FOR DELINIATION

DEPARTMENT OF PUBLIC WORKS
 CITY OF LAS VEGAS



CONSULTING ENGINEERS • PLANNERS • LAND SURVEYORS
 2727 SOUTH RAINBOW BOULEVARD
 LAS VEGAS, NEVADA 89146-5148 PHONE (702) 873-7550 FAX (702) 362-2597

TITLE
TRAFFIC SIGNAL UNDERGROUND PLAN
DURANGO / FRONTAGE ROAD
 PROJECT
DURANGO DRIVE IMPROVEMENTS
 I-215 TO US 95

SEAL
ORIGINAL CONSTRUCTION DRAWINGS ARE ON FILE WITH THE CITY OF LAS VEGAS. THE DOCUMENTS WERE SEALED ON 12/17/02 BY ROBERT C. HOSEA III UNDER LICENSE NO. 10112

NO. NO. **5678**
 RCH
 BY **LMW, WBM**
 DATE **11/27/02**
 SCALE HORIZ. **1"=20'**
 VERT. **NA**
 DRAWING SHEET
T13 **73**
 OF **80**
 SHEETS

RECORD DRAWINGS INFORMATION SUPPLIED BY CONTRACTOR - DECEMBER 2003