

98072D11.dwg 6-18-98 11801 pm EST

27420

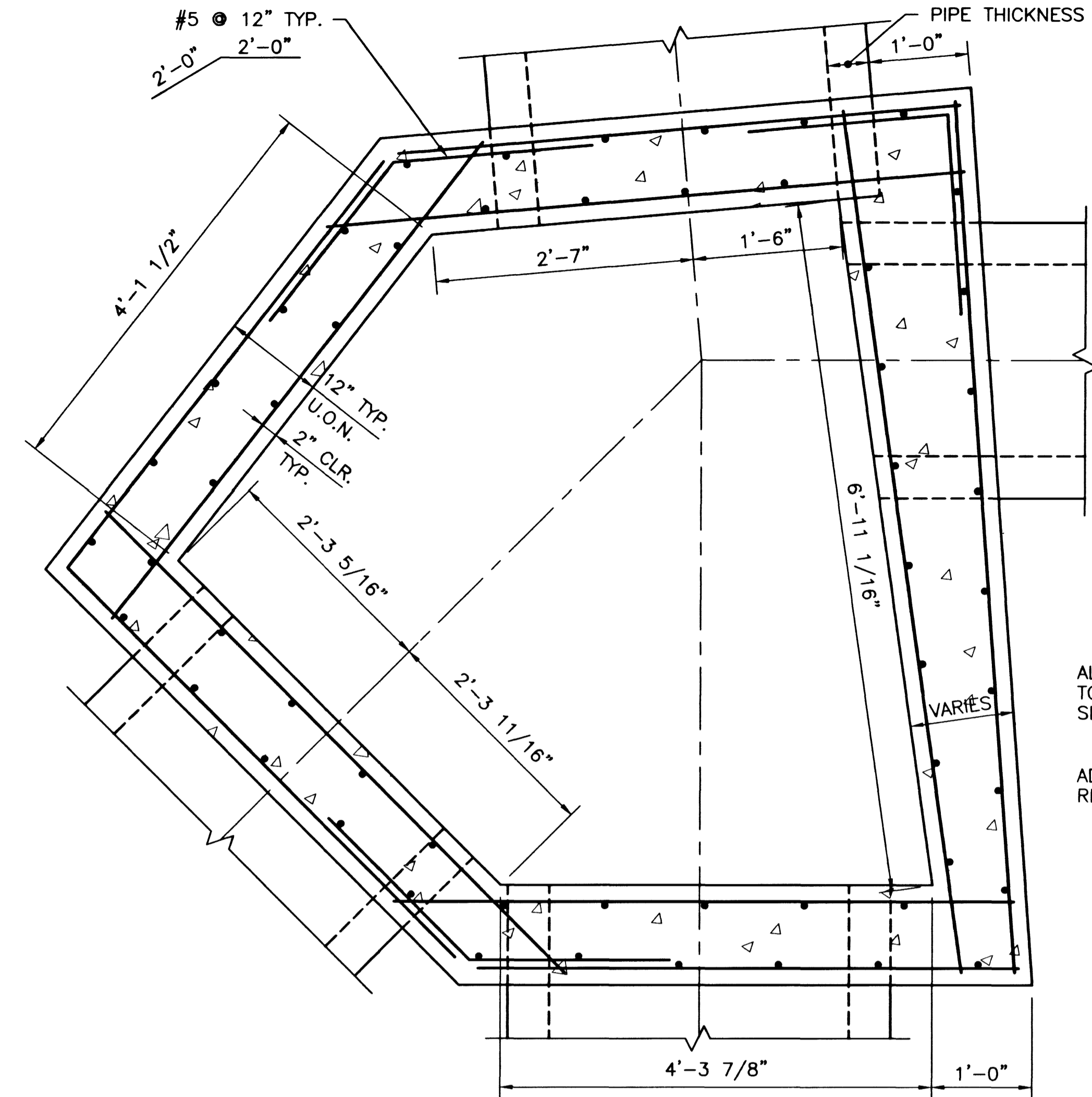

ALL REINFORCEMENT IN WALLS
TO BE #5 @ 12" E.W., E.F.
SEE 2 AND 3 FOR
D21 D21
ADDITIONAL REINF. CUT AS
REQUIRED AT PIPE OPENINGS

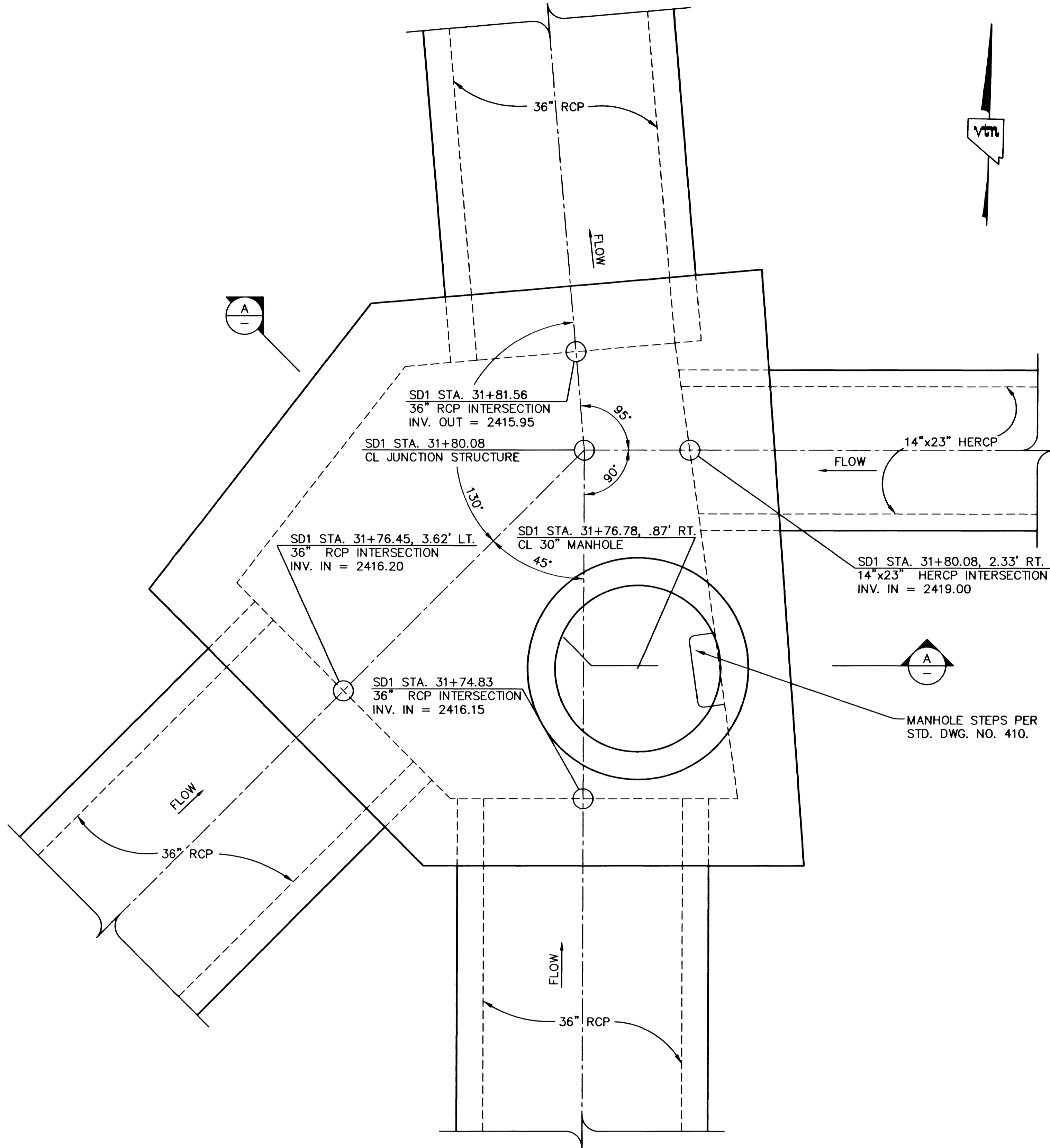
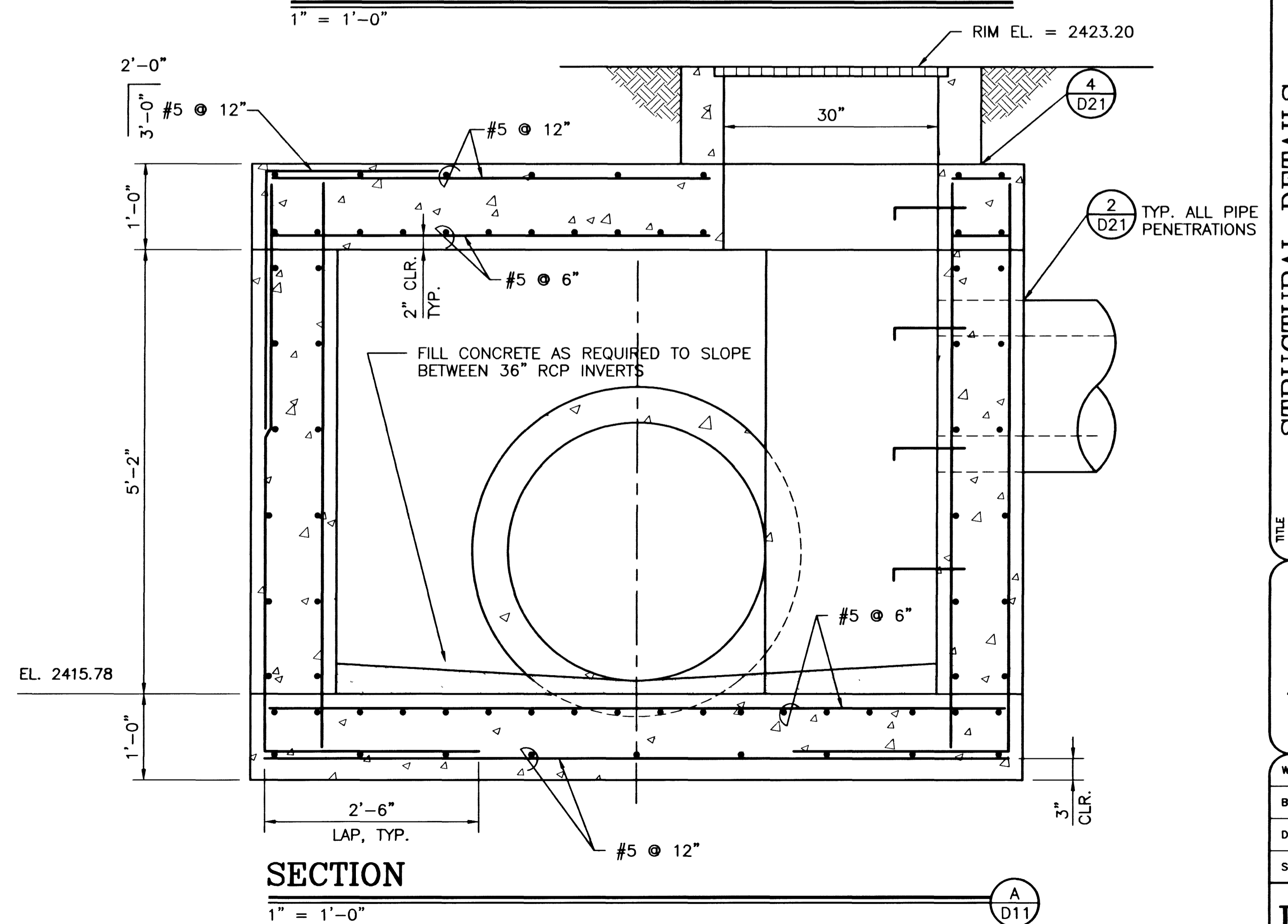

DEPARTMENT OF PUBLIC WORKS
CITY OF LAS VEGAS

REVISION
REV DATE BY

CONSULTING ENGINEERS & PLANNERS & LAND SURVEYORS
277 SOUTH MAIN STREET, SUITE 300
LAS VEGAS, NEVADA 89101
PHONE (702) 575-7000 FAX (702) 575-7000

R2H
nevada

TITLE
STRUCTURAL DETAILS
JUNCTION STRUCTURE
SD1 STA. 31+80.08

PROJECT
DURANGO DRIVE IMPROVEMENTS
CHEYENNE AVENUE TO LONE MOUNTAIN ROAD

PROFESSIONAL ENGINEER-STATE OF NEVADA
DAVID W. SEELY, INC.
No. 1175
7/9/98

WO NO. 5249
BY WSW
DATE 7/17/98
SCALE HORIZ. VERT.
DRAWING SHEET 17 OF 108 SHEETS
D11