

- LEGEND**
- NEW A.C. PAVEMENT (SEE TYPICAL X-SECTIONS)
 - EXISTING A.C. PAVEMENT TO BE REMOVED
 - EXISTING A.C. PAVEMENT TO REMAIN WITH NEW A.C. OVERLAY (SEE TYPICAL X-SECTIONS)
 - NEW TEMPORARY A.C. (SEE TYPICAL X-SECTIONS)
 - NEW CONCRETE MEDIAN

APPROVED

12/22/98
DATE

LAS VEGAS VALLEY WATER DISTRICT

CONSTRUCTION NOTES

- 1 PROTECT IN PLACE
- 2 SAWCUT & MATCH
- 3 REMOVE EXISTING A.C., AGGREGATE BASE AND/OR CONCRETE
- 4 CONSTRUCT MEDIAN ISLAND SEE MEDIAN ISLAND GEOMETRICS AND IRRIGATION PLAN DWG'S R17 - R21
- 5 CONSTRUCT PAVEMENT CROWN TRANSITION SEE MEDIAN ISLAND GEOMETRICS AND IRRIGATION PLAN DWG'S R17 - R21
- 6 EDGE OF NEW A.C. PAVEMENT
- 7 REMOVE A.C. WALKWAY
- 8 CONSTRUCT "L" TYPE CURB AND GUTTER PER USD NO. 216
- 9 CONSTRUCT CURB AND GUTTER AND SIDEWALK RAMP CASE II PER USD NO. 235
- 10 12" CMP
- 11 ADJUST TO FINISH GRADE
- 12 CONSTRUCT 6" TYPE II AGGREGATE BASE AT 95% COMPACTION
- 13 RELOCATE
- 14 CONSTRUCT MEDIAN ISLAND IRRIGATION FACILITIES FOR FUTURE CONNECTION SEE MEDIAN ISLAND GEOMETRICS AND IRRIGATION PLAN DWG'S R17 - R21
- 15 REESTABLISH SURVEY MONUMENT TO FINISH GRADE PER STANDARD DWGS. AND STANDARD SPECS.
- 16 ESTABLISH SURVEY MONUMENT TO FINISH GRADE PER STANDARD DWGS. AND STANDARD SPECS.
- 17 CONSTRUCT CURB AND GUTTER AND MODIFIED SIDEWALK RAMP CASE II PER DETAIL 6 ON SHT D24
- 18 CONSTRUCT GUARDRAIL SEE DWG SD13

FOR STRIPING, STREET LIGHTS AND TRAFFIC SIGNAL PLANS SEE DWG'S T1 - T15

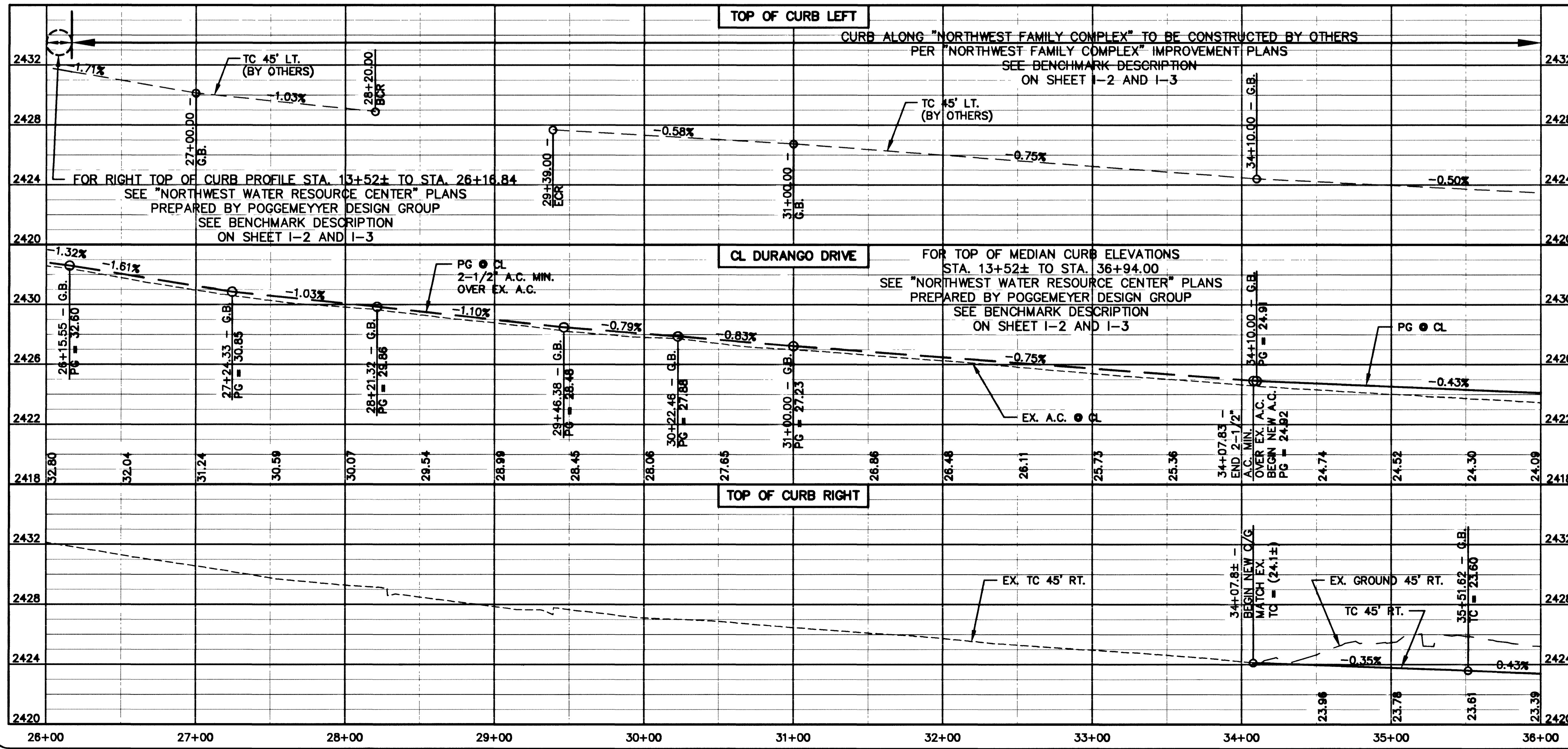

REVISION

NO.	DATE	BY

DEPARTMENT OF PUBLIC WORKS
CITY OF LAS VEGAS, NEVADA

CONSULTING ENGINEERS • PLANNERS • LAND SURVEYORS
2727 SOUTH RAINBOW BOULEVARD
LAS VEGAS, NEVADA 89102-5148 PHONE (702) 875-7550 FAX (702) 362-2597

vtm nevada

TITLE **ROADWAY PLAN AND PROFILE**
STA. 26+00.00 TO STA. 36+00.00
PROJECT **DURANGO DRIVE IMPROVEMENTS**
DURANGO DRIVE
CHEYENNE AVENUE TO LONE MOUNTAIN ROAD

SEAL

NO. NO. **5249**

BY **JL/TMM**

DATE **07/17/98**

SCALE HORIZ. VERT. **1"=40' 1"=4'**

DRAWING SHEET **R3 33**
OF 106 SHEETS

VIEWS: MS - C, P, PS - T, L, T
 I: CAD (V) DRAWN: JZ49 (JZ49-D.DWG)

27436