

FED. RD. REG. NO.	STATE	PROJECT NO.	COUNTY	SHEET NO.
9	NEVADA	STP-604 (3)	CLARK	7

- STA 26+80 (36' LT)
CONSTRUCT 16"x8" WET TAP SLEEVE
AND 6" GATE VALVE AND 18 LF OF 6"
WATER LINE (PER LVVMD STDS)
- STA 28+25 (0' LT) REMOVE EXIST DROP INLET
STA 28+25 (0' LT) RESET W/TYPE 11 DROP INLET
- STA 28+75 (3' LT)
REMOVE AND REPLACE TRAFFIC SIGNAL
BOXES (2). PROVIDE CONDUIT AND
RECONNECT WIRE
- STA 28+87 (4' LT)
REMOVE EXIST WATER METER
ASSEMBLY (PER LVVMD STDS)
- STA 28+94 (5' LT - RESET 3' LT)
STA 30+23 (14' LT - RESET 23' LT)
REMOVE AND RESET TRAFFIC SIGNAL POLE.
PROVIDE NEW FOUNDATION (PER T-30.1.13)
- STA 28+97 TO STA 30+22
INSTALL PVC CONDUITS
- STA 29+05.51 (42' LT)
CONSTRUCT WHEELCHAIR RAMP DELETED
SEE DETAIL 6

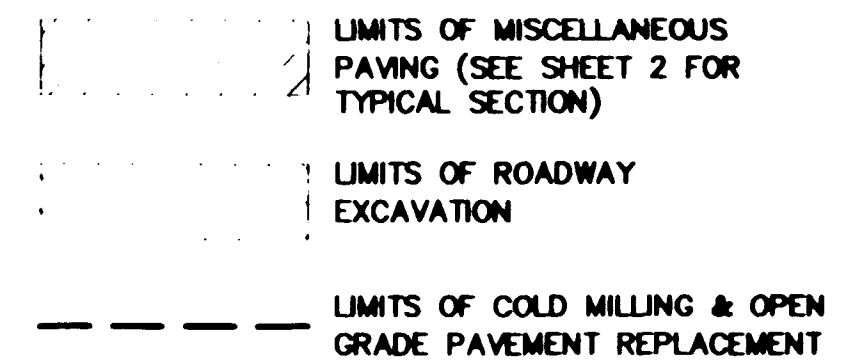

CURVE	RADIUS	LENGTH	TANGENT	DELTA
C1	100.00'	31.78'	16.01'	161°14'27"
C2	2.00'	6.28'	<math>\frac{1}{2} \text{ mile}>	180°00'00"
C3	5.00'	8.88'	7.56'	113°10'28"
C4	15.00'	18.40'	10.55'	70°15'50"
C5	250.00'	74.44'	37.50'	170°3'35"
C6	250.00'	4.01'	2.95'	00°59'12"
C7	100.00'	2.63'	1.31'	01°30'18"

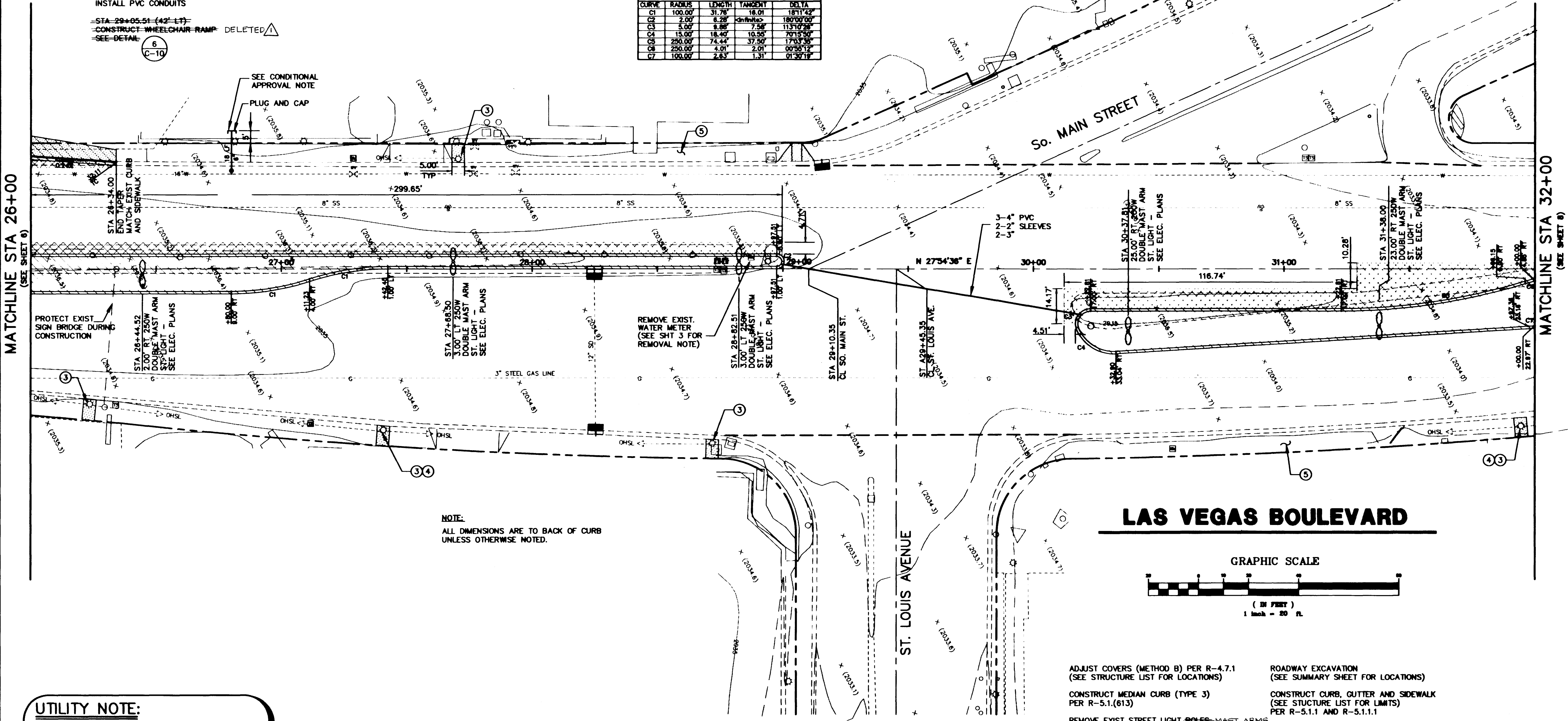

NOTE:
ALL DIMENSIONS ARE TO BACK OF CURB
UNLESS OTHERWISE NOTED.

LAS VEGAS BOULEVARD

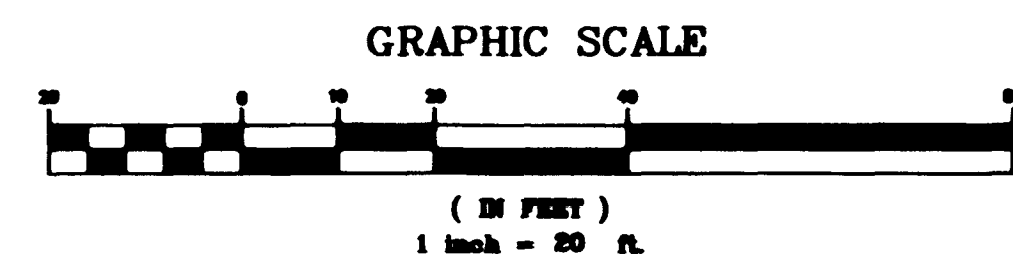

- ADJUST COVERS (METHOD B) PER R-4.7.1 (SEE STRUCTURE LIST FOR LOCATIONS)
- CONSTRUCT MEDIAN CURB (TYPE 3) PER R-5.1.(61.3)
- REMOVE EXIST STREET LIGHT POLES, FOUNDATIONS AND SIDEWALK (SEE STRUCTURE LIST FOR LOCATIONS)
- ROADWAY EXCAVATION (SEE SUMMARY SHEET FOR LOCATIONS)
- CONSTRUCT CURB, GUTTER AND SIDEWALK (SEE STRUCTURE LIST FOR LIMITS) PER R-5.1.1 AND R-5.1.1.1
- INSTALL TRAFFIC LOOP DETECTORS (SEE STRUCTURE LIST FOR LOCATIONS)
- CONSTRUCT STREET LIGHT ASSEMBLIES. (SEE STRUCTURE LIST FOR LOCATIONS AND SHEET T-1 FOR DETAILS)

UTILITY NOTE:
THE LOCATION OF UNDERGROUND UTILITIES SHOWN HEREON HAS BEEN DETERMINED FROM SURFACE EVIDENCE OF THEIR EXISTENCE OR FROM INFORMATION OBTAINED FROM THE UTILITY COMPANIES. THE ENGINEER ACCEPTS NO LIABILITY FOR THE EXISTENCE OR NON-EXISTENCE OF UTILITY LINES. CONTRACTORS AND OTHERS USING THIS DRAWING MUST CONFIRM THE LOCATION OF UNDERGROUND LINES OR STRUCTURES WITH THE UTILITY COMPANIES PRIOR TO COMMENCING ANY EXCAVATION OR ORDERING OF MATERIALS.
CALL 1-800-227-2800 BEFORE ANY EXCAVATION TAKES PLACE

AS BUILT

Call before you Dig.
1-800-227-2800

REVISIONS

DATE

DESIGNED BY DWS

CHECKED BY TEP

DATE 01-08-06

ENGINEERS SURVEYORS

PLANNERS

POGGEMEYER DESIGN GROUP

2801 NORTH TENAYA WAY LAS VEGAS, NEVADA 89128 (703) 235-8100

DEPARTMENT OF PUBLIC WORKS

SAHARA AVENUE TO OAKLEY BOULEVARD

DOWNTOWN ENTRY CORRIDOR IMPROVEMENTS

STA 26+00 - STA 32+00

PROJECT

SHEET

DRAWING NO. 12/7

