

FED. RD. REG. NO.	STATE	PROJECT NO.	COUNTY	SHEET NO.
9	NEVADA	STP-604 (3)	CLARK	4

DATE	REVISIONS
	AS-BUILT

JOB No. 94144	DESIGNED BY DWS	DRAWN BY DW
SHEET No. 4	DATE 01-08-98	CHECKED BY TEP
	ENGINEERS	SUPVISOR
		PLANNERS

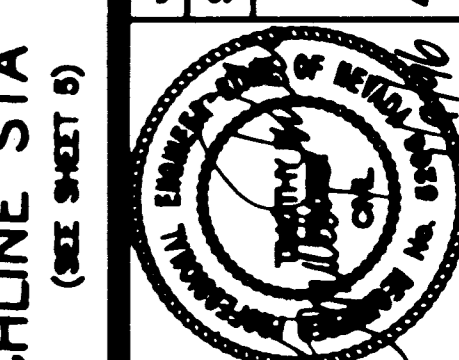

DEPARTMENT OF PUBLIC WORKS
 PROJECT: DOWNTOWN ENTRY CORRIDOR IMPROVEMENTS
 SHEET: SAHARA AVENUE TO OAKY BOULEVARD
 STA 10+00 TO STA 14+00

POGGEMEYER DESIGN GROUP
 2801 NORTH TENAYA WAY LAS VEGAS, NEVADA 89128 (702) 255-8100

DRAWING NO.	9
	4
1-800-227-2800	52

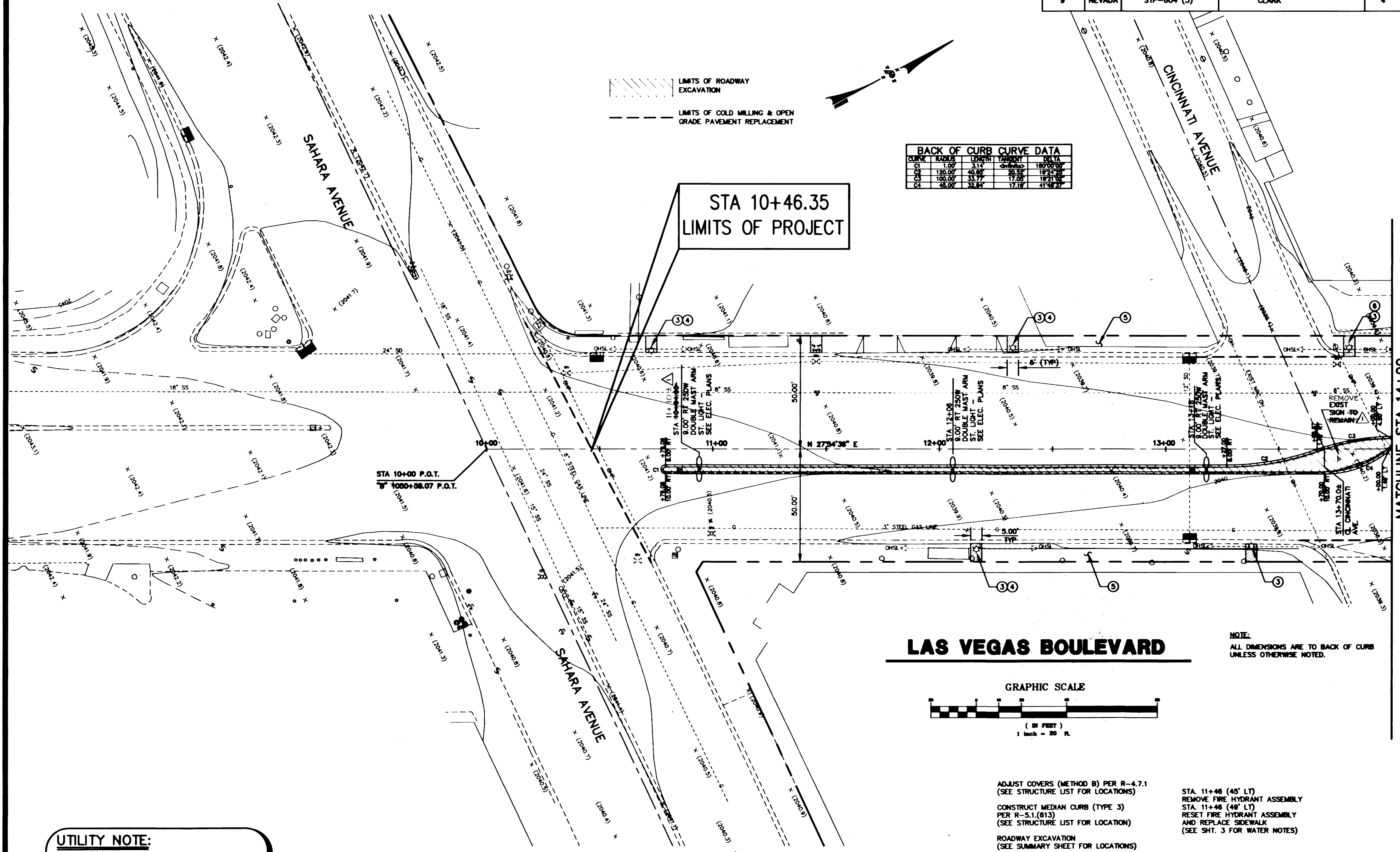

LIMITS OF ROADWAY EXCAVATION
 LIMITS OF COLD MILLING & OPEN GRADE PAVEMENT REPLACEMENT

CURVE	RADIUS	LENGTH	PERCENT	DELTA
CL	1.00	3.14	4.00	180.00
CC	120.00	46.08	20.00	19.24
CA	100.00	33.77	17.00	19.21
CB	40.00	32.84	17.19	41.38

STA 10+46.35
 LIMITS OF PROJECT

LAS VEGAS BOULEVARD

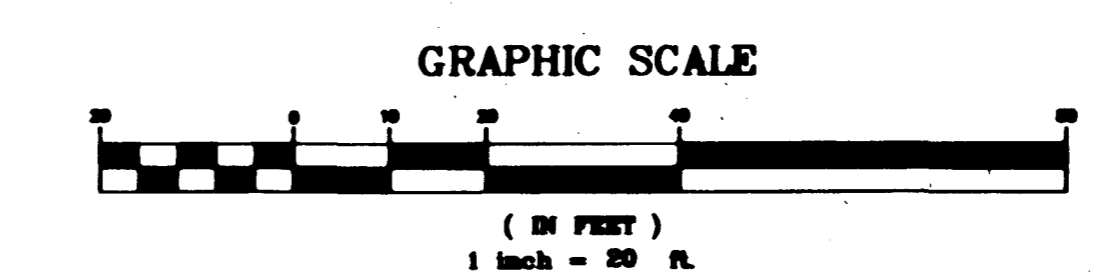

NOTE:
 ALL DIMENSIONS ARE TO BACK OF CURB UNLESS OTHERWISE NOTED.

- ADJUST COVERS (METHOD B) PER R-4.7.1 (SEE STRUCTURE LIST FOR LOCATIONS)
- CONSTRUCT MEDIAN CURB (TYPE 3) (SEE STRUCTURE LIST FOR LOCATION)
- ROADWAY EXCAVATION (SEE SUMMARY SHEET FOR LOCATIONS)
- INSTALL TRAFFIC LOOP DETECTORS (SEE STRUCTURE LIST FOR LOCATIONS)
- REMOVE EXIST STREET LIGHT POLES, MASTS AND FOUNDATIONS AND SIDEWALK (SEE LUMINAIRES STRUCTURE LIST FOR LOCATIONS)
- CONSTRUCT STREET LIGHT ASSEMBLIES (SEE STRUCTURE LIST FOR LOCATIONS AND SHEET E-1 FOR DETAILS)

- STA. 11+48 (45' LT) REMOVE FIRE HYDRANT ASSEMBLY
- STA. 11+48 (48' LT) RESET FIRE HYDRANT ASSEMBLY AND REPLACE SIDEWALK (SEE SHT. 3 FOR WATER NOTES)

UTILITY NOTE:
 THE LOCATION OF UNDERGROUND UTILITIES SHOWN HEREON HAS BEEN DETERMINED FROM SURFACE EVIDENCE OF THEIR EXISTENCE OR FROM INFORMATION OBTAINED FROM THE UTILITY COMPANIES. THE ENGINEER ACCEPTS NO LIABILITY FOR THE EXISTENCE OR NON-EXISTENCE OF UTILITY LINES. CONTRACTORS AND OTHERS USING THIS DRAWING MUST CONFIRM THE LOCATION OF UNDERGROUND LINES OR STRUCTURES WITH THE UTILITY COMPANIES PRIOR TO COMMENCING ANY EXCAVATION OR ORDERING OF MATERIALS.
 CALL 1-800-227-2800 BEFORE ANY EXCAVATION TAKES PLACE.

AS BUILT
 Call before you Dig.
 1-800-227-2800

NO.	PROJECT NO.	DATE
1	SP-100-02	6-1-66

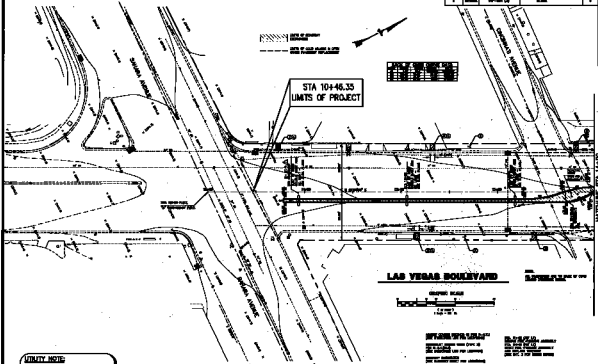

STA 10+46.35
LIMITS OF PROJECT

STATION	WATER	SEWER	GAS
10+00	12"	12"	12"
10+10	12"	12"	12"
10+20	12"	12"	12"
10+30	12"	12"	12"
10+40	12"	12"	12"
10+50	12"	12"	12"
10+60	12"	12"	12"
10+70	12"	12"	12"
10+80	12"	12"	12"
10+90	12"	12"	12"
10+100	12"	12"	12"

LAS VEGAS BOULEVARD

SUNBELT



NOTES:
 1. ALL DIMENSIONS TO CENTERLINE UNLESS OTHERWISE SHOWN.
 2. ALL UTILITIES TO BE DELETED OR RELOCATED AS SHOWN.
 3. SEE ATTACHED SHEETS FOR DETAILS.
 4. SEE ATTACHED SHEETS FOR MATERIALS.
 5. SEE ATTACHED SHEETS FOR SPECIFICATIONS.
 6. SEE ATTACHED SHEETS FOR CONTRACT DOCUMENTS.

CONTRACT NO. SP-100-02
SECTION 100-02
DATE: 6-1-66

AS BUILT



UTILITY NOTE:
 ALL UTILITIES SHOWN ARE BASED ON RECORD DRAWINGS AND FIELD SURVEY. THE CONTRACTOR SHALL VERIFY THE LOCATION AND DEPTH OF ALL UTILITIES PRIOR TO CONSTRUCTION.

DEPARTMENT OF PUBLIC WORKS
 DIVISION OF WATER SUPPLY
 107-V2268F