

**MEDIAN EXCAVATION SECTION A-A (TYP)**  
NO SCALE

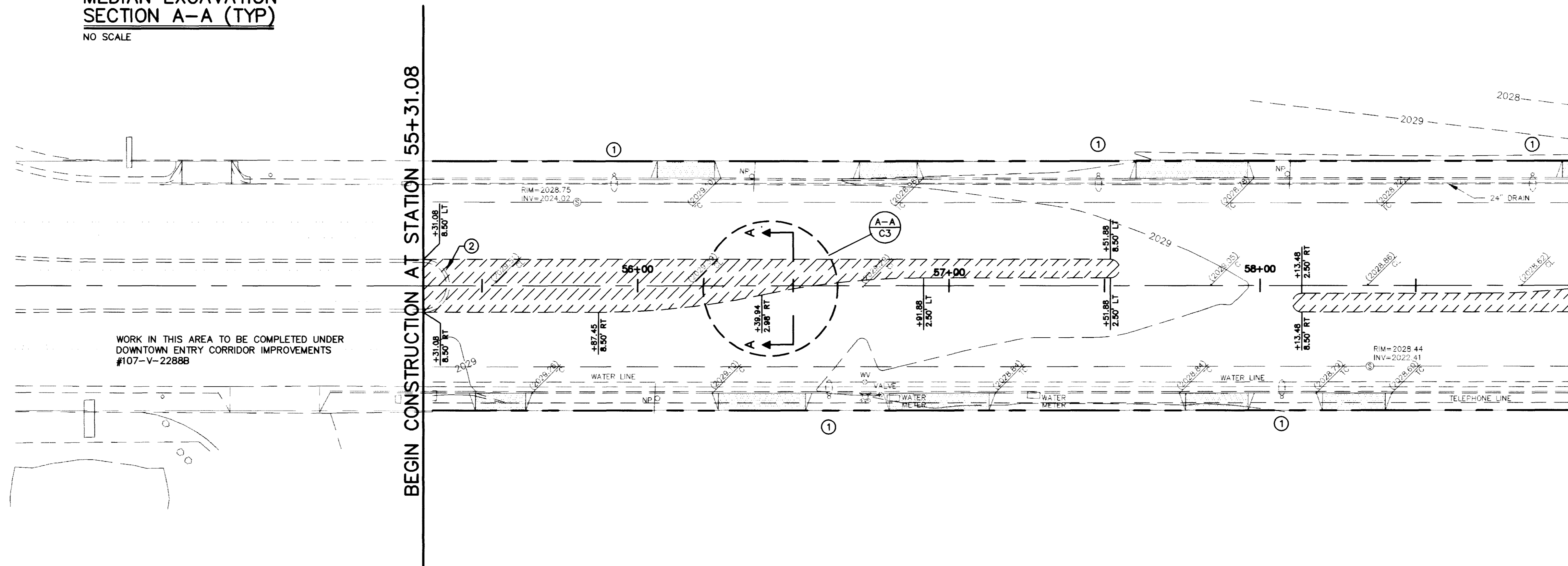

WORK IN THIS AREA TO BE COMPLETED UNDER DOWNTOWN ENTRY CORRIDOR IMPROVEMENTS #107-V-2288B

BEGIN CONSTRUCTION AT STATION 55+31.08

MATCHLINE STA 59+00 (SEE SHEET 4)

**LAS VEGAS BOULEVARD**

- ① STREET LIGHT ARM AND LUMINAIRE REMOVAL: REMOVE STREET LIGHT ARM AND LUMINAIRE, PULL FUSE IN BASE OF POLE AND BOLT PLATE OVER ARM OPENING
- ② REMOVE EXISTING TACK ON CURB NOSE AND MATCH WITH EXISTING TOP OF CURB GRADE

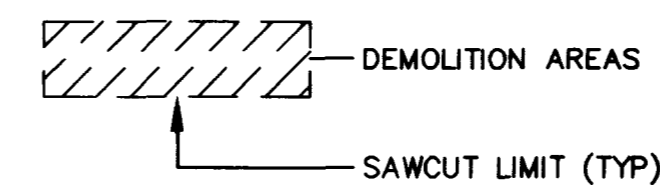
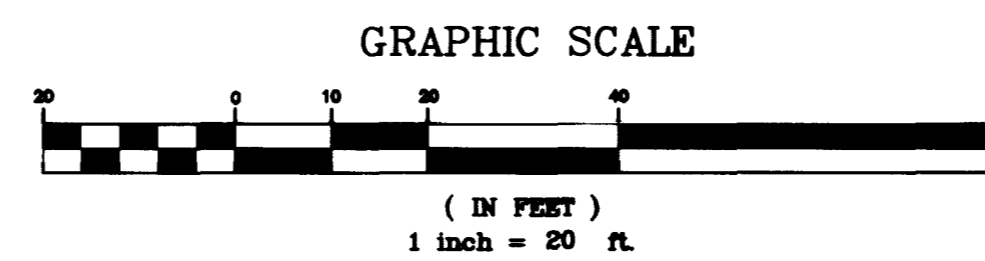

**UTILITY NOTE:**

THE LOCATION OF UNDERGROUND UTILITIES SHOWN HEREON HAS BEEN DETERMINED FROM SURFACE EVIDENCE OF THEIR EXISTENCE OR FROM INFORMATION OBTAINED FROM THE UTILITY COMPANIES. THE ENGINEER ACCEPTS NO LIABILITY FOR THE EXISTENCE OR NON-EXISTENCE OF UTILITY LINES. CONTRACTORS AND OTHERS USING THIS DRAWING MUST CONFIRM THE LOCATION OF UNDERGROUND LINES OR STRUCTURES WITH THE UTILITY COMPANIES PRIOR TO COMMENCING ANY EXCAVATION OR ORDERING OF MATERIALS.

CALL 1-800-227-2600 BEFORE ANY EXCAVATION TAKES PLACE

RECORD DRAWING

Call before you Dig.  
1-800-227-2600



DRAWING NO. 3/28  
C-3

DEPARTMENT OF PUBLIC WORKS  
PROJECT: DOWNTOWN ENTRY CORRIDOR IMPROVEMENTS  
LAS VEGAS BLVD. BEAUTIFICATION  
4TH STREET TO CHARLESTON BLVD.

DEMOLITION PLAN  
STA 55+34.08 TO 59+00

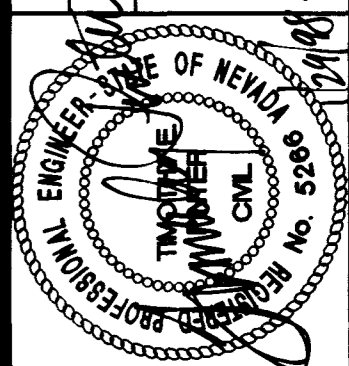

POGGEMEYER DESIGN GROUP  
2601 NORTH TENAYA WAY LAS VEGAS, NEVADA 89128 (702) 255-8100

REVISIONS	DATE

ANY INFORMATION OR DATA ON THIS DRAWING IS NOT INTENDED TO BE SUITABLE FOR REUSE FOR ANY USE OR IN ANY OTHER PROJECT. ANY REUSE WITHOUT WRITTEN PERMISSION AND WITHOUT LIABILITY OF THE ENGINEER.

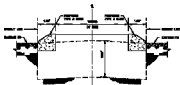

**MEDIAN EXCAVATION  
SECTION A-A (TOP)**

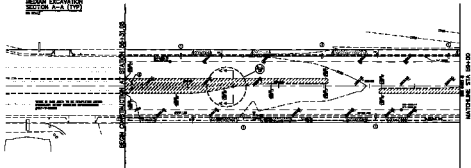

**LAS VEGAS BOULEVARD**

- ① EXIST. CURB AND GUTTER ELEVATIONS
- ② EXIST. PAVEMENT ELEVATIONS
- ③ PROPOSED PAVEMENT ELEVATIONS



**VISIBILITY NOTICE**  
 THE INFORMATION CONTAINED HEREIN IS THE PROPERTY OF THE ENGINEER AND IS NOT TO BE REPRODUCED OR TRANSMITTED IN ANY FORM OR BY ANY MEANS, ELECTRONIC OR MECHANICAL, INCLUDING PHOTOCOPYING, RECORDING, OR BY ANY INFORMATION STORAGE AND RETRIEVAL SYSTEM, WITHOUT THE WRITTEN PERMISSION OF THE ENGINEER.

RECORD DRAWING



DEPARTMENT OF PUBLIC WORKS

DESIGNED BY: [Signature]  
 CHECKED BY: [Signature]  
 DATE: [Date]



1-4