

DEMOLITION PLAN NOTES

- THIS CONTRACT INCLUDES THE DEMOLITION, REMOVAL, AND RECONSTRUCTION OF STREETSCAPE IMPROVEMENTS GENERALLY DESCRIBED AS OCCURRING FROM BACK OF CURB TO THE RIGHT-OF-WAY LIMIT OR WITHIN LANDSCAPE EASEMENT AS NOTED. CONDITIONS MAY VARY.

THE CONTRACTOR IS TO BECOME FAMILIAR WITH THE PROJECT ROADWAY PLANS (CONTRACT 2), AS PREPARED BY KIMLEY-HORN AND ASSOCIATES, AND WITH THESE PLANS AND SPECIFICATIONS, PREPARED BY URBAN RESOURCE GROUP (A DIVISION OF KIMLEY-HORN AND ASSOCIATES, INC.), FOR SPECIAL CONDITIONS PERTAINING TO BOTH PROJECTS.
- CONTRACTOR SHALL COORDINATE THIS WORK WITH THE ROADWAY CONTRACTOR IN ORDER TO ENSURE ADEQUATE MAINTENANCE OF TRAFFIC (M.O.T.), AND THE PROTECTION OF ALL EXISTING IMPROVEMENTS.
- TYPICAL IMPROVEMENTS MADE UNDER CONTRACT 2 WHICH WILL REQUIRE PROTECTION INCLUDE:
 - EXISTING ROADWAY STREET LIGHT POLES (REFER TO ROADWAY PROJECT SPECIFICATIONS)
 - ALL NEW AND EXISTING CURBS (REFER TO ROADWAY PROJECT SPECIFICATIONS UNLESS NOTED OTHERWISE)
 - DRIVEWAY IMPROVEMENTS ONTO PUBLIC OR PRIVATE PROPERTY (REFER TO ROADWAY PROJECT SPECIFICATIONS)
 - EXISTING DRAINAGE STRUCTURES
 - EXISTING DIRECTIONAL AND REGULATORY SIGNAGE AND PARKING METER POSTS
- CONTRACTOR IS ALERTED TO THE POSSIBILITY OF ADDITIONAL DEMOLITION REQUIRED ON POLE FOUNDATIONS, PARTIALLY REMOVED UNDER CONTRACT 2, AS CONFLICTS MAY EXIST WITH NEW TREE FITS OR OTHER CONSTRUCTION.
- CONTRACTOR SHALL BE REQUIRED TO PROTECT AND ADJUST OR REPLACE EXISTING UTILITY BOXES AS NECESSARY TO ADJUST FOR FINISHED SIDEWALK GRADES. CONTRACTOR SHALL REPLACE THOSE BOXES IN NEED OF REPAIR OR NOT MEETING CURRENT OWNER OR APPLICABLE UTILITY COMPANY STANDARDS. REFER TO SPECIAL PROVISIONS FOR BOX FINISHES.

MATCHLINE
SEE SHEET DM-2

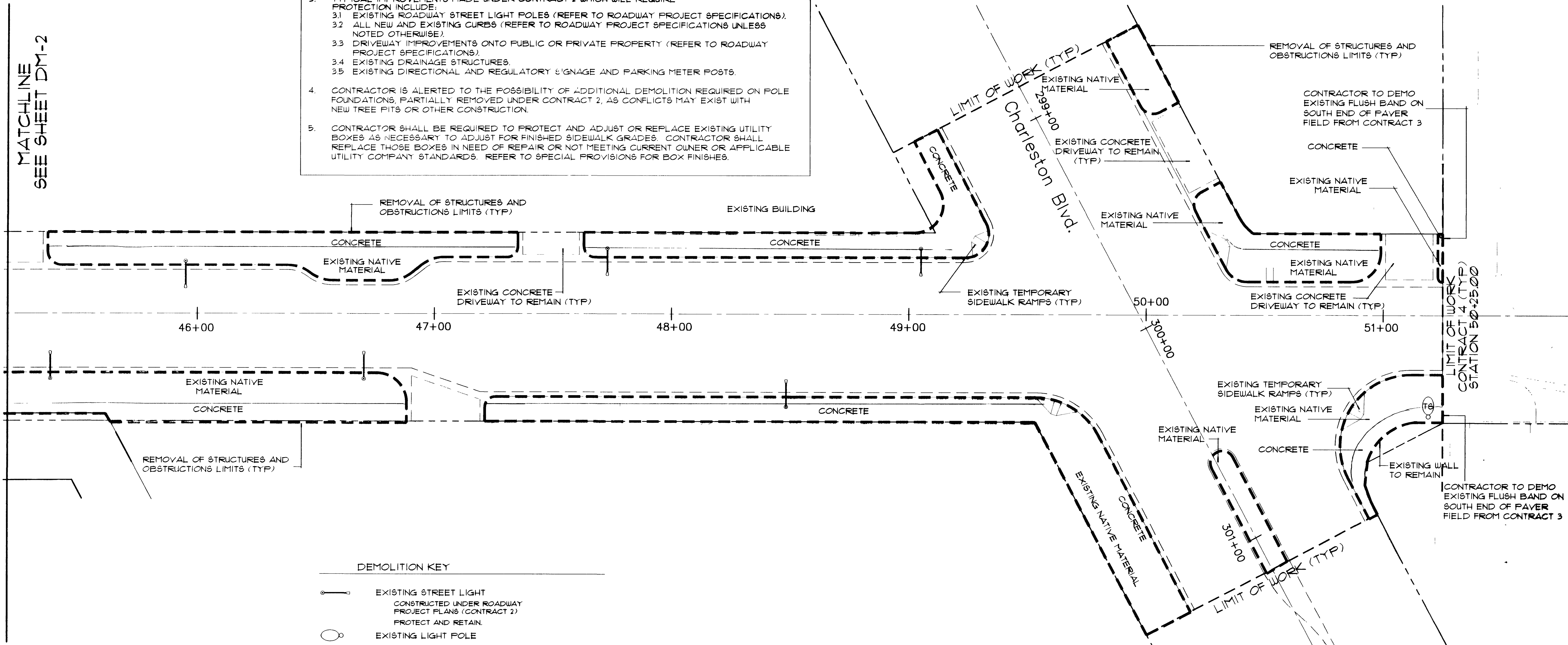

DEMOLITION KEY

- EXISTING STREET LIGHT
CONSTRUCTED UNDER ROADWAY PROJECT PLANS (CONTRACT 2)
PROTECT AND RETAIN.
- EXISTING LIGHT POLE
TO REMAIN
PROTECT AND RETAIN POLE AND FOUNDATION
- EXISTING TRAFFIC SIGNAL POLE/PEDESTRIAN POLE
TO REMAIN
- EXISTING TREE - PALM TO REMAIN
- REMOVAL OF STRUCTURES AND OBSTRUCTIONS LIMIT
- EXISTING LANDSCAPING TO REMAIN

Avoid cutting underground utility lines. It's costly.
Call before you Dig.
1-800-227-2600
LICENSING SERVICE AREA ONLY

| NO. | REVISIONS | DATE | BY |
|-----|-----------|------|----|
| | | | |
| | | | |
| | | | |

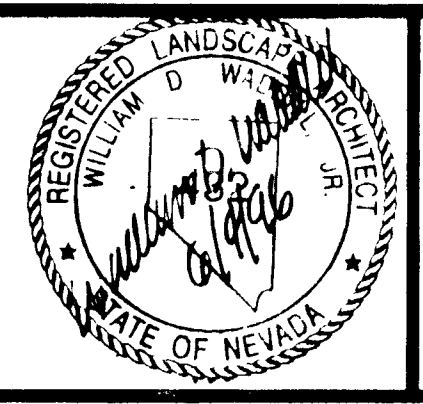

Kimley-Horn and Associates, Inc.
Las Vegas, Nevada © 1996

DESIGNED BY URG
DRAWN BY DD/WSW/PBH
CHECKED BY BW
NOTE BOOK NO.



DOWNTOWN CORRIDOR IMPROVEMENTS
CITY OF LAS VEGAS DEPT. OF PUBLIC WORKS
LAS VEGAS, NEVADA
CONTRACT 4 - 4TH STREET
CHARLESTON BLVD. TO COLORADO AVE.

DATE: 6/96
SCALE: 1"=20'

DEMOLITION LAYOUT PLAN
STA. 45+20 TO STA. 51+25

DWG. NO. 107-V-2288C
FILE NO. 9903.02
DM-3
SHEET 5 OF 22

