

HARDSCAPE SURFACE TREATMENTS

- HARDSCAPE DESCRIPTION**
- 1] NATURAL GREY CONCRETE WITH LIGHT BROOM FINISH AND TOOLED JOINTS AS SHOWN.
 - 2] INTEGRALLY COLORED (MESA BEIGE), TOOLED, AND TROUELED CONCRETE WITH A LIGHT BROOM FINISH. REF. 1, 2, AND 3/D-2.
 - 3] INTEGRALLY COLORED (TAWNY PINK), PRE-CAST 12' x 12' CONCRETE PAVERS ON A CONCRETE SUB-BASE. REF. 1/D-5.
 - 4] NOT USED IN THIS CONTRACT
 - 5] DRY-SHAKE COLORED HARDENER (WALNUT) CONCRETE SIDEWALK RAMP. REF. 1/D-5.
 - 6] INTEGRALLY COLORED (TAWNY PINK) PRECAST 12' x 12' CONCRETE PAVERS ON A CONCRETE SUB-BASE. REF. 4 AND 5/D-2.
 - 7] TIE INTO EXISTING PAVING (SIDEWALK, BUILDING ACCESS, ETC.)

MATCHLINE
SEE SHEET HS-2

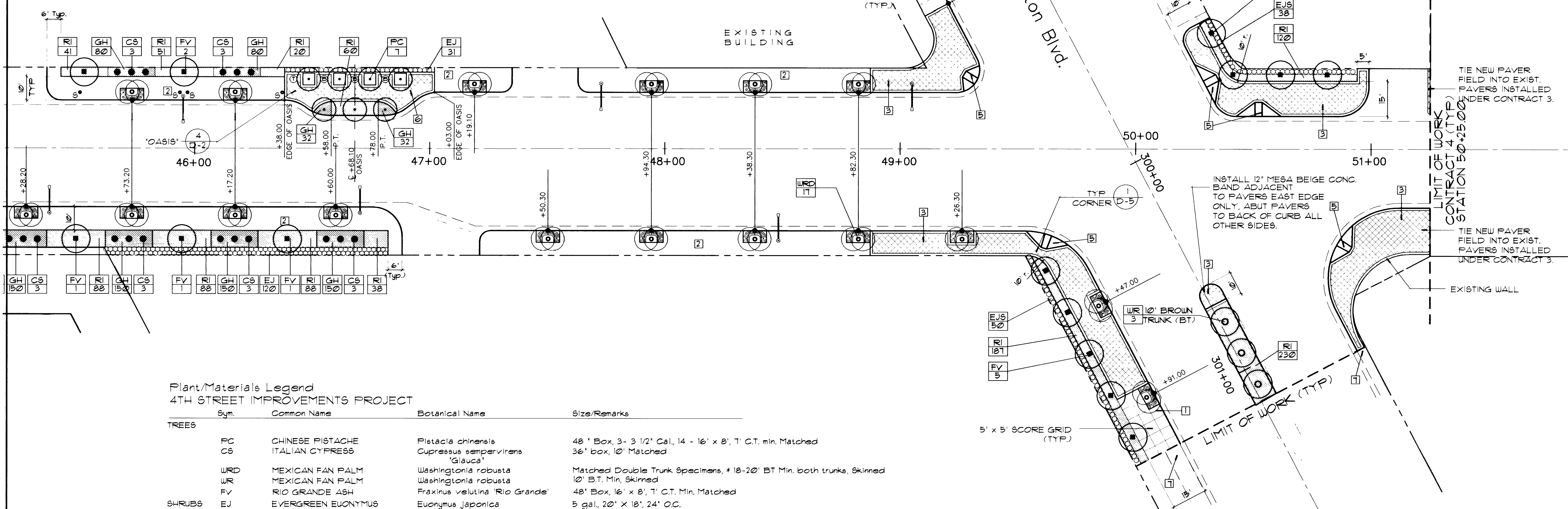

Plant/Materials Legend
4TH STREET IMPROVEMENTS PROJECT

Sym.	Common Name	Botanical Name	Size/Remarks
TREES			
PC	CHINESE PISTACHE	<i>Pistacia chinensis</i>	48' Box, 3- 3 1/2' Cal., 14 - 16' x 8', 1' C.T. min. Matched
CS	ITALIAN CYPRESS	<i>Cupressus sempervirens</i> 'Glauca'	36' box, 10' Matched
URD	MEXICAN FAN PALM	<i>Washingtonia robusta</i>	Matched Double Trunk Specimens, * 18-20' BT Min. both trunks, Skinned
UR	MEXICAN FAN PALM	<i>Washingtonia robusta</i>	10' B.T. Min, Skinned
FV	RIO GRANDE ASH	<i>Fraxinus velutina</i> 'Rio Grande'	48' Box, 16' x 8', 1' C.T. Min. Matched
SHRUBS			
EJ	EVERGREEN EUONYMUS	<i>Euonymus japonica</i>	5 gal., 20' x 18', 24' O.C.
EJ 6	VARIEGATED EUONYMUS	<i>Euonymus japonica</i> 'Silver King'	5 gal., 20' x 18', 24' O.C.
GH	CLUMPING GAZANIA	<i>Gazania Hybrida</i> 'Mini-Star'	1 gal., Full, 12' O.C.
DAISY			
HF	RED YUCCA	<i>Hesperaloe parviflora</i>	5 gal., 3' x 3', 36' O.C.
TC	'REGAL MIST' DEER GRASS	<i>Muhlenbergia capillaris</i>	5 gal., 20' x 18', 36' O.C.
RI	DWARF INDIAN HAWTHORN	<i>Raphiolepis indica</i> 'Enchantress'	5 gal., 15' x 15', 18' O.C.
MISC.			
RI	RIVER ROCK MULCH		REF. SPECS
RI	PRE-CAST CONCRETE BENCHES		REF. SPECS
RI	PRE-CAST CONCRETE TRASH CANS		REF. SPECS
RI	PARKING METER (SINGLE HEAD)		REF. SPECS
RI	PARKING METER (DOUBLE HEAD)		REF. SPECS
RI	PLANT ABBREVIATION (Typ.)		REF. SPECS
RI	PLANT QUANTITY (Typ.)		REF. SPECS
RI	5' x 10' TREE GRATE (REF. DETAIL 3/D-3)		
RI	5' x 5' TREE GRATE (REF. DETAIL 1/D-3)		

* Note: Two single-trunk specimens can be substituted for this item.

Avoid cutting underground utility lines. It's costly.
Call before you Dig.
1-800-227-2600
UNDERGROUND SERVICE ALERT (USA)

NO.	REVISIONS	DATE	BY

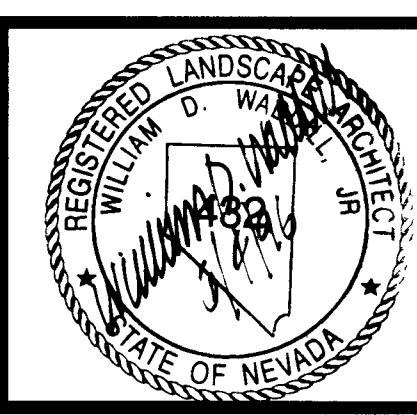

Kimley-Horn and Associates, Inc.
Las Vegas, Nevada © 1996

DESIGNED BY URG
DRAWN BY DD/WSW
CHECKED BY BW
NOTE BOOK NO.



DOWNTOWN CORRIDOR IMPROVEMENTS
CITY OF LAS VEGAS DEPT. OF PUBLIC WORKS
LAS VEGAS, NEVADA
CONTRACT 4 - 4TH STREET
CHARLESTON BLVD. TO COLORADO AVE.

DATE: 6/96
SCALE: 1"=20'

HARDSCAPE LAYOUT
PLAN (WITH LANDSCAPE)
STA.45+20 TO STA.51+25

DWG. NO. 107-V-2288C
FILE NO. 9903.02
HS-3
SHEET 8 OF 22

