

REV	DATE	BY	REVISION
1	4.17.07	ESL	REVISED PER COMMENTS
2	4.19.07	ESL	REVISED PER COMMENTS
3	5.22.07	ESL	REVISED PER COMMENTS
4	5.28.07	ESL	REVISED PER COMMENTS
5	6.1.07	ESL	REVISED PER COMMENTS
6	6.15.07	ESL	REVISED PER COMMENTS
7	7.11.07	ESL	REVISED PER COMMENTS
8	7.24.07	ESL	REVISED PER COMMENTS
9	8.1.07	ESL	REVISED PER COMMENTS

ESI ENGINEERS & SURVEYORS INC.
 701 W. GARDEN ROAD SUITE 200, WEST SAHARA, NV 89134
 (702) 505-1100
 SUBMITTED BY: *Paul E. Johnston* 4/24/07

CURVE DATA TABLE

NO.	Δ	R	L	T
①	20° 24' 03"	20.00	46.29	29.17

- LEGEND**
- 250 WATT H.P.S.
 - LIGHT STANDARD, GREEN CONC. POLE
 - 1 1/4" CONDUIT
 - △ 2" METER & SERVICE
 - △ 8" GATEVALVE
 - △ 2" BLOWOFF

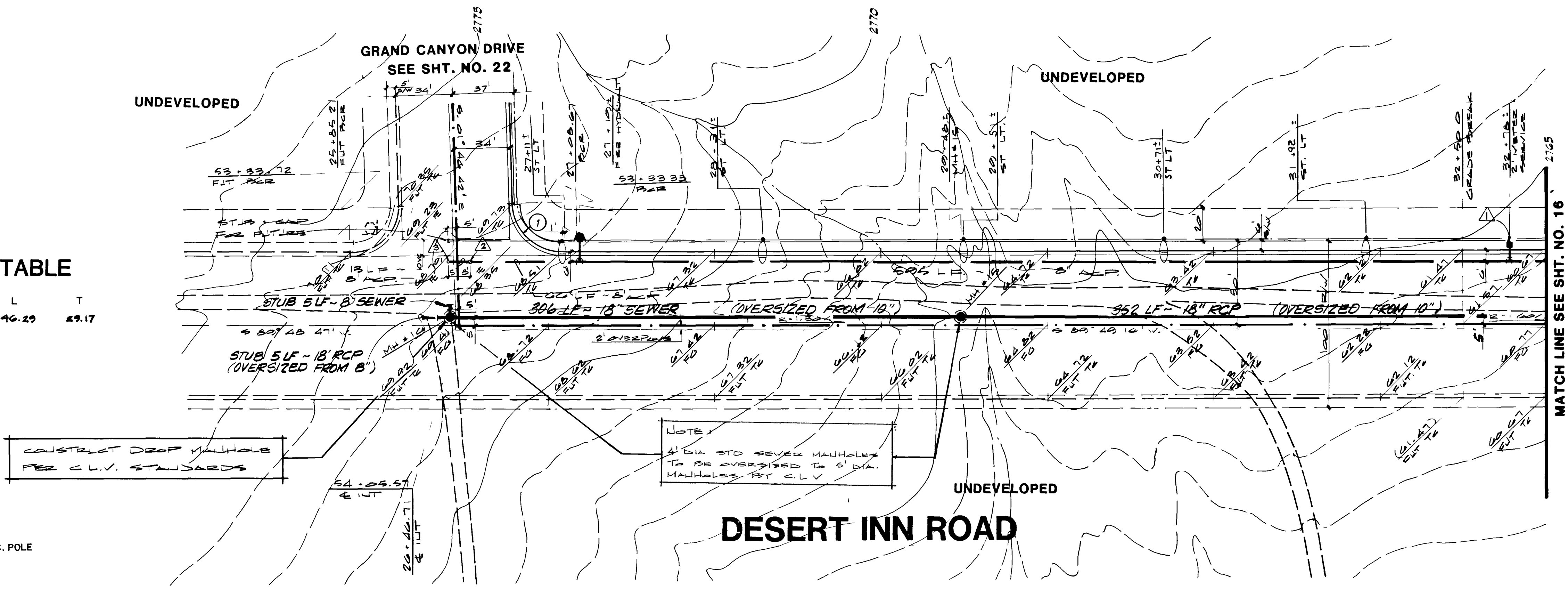

TITLE
STREET & SEWER PLAN & PROFILE
(DESERT INN ROAD STA. 26+46.71 TO 33+00)

PROJECT
E.1/2, SEC. 7 THE LAKES AT WEST SAHARA
PHASE 2

WO NO	2010
BY	ESL
DATE	4/07
SCALE	1" = 40'

SHEET
17
OF 22 SHEETS

Sub 1
CLV CHIEF LAND DEVELOPMENT DATE

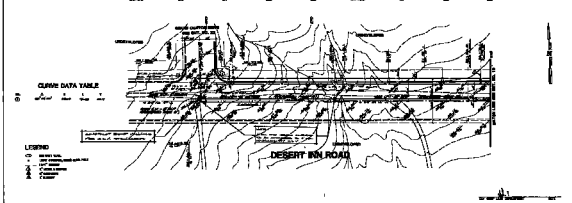
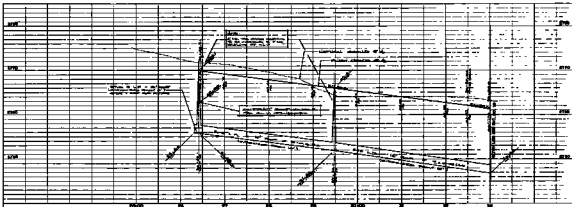

CURVE DATA TABLE

Station	Grade	Curve	Length
2500	1.5%	1	100
2600	1.5%	2	100
2700	1.5%	3	100
2800	1.5%	4	100
2900	1.5%	5	100
3000	1.5%	6	100

LEGEND

- 1. 100' STATION
- 2. 100' STATION
- 3. 100' STATION
- 4. 100' STATION
- 5. 100' STATION
- 6. 100' STATION

DESIGNER: [Name]

CHECKED: [Name]

DATE: [Date]

PROJECT: [Project Name]

SCALE: [Scale]

STREET & SEWER PLAN & PROFILE
 EXHIBIT NO. 10, 11, 12, 13, 14, 15, 16, 17, 18, 19, 20, 21, 22, 23, 24, 25, 26, 27, 28, 29, 30, 31, 32, 33, 34, 35, 36, 37, 38, 39, 40, 41, 42, 43, 44, 45, 46, 47, 48, 49, 50, 51, 52, 53, 54, 55, 56, 57, 58, 59, 60, 61, 62, 63, 64, 65, 66, 67, 68, 69, 70, 71, 72, 73, 74, 75, 76, 77, 78, 79, 80, 81, 82, 83, 84, 85, 86, 87, 88, 89, 90, 91, 92, 93, 94, 95, 96, 97, 98, 99, 100

EJ/2, SEC. 7, THE LARGES AT WEST SAMARA

17