

2785	2785
2775	2775
2765	2765
2755	2755

DATE	4-1-87
BY	ES
REV	1
REV	2

DATE	2-13-87
BY	[Signature]
REV	1

ESI ENGINEERS & SURVEYORS INC.
 7201 W. WILLOW AVE., SUITE 100, DENVER, COLORADO 80235
 PHONE: 303-751-1111
 FAX: 303-751-1112

SUBMITTED BY: [Signature]
 DATE: 2-13-87

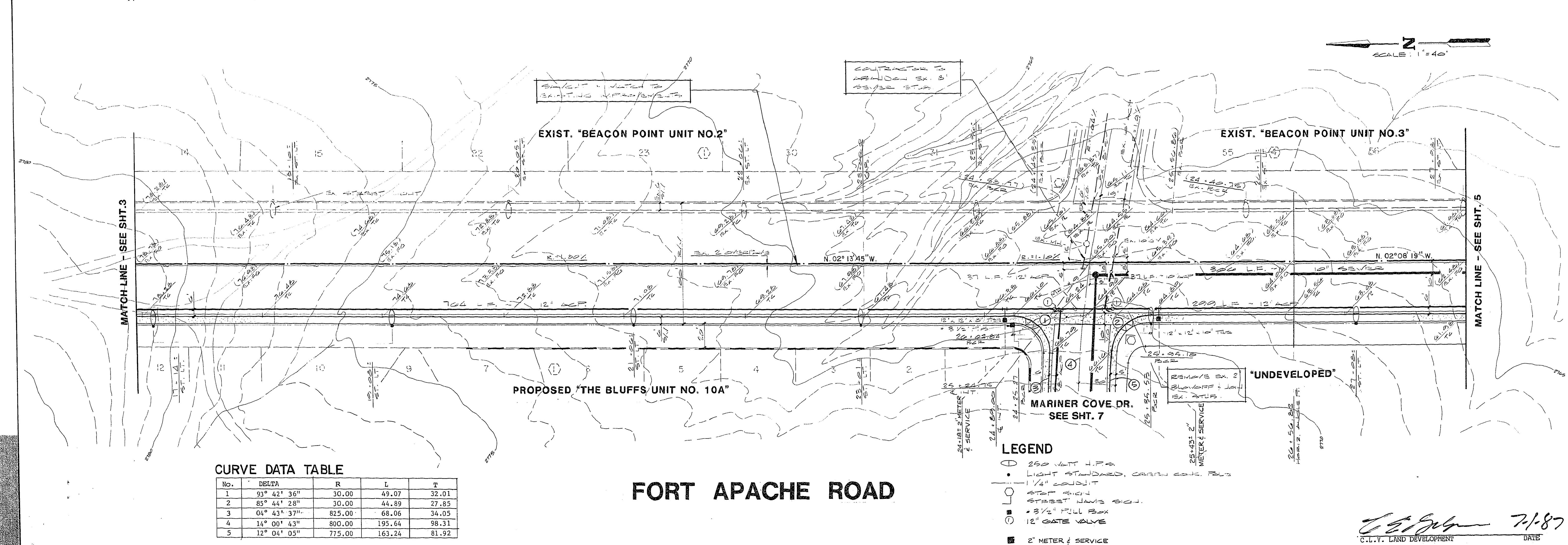

CURVE DATA TABLE

No.	DELTA	R	L	T
1	93° 42' 36"	30.00	49.07	32.01
2	85° 44' 28"	30.00	44.89	27.85
3	06° 43' 37"	825.00	68.06	34.05
4	14° 00' 43"	800.00	195.64	98.31
5	12° 04' 03"	775.00	163.24	81.92

FORT APACHE ROAD

- LEGEND**
- 250 VOLT L.P.S.
 - LIGHT STANDARD, CROWN SIDE, 10' H.
 - 1/4" CONDUIT
 - STOP SIGN
 - STREET NAME SIGN
 - 3/4" FILL BOX
 - 12" GATE VALVE
 - 2' METER & SERVICE

[Signature] 7-1-87
 C.L.V. LAND DEVELOPMENT DATE

TITLE: STREET & SEWER PLAN & PROFILE
 (FORT APACHE RD. STA. 17+00 TO 28+00)

PROJECT: E. 1/2, SEC. 7 THE LAKES AT WEST SAHARA
 PHASE 1

WO NO. 5018
 BY B.G./P.C.
 DATE 1/87
 SCALE HORIZ. 1"=40'
 SCALE VERT. 1"=4'

SHEET: 4
 OF 11 SHEETS

107Y-1933-1(E 1/2 Sec. 7)