

ITEM NO.	DESCRIPTION	CL.V.	R.S.H.	L.V.V.W.D.	TOTAL	UNIT
163.000	3/4" WATER SERVICE AND PLUG	1			826	EA.
333.100	Bituminous Prime Coat		69		69	Gal.
333.100	Bituminous Fog Seal		183		183	Gal.
121.215C	15" R.C.P. Class III		395		395	L.F.
121.218C	18" R.C.P. Class III		105		105	L.F.
121.224C	24" R.C.P. Class III		12		12	L.F.
200.110	Concrete Removal		19		19	EA.
200.300	Remove Tree (Cover 10in.)		1050		1050	C.Y.
200.400	Remove Tree (Cover 10in.)		413		413	Gal.
201.100	Excavation		376		376	C.Y.
334.200	55-lb Emulsified Asphalt		4893		4893	S.Y.
333.500	Type II Gravel Base		2885		2885	TONS
334.119	1/2" Open Graded Plant-Mix		10		10	TONS
334.119	9 1/2" Asphalt Concrete Pavement		936		936	L.F.
334.509	1 1/2" Asphalt Concrete Pavement		184		184	L.F.
340.014	* L* Type Curb And Gutter (C&G)		5304		5304	S.F.
340.037	Concrete Tack-On Curb (7m Base)		1962		1962	S.F.
340.114	Concrete Sidewalk		1889		1889	S.F.
340.146	6 Inch Island Concrete					
340.216	Residential Driveway					
341.004	2" Asphalt Concrete Pavement		54		54	TONS
500.200	Drop Inlet		3		3	EA.
512.500	Adjust Manhole		2		2	EA.
512.600	Storm Drain Manhole		20		20	EA.
512.700	Relocate Fire Hydrant					
512.800	Relocate Fire Hydrant					
512.910	Island Asphalt Coloring		114		114	S.Y.

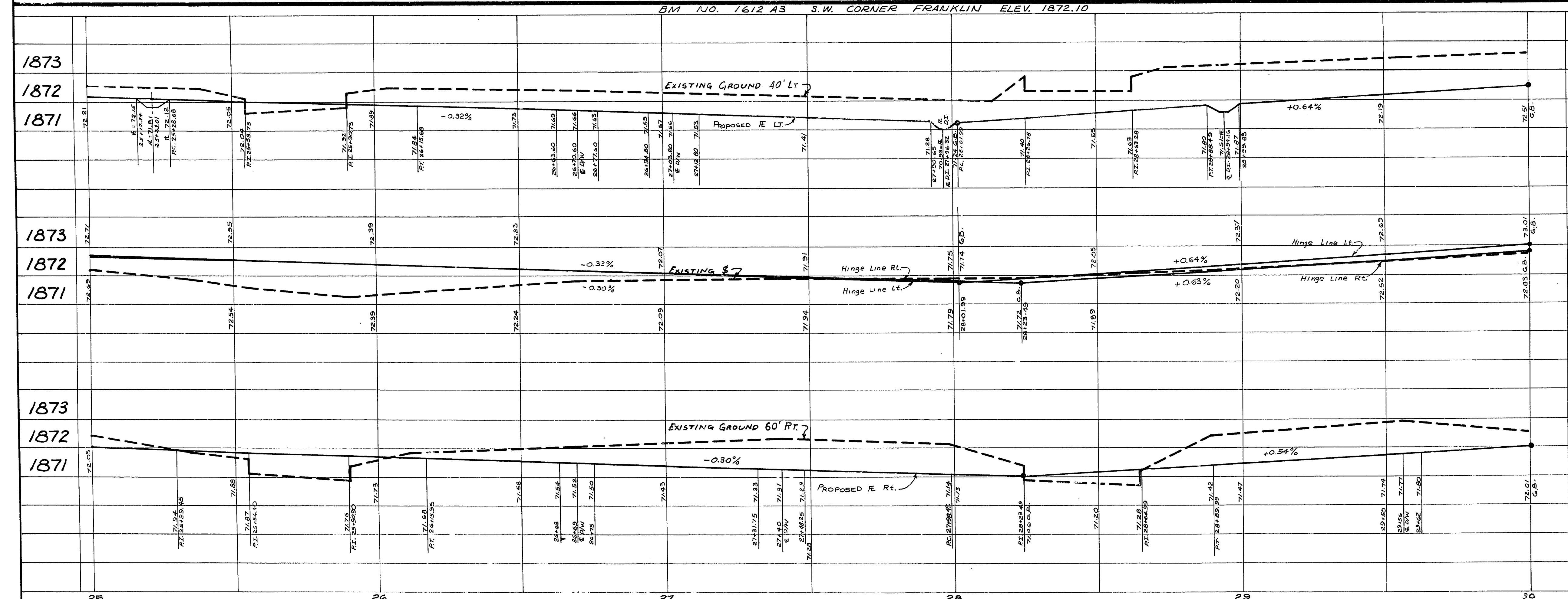

NO.	DELTA	RADIUS	LENGTH	TANGENT	LOC.
1	180° 00' 00"	2.00'	6.28'		BC
13	10° 53' 15"	250.00'	47.51'	23.82'	BC
75	89° 53' 30"	25.00'	39.22'	24.95'	BC
76	89° 53' 30"	20.00'	31.38'	19.96'	BSW
77	89° 53' 30"	20.00'	31.38'	19.96'	RW
78	90° 06' 30"	25.00'	39.32'	25.05'	BC
79	90° 06' 30"	20.00'	31.45'	20.04'	BSW
80	90° 06' 30"	20.00'	31.45'	20.04'	RW
81	90° 00' 00"	25.00'	39.27'	25.00'	BC
82	90° 00' 00"	20.00'	31.42'	20.00'	BSW
83	90° 00' 00"	20.00'	31.42'	20.00'	RW
84	90° 00' 00"	25.00'	39.27'	25.00'	BC
85	90° 00' 00"	20.00'	31.42'	20.00'	BSW
86	90° 00' 00"	20.00'	31.42'	20.00'	RW
87	90° 07' 00"	25.00'	39.32'	25.05'	BC
88	90° 07' 00"	20.00'	31.46'	20.04'	BSW
89	90° 07' 00"	20.00'	31.46'	20.04'	RW
90	89° 53' 00"	25.00'	39.22'	24.95'	BC
91	89° 53' 00"	20.00'	31.38'	19.96'	BSW
92	89° 53' 00"	20.00'	31.38'	19.96'	RW
93	89° 30' 45"	25.00'	39.06'	24.79'	BC
94	89° 30' 45"	20.00'	31.25'	19.83'	BSW
95	89° 30' 45"	20.00'	31.25'	19.83'	RW
96	90° 23' 15"	25.00'	39.48'	25.21'	BC
97	90° 23' 15"	20.00'	31.59'	20.17'	BSW
98	90° 23' 15"	20.00'	31.59'	20.17'	RW

REVISIONS

NO.	DESCRIPTION	BY	DATE	APPROVAL

CITY OF LAS VEGAS NEVADA
DEPARTMENT OF PUBLIC WORKS
SERVICES DIVISION

EASTERN AVENUE
SAHARA AVE. TO CHARLESTON BLVD.

W.O. NO. 7672 F.B.K. NO. 68-4X DATE 11-6-72 DRAWING NO. 107-V835A
DES. G. BILLINGSLEY SC. (H) 1"=20' SC. (V) 1"=2'
DR. CALCOMA & D.R. EPB FILE NO.
APPROVED BY DIRECTOR OF PUBLIC WORKS

SHEET 12 OF 30