

Item No.	Description	CLY	RS.H.	total Unit
121.815C	15" R.C.P. Class III	153	153	L.F.
121.818C	18" R.C.P. Class III	500	500	L.F.
200.110	Concrete Removal	10	10	L.S.
200.300	Remove Tree (4in.-10in.)	12	12	E.A.
200.400	Remove Tree Cover (10in.)	498	498	C.Y.
201.100	Excavation			C.Y.
302.200	Type II Gravel Base	312	312	C.Y.
303.500	1/2" Open Graded Plant-Mix	4690	4690	TONS
304.119	5 1/2" Asphalt concrete Pavement	2785	2785	TONS
340.014	"L" Type Curb And Gutter (24")	802	802	L.F.
340.114	Concrete Sidewalk	4670	4670	S.F.
340.116	6 Inch Island Concrete	2512	2512	S.F.
340.216	Residential Driveway	2296	2296	S.F.
343.200	58-lb Emulsified Asphalt	395	395	GAL.
344.004	2" A.C.	27	27	TONS
500.200	Drop Inlet	4	4	E.A.
512.500	Adjust Manhole	3	3	E.A.
512.600	Storm Drain Manhole	18	18	V.F.
560.200	Relocate Fire Hydrant	2	2	E.A.
334.800	Bituminous Prime Coat	777	777	GAL.
333.100	Bituminous Top Seal	34	34	GAL.
340.256	COMMERCIAL DRIVEWAY	557	557	S.F.

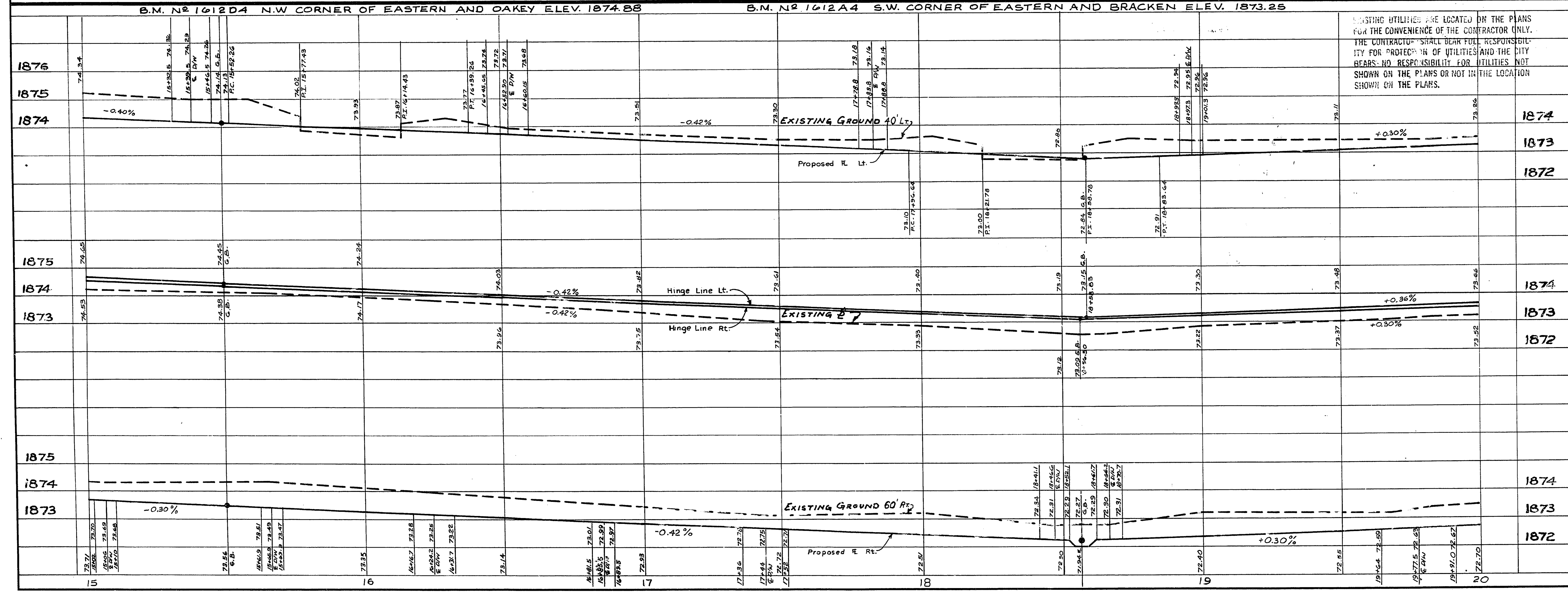

No.	Delta	radius	length	tangent	
1	180°00'00"	2.00'	6.28'	00	b.c.
13	10°53'15"	250.00'	47.51'	23.82'	b.c.
13E	02°04'45"	250.00'	9.07'	4.54'	b.c.
45	90°23'53"	20.00'	31.55'	20.14'	R/W
46	90°23'53"	20.00'	31.55'	20.14'	b/s/w
47	90°23'53"	25.00'	39.44'	25.17'	b.c.
48	89°36'07"	20.00'	31.28'	19.86'	R/W
49	89°36'07"	20.00'	31.28'	19.86'	b/s/w
50	89°36'07"	25.00'	39.10'	24.83'	b.c.
51	90°19'37"	20.00'	31.53'	20.11'	R/W
52	90°19'37"	20.00'	31.53'	20.11'	b/s/w
53	90°19'37"	25.00'	39.41'	25.14'	b.c.
54	89°40'23"	20.00'	31.30'	19.88'	R/W
55	89°40'23"	20.00'	31.30'	19.88'	b/s/w
56	89°40'23"	25.00'	39.13'	24.86'	b.c.

CITY OF LAS VEGAS NEVADA  
 DEPARTMENT OF PUBLIC WORKS  
 SERVICES DIVISION

**EASTERN AVENUE**  
**SAHARA AVE. TO CHARLESTON BLVD.**

W.O. NO. 7672    F.B.K. NO. 68-4X    DATE: 10-27-72    DRAWING NO. 107-V835A  
 SC. (H) 1"=20'    SC. (V) 1"=2'

DESIGNED BY: [Signature]    CHECKED BY: [Signature]    APPROVED BY: [Signature]

SHEET 10 OF 30