

**LEGAL DESCRIPTION**

BEING LOT 3 OF PARCEL MAPS F16, P42, PORTION OF THE SW 1/4, OF THE NW 1/4, OF THE SW 1/4, OF SEC 1, T21S, R60E, MDM, CLARK COUNTY NEVADA. APN 163-01-304-003

**BENCHMARK**

BASIS OF BEARING CCBM #7C1015W66 BEING A RIVET AND SQUARE ALUMINUM PLATE IN TOP OF CURB; NE CORNER OF JONES BLVD AND OBANNON DR. NEAR THE PC OF JONES BLVD. ELEVATION 698.377 (2291.26) NAVD 88

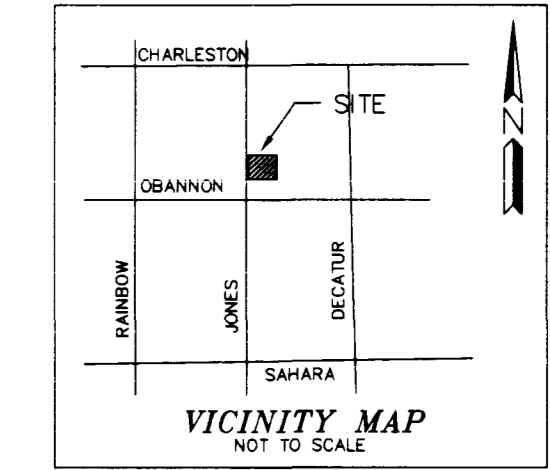

**BASIS OF BEARING**

N 02°07'36"W BEING THE WEST LINE OF THE SOUTHWEST QUARTER OF SECTION 1, T21S, R60E, MDM, CLARK COUNTY, NEVADA, PER RECORD OF SURVEY F54, P39, CLARK COUNTY RECORDERS OFFICE, CLARK COUNTY, NEVADA. ALSO KNOWN AS CENTERLINE JONES BLVD.

**LEGEND AND ABBREVIATIONS**

EG		EDGE OF GRAVEL ROAD
EP		EDGE OF PAVEMENT
EXIST		EXISTING
FG		FINISH GRADE
FF		FINISH FLOOR
FL		FLOW LINE
		DIRECTION OF FLOW
		EXIST CONTOURS
		PROPOSED CONTOURS
		EXISTING GRADE
		GRADE BREAK
		SET BACK LINE
		PROPOSED GRADE
		TOP OF CURB
		TOP OF SIDEWALK
		RADIUS
(XX.XX)		
GB		
SBL		
XX.XX		
TC		
T, SW		
R		

**DEVIATIONS FROM STANDARDS**

NONE

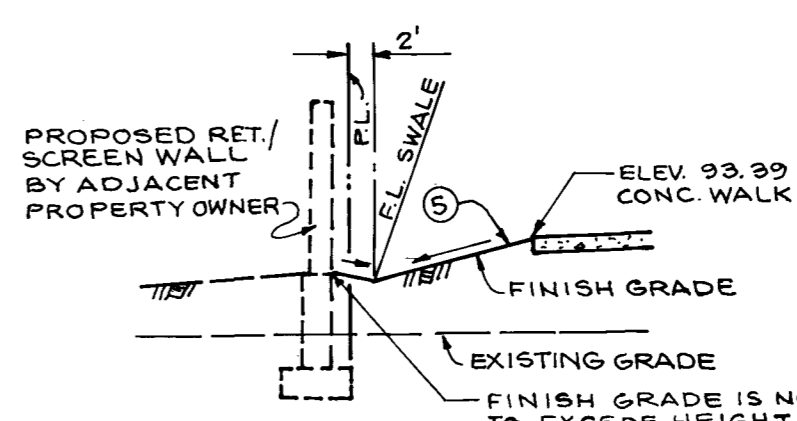

SECTION A N.T.S.

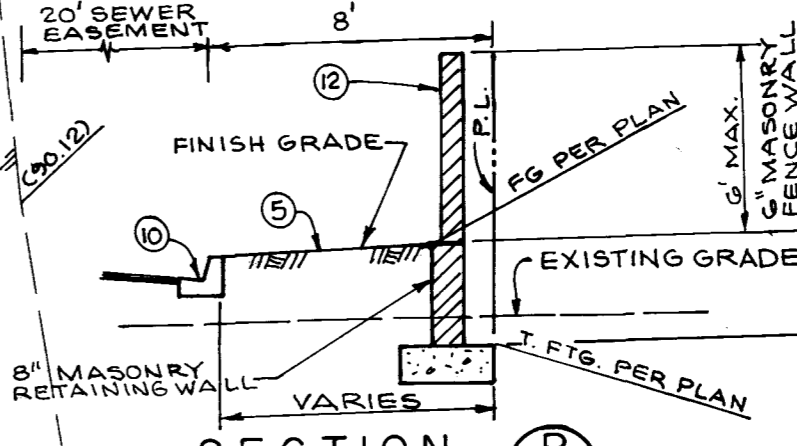

SECTION B N.T.S.

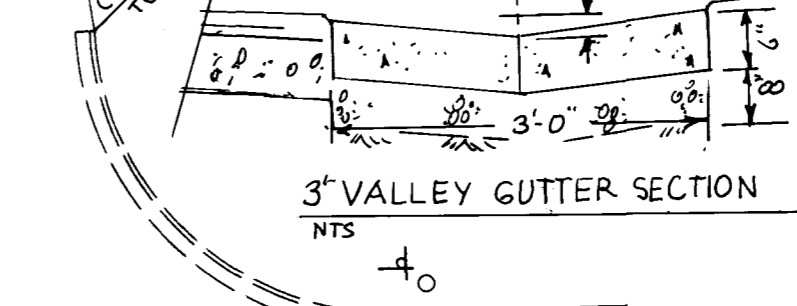

SECTION G N.T.S.

**NDOT NOTE**

JONES BLVD. IS A NEVADA DEPARTMENT OF TRANSPORTATION MAINTAINED ROAD FROM BACK OF CURB. THE CITY OF LAS VEGAS DOES NOT REVIEW THESE PLANS FOR CONFORMANCE WITH NDOT STANDARDS. A SEPARATE REVIEW APPROVAL AND ENCROACHMENT PERMIT MUST BE OBTAINED FROM NDOT PRIOR TO CONSTRUCTION.

**CONSTRUCTION NOTES**

- 6" SIDEWALK, C.C.A. STD. DWG. NO. 234
- CROSS GUTTER, C.C.A. STD. DWG. NO. 228
- CURB RAMP, N.D.O.T. STD. DWG. NO. R.B.1.1.2 (613) TYPE D, SEE BACK OF CURB DATA FOR A & B
- "A" TYPE CURB, C.C.A. STD. DWG. NO. 219
- LANDSCAPE AREA MINIMUM ELEVATION SHOWN
- PARKING STRIPING PER ARCH. DWG. DETAILS
- HANDICAP STRIPING PER ARCH. DWG. DETAILS
- TRASH ENCLOSURE PER ARCH. DWG. DETAILS
- "C" CURB FACE, SEE ARCH. DWG. FOR DETAILS
- "L" TYPE CURB, C.C.A. STD. DWG. NO. 216
- 2" MIN. A.C. PAVEMENT, AGGREGATE BASE AND BACKFILL PER SOIL REPORT.
- STANDARD RETAINING WALL AND 6" HIGH MASONRY FENCE WALL PER C.L.V. STD. DWG. CLV-102, RET. WALL "H" = 4'-0" MAX.
- SIDEWALK RAMP, C.C.A. STD. DWG. NO. 235, CASE 1, A & B = 8'
- INSTALL C.L.V. SURVEY MONUMENT PER C.C.A. STD. DWG. NO. 239.
- BUS PASSENGER LOADING AND SHELTER PAD PER UNIFORM STD. DWG. NO. 234.2 (6'W x 25'L)

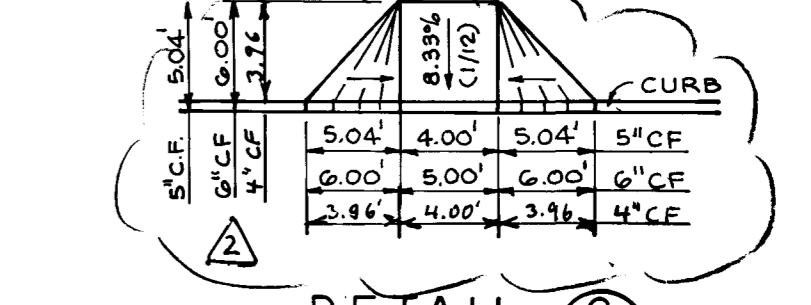

DETAIL C N.T.S.

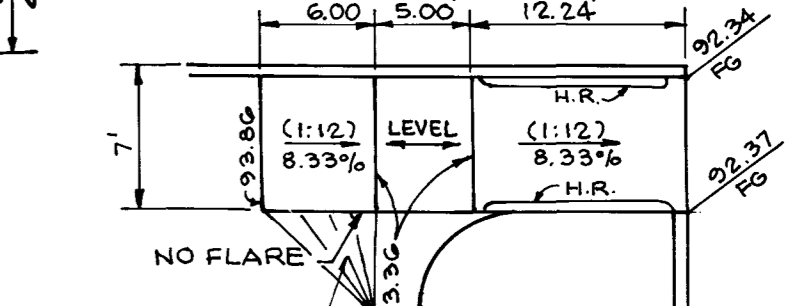

DETAIL D N.T.S.



DETAIL E N.T.S.

**SIGHT VISIBILITY RESTRICTION EASEMENT**

ON SIGHT DISTANCE TRIANGLES, NO VIEW OBSTRUCTION OVER 30" ABOVE TOP OF CURB ALLOWED IN THE DOTTED AREA.

Avoid cutting underground utility lines. It's costly.  
**Call Before You Dig**  
1-800-227-2600

**SAFETY ALERT**  
Call Before You Overhead  
1-702-593-6111

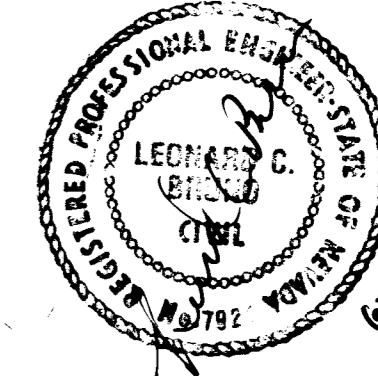

LB Engineering  
LEONARD BRUNO  
940 S. MARTIN L. KING  
LAS VEGAS NV. 89106  
(702) 382-7559

REV	BY	DATE	DESCRIPTION
1	LB	11/10/18	RELOCATE HANDICAP MARKS
2	LB	11/10/18	28" PRIVATE DRAINAGE EASEMENT

Drawn by AB  
Check by  
Date  
Scale 1"=20'

SITE PLAN  
GRADING PLAN

DRAWING NO.  
107V-2876

SHEET C2  
OF 2 OF 3

107-V-2876

03-19

10800 10885 11388

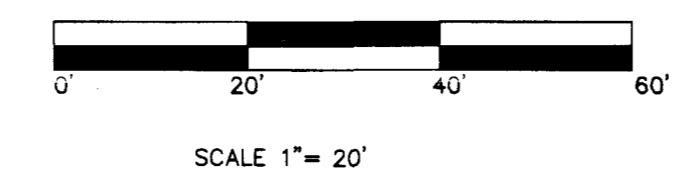

SCALE 1" = 20'

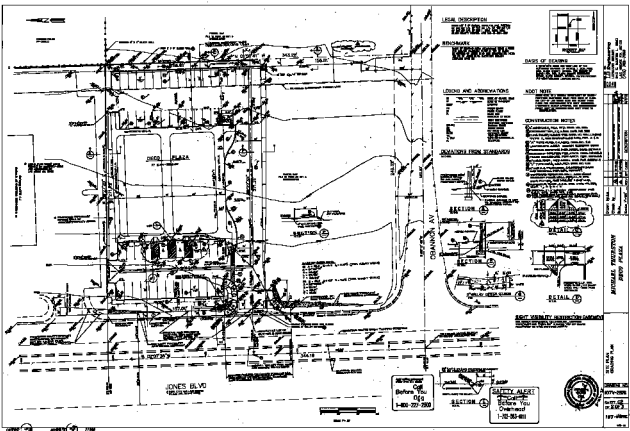

LEGAL DESCRIPTION

**LEGAL DESCRIPTION**

BENCHMARK

**BENCHMARK**

LEGEND AND ABBREVIATIONS

- 1. ...
- 2. ...
- 3. ...
- 4. ...
- 5. ...
- 6. ...
- 7. ...
- 8. ...
- 9. ...
- 10. ...
- 11. ...
- 12. ...
- 13. ...
- 14. ...
- 15. ...
- 16. ...
- 17. ...
- 18. ...
- 19. ...
- 20. ...
- 21. ...
- 22. ...
- 23. ...
- 24. ...
- 25. ...
- 26. ...
- 27. ...
- 28. ...
- 29. ...
- 30. ...
- 31. ...
- 32. ...
- 33. ...
- 34. ...
- 35. ...
- 36. ...
- 37. ...
- 38. ...
- 39. ...
- 40. ...
- 41. ...
- 42. ...
- 43. ...
- 44. ...
- 45. ...
- 46. ...
- 47. ...
- 48. ...
- 49. ...
- 50. ...
- 51. ...
- 52. ...
- 53. ...
- 54. ...
- 55. ...
- 56. ...
- 57. ...
- 58. ...
- 59. ...
- 60. ...
- 61. ...
- 62. ...
- 63. ...
- 64. ...
- 65. ...
- 66. ...
- 67. ...
- 68. ...
- 69. ...
- 70. ...
- 71. ...
- 72. ...
- 73. ...
- 74. ...
- 75. ...
- 76. ...
- 77. ...
- 78. ...
- 79. ...
- 80. ...
- 81. ...
- 82. ...
- 83. ...
- 84. ...
- 85. ...
- 86. ...
- 87. ...
- 88. ...
- 89. ...
- 90. ...
- 91. ...
- 92. ...
- 93. ...
- 94. ...
- 95. ...
- 96. ...
- 97. ...
- 98. ...
- 99. ...
- 100. ...

CONTRACTOR NOTES

NOTICE

CONTRACTOR NOTES

1. ...

2. ...

3. ...

4. ...

5. ...

6. ...

7. ...

8. ...

9. ...

10. ...

11. ...

12. ...

13. ...

14. ...

15. ...

16. ...

17. ...

18. ...

19. ...

20. ...

21. ...

22. ...

23. ...

24. ...

25. ...

26. ...

27. ...

28. ...

29. ...

30. ...

31. ...

32. ...

33. ...

34. ...

35. ...

36. ...

37. ...

38. ...

39. ...

40. ...

41. ...

42. ...

43. ...

44. ...

45. ...

46. ...

47. ...

48. ...

49. ...

50. ...

51. ...

52. ...

53. ...

54. ...

55. ...

56. ...

57. ...

58. ...

59. ...

60. ...

61. ...

62. ...

63. ...

64. ...

65. ...

66. ...

67. ...

68. ...

69. ...

70. ...

71. ...

72. ...

73. ...

74. ...

75. ...

76. ...

77. ...

78. ...

79. ...

80. ...

81. ...

82. ...

83. ...

84. ...

85. ...

86. ...

87. ...

88. ...

89. ...

90. ...

91. ...

92. ...

93. ...

94. ...

95. ...

96. ...

97. ...

98. ...

99. ...

100. ...

SECTION 1



SECTION 2



SECTION 3



NOTICE

1. ...

2. ...

3. ...

4. ...

5. ...

6. ...

7. ...

8. ...

9. ...

10. ...

11. ...

12. ...

13. ...

14. ...

15. ...

16. ...

17. ...

18. ...

19. ...

20. ...

21. ...

22. ...

23. ...

24. ...

25. ...

26. ...

27. ...

28. ...

29. ...

30. ...

31. ...

32. ...

33. ...

34. ...

35. ...

36. ...

37. ...

38. ...

39. ...

40. ...

41. ...

42. ...

43. ...

44. ...

45. ...

46. ...

47. ...

48. ...

49. ...

50. ...

51. ...

52. ...

53. ...

54. ...

55. ...

56. ...

57. ...

58. ...

59. ...

60. ...

61. ...

62. ...

63. ...

64. ...

65. ...

66. ...

67. ...

68. ...

69. ...

70. ...

71. ...

72. ...

73. ...

74. ...

75. ...

76. ...

77. ...

78. ...

79. ...

80. ...

81. ...

82. ...

83. ...

84. ...

85. ...

86. ...

87. ...

88. ...

89. ...

90. ...

91. ...

92. ...

93. ...

94. ...

95. ...

96. ...

97. ...

98. ...

99. ...

100. ...

REVIEWER  
Call Before You Dig  
1-800-277-2300

SAFETY ALERT  
Overhead Power Lines  
1-702-93-6111



PROJECT NO. 187-4000

DATE: 10/15/2008

SCALE: AS SHOWN

DESIGNED BY: [Name]

CHECKED BY: [Name]

APPROVED BY: [Name]

DATE: 10/15/2008

PROJECT NO. 187-4000

DATE: 10/15/2008

SCALE: AS SHOWN

DESIGNED BY: [Name]

CHECKED BY: [Name]

APPROVED BY: [Name]

DATE: 10/15/2008