

REVISIONS CONSULTANTS
 a division of
 Programmer
 Design Group, Inc.
 2801 N. Tenaya Way
 Las Vegas,
 Nevada
 89102
 (702) 255-1084

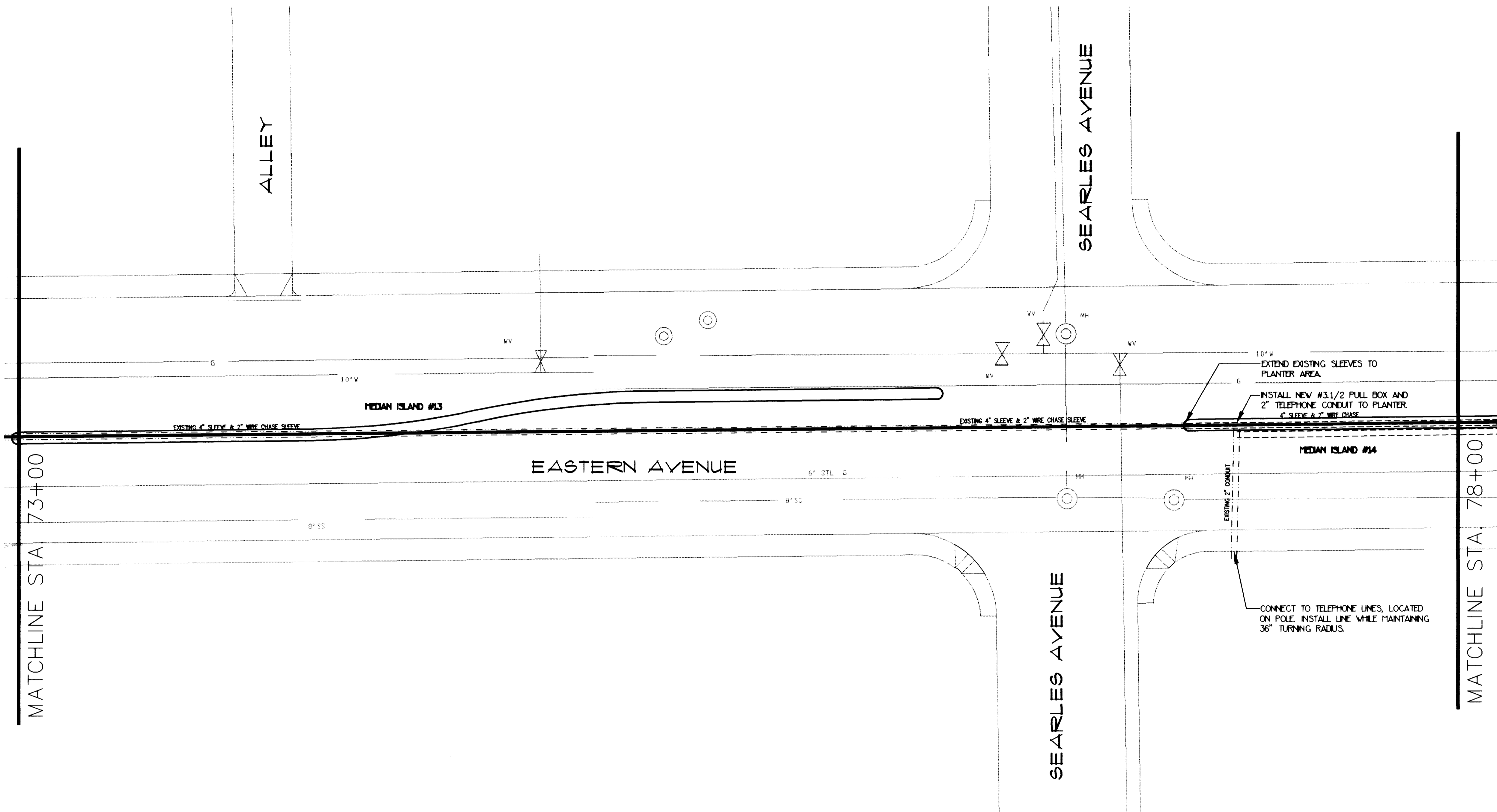

SYMBOL	MANUFACTURER-MODEL NUMBER	PAT.	RD.	PSI	GPM	DRIP GPA	DTL	REMARKS
NOT SHOWN	AGRIFFI THREADED Emitter UF-10, PRESS. COMP. FOR ALL SHRUBS	---	---	30		1.0	F	SEE DETAIL FOR # OF
NOT SHOWN	AGRIFFI THREADED Emitter UF-20, PRESS. COMP. FOR ALL TREES	---	---	30		2.0	F,G,H	EMITTERS PER PLANT
⊙	RAINBIRD CCU-6-SS CLUSTER CONTROL UNIT IN STAINLESS STEEL CABINET (ON RAINBIRD PEDESTAL #PED-ID16)						B	MIN. 5'-0" FROM CURB
⊙	RAINBIRD ESP-24-SAT-TV-SS CONTROLLER, PEDESTAL MOUNT #PED-ID16, WITH MSP1 SURGE PROTECTOR						A	MIN. 5'-0" FROM CURB
⊙	RAINBIRD ESP-12-SAT-TV-SS CONTROLLER, PEDESTAL MOUNT #PED-ID16, WITH MSP1 SURGE PROTECTOR						A	MIN. 5'-0" FROM CURB
⊙	BACKFLOW PREVENTER 1 1/2", REFER TO UDACS PLATE #11A FOR APPROVED MANUFACTURERS AND INSTALLATION							
⊙	METER, 1 1/2" REFER TO UDACS PLATE #12 FOR INSTALLATION							
⊙	FLOW METER (1) DATA INDUSTRIAL MODEL #R220P-1 1/2 FLOW SENSOR (INSTALL PER MFG'S INSTRUCTIONS)						L	
⊙	RAINBIRD 44NF QUICK COUPLING VALVE, PROVIDE TWO MATCHING KEYS AND HOSE SWIVELS						K	
⊙	MASTER VALVE, RAINBIRD 200-PEB ELECTRIC CONTROL VALVE						C	CONNECT TO CONTROLLER
⊙	DRIP VALVE ASSEMBLY: RAINBIRD 100-PEB VALVE, AGRICULTURAL PRODUCTS #E-3/4", 200 MESH SCREEN FILTER AND RAINBIRD PS-30 PRESS. REG.						D	
⊙	DRIP END CAP, AGRICULTURAL PRODUCTS MODEL FCH (BLACK DISK), AUTOMATIC FLUSH VALVE						E	INSTALL AT DRIP LINE END
⊙	MANLINE, PVC SCH. 40 SIZE PER PLAN, 18" MINIMUM COVER						I	
⊙	DRIP LINE HEADER, PVC SCH. 40, 3/4" DIA. WITH 1/2" SALCO #PVCAR-050 FLEXIBLE THICK WALLED PVC TO EMITTERS						F,I	FOR ALL SHRUBS
⊙	DRIP LINE HEADER, PVC SCH. 40, 3/4" DIA. WITH 1/2" SALCO #PVCAR-050 FLEXIBLE THICK WALLED PVC TO EMITTERS						F,I	FOR ALL TREES
⊙	SLEEVES, PVC SCH. 40, SIZE PER PLAN, 18" MINIMUM COVER						J	
⊙	EXISTING SLEEVES, SEE NOTOT CONSTRUCTION PLANS FOR EXACT LOCATIONS							
NOT SHOWN	CONTROL WIRE, UF DIRECT BURIAL, SOLID COPPER, 12 GA. COPPER, 14 GA. PILOT						I	ROUTE WITH MANLINE
NOT SHOWN	PE 34 SIX PAIR FROM ESP-SAT CONTROLLER TO CCU CONTROLLER, 18" MINIMUM COVER						I	ROUTE WITH MANLINE

IRRIGATION LEGEND

- NOTES:
- SEE SHEET L4.01 FOR IRRIGATION DETAILS.
 - LOCATION OF IRRIGATION LINES IS DIAGRAMATIC, AVOID OBSTRUCTIONS. **INSTALL MANLINE ADJACENT TO CURB (TYP.)**
 - INSTALL CONTROL WIRE ADJACENT TO MANLINE WHERE POSSIBLE.

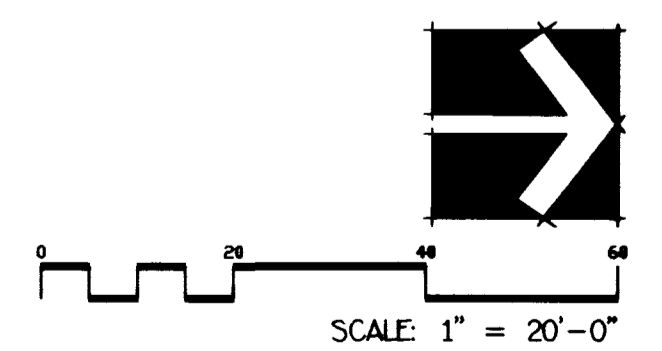

EASTERN AVENUE MEDIANS LANDSCAPING
 STA. 73+00 TO 78+00
 CEDAR AVE TO OWENS AVE
 LAS VEGAS, NEVADA

DATE: 08-19-98
 DRAWN BY: RPS
 CHECKED BY: SWS
 PROJECT NO.: 1003007

SHEET 26 OF 31
L2.11

DWG #107-V2626

08-19-98
 1003007.DWG

10483

