

MATCHLINE SEE DWG T-4

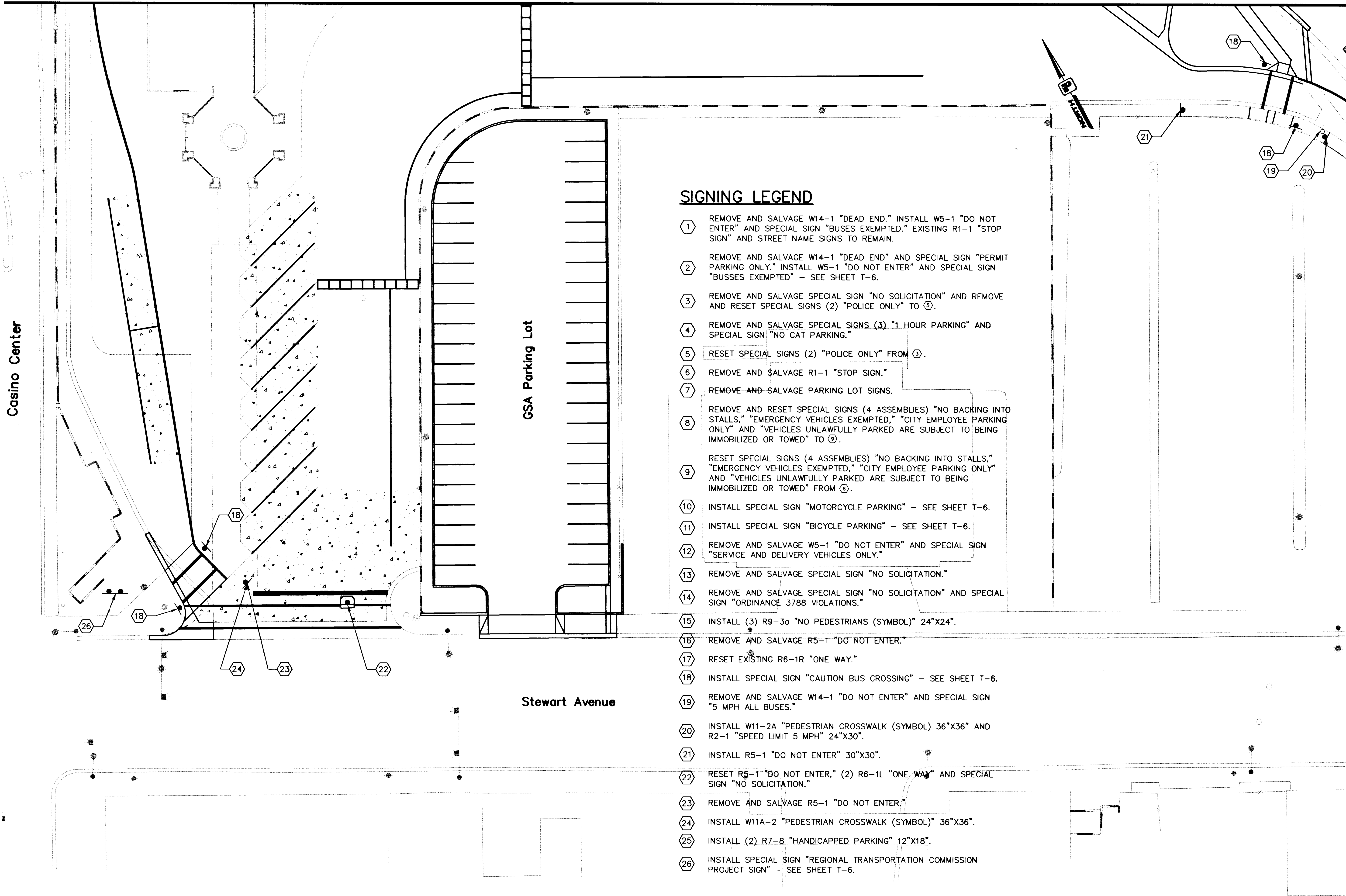

SIGNING LEGEND

- ① REMOVE AND SALVAGE W14-1 "DEAD END." INSTALL W5-1 "DO NOT ENTER" AND SPECIAL SIGN "BUSES EXEMPTED." EXISTING R1-1 "STOP SIGN" AND STREET NAME SIGNS TO REMAIN.
- ② REMOVE AND SALVAGE W14-1 "DEAD END" AND SPECIAL SIGN "PERMIT PARKING ONLY." INSTALL W5-1 "DO NOT ENTER" AND SPECIAL SIGN "BUSES EXEMPTED" - SEE SHEET T-6.
- ③ REMOVE AND SALVAGE SPECIAL SIGN "NO SOLICITATION" AND REMOVE AND RESET SPECIAL SIGNS (2) "POLICE ONLY" TO ⑤.
- ④ REMOVE AND SALVAGE SPECIAL SIGNS (3) "1 HOUR PARKING" AND SPECIAL SIGN "NO CAT PARKING."
- ⑤ RESET SPECIAL SIGNS (2) "POLICE ONLY" FROM ③.
- ⑥ REMOVE AND SALVAGE R1-1 "STOP SIGN."
- ⑦ REMOVE AND SALVAGE PARKING LOT SIGNS.
- ⑧ REMOVE AND RESET SPECIAL SIGNS (4 ASSEMBLIES) "NO BACKING INTO STALLS," "EMERGENCY VEHICLES EXEMPTED," "CITY EMPLOYEE PARKING ONLY" AND "VEHICLES UNLAWFULLY PARKED ARE SUBJECT TO BEING IMMOBILIZED OR TOWED" TO ⑨.
- ⑨ RESET SPECIAL SIGNS (4 ASSEMBLIES) "NO BACKING INTO STALLS," "EMERGENCY VEHICLES EXEMPTED," "CITY EMPLOYEE PARKING ONLY" AND "VEHICLES UNLAWFULLY PARKED ARE SUBJECT TO BEING IMMOBILIZED OR TOWED" FROM ⑧.
- ⑩ INSTALL SPECIAL SIGN "MOTORCYCLE PARKING" - SEE SHEET T-6.
- ⑪ INSTALL SPECIAL SIGN "BICYCLE PARKING" - SEE SHEET T-6.
- ⑫ REMOVE AND SALVAGE W5-1 "DO NOT ENTER" AND SPECIAL SIGN "SERVICE AND DELIVERY VEHICLES ONLY."
- ⑬ REMOVE AND SALVAGE SPECIAL SIGN "NO SOLICITATION."
- ⑭ REMOVE AND SALVAGE SPECIAL SIGN "NO SOLICITATION" AND SPECIAL SIGN "ORDINANCE 3788 VIOLATIONS."
- ⑮ INSTALL (3) R9-3a "NO PEDESTRIANS (SYMBOL)" 24"x24".
- ⑯ REMOVE AND SALVAGE R5-1 "DO NOT ENTER."
- ⑰ RESET EXISTING R6-1R "ONE WAY."
- ⑱ INSTALL SPECIAL SIGN "CAUTION BUS CROSSING" - SEE SHEET T-6.
- ⑲ REMOVE AND SALVAGE W14-1 "DO NOT ENTER" AND SPECIAL SIGN "5 MPH ALL BUSES."
- ⑳ INSTALL W11-2A "PEDESTRIAN CROSSWALK (SYMBOL) 36"x36" AND R2-1 "SPEED LIMIT 5 MPH" 24"x30".
- ㉑ INSTALL R5-1 "DO NOT ENTER" 30"x30".
- ㉒ RESET R5-1 "DO NOT ENTER," (2) R6-1L "ONE WAY" AND SPECIAL SIGN "NO SOLICITATION."
- ㉓ REMOVE AND SALVAGE R5-1 "DO NOT ENTER."
- ㉔ INSTALL W11A-2 "PEDESTRIAN CROSSWALK (SYMBOL)" 36"x36".
- ㉕ INSTALL (2) R7-8 "HANDICAPPED PARKING" 12"x18".
- ㉖ INSTALL SPECIAL SIGN "REGIONAL TRANSPORTATION COMMISSION PROJECT SIGN" - SEE SHEET T-6.

APPROVED

REVISIONS
DESCRIPTION

NO. DATE

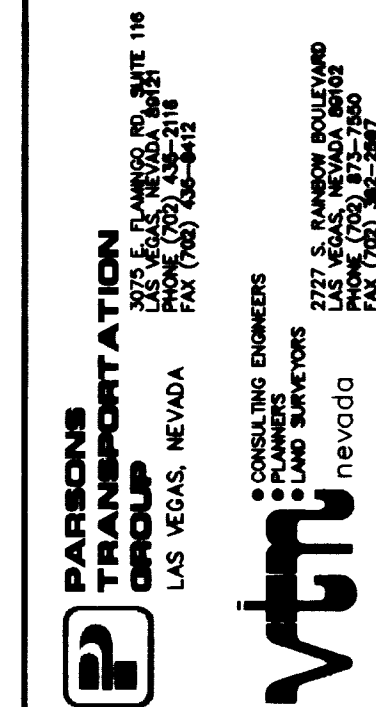
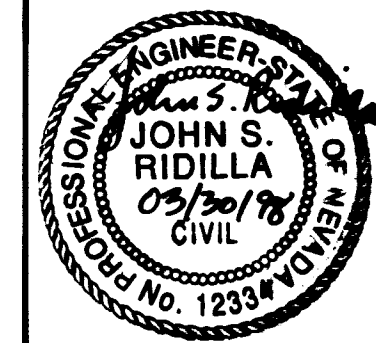

DOWNTOWN TRANSPORTATION CENTER REDESIGN
SIGNING PLAN
REGIONAL TRANSPORTATION COMMISSION

JOB NO. 641209
DATE: 03/30/98
HORIZ. SCALE: 1"=20'
VERT. SCALE: NONE
DRAWN BY: CDA
DESIGNED BY: JSR
APPROVED BY: JJC

DRAWING NO. T-3 OF T-6

G:\PROJECTS\641209\T\5228-SSN.DWG Plotter by M.B.M.

5228-SSN.DWG - 03/30/98

13069

590-2P

